

DEC 28 1988

KENTUCKY HISTORIC RESOURCES
Individual Inventory Form

Resource # Be-42
Boone County

1. Name of Resource: Barger, Donald, House

2. Original Owner: Unknown

3. Other Names: Unknown

4. Prehistoric Site Building Object
Historic Site Structure Other

5. Location: 2972 Front Street
Petersburg, KY

6. Owner's Name: Donald & Joyce Barger []

7. Owner's Address: 2972 Front Street
Petersburg, KY 41080

8. Evaluation: National Register []

9. Recognition & Date:
Nat.Landmark Local Landmark
Nat.Register HABS/HAER
Highway Marker KY Inventory 1977
KY Landmark Certificate

10. N.R.Status & Date:

11. N.R.Group:
District Name: []
Mult.Resource Area: Boone County []
Thematic Name: []

12. Historical Theme:
Primary: Architecture []
Secondary: []
Other: []

13. Statement of Significance:
This property is significant under criterion C as a good and particularly well-preserved, representative of approximately a dozen hall-parlor cottages in Petersburg, and of the ten hall-parlor houses surveyed in the rest of Boone County. The changes made to the house in the early 20th century do not affect []

14. History: its integrity: the overall design can readily be appreciated.

16. Date:
Original Building 4th & 19th c. []
Addition early 20th c. []

17. Style: No academic style []

18. Architect/Builder: unknown

19. No. of Stories: one []

20. Original Floor Plan: hall-parlor []

21. Single Pile Double Pile N.A.

22. Roof Form & Material: Original
gable/st. sm. tin Not Original

23. Structural Material: wood frame []

24. Exterior Material: weatherboard []

25. Foundation Material: stone []

26. Major Alterations: None
Moved/Rebuilt Other
Additions

27. Special Features: eccentric dining room woodwork

28. Outbuildings: none []

29. Original Function: dwelling []

30. Present Use: dwelling []

31. Condition: excellent []

32. Endangered: Yes
No

33. Attach Photos:
Roll: 2 Photo Nos: 15-16 No. of Slides:
19-20

Unknown

15. Source of historical information and/or contact person: N/A

34. Prepared by: Kenneth T. Gibbs

35. Organization: Boone Co.Hist.Pres.Rev.Brd.

36. Date: Sept. 1986

37. New Survey Resurvey

KENTUCKY HISTORIC RESOURCES
Individual Inventory Form

Resource # Be-42

38. UTM Point of Primary Building: Zone Easting Northing 39. G.I.S. Mod. []
 Quadrant: Lawrenceburg 16 684520 4326560 40. Coordi.Accuracy []

41. UTM Points of Boundary (for N. R. eligible sites only):

A.	---	-----	-----	D.	---	-----	-----
B.	---	-----	-----	E.	---	-----	-----
C.	---	-----	-----	F.	---	-----	-----

42. Total Acreage in Present Property: 0.20 43. Acreage included in proposed N.R. boundary: 0.20

44. Site Plan (and boundary description and justification for N.R. sites):

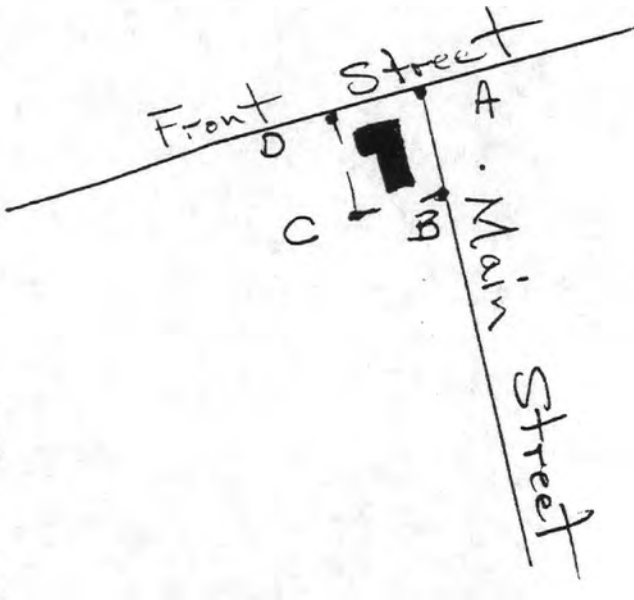

The boundaries, shown by points A, B, C, and D, includes the building and the entire city lot historically associated with the property. Line A-B is on the west side of Main Street, and line D-A is on the south side of Front Street.

The property occupies city lot 1 and is roughly 60' x 120' in size.

Contributing: 1 building

45. Description and House Plan:

The three-bay front block of the house consists of two rooms, parlor and bedroom, and the ell also consists of two rooms, dining room and kitchen. The porch in the angle of the ell has been enclosed. The 1/1 windows are topped by cornice strips, the transoms over the doors are concealed with wooden covering, and each of the three gables is fitted with a rectangular vent equipped with a hinged louvered shutter. There is no front porch, and apparently never was one, and the wide porch at the entrance to the kitchen is apparently an early 20th century addition. The flue at the ell gable is a more recent addition. The original two chimneys are decoratively corbeled.

Little-changed since the construction of the house, the interior features black iron mantels stenciled in gold, built-in closets flanking the gable window in the bedroom, and a built-in corner cupboard in the dining room. The woodwork includes bull's eye corner blocks in the two front rooms, plain trabeated woodwork in the kitchen, and very eccentric surrounds in the dining room, consisting of vertical moldings cut in jagged peaks at the tops connected by plain horizontal members.

There are no outbuildings.

United States Department of the Interior
National Park Service

National Register of Historic Places
Continuation Sheet

Section number _____ Page _____

Multiple Resource Area
Thematic Group

Name Boone County MRA
State KENTUCKY

Nomination/Type of Review

Date/Signature

- Cover *Substantive Review* Keeper Return 2/6/89
- 1. Stephens, L.B., Farm *Substantive Review* *for* Keeper Patrick Andrews 2/6/89
DOE/OWNER OBJECTION
- 2. Stites, Donald, Farmhouse *Substantive Review* Keeper Return 2/6/89 PWA
DOE/OWNER OBJECTION
- 3. Allen, B.M., House *Entered in the National Register* Keeper Melvin Byers 2/6/89
- 4. Aylor, A.J., House *Entered in the National Register* Keeper Melvin Byers 2/6/89
- 5. **Barger, Donald, House** *Entered in the National Register* Keeper Melvin Byers 2/6/89
- 6. Belleview Baptist Church *Entered in the National Register* Keeper Melvin Byers 2/6/89
- 7. Belleview Post Office *Substantive Review* Keeper Patrick Andrews 6/14/89
- 8. Big Bone Methodist Church *Entered in the National Register* Keeper Melvin Byers 2/6/89
- 9. Blankenbeker, Clinton, House *Entered in the National Register* Keeper Melvin Byers 2/6/89
- 10. Boone County Distillery Cooperage *Substantive Review* Keeper Return 2/6/89

10/1/89

UNITED STATES DEPARTMENT OF THE INTERIOR
NATIONAL PARK SERVICE

NATIONAL REGISTER OF HISTORIC PLACES
EVALUATION/RETURN SHEET

REQUESTED ACTION: NOMINATION

PROPERTY NAME: Barger, Donald, House

MULTIPLE NAME: Boone County MRA

STATE & COUNTY: KENTUCKY, Boone

DATE RECEIVED: 12/28/88 DATE OF PENDING LIST: 1/10/89
DATE OF 16TH DAY: 1/26/89 DATE OF 45TH DAY: 2/11/89
DATE OF WEEKLY LIST:

REFERENCE NUMBER: 88003259

NOMINATOR: STATE

REASONS FOR REVIEW:

APPEAL: N DATA PROBLEM: N LANDSCAPE: N LESS THAN 50 YEARS: N
OTHER: N PDIL: N PERIOD: N PROGRAM UNAPPROVED: N
REQUEST: N SAMPLE: N SLR DRAFT: N NATIONAL: N

COMMENT WAIVER: N

ACCEPT RETURN REJECT 2/6/89 DATE

Entered in the
National Register

ABSTRACT/SUMMARY COMMENTS:

RECOM./CRITERIA _____
REVIEWER _____
DISCIPLINE _____
DATE _____

DOCUMENTATION see attached comments Y/N see attached SLR Y/N

CLASSIFICATION

count resource type

STATE/FEDERAL AGENCY CERTIFICATION

FUNCTION

historic current

DESCRIPTION

architectural classification
 materials
 descriptive text

SIGNIFICANCE

Period Areas of Significance--Check and justify below

Specific dates Builder/Architect
Statement of Significance (in one paragraph)

summary paragraph
 completeness
 clarity
 applicable criteria
 justification of areas checked
 relating significance to the resource
 context
 relationship of integrity to significance
 justification of exception
 other

BIBLIOGRAPHY

GEOGRAPHICAL DATA

acreage verbal boundary description
 UTM's boundary justification

ACCOMPANYING DOCUMENTATION/PRESENTATION

sketch maps USGS maps photographs presentation

OTHER COMMENTS

Questions concerning this nomination may be directed to

_____ Phone _____

Signed _____ Date _____









Please refer to the map in the
Multiple Property Cover Sheet
for this property

Multiple Property Cover Sheet Reference Number: 64000206