

KENTUCKY HISTORIC RESOURCES  
Individual Inventory Form

Resource # Be-296  
Boone County

1. Name of Resource: Big Bone Methodist Church

2. Original Owner: Big Bone Methodist Church

3. Other Names: none

4. Prehistoric Site Building X Object  
Historic Site Structure Other

5. Location: 3435 Beaver Road Union, KY

6. Owner's Name: Mark Sorrell [ ]

7. Owner's Address: 3422 Beaver Road, Union, KY 41091

8. Evaluation: National Register [ ]

9. Recognition & Date:  
Nat.Landmark \_\_\_\_\_ Local Landmark \_\_\_\_\_  
Nat.Register \_\_\_\_\_ HABS/HAER \_\_\_\_\_  
Highway Marker \_\_\_\_\_ KY Inventory 1977  
KY Landmark Certificate \_\_\_\_\_

10. N.R.Status & Date:

11. N.R.Group:  
District Name: [ ]  
Mult.Resource Area: Boone County [ ]  
Thematic Name: [ ]

12. Historical Theme:  
Primary: Architecture [ ]  
Secondary: [ ]  
Other: [ ]

13. Statement of Significance:  
This property is significant under criterion C as a good example of vernacular architecture, significant to Boone County in the period 1880-1930. The building is notable for its vernacular interpretation of ornamental devices from the Gothic Revival and Queen Anne styles and of traditional church form in the area: nave plan, [ ]

16. Date: Original Building 1888\* [ ]  
Addition [ ]

17. Style: Gothic Revival [ ]  
Queen Anne [ ]

18. Architect/Builder: unknown

19. No. of Stories: one [ ]

20. Original Floor Plan: nave [ ]

21. Single Pile Double Pile N.A. X

22. Roof Form & Material: Original X  
gable/asph. shingle Not Original

23. Structural Material: wood frame [ ]

24. Exterior Material: weatherboard [ ]

25. Foundation Material: fieldstone [ ]

26. Major Alterations: None X  
Moved/Rebuilt Other

27. Special Features: two stories of windows rather than one

28. Outbuildings: none [ ]

29. Original Function: church [ ]

30. Present Use: church [ ]

31. Condition: excellent [ ]

32. Endangered: Yes  
No X

33. Attach Photos: Roll: 10 Photo Nos: 33-34 No. of Slides:

14. History: rectangular gable form, gable-front facade.

The congregation was organized in 1887, serving the community known as Big Bone, known since the 18th century for local deposits of prehistoric animal remains. The first minister of the church was the Reverend George Froh, a German veteran of the Civil War.

15. Source of historical information and/or contact person:  
\*sign in panel above door

34. Prepared by: Kenneth T. Gibbs  
35. Organization: Boone Co.Hist.Pres.Rev.Brd.  
36. Date: September 1986  
37. New Survey \_\_\_\_\_ Resurvey X

KENTUCKY HISTORIC RESOURCES  
Individual Inventory Form

Resource # Be-296

38. UTM Point of Primary Building:	Zone	Easting	Northing	39. G.I.S. Mod.	[ ]
Quadrant: <u>Rising Sun</u>	<u>16</u>	<u>695060</u>	<u>4306600</u>	40. Coord. Accuracy	[ ]
41. UTM Points of Boundary (for N. R. eligible sites only):					
A.	---	---	---	D.	---
B.	---	---	---	E.	---
C.	---	---	---	F.	---
42. Total Acreage in Present Property: .215		43. Acreage included in proposed N.R. boundary: .215			
44. Site Plan (and boundary description and justification for N.R. sites):					

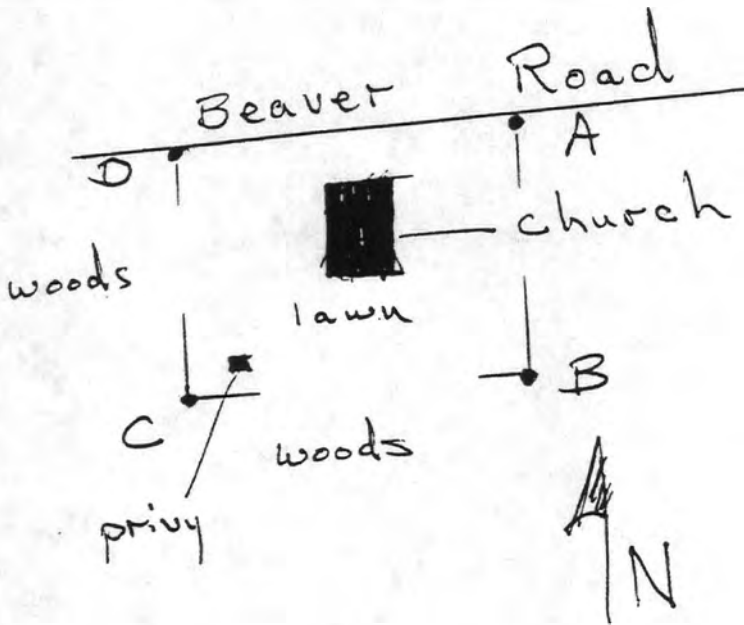

The nominated property occupies tax parcel 31-48 and is roughly 125' x 75' in size. The boundary includes the building and sufficient acreage, marked on two sides by lines of woods, to provide a setting. The privy is also included.

Contributing: 2 buildings

45. Description and House Plan:

The simple gable-front building features a regular, tiered placement of pointed-arch windows, four bays on the two sides and three bays on the front and back. Part of the interior, above the door, is occupied by a balcony. All the windows are double-hung sash, consisting of opaque glass surrounded by small panes of colored glass. A semi-octagonal, one-story bay projects beyond the plane of the wall in the center of the rear of the building. The foundation is quarried stone in even courses, topped with a projecting wooden water table. The chief decorative detail, drawn from the Queen Anne style, is in the front, including the ornament and the gabled hood over the door, built of chamfered wooden elements and filled with panels pierced with delicate stems and leaf shapes. The space between the building and the higher elevation of the roadway has been paved with concrete to encourage water runoff. There is a small wooden privy to the southwest of the church, built at about the same time as the church.

including the side-ped

United States Department of the Interior  
National Park Service

National Register of Historic Places  
Continuation Sheet

Section number \_\_\_\_\_ Page \_\_\_\_\_

Multiple Resource Area  
Thematic Group

Name Boone County MRA  
State KENTUCKY

Nomination/Type of Review	Date/Signature
Cover <i>Substantive Review</i>	Keeper <u>Return 2/6/89</u>
1. Stephens, L.B., Farm <i>Substantive Review</i> <b>DOE/OWNER OBJECTION</b>	<i>Determined Eligible</i> Keeper <u>Patrick Andrews 2/6/89</u> Attest _____
2. Stites, Donald, Farmhouse <i>Substantive Review</i> <b>DOE/OWNER OBJECTION</b>	Keeper <u>Return 2/6/89 PWA</u> Attest _____
3. Allen, B.M., House <i>Entered in the National Register</i>	Keeper <u>Melvin Byers 2/6/89</u> Attest _____
4. Aylor, A.J., House <i>Entered in the National Register</i>	Keeper <u>Melvin Byers 2/6/89</u> Attest _____
5. Barger, Donald, House <i>Entered in the National Register</i>	Keeper <u>Melvin Byers 2/6/89</u> Attest _____
6. Belleview Baptist Church <i>Entered in the National Register</i>	Keeper <u>Melvin Byers 2/6/89</u> Attest _____
7. Belleview Post Office <i>Substantive Review</i>	Keeper <u>Patrick Andrews 6/14/89</u> Attest _____
8. Big Bone Methodist Church <i>Entered in the National Register</i>	Keeper <u>Melvin Byers 2/6/89</u> Attest _____
9. Blankenbeker, Clinton, House <i>Entered in the National Register</i>	Keeper <u>Melvin Byers 2/6/89</u> Attest _____
10. Boone County Distillery Cooperage <i>Substantive Review</i>	Keeper <u>Return P. Andrews 2/6/89</u> Attest _____

10/27/89



UNITED STATES DEPARTMENT OF THE INTERIOR  
NATIONAL PARK SERVICE

NATIONAL REGISTER OF HISTORIC PLACES  
EVALUATION/RETURN SHEET

REQUESTED ACTION: NOMINATION

PROPERTY Big Bone Methodist Church  
NAME:

MULTIPLE Boone County MRA  
NAME:

STATE & COUNTY: KENTUCKY, Boone

DATE RECEIVED: 12/28/88 DATE OF PENDING LIST: 1/10/89  
DATE OF 16TH DAY: 1/26/89 DATE OF 45TH DAY: 2/11/89  
DATE OF WEEKLY LIST:

REFERENCE NUMBER: 88003287

NOMINATOR: STATE

REASONS FOR REVIEW:

APPEAL: N DATA PROBLEM: N LANDSCAPE: N LESS THAN 50 YEARS: N  
OTHER: N PDIL: N PERIOD: N PROGRAM UNAPPROVED: N  
REQUEST: N SAMPLE: N SLR DRAFT: N NATIONAL: N

COMMENT WAIVER: N

ACCEPT  RETURN  REJECT 2/6/89 DATE

Entered in the  
National Register

ABSTRACT/SUMMARY COMMENTS:

RECOM./CRITERIA \_\_\_\_\_  
REVIEWER \_\_\_\_\_  
DISCIPLINE \_\_\_\_\_  
DATE \_\_\_\_\_

DOCUMENTATION see attached comments Y/N see attached SLR Y/N

---

CLASSIFICATION

count       resource type

---

STATE/FEDERAL AGENCY CERTIFICATION

---

FUNCTION

historic       current

---

DESCRIPTION

architectural classification  
 materials  
 descriptive text

---

SIGNIFICANCE

Period      Areas of Significance--Check and justify below

Specific dates      Builder/Architect  
Statement of Significance (in one paragraph)

summary paragraph  
 completeness  
 clarity  
 applicable criteria  
 justification of areas checked  
 relating significance to the resource  
 context  
 relationship of integrity to significance  
 justification of exception  
 other

---

BIBLIOGRAPHY

---

GEOGRAPHICAL DATA

acreage       verbal boundary description  
 UTM's       boundary justification

---

ACCOMPANYING DOCUMENTATION/PRESENTATION

sketch maps     USGS maps     photographs     presentation

---

OTHER COMMENTS

Questions concerning this nomination may be directed to

\_\_\_\_\_ Phone \_\_\_\_\_

Signed \_\_\_\_\_ Date \_\_\_\_\_



1888  
BIG BONE  
METHODIST  
CHURCH

WELCOME

WOMEN SOCIETY, JUNIOR  
LADIES SOCIETY, A.S.T.S.

Please refer to the map in the  
Multiple Property Cover Sheet  
for this property

Multiple Property Cover Sheet Reference Number: 64000206