

DEC 28 1988

3268

KENTUCKY HISTORIC RESOURCES  
Individual Inventory Form

Resource # Be-70  
Boone County

1. Name of Resource:  
Chambers, A.E., Octagonal Barn

2. Original Owner:  
A. E. Chambers

3. Other Names:  
Oak Knoll Farm

4. Prehistoric Site	Building Structure	Object Other
Historic Site		

5. Location:  
5009 Petersburg Road  
Burlington, KY

6. Owner's Name:  
Jack and Mary Lillie [ ]

7. Owner's Address:  
5009 Petersburg Road  
Burlington, KY

8. Evaluation: National Register [ ]

9. Recognition & Date:  
 Nat.Landmark \_\_\_\_\_ Local Landmark \_\_\_\_\_  
 Nat.Register \_\_\_\_\_ HABS/HAER \_\_\_\_\_  
 Highway Marker \_\_\_\_\_ KY Inventory 1977  
 KY Landmark Certificate \_\_\_\_\_

10. N.R.Status & Date:

11. N.R.Group:  
 District Name: [ ]  
 Mult.Resource Area: Boone County [ ]  
 Thematic Name: [ ]

12. Historical Theme:  
 Primary: Architecture [ ]  
 Secondary: Agriculture [ ]  
 Other: [ ]

13. Statement of Significance:  
 This property is significant under criterion C as a good, well-preserved example of the vogue in the period 1860-1880 for octagonal form buildings. The best-preserved of only two octagonal form buildings identified in Boone County, this barn is of local significance. The property is also significant. [ ]

14. History: under criterion A as a good example of a specialized agricultural outbuilding in the period 1870-1900.  
 The owner indicated in the 1883 atlas was A. E. Chambers.

16. Date:  
 Original Building c. 1870s [ ]  
 Addition [ ]

17. Style:  
 vernacular [ ]

18. Architect/Builder: unknown [ ]

19. No. of Stories: N/A [ ]

20. Original Floor Plan:  
 cross-axis [ ]

21. Single Pile Double Pile N.A. X

22. Roof Form & Material: Original X  
 octagonal/asph. shingle Not Original

23. Structural Material:  
 wood frame [ ]

24. Exterior Material:  
 board-and-batten [ ]

25. Foundation Material:  
 fieldstone [ ]

26. Major Alterations: None X  
 Moved/Rebuilt Other  
 Additions

27. Special Features:  
 axial, not central feeding of livestock

28. Outbuildings:  
 five [ ]

29. Original Function:  
 livestock and hay barn [ ]

30. Present Use: none [ ]

31. Condition: fair [ ]

32. Endangered: Yes X  
 the barn is leaning southeast No

33. Attach Photos:  
 Roll: 2 Photo Nos: 3-6 No. of Slides:  
 16 8  
 17 22 & 23

15. Source of historical information and/or contact person: William Conrad

34. Prepared by: Kenneth T. Gibbs  
 35. Organization: Boone Co. Hist. Pres. Rev. Bd.  
 36. Date: September 1986  
 37. New Survey \_\_\_\_\_ Resurvey X

KENTUCKY HISTORIC RESOURCES  
Individual Inventory Form

Resource # Be-70

38. UTM Point of Primary Building: Quadrant: <u>Lawrenceburg</u>	Zone <u>16</u>	Easting <u>689100</u>	Northing <u>4326500</u>	39. G.I.S. Mod. [ ]	40. Coordi. Accuracy [ ]
---------------------------------------------------------------------	-------------------	--------------------------	----------------------------	---------------------	--------------------------

41. UTM Points of Boundary (for N. R. eligible sites only):

A. -----	D. -----
B. -----	E. -----
C. -----	F. -----

42. Total Acreage in Present Property: 2.192 43. Acreage included in proposed N.R. boundary: 2.192

44. Site Plan (and boundary description and justification for N.R. sites):

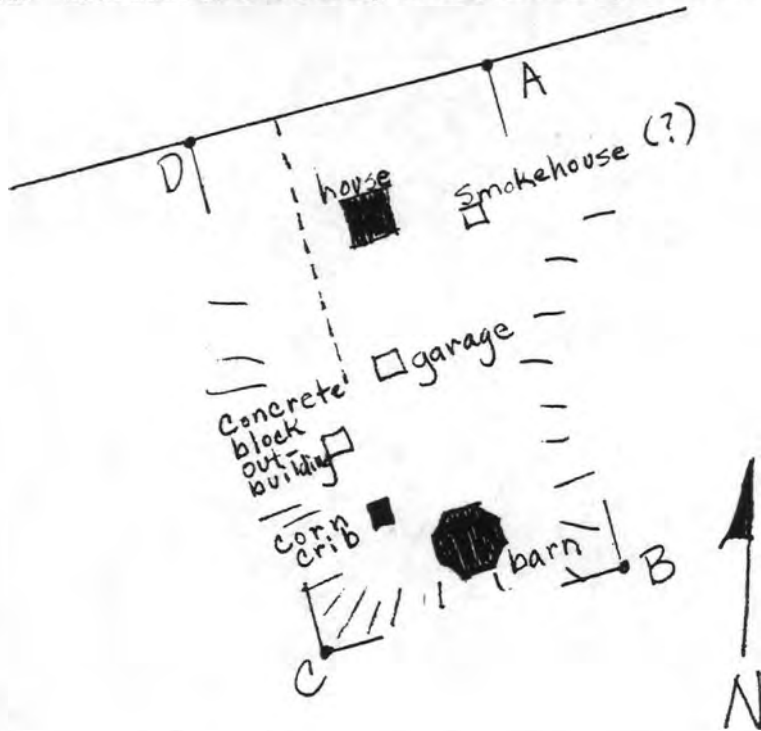

The boundary follows the property line and is referred to as parcel 16-01A by the tax maps. The boundary, shown by points A, B, C, and D, is a rectangle approximately 200' x 475'. It includes the barn, the farmhouse, and four outbuildings, as well as sufficient acreage to provide a setting. Boundary D-A is on the south side of Petersburg Road.

Contributing: 2 buildings (octagonal barn, farmhouse)

1 Structure (corncrib)

Noncontributing: 3 buildings (garage, concrete block outbuilding, smokehouse)

45. Description and House Plan:

Although octagonal barns were devised to permit efficient feeding of livestock from the center of the structure, the two barns built in Boone County were planned for cross-axis feeding. The main axis of the A. E. Chambers octagonal barn extends southward from the main door on the north face. The silo, on the southeast face of the barn, seems to have been added at a later time, perhaps when the barn was adapted for dairy cattle.

The barn is capped with a cupola-like, louvered air vent. The louvers of the vent have deteriorated, as have the solid shutters of other openings and the board-and-batten covering of the building. Also, portions of the fieldstone foundation have been replaced with concrete blocks. Although several walls are leaning noticeably toward the silo, the barn may be structurally sound.

The barn is complemented by the contemporary frame farmhouse and four outbuildings between the barn and house. The two-story, gabled, T-form house has recently been vinyl-sided, although the decorative wooden porches flanking the stem of the T remain, and the windows have been replaced with aluminum versions. The stem of the T faces Petersburg Road (north), and there are matching 1-story porches, decorated with wooden jigsaw work, in the angles of the T. A 1-story octagonal bay lights the main parlor, in the stem of the T. A 1-story, frame addition was constructed at the south end of the house in the 1970s. The farmhouse contributes to the significance of the property in that it was both the residence of the original owners and the center of the family-run farm.

(Continued)

---

45. Description and House Plan: (Continued)

---

The other outbuildings include a late 19th century frame corn crib, a concrete block shed, an early 20th century frame garage, and a small frame outbuilding used perhaps as a smokehouse. Although the corn crib, consisting of 2 cribs flanking an open central bay, with gable roof covered with standing-seam metal, appears to have been erected after the period of significance of the property, it contributes to the setting by illustrating the variety of uses required in 19th century agricultural outbuildings in Boone County.

United States Department of the Interior  
National Park Service

National Register of Historic Places  
Continuation Sheet

Section number \_\_\_\_\_ Page \_\_\_\_\_

Multiple Resource Area  
Thematic Group

Name Boone County MRA  
State KENTUCKY

Nomination/Type of Review

Date/Signature

11. Boone County Distillery Superintendant's  
House and Guest House Entered in the  
National Register

for Keeper Melvyn Byrum 2/6/89  
Attest \_\_\_\_\_

12. Botts House Entered in the  
National Register

for Keeper Melvyn Byrum 2/6/89  
Attest \_\_\_\_\_

13. Calvert, B.C., House Entered in the  
National Register

for Keeper Melvyn Byrum 2/6/89  
Attest \_\_\_\_\_

DEP  
SCK/F-  
14. Chambers, A.E., Octagonal Barn  
Substantive Review

for Keeper Patrick Andrews 2/7/89  
Attest \_\_\_\_\_

15. Chandler House Entered in the  
National Register

for Keeper Melvyn Byrum 2/6/89  
Attest \_\_\_\_\_

16. Christian Meeting House Entered in the  
National Register

for Keeper Melvyn Byrum 2/6/89  
Attest \_\_\_\_\_

17. Clore House Entered in the  
National Register

for Keeper Melvyn Byrum 2/6/89  
Attest \_\_\_\_\_

18. Clore, Jonas, House Entered in the  
National Register

for Keeper Melvyn Byrum 2/6/89  
Attest \_\_\_\_\_

19. Collins, Capt. N., House Entered in the  
National Register

for Keeper Melvyn Byrum 2/6/89  
Attest \_\_\_\_\_

20. Corn, Allie, House Entered in the  
National Register

for Keeper Melvyn Byrum 2/6/89  
Attest \_\_\_\_\_

United States Department of the Interior  
National Park Service

National Register of Historic Places  
Continuation Sheet

Section number \_\_\_\_\_ Page \_\_\_\_\_

SUPPLEMENTARY LISTING RECORD

NRIS Reference Number: 88003268

Date Listed: 2/7/89

A. E. Chambers Octagonal Barn  
Property Name

Boone  
County

KY  
State

Multiple Name

-----  
This property is listed in the National Register of Historic Places in accordance with the attached nomination documentation subject to the following exceptions, exclusions, or amendments, notwithstanding the National Park Service certification included in the nomination documentation.

Patrick Andrews  
Signature of the Keeper

2/7/89  
Date of Action

===== Amended Items in Nomination:

The resource count had to be clarified. The corn crib is described as being constructed after the period of significance, yet it is listed as contributing. Marty Perry with the KY SHPO says that this was an oversight and that the form should be changed. The form is now officially amended to list the corn crib as non-contributing.

DISTRIBUTION:

- National Register property file
- Nominating Authority (without nomination attachment)

FOX RIVER  
GLISH-BOND  
50% COTTON

UNITED STATES DEPARTMENT OF THE INTERIOR  
NATIONAL PARK SERVICE

NATIONAL REGISTER OF HISTORIC PLACES  
EVALUATION/RETURN SHEET

REQUESTED ACTION: NOMINATION

PROPERTY NAME: Chambers, A. E., Octagonal Barn

MULTIPLE NAME: Boone County MRA

STATE & COUNTY: KENTUCKY, Boone

DATE RECEIVED: 12/28/88      DATE OF PENDING LIST: 1/10/89  
DATE OF 16TH DAY: 1/26/89      DATE OF 45TH DAY: 2/11/89  
DATE OF WEEKLY LIST:

REFERENCE NUMBER: 88003268

NOMINATOR: STATE

REASONS FOR REVIEW:

APPEAL: N DATA PROBLEM: Y LANDSCAPE: N LESS THAN 50 YEARS: N  
OTHER: N PDIL: N PERIOD: N PROGRAM UNAPPROVED: N  
REQUEST: N SAMPLE: N SLR DRAFT: N NATIONAL: N

COMMENT WAIVER: N

ACCEPT     RETURN     REJECT    2/7/89 DATE

ABSTRACT/SUMMARY COMMENTS:

*Historically & architecturally significant farm complex  
- see SLR for clarification of resource count*

RECOM./CRITERIA accept A&C  
REVIEWER Patrick Andrus  
DISCIPLINE Historian  
DATE 2/6/89

DOCUMENTATION see attached comments Y/N see attached SLR Y/N

---

CLASSIFICATION

count       resource type

---

STATE/FEDERAL AGENCY CERTIFICATION

---

FUNCTION

historic       current

---

DESCRIPTION

architectural classification  
 materials  
 descriptive text

---

SIGNIFICANCE

Period      Areas of Significance--Check and justify below

Specific dates      Builder/Architect  
Statement of Significance (in one paragraph)

summary paragraph  
 completeness  
 clarity  
 applicable criteria  
 justification of areas checked  
 relating significance to the resource  
 context  
 relationship of integrity to significance  
 justification of exception  
 other

---

BIBLIOGRAPHY

---

GEOGRAPHICAL DATA

acreage       verbal boundary description  
 UTM's       boundary justification

---

ACCOMPANYING DOCUMENTATION/PRESENTATION

sketch maps       USGS maps       photographs       presentation

---

OTHER COMMENTS

Questions concerning this nomination may be directed to

\_\_\_\_\_ Phone \_\_\_\_\_

Signed \_\_\_\_\_ Date \_\_\_\_\_













Please refer to the map in the  
Multiple Property Cover Sheet  
for this property

Multiple Property Cover Sheet Reference Number: 64000206