

DEC 28 1988

3285

KENTUCKY HISTORIC RESOURCES
Individual Inventory Form

Resource # Be-274
Boone County

1. Name of Resource: Lassing, Morris, House

2. Original Owner: Morris Lassing

3. Other Names: Elm Tree Place

4. Prehistoric Site Building Object
Historic Site Structure Other

5. Location: 10515 Hwy 42
Union, KY

6. Owner's Name: Stuart & Sara Ferguson []

7. Owner's Address: 10515 Hwy 42
Union, KY

8. Evaluation: National Register []

9. Recognition & Date:
Nat.Landmark Local Landmark
Nat.Register HABS/HAER
Highway Marker KY Inventory 1977
KY Landmark Certificate

10. N.R.Status & Date:

11. N.R.Group:
District Name: []
Mult.Resource Area: Boone County []
Thematic Name: []

12. Historical Theme:
Primary: Architecture []
Secondary: Agriculture []
Other: []

13. Statement of Significance:
This property is significant under criterion C as a good example of the dogtrot form, significant to Boone County in the period 1800-1850. It is notable for its juxtaposition of mid-19th century taste (Federal and Greek Revival) and mid-20th century design (the two end wings), extending the period of significance []

14. History: to 1950. (Continued)

From John Hamilton of Buckingham Co., VA, 110 a. passed to MORRIS Lassing (1800-1867), from Bavaria, and his wife, Martha Hamilton Lassing (married 1826). Martha Lassing is the owner shown in the 1883 atlas. The property was purchased (c. 1914) by Charles Philip Baker after Therese Lassing's death (granddaughter of Martha). Tenants lived in the house until Walter & Shirley (granddaughter of Charles Philip Baker) Ferguson moved into the house in 1928. The current owner is their grandson.

15. Source of historical information and/or contact person: Perrin, Biographical Sketches
research in possession of owner

16. Date:
Original Building 1820s []
Addition mid-19th c./mid-20th c. []

17. Style: Federal []
Greek Revival []

18. Architect/Builder: unknown

19. No. of Stories: two []

20. Original Floor Plan: central passage (dogtrot log form) []

21. Single Pile Double Pile N.A.

22. Roof Form & Material: Original
gable/asphalt shingle Not Original

23. Structural Material: log/wood frame []

24. Exterior Material: weatherboarding []

25. Foundation Material: []

26. Major Alterations: None
Moved/Rebuilt Other
Additions

27. Special Features: none

28. Outbuildings: six []

29. Original Function: farm dwelling []

30. Present Use: farm dwelling []

31. Condition: excellent []

32. Endangered: Yes
No

33. Attach Photos: Roll: 10 Photo Nos:16-32 No. of Slides:

34. Prepared by: Kenneth T. Gibbs

35. Organization: Boone Co. Hist. Pres. Rev. Bnd

36. Date: September 1986

37. New Survey Resurvey

DEC 28 1988

KENTUCKY HISTORIC RESOURCES
Individual Inventory Form

Resource # Be-274

38. UTM Point of Primary Building: Zone Easting Northing 39. G.I.S. Mod. []
 Quadrant: Union 16 701380 4311120 40. Coordi.Accuracy []

41. UTM Points of Boundary (for N. R. eligible sites only):

A. ----- D. -----
 B. ----- E. -----
 C. ----- F. -----

42. Total Acreage in Present Property: 16.04 43. Acreage included in proposed N.R. boundary: 2

44. Site Plan (and boundary description and justification for N.R. sites):

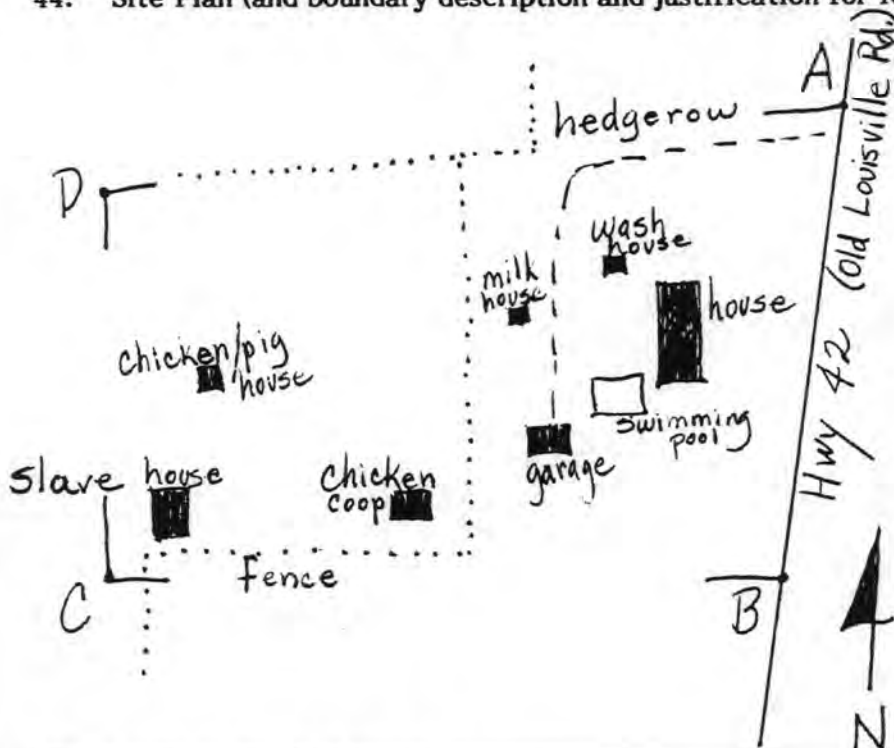

Beginning at a point on the west side of Hwy 42 and 10' north of the driveway, proceed southwest along Hwy 42 (B). Then proceed 350' west (C), turning north for 200' (D). Then proceed east northeast 400' to the point of origin (A). The boundary includes the built environment and sufficient acreage to provide a setting.

Contributing: 7 buildings
 Noncontributing: 1 structure (swimming pool)

45. Description and House Plan:

The original house, which faces east, is a dogtrot form log structure, perhaps built in two stages. The north pen is finished inside with Federal woodwork, the south pen with Greek Revival woodwork, including hoods, or drip moldings, and the central passage is a mix of the two (the staircase is square, open-well of simple design). The walls enclosing the central passage are of log construction. During the 1840s or 1850s, the height of the house was raised from 1½ stories to a full two stories with frame construction, a frame ell was erected, and the Greek Revival detail was added, including the front entry, consisting of a 4-panel door flanked by detached Greek Doric fluted columns and sidelights and a transom divided into three parts by fluted blocks. The frame that surrounds the doorway, consisting of pilasters, fluted blocks and a cornice, was added when the one-story Greek Revival porch was removed c. 1950. The windows are 6/6 double-hung sash, and the cornice is ornamented with brackets across the front and gable-ends and with modillions across the back. Both brick chimneys are located in the interior of the end walls.

During a remodeling beginning in the late 1940s, the two one-story wings were added, giving the house a three-part form, and the 1½ story ell was replaced with a slightly taller ell. The key elements marking these mid-20th century additions, distinguishing them from the 19th century section of the house, are the change in window proportions, the flush gable-ends, the simple cornices, the de-emphasized foundations, the design of the open porch making up the south wing, and the design of the exterior chimney in the gable-end of the ell.

The main barn on the farm, built as a dairy barn, was located at the end of the entrance

(Continued)

Resource # Be-274
Boone County
Page 3 of 3 Pages

45. Description and House Plan: (Continued)

lane until it burned. The original frame smokehouse and an early 20th century privy have also burned, since the accompanying photographs were taken. The remaining outbuildings include a wash house, milk house, chicken coop, pig house, slave house and garage.

The contemporary wash house (brick common bond, 1-room plan, gabled with asphalt shingles, fieldstone foundation, decorative pierced bargeboards, 6/6 double-hung sash window on east, off-center door in south gable-end) was equipped with a root cellar under the floor.

The 2-car garage (frame, weatherboard, gabled with asphalt shingles, overhead doors) was built in the mid-20th century.

The milk house (concrete block, side-gabled with asphalt shingle roofing) was built c. 1943.

The chicken coop (board & batten, gabled roof, overhanging and sheltering the gable-end entry on the east) was built in the late 19th century.

The chicken house/pig house (concrete block, shed roof, asphalt shingles) has an open entry in the east wall and was built c. 1945.

The slave house, a rectangular, single-pen log house (exterior end chimney of stone and brick, door and window on the east, no openings on the west or south, collapsed wall on the north) was built at about the same time as the house and is in deteriorated condition.

All outbuildings contribute to the integrity of the property because they illustrate the specialized uses of outbuildings in Boone County in this period and the necessity of replacing outbuildings over time.

13. Statement of Significance

The property is also significant under criterion A as a good example of a large farm in Boone County, in the period 1820-1938.

UNITED STATES DEPARTMENT OF THE INTERIOR
NATIONAL PARK SERVICE

NATIONAL REGISTER OF HISTORIC PLACES
EVALUATION/RETURN SHEET

REQUESTED ACTION: NOMINATION

PROPERTY Lassing, Morris, House
NAME:

MULTIPLE Boone County MRA
NAME:

STATE & COUNTY: KENTUCKY, Boone

DATE RECEIVED: 12/28/88 DATE OF PENDING LIST: 1/10/89
DATE OF 16TH DAY: 1/26/89 DATE OF 45TH DAY: 2/11/89
DATE OF WEEKLY LIST:

REFERENCE NUMBER: 88003285

NOMINATOR: STATE

REASONS FOR REVIEW:

APPEAL: N DATA PROBLEM: N LANDSCAPE: N LESS THAN 50 YEARS:
OTHER: N PDIL: N PERIOD: PROGRAM UNAPPROVED: N
REQUEST: N SAMPLE: N SLR DRAFT: N NATIONAL: N

COMMENT WAIVER: N

ACCEPT RETURN REJECT 2/9/89 DATE

ABSTRACT/SUMMARY COMMENTS:

The period of significance has been defined to 1950 yet the exceptional significance of this building is not discussed. Please either provide an explanation of its exceptional significance or reconsider the period of significance

RECOM./CRITERIA Return
REVIEWER Patrick Andrews
DISCIPLINE Historian
DATE 2/9/89

DOCUMENTATION see attached comments Y/N see attached SLR Y/N

CLASSIFICATION

count resource type

STATE/FEDERAL AGENCY CERTIFICATION

FUNCTION

historic current

DESCRIPTION

architectural classification
 materials
 descriptive text

SIGNIFICANCE

Period Areas of Significance--Check and justify below

Specific dates Builder/Architect
Statement of Significance (in one paragraph)

summary paragraph
 completeness
 clarity
 applicable criteria
 justification of areas checked
 relating significance to the resource
 context
 relationship of integrity to significance
 justification of exception
 other

BIBLIOGRAPHY

GEOGRAPHICAL DATA

acreage verbal boundary description
 UTM's boundary justification

ACCOMPANYING DOCUMENTATION/PRESENTATION

sketch maps USGS maps photographs presentation

OTHER COMMENTS

Questions concerning this nomination may be directed to

Signed Patrick Andrus Phone _____
Date _____

2/9/89

KENTUCKY HISTORIC RESOURCES
Individual Inventory Form

Resource # Be-274
Boone County

<p>1. Name of Resource: <u>Lassing, Morris, House</u></p> <p>2. Original Owner: <u>Morris Lassing</u></p> <p>3. Other Names: <u>Elm Tree Place</u></p> <p>4. Prehistoric Site <input type="checkbox"/> Building <input checked="" type="checkbox"/> Object Historic Site <input type="checkbox"/> Structure <input type="checkbox"/> Other</p> <p>5. Location: <u>10515 Hwy 42</u> <u>Union, KY</u></p> <p>6. Owner's Name: <u>Stuart & Sara Ferguson</u> []</p> <p>7. Owner's Address: <u>10515 Hwy 42</u> <u>Union, KY</u></p> <p>8. Evaluation: <u>National Register</u> []</p> <p>9. Recognition & Date: Nat.Landmark _____ Local Landmark _____ Nat.Register _____ HABS/HAER _____ Highway Marker _____ KY Inventory <u>1977</u> KY Landmark Certificate _____</p> <p>10. N.R.Status & Date:</p> <p>11. N.R.Group: District Name: [] Mult.Resource Area: <u>Boone County</u> [] Thematic Name: []</p> <p>12. Historical Theme: Primary: <u>Architecture</u> [] Secondary: <u>Agriculture</u> [] Other: []</p> <p>13. Statement of Significance: This property is significant under criterion C as a good example of the dogtrot form, significant to Boone County in the period 1800-1850. It is notable for its juxtaposition of mid-19th century taste (Federal and Greek Revival) and mid-20th century design (the two end wings), extending the period of significance []</p> <p>14. History: <u>to 1940. (Continued)</u></p> <p>From John Hamilton of Buckingham Co., VA, 110 a. passed to MORRIS LASSING (1800-1867), from Bavaria, and his wife, Martha Hamilton Lassing (married 1826). Martha Lassing is the owner shown in the 1883 atlas. The property was purchased (c. 1914) by Charles Philip Baker after Therese Lassing's death (granddaughter of Martha). Tenants lived in the house until Walter & Shirley (granddaughter of Charles Philip Baker) Ferguson moved into the house in 1928. The current owner is their grandson.</p> <p>15. Source of historical information and/or contact person: <u>Perrin, Biographical Sketches</u> research in possession of owner</p>	<p>16. Date: <u>Original Building 1820s</u> [] <u>Addition mid-19th c./mid-20th c.</u> []</p> <p>17. Style: <u>Federal</u> [] <u>Greek Revival</u> []</p> <p>18. Architect/Builder: <u>unknown</u></p> <p>19. No. of Stories: <u>two</u> []</p> <p>20. Original Floor Plan: <u>central passage (dogtrot log form)</u> []</p> <p>21. Single Pile <input checked="" type="checkbox"/> Double Pile <u>N.A.</u></p> <p>22. Roof Form & Material: <u>Original</u> <input checked="" type="checkbox"/> <u>gable/asphalt shingle</u> Not Original</p> <p>23. Structural Material: <u>log/wood frame</u> []</p> <p>24. Exterior Material: <u>weatherboarding</u> []</p> <p>25. Foundation Material: []</p> <p>26. Major Alterations: <u>None</u> <u>Moved/Rebuilt</u> Other <input checked="" type="checkbox"/> <u>Additions</u> <input checked="" type="checkbox"/></p> <p>27. Special Features: <u>none</u></p> <p>28. Outbuildings: <u>six</u> []</p> <p>29. Original Function: <u>farm dwelling</u> []</p> <p>30. Present Use: <u>farm dwelling</u> []</p> <p>31. Condition: <u>excellent</u> []</p> <p>32. Endangered: <u>Yes</u> <u>No</u> <input checked="" type="checkbox"/></p> <p>33. Attach Photos: <u>Roll: 10 Photo Nos:16-32 No. of Slides:</u></p> <p>34. Prepared by: <u>Kenneth T. Gibbs</u></p> <p>35. Organization: <u>Boone Co. Hist. Pres. Rev. Brd.</u></p> <p>36. Date: <u>September 1986</u></p> <p>37. New Survey _____ Resurvey <input checked="" type="checkbox"/></p>
--	--

KENTUCKY HISTORIC RESOURCES
Individual Inventory Form

DEC 28 1980
Resource # Be-274

38. UTM Point of Primary Building: Quadrant: Union	Zone 16	Easting 701380	Northing 4311120	39. G.I.S. Mod. []	40. Coordi. Accuracy []
---	---------	----------------	------------------	---------------------	--------------------------

41. UTM Points of Boundary (for N. R. eligible sites only):

A. ---	D. ---
B. ---	E. ---
C. ---	F. ---

42. Total Acreage in Present Property: 16.04 43. Acreage included in proposed N.R. boundary: 2

44. Site Plan (and boundary description and justification for N.R. sites):

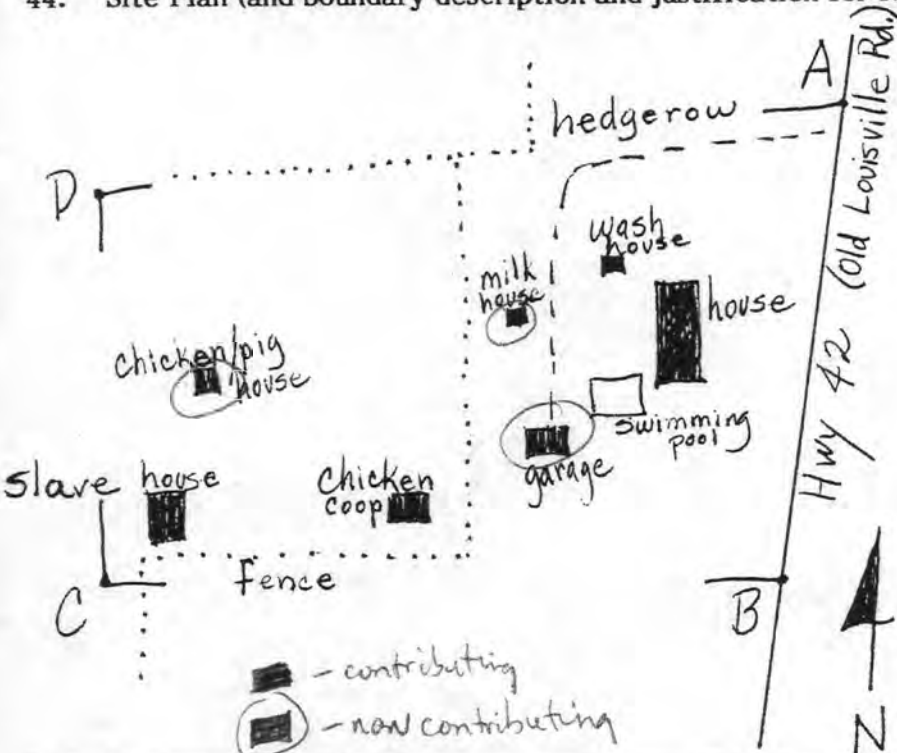

Beginning at a point on the west side of Hwy 42 and 10' north of the driveway, proceed southwest along Hwy 42 (B). Then proceed 350' west (C), turning north for 200' (D). Then proceed east northeast 400' to the point of origin (A). The boundary includes the built environment and sufficient acreage to provide a setting.

Contributing: 7 buildings
Noncontributing: 1 structure (swimming pool)

45. Description and House Plan:

The original house, which faces east, is a dogtrot form log structure, perhaps built in two stages. The north pen is finished inside with Federal woodwork, the south pen with Greek Revival woodwork, including hoods, or drip moldings, and the central passage is a mix of the two (the staircase is square, open-well of simple design). The walls enclosing the central passage are of log construction. During the 1840s or 1850s, the height of the house was raised from 1½ stories to a full two stories with frame construction, a frame ell was erected, and the Greek Revival detail was added, including the front entry, consisting of a 4-panel door flanked by detached Greek Doric fluted columns and sidelights and a transom divided into three parts by fluted blocks. The frame that surrounds the doorway, consisting of pilasters, fluted blocks and a cornice, was added when the one-story Greek Revival porch was removed c. 1950. The windows are 6/6 double-hung sash, and the cornice is ornamented with brackets across the front and gable-ends and with modillions across the back. Both brick chimneys are located in the interior of the end walls.

During a remodelling beginning in the late 1940s, the two one-story wings were added, giving the house a three-part form, and the 1½ story ell was replaced with a slightly taller ell. The key elements marking these mid-20th century additions, distinguishing them from the 19th century section of the house, are the change in window proportions, the flush gable-ends, the simple cornices, the de-emphasized foundations, the design of the open porch making up the south wing, and the design of the exterior chimney in the gable-end of the ell.

The main barn on the farm, built as a dairy barn, was located at the end of the entrance
(Continued)

Resource # Be-274
Boone County
Page 3 of 3 Pages

45. Description and House Plan: (Continued)

lane until it burned. The original frame smokehouse and an early 20th century privy have also burned, since the accompanying photographs were taken. The remaining outbuildings include a wash house, milk house, chicken coop, pig house, slave house and garage.

The contemporary wash house (brick common bond, 1-room plan, gabled with asphalt shingles, fieldstone foundation, decorative pierced bargeboards, 6/6 double-hung sash window on east, off-center door in south gable-end) was equiped with a root cellar under the floor.

The 2-car garage (frame, weatherboard, gabled with asphalt shingles, overhead doors) was built in the mid-20th century.

The milk house (concrete block, side-gabled with asphalt shingle roofing) was built c. 1943.

The chicken coop (board & batten, gabled roof, overhanging and sheltering the gable-end entry on the east) was built in the late 19th century.

The chicken house/pig house (concrete block, shed roof, asphalt shingles) has an open entry in the east wall and was built c. 1945.

The slave house, a rectangular, single-pen log house (exterior end chimney of stone and brick, door and window on the east, no openings on the west or south, collapsed wall on the north) was built at about the same time as the house and is in deteriorated condition.

All outbuildings contribute to the integrity of the propey because they illustrate the specialized uses of outbuildings in Boone County in this period and the necessity of replacing outbuildings over time.

13. Statement of Significance

The property is also significant under criterion A as a good example of a large farm in Boone County, in the period 1820-1938.

United States Department of the Interior
National Park Service

National Register of Historic Places
Continuation Sheet

Section number _____ Page _____

Multiple Resource Area
Thematic Group

Name Boone County MRA
State KENTUCKY

Nomination/Type of Review	Date/Signature
41. Hudson House <i>Entered in the National Register</i>	Keeper <u><i>Delores Byers</i></u> 2/6/89 Attest _____
42. Huey, D.W., House <i>Entered in the National Register</i>	Keeper <u><i>Delores Byers</i></u> 2/6/89 Attest _____
43. Hughes House <i>Entered in the National Register</i>	Keeper <u><i>Delores Byers</i></u> 2/6/89 Attest _____
44. Johnson, Cave, House <i>Substantive Review</i>	Keeper <u><i>Patrick Andrews</i></u> 2/6/89 Attest _____
45. Kirtley, Rev. Robert E., House <i>Entered in the National Register</i>	Keeper <u><i>Delores Byers</i></u> 2/6/89 Attest _____
46. Lassing, Morris, House <i>Substantive Review</i>	Keeper <u><i>Patrick Andrews</i></u> 6/14/90 <i>Pat</i> Attest _____
47. Loder House <i>Entered in the National Register</i>	Keeper <u><i>Delores Byers</i></u> 2/6/89 Attest _____
48. Mayhugh, John Clifton, House <i>Entered in the National Register</i>	Keeper <u><i>Delores Byers</i></u> 2/6/89 Attest _____
49. Miller, John C., House <i>Entered in the National Register</i>	Keeper <u><i>Delores Byers</i></u> 2/6/89 Attest _____
50. Miller, M., House <i>Entered in the National Register</i>	Keeper <u><i>Delores Byers</i></u> 2/6/89 Attest _____

UNITED STATES DEPARTMENT OF THE INTERIOR
NATIONAL PARK SERVICE

NATIONAL REGISTER OF HISTORIC PLACES
EVALUATION/RETURN SHEET

REQUESTED ACTION: RESUBMISSION

PROPERTY NAME: Lassing, Morris, House

MULTIPLE NAME: Boone County MRA

STATE & COUNTY: KENTUCKY, Boone

DATE RECEIVED: 5/07/90

DATE OF PENDING LIST:

DATE OF 16TH DAY:

DATE OF 45TH DAY:

6/21/90

DATE OF WEEKLY LIST:

REFERENCE NUMBER: 88003285

NOMINATOR: STATE

DETAILED EVALUATION: Y

ACCEPT RETURN REJECT 6/14/90 DATE

ABSTRACT/SUMMARY COMMENTS:

*On resubmission the period of significance
has been defined as ending in 1938*

RECOM./CRITERIA accept A&C
REVIEWER Patricia Andrews
DISCIPLINE Historian
DATE 6/14/90

DOCUMENTATION see attached comments Y/N see attached SLR Y/N

CLASSIFICATION

count resource type

STATE/FEDERAL AGENCY CERTIFICATION

FUNCTION

historic current

DESCRIPTION

architectural classification
 materials
 descriptive text

SIGNIFICANCE

Period Areas of Significance--Check and justify below

Specific dates Builder/Architect
Statement of Significance (in one paragraph)

summary paragraph
 completeness
 clarity
 applicable criteria
 justification of areas checked
 relating significance to the resource
 context
 relationship of integrity to significance
 justification of exception
 other

BIBLIOGRAPHY

GEOGRAPHICAL DATA

acreage verbal boundary description
 UTM's boundary justification

ACCOMPANYING DOCUMENTATION/PRESENTATION

sketch maps USGS maps photographs presentation

OTHER COMMENTS

Questions concerning this nomination may be directed to

_____ Phone _____

Signed _____ Date _____























MAY 7 1990

Be-274 Morris Lassing House
16/701380/431120

16/702720/4309260
Harvey A. Hicks House
Be-206

Be-205

L. B. Steph
A. 16/7041
B. 16/7041
C. 16/7031
D. 16/7039

Be-208 Hughes House
16/704220/430

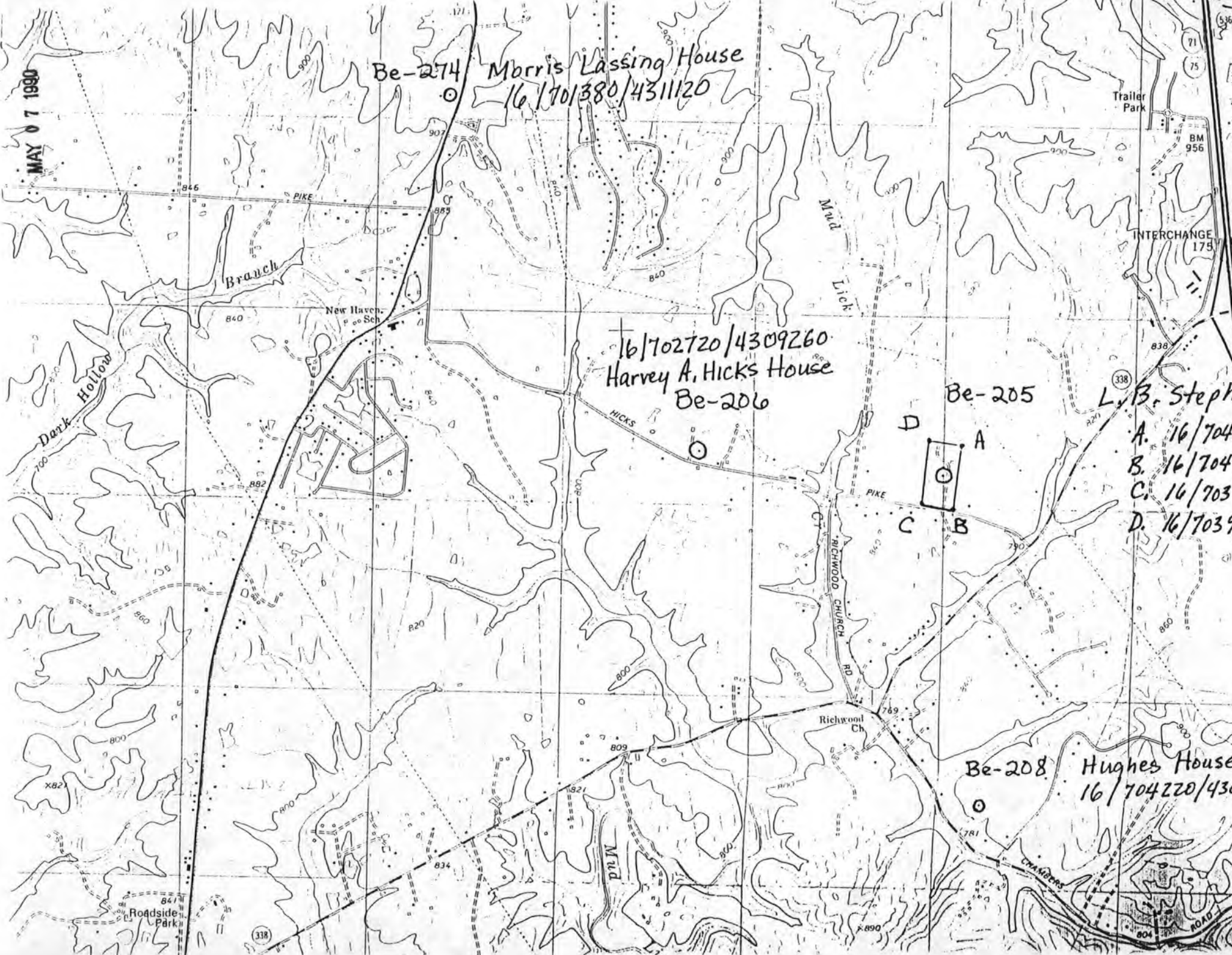

Trailer Park

BM 956

INTERCHANGE 175

New Haven Sch

HICKS

Mud Tuck

RICHWOOD CHURCH RD

Richwood Ch

Mud

CHAMBERS ROAD

Roadside Park

338

71

75

338

804

ROAD

Please refer to the map in the
Multiple Property Cover Sheet
for this property

Multiple Property Cover Sheet Reference Number: 64000206