

KENTUCKY HISTORIC RESOURCES  
Individual Inventory Form

Resource # Be-363  
Boone County

1. Name of Resource: Peters house

2. Original Owner: Unknown

3. Other Names: None

4. Prehistoric Site  Building  Object   
Historic Site  Structure  Other

5. Location: 2973 Third Street  
Petersburg, Kentucky

6. Owner's Name: Kim & Delana Peters [ ]

7. Owner's Address: 2973 Third Street  
Petersburg, KY 41080

8. Evaluation: National Register [ ]

9. Recognition & Date:  
Nat.Landmark  Local Landmark   
Nat.Register  HABS/HAER   
Highway Marker  KY Inventory 1987  
KY Landmark Certificate

10. N.R.Status & Date:

11. N.R.Group:  
District Name: [ ]  
Mult.Resource Area: Boone County [ ]  
Thematic Name: [ ]

12. Historical Theme:  
Primary: Architecture [ ]  
Secondary: [ ]  
Other: [ ]

13. Statement of Significance:  
This property is significant under criterion C as a good example of the T-form, significant to Boone County in the period 1875-1930. The house is a notable variant of the T-form in that one side (the east side, or bar of the T) was treated as a second facade, a likely response to the street-corner site. The vinyl siding [ ]

14. History: has a minimal impact on the overall form and design.

16. Date: Original Building 1880s-1890s [ ]  
Addition [ ]

17. Style: Folk Victorian [ ]  
[ ]

18. Architect/Builder: unknown

19. No. of Stories: one [ ]

20. Original Floor Plan: T [ ]

21. Single Pile  Double Pile  N.A.

22. Roof Form & Material: Original   
gable/stamped tin Not Original

23. Structural Material: wood frame [ ]

24. Exterior Material: [ ]  
wood trim/vinyl siding [ ]

25. Foundation Material: fieldstone [ ]

26. Major Alterations: None  
Moved/Rebuilt Other  (siding)  
Additions

27. Special Features: design reflects corner site

28. Outbuildings: four: 2 sheds, chicken house, stable [ ]

29. Original Function: dwelling [ ]

30. Present Use: dwelling [ ]

31. Condition: excellent [ ]

32. Endangered: Yes   
No

33. Attach Photos:  
Roll: 1 Photo Nos: 2-6 No. of Slides: 9  
14

This house is not indicated in the 1883 atlas.

15. Source of historical information and/or contact person: N/A

34. Prepared by: Kenneth T. Gibbs

35. Organization: Boone Co. Hist. Pres. Rev. Bd

36. Date: September 1986

37. New Survey  Resurvey

KENTUCKY HISTORIC RESOURCES  
Individual Inventory Form

Resource # Be-363

38. UTM Point of Primary Building: Quadrant: <u>Lawrenceburg</u>	Zone <u>16</u>	Easting <u>684805</u>	Northing <u>4326325</u>	39. G.I.S. Mod. [ ]	40. Coordi. Accuracy [ ]
---	-------------------	--------------------------	----------------------------	---------------------	--------------------------

41. UTM Points of Boundary (for N. R. eligible sites only):

A. ---	D. ---
B. ---	E. ---
C. ---	F. ---

42. Total Acreage in Present Property: <u>0.546</u>	43. Acreage included in proposed N.R. boundary: <u>0.546</u>
---	--

44. Site Plan (and boundary description and justification for N.R. sites):

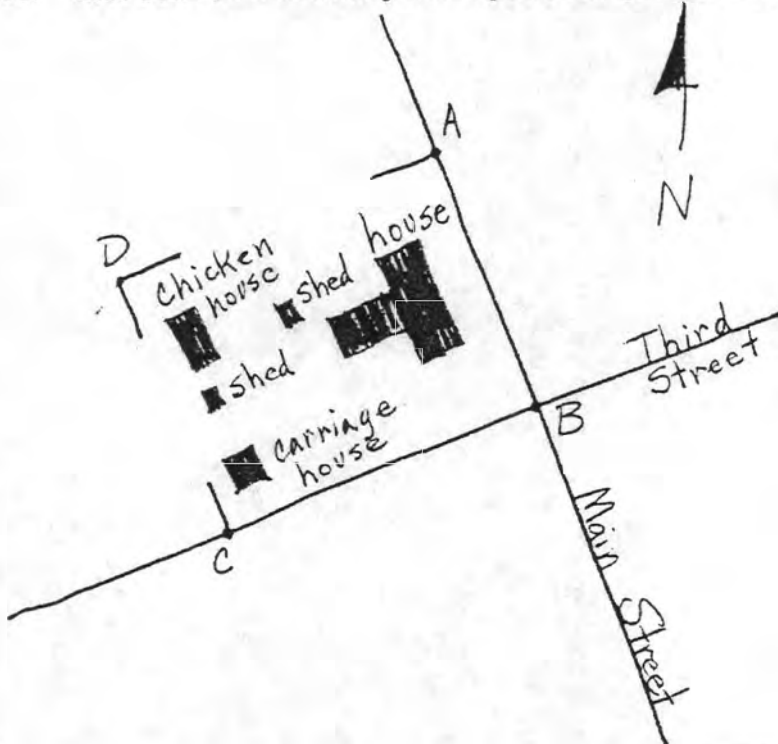

The nominated property occupies city lots 117 and 118 and is roughly 140' x 170' in size. The boundary rectangle, shown by the points A, B, C, and D, includes the house, all four outbuildings and the entire city lots (117 & 118) historically associated with the property. The outbuildings are included as contributing resources since they help to define the domestic character of the dwelling during the period of significance.

Contributing: 5 buildings

45. Description and House Plan:

The treatment of this one-story house reflects its corner site: the principal facade (south) has the appearance of a typical one-story T-form house, while the east side, given its own three-bay porch and central door, has the appearance of a hall-parlor house, another popular form in Petersburg. Cornice moldings are found at the eaves, at all three gables, around both porches, around the semi-octagonal projecting bay, and over all the openings. Each gable features a hinged attic ventilator. The doors, lighted in the upper portion, and the window sashes, consisting of either one or two panes, are original, as is the turned and jigsawed wooden ornament of both porches. Although integrity of materials was compromised by the very recent use of vinyl siding, care was evidently taken to leave the wooden trim that gives the house much of its character and period associations.

The four outbuildings are all of wood frame construction. One has board-and-batten sheathing, and one is shed-roofed, but otherwise they are gabled with weatherboarding. Their uses are unknown, but they may include a carriage house, chicken house and tool shed. They are all contemporary with the house and contribute to its significance and setting.

United States Department of the Interior  
National Park Service

National Register of Historic Places  
Continuation Sheet

Section number \_\_\_\_\_ Page \_\_\_\_\_

Multiple Resource Area  
Thematic Group

Name Boone County MRA  
State KENTUCKY

Nomination/Type of Review	Date/Signature
51. Norman, L.C., House <i>Entered in the National Register</i>	Keeper <u>Melores Byers</u> 2/6/89 Attest _____
52. Parker, Richard, House <i>Entered in the National Register</i>	Keeper <u>Melores Byers</u> 2/6/89 Attest _____
53. Peters House <i>Entered in the National Register</i>	Keeper <u>Melores Byers</u> 2/6/89 Attest _____
54. Prospect Farm <i>Substantive Review</i>	for Keeper <u>Patrick Andrus</u> 2/6/89 Attest _____
55. Rabbit Hash General Store <i>Substantive Review</i>	for Keeper <u>Patrick Andrus</u> 2/6/89 Attest _____
56. Ransom House <i>Entered in the National Register</i>	for Keeper <u>Melores Byers</u> 2/6/89 Attest _____
57. Rogers, James, House <i>Entered in the National Register</i>	for Keeper <u>Melores Byers</u> 2/6/89 Attest _____
58. Ryle's Super Market and Oddfellows Building <i>Entered in the National Register</i>	for Keeper <u>Melores Byers</u> 2/6/89 Attest _____
59. Terrill, George H., House <i>Entered in the National Register</i>	for Keeper <u>Melores Byers</u> 2/6/89 Attest _____
60. Uitz, Ephraim, House <i>Substantive Review</i>	for Keeper <u>Patrick Andrus</u> 6/14/90 Attest _____

SRK

DCP

UNITED STATES DEPARTMENT OF THE INTERIOR  
NATIONAL PARK SERVICE

NATIONAL REGISTER OF HISTORIC PLACES  
EVALUATION/RETURN SHEET

REQUESTED ACTION: NOMINATION

PROPERTY NAME: Peters House

MULTIPLE NAME: Boone County MRA

STATE & COUNTY: KENTUCKY, Boone

DATE RECEIVED: 12/28/88      DATE OF PENDING LIST: 1/10/89  
DATE OF 16TH DAY: 1/26/89      DATE OF 45TH DAY: 2/11/89  
DATE OF WEEKLY LIST:

REFERENCE NUMBER: 88003298

NOMINATOR: STATE

REASONS FOR REVIEW:

APPEAL: N    DATA PROBLEM: N    LANDSCAPE: N    LESS THAN 50 YEARS: N  
OTHER: N    PDIL: N    PERIOD: N    PROGRAM UNAPPROVED: N  
REQUEST: N    SAMPLE: N    SLR DRAFT: N    NATIONAL: N

COMMENT WAIVER: N

ACCEPT     RETURN     REJECT    2/6/89 DATE

Entered in the  
National Register

ABSTRACT/SUMMARY COMMENTS:

RECOM./CRITERIA \_\_\_\_\_  
REVIEWER \_\_\_\_\_  
DISCIPLINE \_\_\_\_\_  
DATE \_\_\_\_\_

DOCUMENTATION see attached comments Y/N see attached SLR Y/N

---

CLASSIFICATION

count       resource type

---

STATE/FEDERAL AGENCY CERTIFICATION

---

FUNCTION

historic       current

---

DESCRIPTION

architectural classification  
 materials  
 descriptive text

---

SIGNIFICANCE

Period      Areas of Significance--Check and justify below

Specific dates      Builder/Architect  
Statement of Significance (in one paragraph)

summary paragraph  
 completeness  
 clarity  
 applicable criteria  
 justification of areas checked  
 relating significance to the resource  
 context  
 relationship of integrity to significance  
 justification of exception  
 other

---

BIBLIOGRAPHY

---

GEOGRAPHICAL DATA

acreage       verbal boundary description  
 UTM's       boundary justification

---

ACCOMPANYING DOCUMENTATION/PRESENTATION

sketch maps     USGS maps     photographs     presentation

---

OTHER COMMENTS

Questions concerning this nomination may be directed to

\_\_\_\_\_  
Signed \_\_\_\_\_ Phone \_\_\_\_\_  
Date \_\_\_\_\_







2975





Please refer to the map in the  
Multiple Property Cover Sheet  
for this property

Multiple Property Cover Sheet Reference Number: 64000206