

United States Department of the Interior
National Park Service

National Register of Historic Places
Registration Form

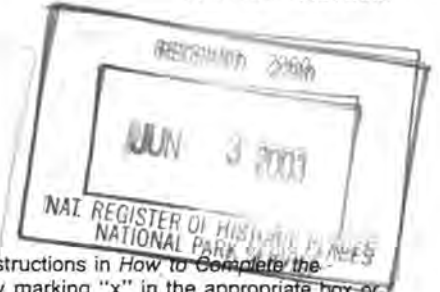

This form is for use in nominating or requesting determinations for individual properties and districts. See instructions in *How to Complete the National Register of Historic Places Registration Form* (National Register Bulletin 16A). Complete each item by marking "x" in the appropriate box or by entering the information requested. If an item does not apply to the property being documented, enter "N/A" for "not applicable." For functions, architectural classification, materials, and areas of significance, enter only categories and subcategories from the instructions. Place additional entries and narrative items on continuation sheets (NPS Form 10-900a). Use a typewriter, word processor, or computer, to complete all items.

1. Name of Property

historic name George W. Barkley Farm

other names/site number BK21

2. Location

street & number Route #1, Box 150 NA not for publication

city or town Augusta vicinity

state Kentucky code KY county Bracken code 023 zip code 41002

3. State/Federal Agency Certification

As the designated authority under the National Historic Preservation Act, as amended, I hereby certify that this nomination request for determination of eligibility meets the documentation standards for registering properties in the National Register of Historic Places and meets the procedural and professional requirements set forth in 36 CFR Part 60. In my opinion, the property meets does not meet the National Register criteria. I recommend that this property be considered significant nationally statewide locally. (See continuation sheet for additional comments.)
David L. Morgan, SHPO and
executive director 3-04-03
Signature of certifying official/Title Date
State Historic Preservation Office: Kentucky Heritage Council
State of Federal agency and bureau

In my opinion, the property meets does not meet the National Register criteria. (See continuation sheet for additional comments.)

Signature of certifying official/Title Date

State or Federal agency and bureau

4. National Park Service Certification

I hereby certify that the property is:

- entered in the National Register.
 See continuation sheet.
- determined eligible for the National Register
 See continuation sheet.
- determined not eligible for the National Register.
- removed from the National Register.
- other, (explain:)

David L. Morgan Signature of the Keeper
June 18, 2003 Date of Action

George W. Barkley Farm

Name of Property

Bracken, Kentucky

County and State

5. Classification

Ownership of Property

(Check as many boxes as apply)

- private
- public-local
- public-State
- public-Federal

Category of Property

(Check only one box)

- building(s)
- district
- site
- structure
- object

Number of Resources within Property

(Do not include previously listed resources in the count.)

Contributing	Noncontributing	
0	2	buildings
1		sites
		structures
		objects
1	2	Total

Name of related multiple property listing

(Enter "N/A" if property is not part of a multiple property listing.)

N/A

Number of contributing resources previously listed in the National Register

0

6. Function or Use

Historic Functions

(Enter categories from instructions)

AGRICULTURE/SUBSISTENCE/ agricultural field

Current Functions

(Enter categories from instructions)

AGRICULTURE/SUBSISTENCE/ agricultural field

7. Description

Architectural Classification

(Enter categories from instructions)

N/A

Materials

(Enter categories from instructions)

foundation N/A

walls N/A

roof N/A

other

Narrative Description

(Describe the historic and current condition of the property on one or more continuation sheets.)

**United States Department of the Interior
National Park Service**

**National Register of Historic Places
Continuation Sheet**

Section Number 7 Page 1

Barkley, George W., Farm

(BK-21) Bracken County, Kentucky

Description

The original farm owned by George W. Barkley is now divided among a number of owners. In 1860, the farm was estimated at approximately 400 acres (mostly bottom land along the Ohio River), and the census gives the value of George Barkley's land as \$5,000 (one of the largest amounts in Bracken County). The locations of the original farmhouses have been lost, though there is speculation that one was located near the river and destroyed by a flood. Remains of another home are near the property, but only a stone chimney is left standing. The part of the property that the surveyors felt was an appropriate site for nomination was the location of the farmhouse built by George Barkley's son, Colonel William E. Barkley in 1908. Colonel Barkley was an extremely important person in the development of the local community. He was President and major stockholder of at least three banks in Augusta, as well as the impetus behind bringing the telephone to Bracken County. His home is now on 11 acres owned by Eugene Hargett, who claims that he bought the farm from an adopted daughter of William Barkley, a Mrs. Pogue (personal conversation). A set of railroad tracks bisect the farm, and were built around the turn of the century. The current farm runs from the tracks to Route 8 (approximately one-quarter of a mile) and extends along the tracks long enough to make 11 acres. Due to the character of the bottom land, most of it is still in use for row crops, mostly corn and tobacco. The portion of the property being considered for nomination is also currently planted in corn and tobacco.

**United States Department of the Interior
National Park Service**

**National Register of Historic Places
Continuation Sheet**

Section Number 7 Page 2

Barkley, George W., Farm

(BK-21) Bracken County, Kentucky

Beyond the tracks is part of the original farm that includes very large bottom land all the way to the river (one-half mile). This property is the possession of another land owner.

The Structures

The 1908 house is a two story center passage, double pile farmhouse. It has simple fenestration which includes one-over-one windows, a colonial porch, and plain entablature. There is a rear entrance and a small porch on the west elevation. The house is five-bay with a 1/1 sash and Doric columns supporting the porch with decorative panels cast in concrete piers under the porch.

The barn has mortise and tenon joints with wooden pegs used as the main fasteners. The walls are vertical board, and the pier foundation (tenuous as it is) is made up of field stone and concrete block. The support posts are hand hewn. The gable roof consists of wooden slats covered with corrugated tin. There is a front sliding door and a rear hinged door. Oddly enough, the center bay is tiered perpendicular to the gable while the side bays are tiered parallel to the gable. There are six bents and three bays. The front three bents on the right and the front two bents on the left have been enclosed, and the barn has been wired for electricity. The barn is four tiers high in the center, and according to the owner, the barn is as old as the house. Mr. Hargett also claims that the Ohio River flood of 1937 moved the barn to its present location,

**United States Department of the Interior
National Park Service**

**National Register of Historic Places
Continuation Sheet**

Section Number 7 **Page** 3

Barkley, George W., Farm

(BK-21) Bracken County, Kentucky

which accounts for some of its dilapidated condition.

There is also a wooden carport on the property near the house that seems to be as old as the house itself. No real evidence could be found as to its origin. Mr. Hargett also stated that near the railroad tracks there was originally a train depot, of which the surveyors could find no trace.

8. Statement of Significance

Applicable National Register Criteria

(Mark "x" in one or more boxes for the criteria qualifying the property for National Register listing.)

- A Property is associated with events that have made a significant contribution to the broad patterns of our history.
- B Property is associated with the lives of persons significant in our past.
- C Property embodies the distinctive characteristics of a type, period, or method of construction or represents the work of a master, or possesses high artistic values, or represents a significant and distinguishable entity whose components lack individual distinction.
- D Property has yielded, or is likely to yield, information important in prehistory or history.

Criteria Considerations

(Mark "x" in all the boxes that apply.)

Property is:

- A owned by a religious institution or used for religious purposes.
- B removed from its original location.
- C a birthplace or grave.
- D a cemetery.
- E a reconstructed building, object, or structure.
- F a commemorative property.
- G less than 50 years of age or achieved significance within the past 50 years.

Areas of Significance

(Enter categories from instructions)

Agriculture

Period of Significance

1864-1865

Significant Dates

1864; 1865

Significant Person

(Complete if Criterion B is marked above)

N/A

Cultural Affiliation

N/A

Architect/Builder

N/A

Narrative Statement of Significance

(Explain the significance of the property on one or more continuation sheets.)

9. Major Bibliographical References

Bibliography

(Cite the books, articles, and other sources used in preparing this form on one or more continuation sheets.)

Previous documentation on file (NPS):

- preliminary determination of individual listing (36 CFR 67) has been requested
- previously listed in the National Register
- previously determined eligible by the National Register
- designated a National Historic Landmark
- recorded by Historic American Buildings Survey # _____
- recorded by Historic American Engineering Record # _____

Primary location of additional data:

- State Historic Preservation Office
- Other State agency
- Federal agency
- Local government
- University
- Other

Name of repository:

Maysville-Mason Museum
University of Kentucky
Kentucky Heritage Council

United States Department of the Interior
National Park Service

National Register of Historic Places
Continuation Sheet

Section Number 8 Page 1

Barkley, George W., Farm

(BK-21) Bracken County, Kentucky

Statement of Significance

The George W. Barkley Farm (BK-21) meets National Register criterion A. The farm is significant in Kentucky's agricultural history in association with an event: it is the site of first cultivation of White Burley tobacco. The Period of Significance of 1864-1865 has been chosen to recognize the two growing seasons when the plant was conceived and successfully harvested, giving the farm its most compelling claim to statewide significance. Prior to the 1860s, Kentucky had been a national leader in tobacco production, growing a dark, smoke-cured tobacco in the western part of the state used for chewing and pipe and cigar smoking. This nomination's historic context, "The Development of White Burley Tobacco, 1860-1880" discusses the early expansion of the new strain of tobacco into the central part of the state. For nearly two decades, Bluegrass farmers gave White Burley little more than passing attention, but in the early 1880s the crop transformed that region's agricultural landscape. Barkley and his descendents farmed and grew tobacco into the 20th century, however their role in the dissemination of White Burley tobacco from Bracken County on the Ohio River, to the inland counties of the Bluegrass region, has not been recognized by historians. While the Barkley family had a lengthy local prominence as Bracken County farmers, their farm's significance at a *statewide* level comes from the development of this new form of tobacco in 1864-1865.

The Development of White Burley Tobacco, 1860-1880

White Burley, now just "burley", the largest of America's leaf crops, had a rather inauspicious beginning at this then relatively large farm on the Ohio River. George Barkley's father settled in Kentucky in 1796 on a farm near Augusta, the remains of which now surround the farm being considered for nomination. It was, however, George Barkley himself who would gain national prominence as a tobacco farmer.

His rise to notoriety began on a spring day in 1864 when two tenant farmers, George Webb and Joseph Fore, ran short of tobacco seed for their farm in Brown County, Ohio. They crossed the Ohio River to get seed from Barkley. As the seedlings grew, they were sturdy and fine textured, but the dirty yellow appearance of the leaf prompted the tenants to destroy the plants, believing them unhealthy or dwarfed.

**United States Department of the Interior
National Park Service**

**National Register of Historic Places
Continuation Sheet**

Section Number 8 Page 2

Barkley, George W., Farm

(BK-21) Bracken County, Kentucky

This was not, however, the end of Barkley's hybrid seed. The following year Webb transplanted one thousand of the plants on his own farm. Allowed to grow to maturity the plants were very healthy and had a cream-colored stalk. Once cured the leaf was bright yellow and smoked "bitter"--dry and lacking the heavy load of natural sweeteners found in other burley strains. It brought an excellent price in the Cincinnati market, won first and second prizes for cutting leaf at the 1867 St. Louis Fair, and brought the amazing price of \$58 a hundredweight.

White Burley quickly replaced the gummy red burley throughout central Kentucky because of a variety of reasons: it was harvested more quickly by stalk-cutting, it required only air for curing (not the flue or smoke curing of the red burley), and it cured more rapidly. All of these factors combined to allow the crop to be brought to market more quickly, a decided advantage to poor farmers in Kentucky.

It is difficult to overestimate the importance of White Burley for the culture of Kentucky. With the advent of cigarette blends using burley in 1913 the crop became practically the sole source of income for many small farmers in the state. By the mid-1960s over 34% of any given blend world-wide was American burley, and Kentucky was by far America's largest producer of burley. The repercussions of the seed developed on this farm in Bracken County have been felt for over 130 years. The advent of White Burley boosted Kentucky production, and it was and still is the key crop of the Bluegrass region (Tobacco Institute 43). Figures from the 1850, 1860, and

**United States Department of the Interior
National Park Service**

**National Register of Historic Places
Continuation Sheet**

Section Number 8 Page 3

Barkley, George W., Farm

(BK-21) Bracken County, Kentucky

1880 agricultural censuses show the pattern of production in the state. For the year ending June 1, 1850, Kentucky produced 55,501,196 pounds of tobacco. During this time the dark, fire-cured tobacco of Western Kentucky was most prominent, with Christian, (6,312,076 lbs) , Henderson, (4,292,960 lbs), and Daviess (3,426,633 lbs) counties topping the production list. The 1860 census reports the state producing 103,126,810 pounds, with the greatest concentration still in Christian (11,409,016 lbs), Daviess (5,303,470 lbs), and Todd (4,964,796 lbs), all dark tobacco counties. Figures from the 1880 census show the increase in output of all counties, with White Burley counties increasing from under a million pounds to an output of two to six million pounds, as with Bracken, Mason, and Harrison counties. Acreage of production increased in this time as well. The total of 142,000 tobacco-producing acres in 1866 grew to 320,000 in 1875 (Tobacco Institute 45). The thirteen Bluegrass counties-- Anderson, Bourbon, Boyle, Clark, Fayette, Franklin, Garrard, Harrison, Jessamine, Madison, Mercer, Scott, and Woodford--produced 518, 264 pounds of tobacco in 1870, garnering 17% of the state's production revenues (Amos 132). The growing popularity of cigarettes during the last decades of the nineteenth century lead to increase in production. The thirteen Bluegrass counties produced an incredible 4,757,640 pounds in 1899 (Amos 136).

By comparing a series of statistics one can arrive at a reasonable conclusion as to what are typical or atypical tobacco farms. For example, the 1860 census lists the farm of George Barkley (the originator of White Burley seed) in Bracken County as

**United States Department of the Interior
National Park Service**

**National Register of Historic Places
Continuation Sheet**

Section Number 8 Page 4

Barkley, George W., Farm

(BK-21) Bracken County, Kentucky

being worth \$5,000 with approximately 400 acres. The typical outer Bluegrass *county* in 1919 cultivated between 6,000 and 9,000 acres, giving some indication as to how important Barkley's farm must have been (Davis 85). Also, by 1919 Kentucky was producing 456,500,000 pounds of tobacco (Davis 84). By comparing this figure with the fact that in 1919 the typical outer Bluegrass county was producing approximately 20,000 pounds of tobacco per square mile, and the typical inner Bluegrass county was producing between 50,000 and 70,000 pounds of tobacco, one can see both the importance of the crop for the region and the relative importance of individual farms (Davis 85).

Information concerning the original strains of White Burley has been rather difficult to obtain. Most of the sources that deal with George Barkley in any more than a cursory manner are found in a file of unattributed newspaper articles in the files of the Maysville-Mason County Museum, Maysville, Kentucky. While the information proved invaluable, due to the disorganized nature of these articles it is impossible to cite them individually. The research has been unable to uncover specific documentation that addresses exactly what Barkley was doing to develop this strain of tobacco. For example, we do not know if the development of White Burley was an accident or if it was the culmination of a long process of hybridization. All of the research does point, however, to Barkley and the tenant farmers as being the first to discover the plant.

**United States Department of the Interior
National Park Service**

**National Register of Historic Places
Continuation Sheet**

Section Number 9 Page 1

Barkley, George W., Farm

(BK-21) Bracken County, Kentucky

Major Bibliographic References

Amos, Christine A. The Bluegrass Cultural Landscape Regional: A Historic Overview. 1988.

This report provides a number of interesting details about the cultural landscape of the Bluegrass region; however, the subject of tobacco is only a small portion of the discussion. A variety of useful production statistics are to be found here.

Davis, Darrell Haug. Geography of the Blue Grass Region. Frankfort, Kentucky: The Kentucky Geological Survey, 1927.

An extremely useful discussion of both the landscape and the crop production of the Bluegrass region. The most useful section was a statistical discussion of tobacco production.

The Tobacco Institute, Inc. Kentucky and Tobacco: A Chapter in America's Industrial Growth. Washington D.C.: The Tobacco Institute Inc., 1962.

A small but highly informative pamphlet that included general definitions, production statistics, and historical details.

Unpublished References

Parker, Elizabeth. Bracken County Historian. Phone: (606) 756-2101.

**United States Department of the Interior
National Park Service**

**National Register of Historic Places
Continuation Sheet**

Section Number 9 Page 2

Barkley, George W., Farm

(BK-21) Bracken County, Kentucky

Ms. Parker was extremely helpful in verifying the validity of the property owned by Eugene Hargett as appropriate for nomination.

Maysville-Mason County Museum. Genealogical Library. Phone (606) 564-5865.

Various unattributed newspaper articles were found in the vertical file, dealing both with a general history of tobacco in the area and the Barkley farm in particular.

George W. Barkley Farm
Name of Property

Bracken, Kentucky
County and State

10. Geographical Data

Acreage of Property approximately 11

UTM References

(Place additional UTM references on a continuation sheet.)

1	17	242310	4296100	Higginsport Quad	3	17	242260	4295920
Zone	Easting	Northing	Zone		Easting	Northing		
2	17	242400	4295940		4	17	242240	4296080

See continuation sheet

Verbal Boundary Description

(Describe the boundaries of the property on a continuation sheet.)

Boundary Justification

(Explain why the boundaries were selected on a continuation sheet.)

11. Form Prepared By

name/title Terri Boggs, Mac Cooley, John DeAtley, Kathy Siler

organization Centre College date July 21, 1995

street & number 625 W. Walnut St. telephone (606) 238-5244

city or town Danville state Ky. zip code 40422

Additional Documentation

Submit the following items with the completed form:

Continuation Sheets

Maps

A USGS map (7.5 or 15 minute series) indicating the property's location.

A Sketch map for historic districts and properties having large acreage or numerous resources.

Photographs

Representative black and white photographs of the property.

Additional items

(Check with the SHPO or FPO for any additional items)

Property Owner

(Complete this item at the request of SHPO or FPO.)

name Eugene Hargett

street & number Box 150 Route #1 telephone (606) 756-2345

city or town Augusta state Ky. zip code 41002

Paperwork Reduction Act Statement: This information is being collected for applications to the National Register of Historic Places to nominate properties for listing or determine eligibility for listing, to list properties, and to amend existing listings. Response to this request is required to obtain a benefit in accordance with the National Historic Preservation Act, as amended (16 U.S.C. 470 *et seq.*).

Estimated Burden Statement: Public reporting burden for this form is estimated to average 18.1 hours per response including time for reviewing instructions, gathering and maintaining data, and completing and reviewing the form. Direct comments regarding this burden estimate or any aspect of this form to the Chief, Administrative Services Division, National Park Service, P.O. Box 37127, Washington, DC 20013-7127; and the Office of Management and Budget, Paperwork Reductions Projects (1024-0018), Washington, DC 20503.

**United States Department of the Interior
National Park Service**

**National Register of Historic Places
Continuation Sheet**

Section Number 10 Page 1

Barkley, George W., Farm

(BK-21) Bracken County, Kentucky

Verbal Boundary Description

See PVA Map; the property is designated as parcel 7 of Bracken County Property Valuation Assessor map #57

Boundary Justification

Although George W. Barkley's original farm contained over 400 acres, the most logical contemporary site for nomination is the eleven acres on which Colonel William Barkley's house now stands. This is the only site on the 400 acres that contains structures built by members of the original family. Also, documentation suggests that Webb and Fore crossed the Ohio River on a ferry from Higginsport, Ohio, which is directly across the river from the eleven acres currently owned by Eugene Hargett. A local historian, Ms. Elizabeth Parker, confirmed in a conversation with Marty Perry that the property owned by Hargett contains a tobacco field that has been in relative continuous use since Barkley began growing tobacco on the farm. She also believes that this property is undoubtedly the proper site for nomination.

OHIO RIVER

OPEN FIELDS

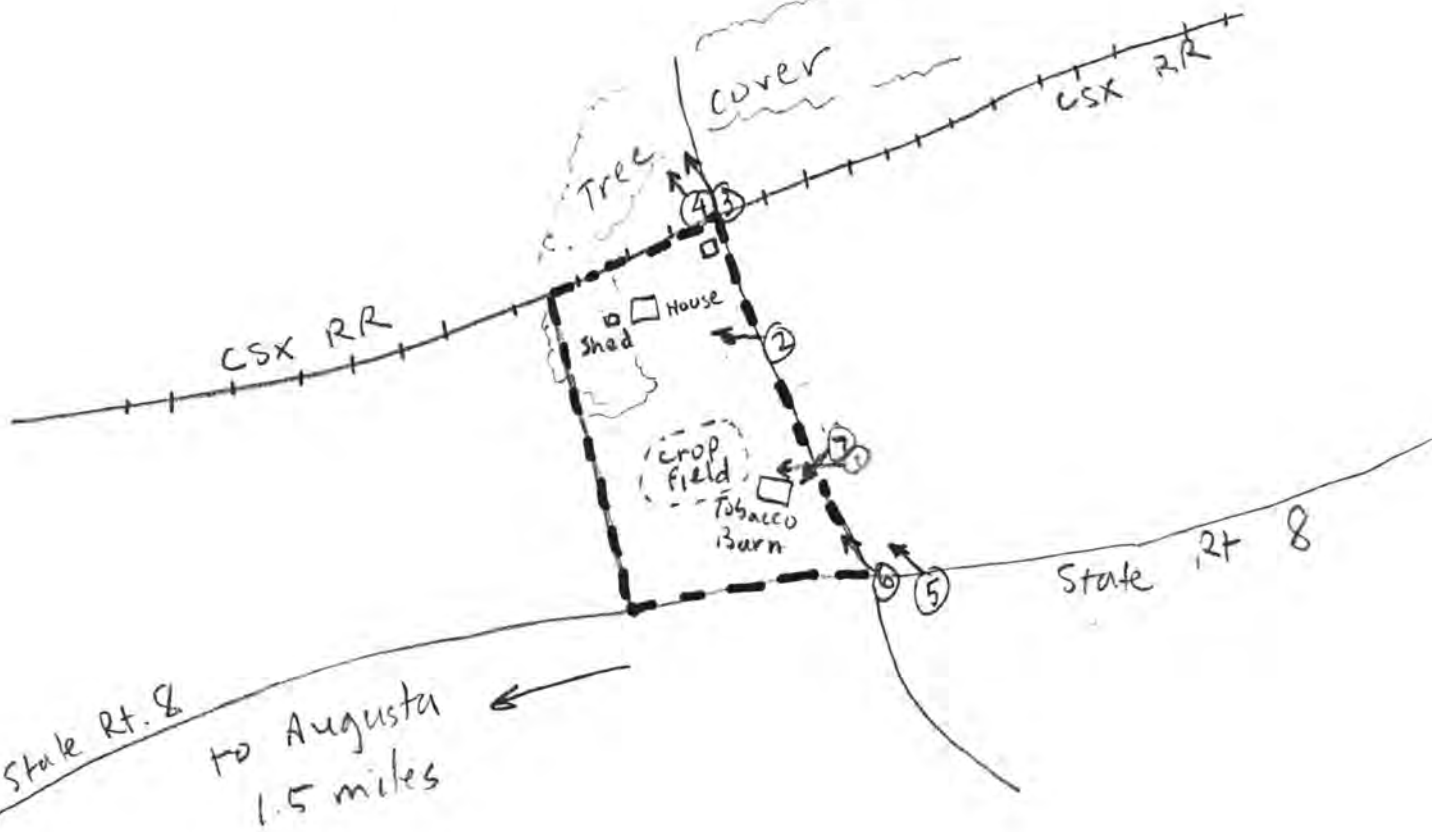

Approximate scale 1" = 330'

George W. Barkley Farm
Bracken Co., Ky

Sketch map & Photo identification

--- = area proposed for listing

United States Department of the Interior
National Park Service

National Register of Historic Places
Continuation Sheet

Section Number photos Page 1

Barkley, George W., Farm

(BK-21) Bracken County, Kentucky

Photographic Identification Sheet

Same information for all photos:

Name: George Barkley Farm

Location: Bracken County, KY

Photographer: Marty Perry

Date: January, 2003

Location of Negatives: Kentucky Heritage Council, 300 Washington Street, Frankfort, KY 40601

Photograph-specific information:

Photo #	Photo Direction and Content:
Photo 1:	to west: tobacco field at center, tobacco barn at left
Photo 2:	to west: shed behind house
Photo 3:	to northwest: view of fields toward Ohio River taken from CSX tracks. Hills of Ohio in distance
Photo 4:	to northwest: closer view of fields shown in Photo 3
Photo 5:	to northwest: overview shot of farm from State Route 8
Photo 6:	to northwest: view of main house, CSX railroad tracks in the rear
Photo 7:	to southwest: tobacco barn; gable side faces eastward

Recommendation: SLR Return

Action: SLR Return None

DOCUMENTATION ISSUES—DISCUSSION SHEET

STATE NAME: KY COUNTY NAME Benton RESOURCE NAME Parkley, Geo., Farm

REFERENCE NO. 03-259 MULTIPLE NAME _____

Solution:

PROBLEM: There is only one UTM on the map. There should be four. The map has not been matched up with the farm. The boundary justification says "this part of the original 400 acre farm is because of the house. In the resource count the house is not there. By the notation it is outside the PofS for the resource. But how do we know this is where White Parkley was created. ~~There is no description of the site~~ There is no description of the site. House stood - n

RESOLUTION:

SLR: Yes No

DATABASE CHANGE: _____

UNITED STATES DEPARTMENT OF THE INTERIOR
NATIONAL PARK SERVICE

NATIONAL REGISTER OF HISTORIC PLACES
EVALUATION/RETURN SHEET

REQUESTED ACTION: NOMINATION

PROPERTY NAME: Barkley, George W., Farm

MULTIPLE
NAME:

STATE & COUNTY: KENTUCKY, Bracken

DATE RECEIVED: 3/06/03 DATE OF PENDING LIST: 4/02/03
DATE OF 16TH DAY: 4/18/03 DATE OF 45TH DAY: 4/20/03
DATE OF WEEKLY LIST:

REFERENCE NUMBER: 03000259

REASONS FOR REVIEW:

APPEAL: N DATA PROBLEM: N LANDSCAPE: N LESS THAN 50 YEARS: N
OTHER: N PDIL: N PERIOD: N PROGRAM UNAPPROVED: N
REQUEST: N SAMPLE: N SLR DRAFT: Y NATIONAL: N

COMMENT WAIVER: N

 ACCEPT RETURN REJECT _____ DATE

ABSTRACT/SUMMARY COMMENTS:

*Return. Please see
attached comments.*

RECOM./CRITERIA _____

REVIEWER Daniel Vivian DISCIPLINE Historian

TELEPHONE (202) 354-2252 DATE 4/16/03

DOCUMENTATION see attached comments (Y)N see attached SLR Y/N

RECEIVED
MAY 7 2005
KY HERITAGE
COUNCIL

**The United States Department of the Interior
National Park Service**

**National Register of Historic Places
Evaluation/Return Sheet**

Property Name: George W. Barkley Farm
Bracken County, Kentucky

Reference Number: 02000259

Reason for Return:

This nomination is being returned because of technical errors and questions concerning the significance of the property. Based on the information provided, the property appears to be significant in the agricultural history of Bracken County, Kentucky. It is unclear, however, if the period of significance selected, 1864-1880, is appropriate. Certainly this was the period in which George Barkley became significant as the source of White Burley tobacco seed, but did the farm continue to be significant after 1880? The information provided does not specify whether 1880 was selected as the end date of the period arbitrarily or because of a historical event. Since the farm remained in the Barkley Family into the twentieth century, most notably under the management of Colonel William E. Barkley, George Barkley's son and "an extremely important person in the development of the local community" (Sec. 7, p. 1), is it possible that its significance continued? Or did the property achieve significance in other areas, perhaps for its association with Colonel William Barkley (Criterion B)? The nomination convincingly demonstrates that the property is significant under Criterion A in the area of agriculture; these comments are provided only to assist with revisions that you may wish to undertake but which are not necessary for the property to be listed. If upon reevaluation it is determined that the significance of the property continued into the twentieth century, it may be possible for the 1908 farmhouse and the barn, which evidently dates from the same period, to be counted as contributing resources.

Under Section 10 of the registration form, only one UTM reference has been entered. For properties of 10 or more acres, the National Register guidelines require three or more UTM references. The rectangular form of the nominated property suggests that a UTM reference should be recorded at each corner. Please revise this section of the nomination so it includes the

required number of UTM references.

Please feel free to contact me if you have any questions. You may reach me at (202) 354-2252 or by email at <Dan_Vivian@nps.gov>. We look forward to receiving a revised nomination.

Daniel Vivian, Historian
National Register of Historic Places

April 16, 2003

UNITED STATES DEPARTMENT OF THE INTERIOR
NATIONAL PARK SERVICE

NATIONAL REGISTER OF HISTORIC PLACES
EVALUATION/RETURN SHEET

REQUESTED ACTION: RESUBMISSION

PROPERTY NAME: Barkley, George W., Farm

MULTIPLE NAME:

STATE & COUNTY: KENTUCKY, Bracken

DATE RECEIVED: 6/03/03 DATE OF PENDING LIST:
DATE OF 16TH DAY: DATE OF 45TH DAY: 7/18/03
DATE OF WEEKLY LIST:

REFERENCE NUMBER: 03000259

DETAILED EVALUATION:

ACCEPT RETURN REJECT _____ DATE

ABSTRACT/SUMMARY COMMENTS:

The George W. Barkley Farm is significant in a statewide context under Criterion A for its agricultural significance as the site where white burley tobacco was first cultivated. In 1864-1865, George Barkely successfully grew and harvested the crop that eventually became known as "burley." Kentucky farmers had previously grown a dark, smoke-cured tobacco; in the 1880s many switched to burley tobacco, which transformed the agricultural landscape of Kentucky in the following decades. Burley gained favor because it was easier to harvest and could be air-cured, and its widespread adoption boosted tobacco production in Kentucky. Today, it remains a key crop in the Bluegrass Region. As the site of the first cultivation and harvesting of burley, the Barkely Farm is significant in the agricultural history of Kentucky. It retains integrity from its period of significance.

RECOM./CRITERIA A

REVIEWER Daniel Vivian

DISCIPLINE Historian

TELEPHONE (202)354-2252

DATE June 18, 2003

DOCUMENTATION see attached comments Y/ see attached SLR Y/



Barkley, George W., Farm

Bracken Co., Ky

①



Barkley, George W., Farm

Bracken Co., KY

(2)



Barkley, George W., Farm

Bracken Co., Ky



Barkley, George W., Farm Bracken Co., KY



Barkley, George W., Farm

Bracken Co., KY

5



Barkley, George W., Farm

Bracken Co., KY

(6)



Barkley, George W., farm

Bracken Co., KY

⑦



Bar Kley, George, Farm
Brocken Co., KY
ZONE: 17
Easting/Northing
1: 242 310/4246 100
2: 242 400/4245 940
3: 242 260/4245 920
4: 242 240/4246 080

Mapped, edited, and published by the Geological Survey
Kentucky area mapped in cooperation with State of Kentucky
Geological Survey
Control by USGS, USC&GS, and USCE
Topography in Ohio by photogrammetric methods from aerial
photographs taken 1960. Field checked 1961
Topography in Kentucky by photogrammetric methods from aerial
photographs taken 1950. Field checked 1952. Revised 1961
Polyconic projection: 1927 North American datum. 10,000-foot grids
based on Ohio coordinate system, south zone, and Kentucky coordinate
system, north zone. 1000-metre Universal Transverse Mercator grid
ticks, zone 17, shown in blue
Fine red dashed lines indicate selected fence and field lines where
generally visible on aerial photographs. This information is unchecked
The state boundary as shown represents the approximate position
of the low water line as determined from U. S. Corps of Engineers
Ohio River charts, surveyed 1913, and supplementary information
Ohio area lies within the Virginia Military District

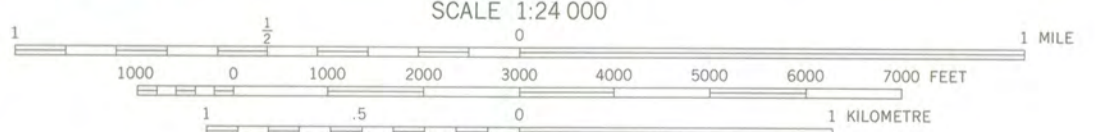
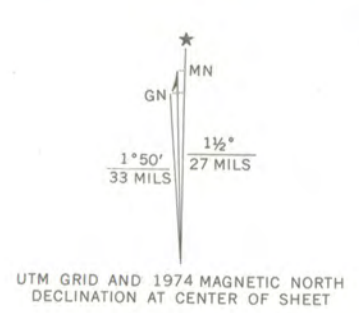

CONTOUR INTERVAL 20 FEET
DOTTED LINES REPRESENT 10-FOOT CONTOURS
NATIONAL GEODETIC VERTICAL DATUM OF 1929

THIS MAP COMPLIES WITH NATIONAL MAP ACCURACY STANDARDS
FOR SALE BY U. S. GEOLOGICAL SURVEY, RESTON, VIRGINIA 22092
KENTUCKY GEOLOGICAL SURVEY, LEXINGTON, KENTUCKY 40506,
AND KENTUCKY DEPARTMENT OF COMMERCE, FRANKFORT, KENTUCKY 40601
A FOLDER DESCRIBING TOPOGRAPHIC MAPS AND SYMBOLS IS AVAILABLE ON REQUEST



ROAD CLASSIFICATION

Heavy-duty	Light-duty
Medium-duty	Unimproved dirt
U. S. Route	State Route

HIGGINSPORT, OHIO-KY.
N3845-W8352.5/7.5

1961
PHOTOREVISED 1974
AMS 4261 IV SW-SERIES V852

Revisions shown in purple compiled in cooperation with
State of Ohio agencies from aerial photographs taken
1974. This information not field checked.



Education, Arts and Humanities Cabinet

KENTUCKY HERITAGE COUNCIL

The State Historic Preservation Office

Paul E. Patton
Governor
Marlene M. Helm
Cabinet Secretary

David L. Morgan
Executive Director and
SHPO

February 26, 2003

Eugene Hargett
Box 150 Route #1
Augusta KY 41002

Dear Mr. Hargett:

I am writing to verify your continued support for listing your property in the National Register of Historic Places. You'll recall that in 1995 this office processed a form to list your farm on the Register. That form was approved by the State Historic Preservation Review Board, but could not be forwarded to the Register due to the lack of vital photographic information needed to complete the form.

In January this year I visited the site and from the public roads obtained that photographic information to complete the form. I have now readied the form for submission to the National Register. I've checked with the Property Valuation Office, and they assure me that you still own the property. I'm now writing to confirm that you support the listing of your property on the National Register, as you did when we notified you in 1995.

I am enclosing a copy of the literature you were sent in 1995 explaining the effects of listing. The results of listing are today the same as eight years ago: if your property is listed in the National Register, your rights to change your property will be unaffected.

Please feel free to contact me at my office by phone, mail, or email to reply. If you are in support of the listing, you do not need to contact me. However, if you have changed your mind, and intend to object to the listing, please contact me by March 15 so I can advise you on how to communicate that objection to the Register. I look forward to your support, and thank you for your consideration.

Sincerely,

Marty Perry, National Register Coordinator

Email: marty.perry@mail.state.ky.us

Voice mail extension: 132



Education, Arts and Humanities Cabinet

KENTUCKY HERITAGE COUNCIL

The State Historic Preservation Office

Paul E. Patton
Governor
Marlene M. Helm
Cabinet Secretary

David L. Morgan
Executive Director and
SHPO

March 4, 2003

Ms. Carol Shull, Chief
National Park Service, US Department of Interior
National Register of Historic Places
1201 Eye Street, NW 8th Floor
Washington DC 20005

Dear Ms. Shull:

Enclosed is documentation for Kentucky properties recommended by the Review Board to meet the National Register eligibility criteria at their January 31, 2003 meeting. The properties include:

The Pocket Rural Historic District, Bourbon County, KY
Thomas Champ House, Bourbon County, KY
Bradford School House, Bracken County, KY
Civil War Fort at Boonesboro, Clark County, KY
Liggett and Myers Tobacco Re-handling Plant, Fayette County, KY
Axton-Fisher Tobacco Company Warehouse, Jefferson County, KY
Finzer & Company Tobacco Factory, Jefferson County, KY
Louisville Grocery Company Building, Jefferson County, KY

✓ Among the new submissions is the **Barkley, George, Farm** in Bracken County, KY, approved at the 9/26/95 Review Board meeting. After the meeting, we learned that photograph identification was missing. Our staff National Register Coordinator visited the site this year to document its current situation; the site has not changed since the original nomination. Attached is correspondence with the owner, the same owner as in 1995, explaining this situation.

Also included are 2 nominations resubmitted and revised according to return comments, the **W.K. Stewart Bookstore**, and the **Duncan, Stuart E. and Annie L., Estate**, both in Jefferson County, KY

Finally, this mailing contains a form calling for the reduction of the **Battle of Munfordville**, Hart County, KY, as well as this office's petition for removal of the entire area added to that site in 2001.

As State Historic Preservation Officer, I judge all but the final Kentucky property on this list meet the National Register criteria, and request they be listed. Thank you for considering their eligibility.

Sincerely,

David L. Morgan, Executive Director
Kentucky Heritage Council and
State Historic Preservation Officer



Education, Arts and Humanities Cabinet

KENTUCKY HERITAGE COUNCIL

The State Historic Preservation Office



Paul E. Patton
Governor
Marlene M. Helm
Cabinet Secretary

David L. Morgan
Executive Director and
SHPO

May 9, 2003

Ms. Carol Shull, Chief
National Park Service, US Department of Interior
National Register of Historic Places
1201 Eye Street, NW 8th Floor
Washington DC 20005

Dear Ms. Shull:

Enclosed is a nomination revised according to comments made on its return sheet. The nomination is for the **Barkley, George W., Farm, Bracken County, Kentucky.**

The documentation needed to address the Period of Significance more appropriately. The Statement of Significance has been revised and the Period of Significance was changed in accord with the comments on the return sheets. Also, the 4 UTM coordinates originally plotted and calculated on the quad map have now been entered on page 4 of the cover form.

We appreciate your efforts to list this Kentucky property on the National Register.

Sincerely,

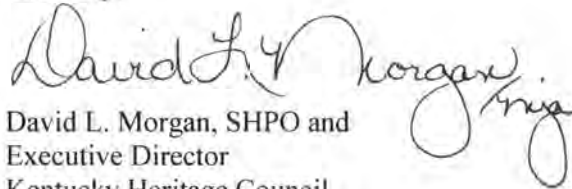

David L. Morgan, SHPO and
Executive Director
Kentucky Heritage Council