



KENTUCKY HISTORIC RESOURCES INVENTORY

Site No. CP-60

1. Historic Name(s) <u>Reitman's St. Joseph House</u> Original Owner <u>Nicholas Reitman</u>		22. ADD/County <u>Campbell</u> 019	
2. Present Name <u>Helen Reitman House</u>		23. U.S.G.S. Quadrant (15'/75') <u>New Richmond</u> 136 G.I.S. Mod.	
3. Location <u>Four Mile Pike, Camp Springs</u>		24. UTM Reference 16 7283510 43193610 Zone Easting Northing	
4. Owner's Name <u>Helen Reitman</u>		25. Coordinate Accuracy 	
5. Owner's Address <u>163 Fender Road, Melbourne</u>		26. Prehistoric Site Object Historic Site Structure Building Other	
6. Open to Public Yes <input type="checkbox"/> No <input checked="" type="checkbox"/> <u>XX</u>	7. Visible from road Yes <input checked="" type="checkbox"/> No <input type="checkbox"/> <u>XX</u>	8. Ownership XX Private <input type="checkbox"/> Local <input type="checkbox"/> State <input type="checkbox"/> Federal <input type="checkbox"/>	
9. Local Contact/Organization <u>Campbell County Heritage League</u>		27. National Register District Name: <u>GERMAN SETTLEMENT PROPERTIES</u> <u>FOUR MILE CREEK AREA</u> 	
10. Site Plan with North Arrow		28. Significance Evaluation D	
18. Description Unusually large stone building located in the core of the Camp Springs settlement. Front elevation practically abuts Four Mile Pike while a road to St. Joseph's Catholic Church borders the rear or east elevation. This five bay, 2 1/2 story stone edifice was constructed into the side of a hill, thus allowing a direct entrance into the second floor rear. The front entrance was (Continue on Back)		11. Architect	
		12. Builder <u>probably N. Reitman</u>	
		13. Date <u>c.1868</u> A. <input checked="" type="checkbox"/> <u>4</u> B. <input type="checkbox"/>	
		14. Style A. Vernacular <input checked="" type="checkbox"/> <u>V</u> B. <input type="checkbox"/>	
		15. Original Use <u>Dwelling/Tavern</u> <input type="checkbox"/>	
16. Present use <u>Dwelling/Apartments</u>		29. Status Date National Landmark <input type="checkbox"/> National Register <input type="checkbox"/> Landmark Certificate <input type="checkbox"/> Kentucky Survey <input checked="" type="checkbox"/> <u>5/10/79</u> Local Landmark <input type="checkbox"/> HABS/HAER <input type="checkbox"/>	
17. Condition <u>Good</u> B		30. Historic Theme Primary <u>Architecture</u> C Secondary <u>Ethnic History</u> C C Other <u>Commerce</u> E	
19. History According to local sources, this building was built by Nicholas Reitman circa 1868. Reitman, a native of Bavaria, came to the U.S. prior to 1855. By the early 1870s Reitman (also spelled Wrightman) had acquired multiple holdings around Indian Springs. In 1874 his 54 acre tract		31. Endangered Yes <input type="checkbox"/> No <input checked="" type="checkbox"/> <u>XX</u>	
20. Significance Significant as a physical manifestation of German settlement into Four Mile Creek Valley. Along with the <u>Camp Springs House (CO-71)</u> , this is one of the largest		32. Preservation Project Status Actual Cost in \$1,000s 	
21. Source of Information <u>Elizabeth Reitman</u> <u>Balbina Enzweiler</u>		33. ATTACH PHOTO <div style="display: flex; justify-content: space-around;">   </div>	
34. Prepared by: <u>Carolyn M. Torma</u> <u>Edward A. Chappel</u>		Roll No. <u>19</u> Picture No. <u>16-31</u> Direction _____	
35. Organization <u>Kentucky Heritage Council</u>		36. Date <u>5/10/79</u>	
37. Revision Dates 38. Staff Review <u>11/2/82</u> <u>Steve Gordon</u>			

18. shifted one bay to the south, thus altering the original symmetrical fenestration. Side elevations are impressive; being three bays deep and three stories tall. Roof exhibits cornice returns. As was customary, all bays feature the handsome segmental arch openings with stone voussoirs. The majority of the windows are six-over-six sash with a few metal casement replacement. The interior is said to have a vaulted cellar originally used to store beer.

Across Four Mile Pike and to the northwest is one of three round stone smoke-houses included in this nomination. Evidence indicates it was associated with a farmhouse that is no longer standing.

19. on Four Mile Creek was valued at \$1,900 with the improvements assessed at \$5,000. The 1880 census indicates that in addition to the Reitmans many German farm laborers lived in this building. A souvenir program for the 1888 Alexandria Fair contains a listing for Four and Twelve Mile Hotel. Local sources suggest the building was probably built by Peter Ensweiler and Nicholas Reitman.



Round stone smokehouse/icehouse across from Reitman House on Four Mile Pike



North elevation and masonry detail

20. stone buildings in the area.

21. Eighth and Tenth Census of the United States; 1860, 1880, Campbell County. Campbell County Tax Lists, 1874. Alexandria Fair Program, 1888. Griffing, Atlas of Boone, Kenton, and Campbell Counties, 1883.

KENTUCKY HISTORIC RESOURCE INVENTORY SUPPLEMENT
BOUNDARY AND LOCATION INFORMATION

Historic Property Name Nicholas Reitman House Site # CP-60

Multiple Resource/Thematic Nomination Title German Settlement Properties
Four Mile Creek Area

U.T.M. Coordinates - List multiple UTM's if property is ten or more acres.

A. 16 728350 4319360 D. _____

B. _____ E. _____

C. _____ F. _____

Verbal Boundary Description Acres @1.6 acres

Beginning at the intersection of Four Mile Pike (Route 547) and St. Joseph's Church Road, proceed south 400' along the west side of latter road, then turning west proceed down hill 175' along fencerow to Four Mile Pike, then proceed north 250' along said road, crossing Four Mile Pike so as to include round smokehouse, then return to east side of road, proceeding north 150' to the point of origin. Boundaries include large stone Reitman House, domestic yard space, and round smokehouse on opposite side of Four Mile Pike.

Sketch of Site Plan (Showing outbuildings, structures, landscape features and the site boundary as described above.)

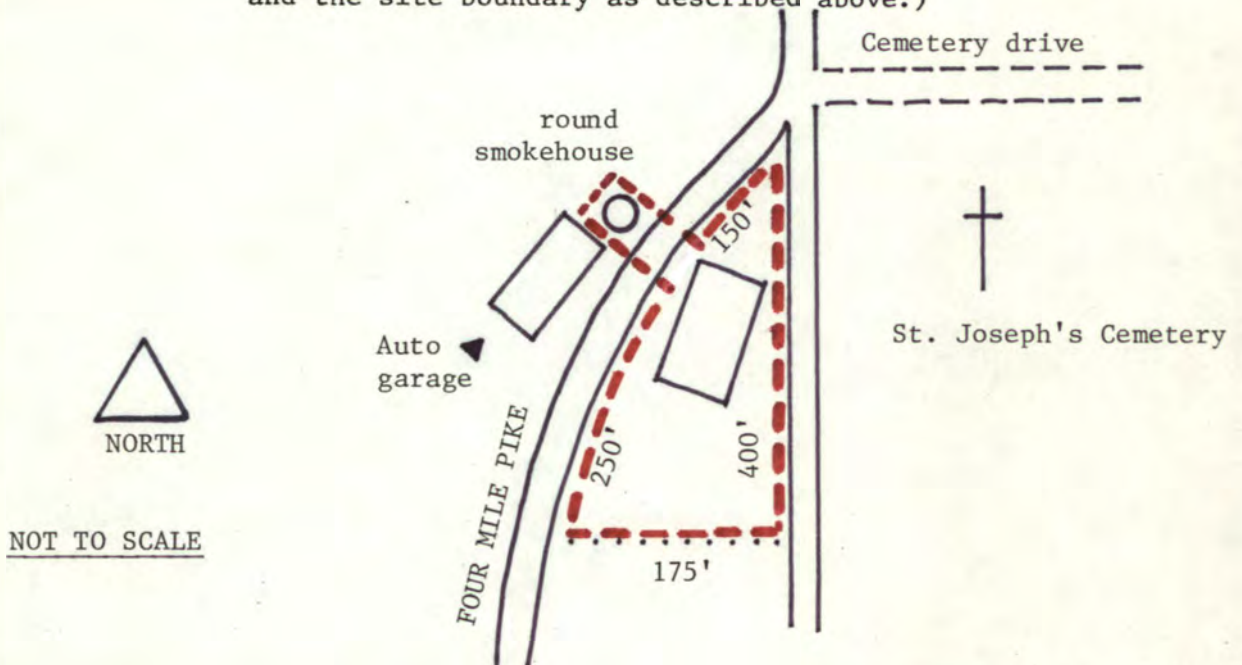

Official Courthouse Property Reference:

United States Department of the Interior
National Park Service

National Register of Historic Places
Inventory—Nomination Form

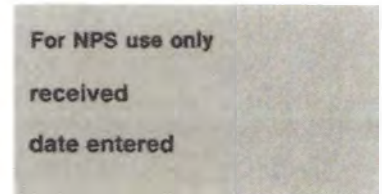

Continuation sheet

Item number

Page 2 of 3

Multiple Resource Area
Thematic Group

Name German Settlement, Four Mile Creek Area Thematic Resources
State Kentucky

Nomination/Type of Review

Date/Signature

11. Roth Farm

Entered in the
National Register

Keeper

3/9/83 Delores Byers

Attest

12. Baumann House

Entered in the
National Register

Keeper

3/9/83 Delores Byers

Attest

13. Ort-Heeb Farm

Entered in the
National Register

Keeper

3/9/83 Delores Byers

Attest

14. Faha, John, House

Entered in the
National Register

Keeper

3/9/83 Delores Byers

Attest

15. St. John's Lutheran Cemetery

Entered in the
National Register

Keeper

3/9/83 Delores Byers

Attest

16. Kremer, Matthias, House

Substantive Review

Keeper

Sandra M. Clelland 3/9/83

Attest

accept Patrick Andrus 3/7/83

17. Trutschell House (DeMoss House)

Substantive Review

Keeper

Determined Eligible

Sandra M. Clelland 3/9/83

DOE/OWNER OBJECTION

Attest

Eligible Patrick Andrus 3/7/83

18. Reitman's St. Joseph House

Entered in the
National Register

Keeper

3/9/83 Delores Byers

Attest

19. Camp Spring House

Entered in the
National Register

Keeper

3/9/83 Delores Byers

Attest

20. Kremer, Frederick, House

Entered in the
National Register

Keeper

3/9/83 Delores Byers

Attest

United States Department of the Interior
National Park Service

Reitman's St. Joseph House (German
Settlement, Four Mile Creek Area TR)
Campbell County
KENTUCKY

Working No. JAN 24 1983

Fed. Reg. Date: 2.7.84

Date Due: 2/24/83 - 3/10/83

Action: ACCEPT 3/8/83

Entered in the RETURN

National Register REJECT

Federal Agency: _____

- resubmission
- nomination by person or local government
- owner objection
- appeal

Substantive Review: sample request appeal NR decision

Reviewer's comments:

Recom./Criteria _____

Reviewer _____

Discipline _____

Date _____

see continuation sheet

Nomination returned for: technical corrections cited below
 substantive reasons discussed below

1. Name

2. Location

3. Classification

Category	Ownership	Status	Present Use
	Public Acquisition	Accessible	

4. Owner of Property

5. Location of Legal Description

6. Representation in Existing Surveys

has this property been determined eligible? yes no

7. Description

Condition		Check one	Check one
<input type="checkbox"/> excellent	<input type="checkbox"/> deteriorated	<input type="checkbox"/> unaltered	<input type="checkbox"/> original site
<input type="checkbox"/> good	<input type="checkbox"/> ruins	<input type="checkbox"/> altered	<input type="checkbox"/> moved date _____
<input type="checkbox"/> fair	<input type="checkbox"/> unexposed		

Describe the present and original (if known) physical appearance

- summary paragraph
- completeness
- clarity
- alterations/integrity
- dates

8. Significance

Period _____ Area of Significance—Check and justify below

Specific dates _____ Builder/Architect _____

Statement of Significance (in one paragraph)

- _____ summary paragraph
- _____ completeness
- _____ clarity
- _____ applicable criteria
- _____ justification of areas checked
- _____ relating significance to the resource
- _____ context
- _____ relationship of integrity to significance
- _____ justification of exception
- _____ other

9. Major Bibliographical References

10. Geographical Data

Address of nominated property _____

Geographic name _____

USIT References _____

Verbal boundary description and justification _____

11. Form Prepared By

12. State Historic Preservation Officer Certification

The evaluated significance of this property within the state is

_____ national _____ state _____ local

State Historic Preservation Officer signature _____

Title _____ date _____

13. Other

- _____ Maps
- _____ Photographs
- _____ Other

Questions concerning this nomination may be directed to _____

Signed _____ Date _____ Phone: 202 272-3500

Comments for any item may be continued on an attached sheet.







Please refer to the map in the
Multiple Property Cover Sheet
for this property

Multiple Property Cover Sheet Reference Number: 64000220

W A I V E R

(by Property Owner)

Mrs. Mary Cronan Oppel, Director
Kentucky Heritage Council, and
State Historic Preservation Officer
Education and Humanities Cabinet
Nineth Floor, Capital Plaza Tower
Frankfort, Kentucky 40601

Dear Mrs. Oppel:

This will confirm that I am fully aware of the effects of listing a property in the National Register of Historic Places. I recognize that, under the National Historic Preservation Act, I am entitled to object to the proposed listing of my property by a notarized, written statement. If I am the sole owner and I object, my property will not be listed. If there are multiple owners of this property and a majority of the owners object, the property will not be listed.

Following is the name and address of my property.

FOUR MILE HOUSE
Historic Name of Property

ROUTE 547
Street

CAMP SPRINGS KY 41059
City State Zip

I hereby waive my right to object to the proposed listing and notify you that I request that my property be listed in the National Register at the earliest possible date.

Sincerely,

Helene M. Reitman

RECEIVED

NOV 1 1982

KY. HERITAGE
COMMISSION

[Faint, illegible handwritten text]