

KENTUCKY HISTORIC RESOURCES INVENTORY

1. Name of Site: Spring House on Flat Fork	16. Date: Early or Mid-19th Century [3] ? []
2. Prehistoric Site Building <input checked="" type="checkbox"/> Object Historic Site Structure Other	17. Style: Early 19th C Vernacular [V] []
3. Location: West side KY 161, 1 2/10 mile south of Kentucky 324	18. Architect/Builder:
4. ADD/County: Mason [081]	19. No. of Stories: Two [C]
5. Original Owner:	20. Original Floor Plan: Single Cell [B]
6. Other Names:	21. Single Pile Double Pile N.A. <input checked="" type="checkbox"/>
7. Owners Name: Cecil McCarthy	22. Roof Form & Original Material: Gable
8. Owners Address: Flat Fork Pike Mays Lick, Kentucky 41055	23. Structural Material: Stone [B]
9. Evaluation: Meets National Register [C]	24. Exterior Finish: Stone [S]
10. Status & Date: Nat.Landmark KY Survey Nat.Register Local Landmark Landmark Cert. HABS/HAER	25. Foundation Material: Stone [A]
11. N.R.Group District Name [] Mult.Resource Area [] Thematic Name Early Stone Bldgs. []	26. Major Alterations: Moved Wall Treat. Additions None <input checked="" type="checkbox"/>
12. Historical Theme: Primary: Architecture [C] Secondary: [] Other: []	27. Outbuildings: House, quarters, three barns [5]
13. Statement of Significance: Excellent example stone spring house; type unique to Mason County.	28. Original Use: Spring House [C]
	29. Present Use: Spring House
	30. Condition: Good [B]
	31. Endangered Yes _____ No <input checked="" type="checkbox"/>
	31. Attach Photos Roll: Stone 24 Photo Nos: 23 - 36 Slides Also
14. History:	
15. Source of Historical Information:	33. Prepared by: Carolyn Murray Wooley
	34. Organization: Kentucky Heritage Council
	35. Date: April 1984

KENTUCKY HISTORIC RESOURCES INVENTORY

36. UTM Point of Primary Building: 17 253 320 4264 520 37. USGS Quadrant: Elizaville 38. G.I.S. Mod. []
39. Coordinate Accuracy []

40. UTM Points of Boundary:
A. 17 253 480 4264 760 C. 17 253 925 4264 180 E. 17 253 100 4264 760
B. 17 253 600 4264 250 D. 17 253 060 4264 330 F.

41. Total Acreage in Present Property: . 42. Acreage Included in Nominated Boundary: 60

43. Site Plan and Boundary Description and Justification:



Site enclosed by a P.C.D.E. as shown.
B-C is on Flat Fork. D-E is at Ky 161.
Boundary includes spring house, pond,
house, quarters and 3 barns.

44. Description and House Plan:

One room, dry stone springhouse, ca. 14' X 16'; two stories tall, doorway to each story in north end of house; north gable end of roof extended to roof over entrance.

Spring flows through rock lining into circular basin outside northwest corner of house; basin ca. four feet tall, covered by stone slab (photo 3). Pool overflows and goes under entrance walk and under stone door threshold into springhouse. Steps descend from west hillside to walkway between spring and springhouse (photo 2). Spring flows out southeast corner of springhouse into stone lined pond (photo 1).

Located east downhill from three bay, two story weatherboarded house. Site has two two-story servants quarters and three old barns. Appears to be early road bed running latitudinally in front of house.

ML 57

ML 57
p. 3 of 3

Spring
branch

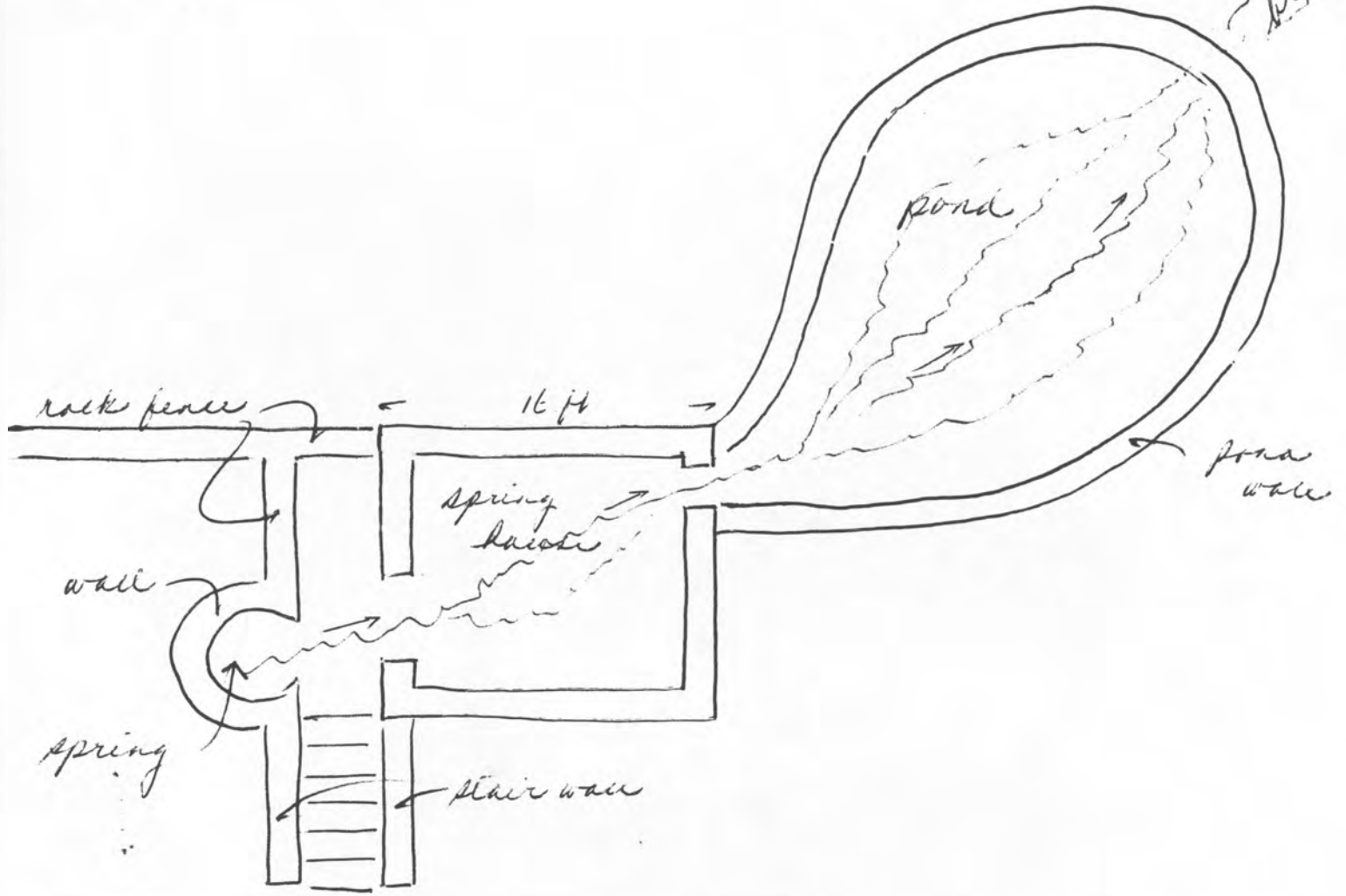

Stone slab threshold to spring house,
spring flows under it.

Area outside doorway also covered by
stone slabs spanning spring run.

NATIONAL REGISTER OF HISTORIC PLACES
EVALUATION/RETURN SHEET

Spring House on Flat Fork (Early Stone
Buildings of Kentucky TR)
Mason County
KENTUCKY

~~Substantive Review~~

Working No. JUN 6 1985
Fed. Reg. Date: _____
Date Due: 7/4/85 - 7/21/85
Action: ACCEPT _____
RETURN 7/21/85 _____
REJECT _____
Federal Agency: _____

- resubmission
- nomination by person or local government
- owner objection
- appeal

Substantive Review: sample request appeal NR decision

Reviewer's comments:

see letter

Recom./Criteria _____ *dit*
Reviewer _____
Discipline _____
Date _____
_____ see continuation sheet

Nomination returned for: technical corrections cited below
 substantive reasons discussed below

1. Name

2. Location

3. Classification

Category	Ownership Public Acquisition	Status Accessible	Present Use
----------	---------------------------------	----------------------	-------------

4. Owner of Property

5. Location of Legal Description

6. Representation in Existing Surveys

Has this property been determined eligible? yes no

7. Description

Condition		Check one	Check one
<input type="checkbox"/> excellent	<input type="checkbox"/> deteriorated	<input type="checkbox"/> unaltered	<input type="checkbox"/> original site
<input type="checkbox"/> good	<input type="checkbox"/> ruins	<input type="checkbox"/> altered	<input type="checkbox"/> moved date _____
<input type="checkbox"/> fair	<input type="checkbox"/> unexposed		

Describe the present and original (if known) physical appearance

- summary paragraph
- completeness
- clarity
- alterations/integrity
- dates
- boundary selection

8. Significance

Period _____ Areas of Significance—Check and justify below

Specific dates _____

Builder/Architect

Statement of Significance (*in one paragraph*)

- summary paragraph
- completeness
- clarity
- applicable criteria
- justification of areas checked
- relating significance to the resource
- context
- relationship of integrity to significance
- justification of exception
- other

9. Major Bibliographical References

10. Geographical Data

Acreege of nominated property _____

Quadrangle name _____

UTM References _____

Verbal boundary description and justification

11. Form Prepared By

12. State Historic Preservation Officer Certification

The evaluated significance of this property within the state is:

____ national ____ state ____ local

State Historic Preservation Officer signature

title

date

13. Other

- Maps
- Photographs
- Other

Questions concerning this nomination may be directed to _____

Signed _____ Date _____ Phone: _____

KENTUCKY HISTORIC RESOURCES
Individual Inventory Form

Resource # MS-57
Mason _____ County _____

1. Name of Resource: <u>Springhouse on Flat Fork</u>		16. Date: Original Building <u>early 19th C.</u> [8] Addition []	
2. Original Owner: <u>Not Known</u>		17. Style: <u>Settlement Vernacular</u> [2V] []	
3. Other Names:		18. Architect/Builder: <u>Not Known</u>	
4. Prehistoric Site _____ Building X Object Historic Site _____ Structure _____ Other _____		19. No. of Stories: <u>Two</u> [2.0]	
5. Location: <u>west side of Kentucky 161, 1 2/10 miles south of Kentucky 324, near Mays Lick</u>		20. Original Floor Plan: <u>Rec. Single Cell</u> [1R]	
6. Owner's Name: <u>Cecil McCarthy</u> [P]		21. Single Pile X Double Pile _____ N.A. X	
7. Owner's Address: <u>Flat Fork Pike Mays Lick, Kentucky 41055</u>		22. Roof Form & Material: <u>Original</u> <u>Gable</u> Not Original	
8. Evaluation: [G]		23. Structural Material: <u>Stone</u> [S]	
9. Recognition & Date: Nat.Landmark _____ Local Landmark _____ Nat.Register _____ HABS/HAER _____ Highway Marker _____ KY Inventory X KY Landmark Certificate _____		24. Exterior Material: <u>Stone</u> [S] []	
10. N.R.Status & Date:		25. Foundation Material: <u>Stone</u> [S] []	
11. N.R.Group: District Name: [] Mult.Resource Area: [] Thematic Name: <u>Early Stone Buildings</u> []		26. Major Alterations: <u>None</u> X <u>Moved/Rebuilt</u> Other _____ Additions _____	
12. Historical Theme: Primary: <u>Architecture</u> [030] Secondary: [] Other: []		27. Special Features: <u>Spring arises outside Springhouse</u>	
13. Statement of Significance: <u>Excellent example stone springhouse; type unique to Mason County.</u> []		28. Outbuildings: <u>House, Quarters, Three Barns</u> [5]	
14. History: <u>Not Researched.</u>		29. Original Function: <u>Springhouse</u> [1C]	
15. Source of historical information and/or contact person:		30. Present Use: <u>Springhouse</u> [1C]	
		31. Condition: <u>Excellent</u> [E]	
		32. Endangered: Yes _____ No X	
		33. Attach Photos: <u>Roll: 24 Photo Nos 23-36 No. of Slides: X</u>	
		34. Prepared by: <u>Carolyn Murray-Wooley</u>	
		35. Organization: <u>Kentucky Heritage Council</u>	
		36. Date: <u>April 1984</u>	
		37. New Survey X Resurvey _____	

36. UTM Point of Primary Building: 17 253 320 4264 520
 37. USGS Quadrant: Uigsville
 38. G.I.S. Mod. []
 39. Coordinate Accuracy []
 40. UTM Points of Boundary:
 A. 17 253 480 4264 760 C. 17 253 325 4264 180 E. 17 253 100 4264 760
 B. 17 253 600 4264 250 D. 17 253 060 4264 520 F. []

41. Total Acreage in Present Property: [] 42. Acreage Included in Nominated Boundary: 60

43. Site Plan and Boundary Description and Justification:

Site enclosed by A-B-C-D-E as shown.
 B-C is on Flat Fork, D-E is at Ky 161.
 Boundary includes Spring house, pond, house, quarters and 3 barns.

- 7 contributing buildings
- 1 contributing structure (pond)
- 1 non contributing building (garage)

Boundary includes a portion of the original farm which can be seen from house.

45. Description and House Plan

One-room, dry-stone springhouse, ca. 14 x 16 feet; two stories tall, doorway to each story in north end of house; north gable end of roof extended to roof over entrance. Spring flows through rock lining into circular basin outside northwest corner of house; basin ca. four feet tall, covered by stone slab. Pool overflows and goes under entrance walk and under stone door threshold into springhouse. Steps descend from west hillside to walkway between spring and springhouse. Springs flows out southeast corner of springhouse into stone lined pond.

The spring is located downhill, east of the house.

There are several other original buildings on this farm complex. The main house is a two-story, three-bay weatherboarded house with a two-story ell. Two two-story weatherboarded servants' quarters are in the yard, southeast of the house. There are three barns around the barn yard south of the house. All of these are in good condition.

ML57

Spring
Tranche

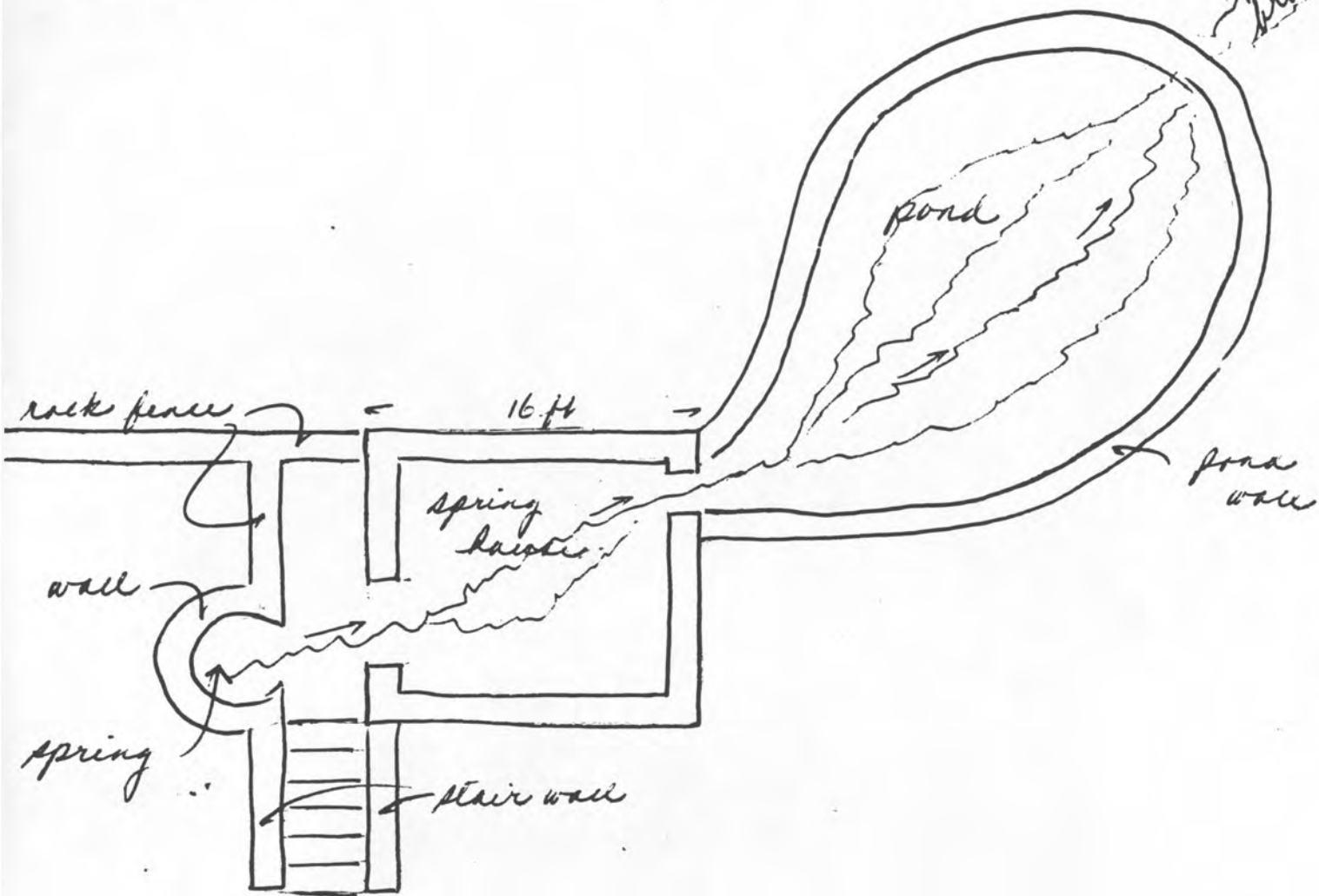

Stone slab threshold to spring house,
spring flows under it.

Area outside doorway also covered by
stone slabs spanning spring run.

NATIONAL REGISTER OF HISTORIC PLACES
EVALUATION/RETURN SHEET

✓
gd

Spring House on Flat Fork (Early Stone Buildings
of Kentucky--Outer Bluegrass and Pennyrile TR)
Mason County
KENTUCKY

Substantive Review

Working No. 6-6-85

Fed. Reg. Date: _____

Date Due: 1/10/87

Action: ACCEPT

RETURN 1-8-87

REJECT

Federal Agency: _____

- resubmission
- nomination by person or local government
- owner objection
- appeal

Substantive Review: sample request appeal NR decision

Reviewer's comments:

Unlike the other springhouse
nominations where there is
some historic information on
the properties considered contrib

Recom./Criteria Return
Reviewer Aschlag
Discipline Arch Hist
Date 1/10/87
_____ see continuation sheet

Nomination returned for: technical corrections cited below
 substantive reasons discussed below

(and in the cover), there was
none given for this property.
Can any ^{basic} information on the
dates/period of signif for
the farm complex be given
to support the contrib
document determination?
Can the house be dated
on its style? Please disc
if any problem. Thank
you.

1. Name

2. Location

3. Classification

Category Ownership Status
Public Acquisition Present Use Accessible

4. Owner of Property

5. Location of Legal Description

6. Representation in Existing Surveys

Has this property been determined eligible? yes no

7. Description

Condition

excellent deteriorated unaltered original site

good ruins altered moved date _____

fair unexposed

Describe the present and original (if known) physical appearance

- summary paragraph
- completeness
- clarity
- alterations/integrity
- dates
- boundary selection

8. Significance

Period _____ Areas of Significance—Check and justify below

Specific dates _____ Builder/Architect _____
Statement of Significance (*in one paragraph*)

- summary paragraph
- completeness
- clarity
- applicable criteria
- justification of areas checked
- relating significance to the resource
- context
- relationship of integrity to significance
- justification of exception
- other

9. Major Bibliographical References

10. Geographical Data

Acreage of nominated property _____
Quadrangle name _____
UTM References _____

Verbal boundary description and justification _____

11. Form Prepared By

12. State Historic Preservation Officer Certification

The evaluated significance of this property within the state is:

_____ national _____ state _____ local

State Historic Preservation Officer signature

title _____ date _____

13. Other

- Maps
- Photographs
- Other

Questions concerning this nomination may be directed to _____

Signed A. Schmalzel Date 1/18/87 Phone: _____

KENTUCKY HISTORIC RESOURCES
Individual Inventory Form

Resource # MS-57
Mason County

1. Name of Resource: Springhouse on Flat Fork

2. Original Owner: Not Known

3. Other Names:

4. Prehistoric Site Building Object
Historic Site Structure Other

5. Location: west side of Kentucky 161, 1 2/10 miles south of Kentucky 324, near Mays Lick

6. Owner's Name: Cecil McCarthy [P]

7. Owner's Address: Flat Fork Pike
Mays Lick, Kentucky 41055

8. Evaluation: [G]

9. Recognition & Date:
Nat.Landmark Local Landmark
Nat.Register HABS/HAER
Highway Marker KY Inventory
KY Landmark Certificate

10. N.R.Status & Date:

11. N.R.Group:
District Name: []
Mult.Resource Area: []
Thematic Name: Early Stone Buildings []

12. Historical Theme:
Primary: Architecture [030]
Secondary: []
Other: []

13. Statement of Significance:

Excellent example stone springhouse; type unique to Mason County.

[]

14. History:

Not Researched.

15. Source of historical information and/or contact person:

16. Date: Original Building early 19th C. [8]
Addition []

17. Style: Settlement Vernacular [2V]
[]

18. Architect/Builder: Not Known

19. No. of Stories: Two [2.0]

20. Original Floor Plan: [1R]
Rec. Single Cell

21. Single Pile Double Pile N.A.

22. Roof Form & Material: Original
Gable Not Original

23. Structural Material: Stone [S]

24. Exterior Material: Stone [S]
[]

25. Foundation Material: Stone [S]
[]

26. Major Alterations: None
Moved/Rebuilt Other
Additions

27. Special Features: Spring arises outside Springhouse

28. Outbuildings: House, Quarters, Three Barns [5]

29. Original Function: Springhouse [01C]

30. Present Use: Springhouse [01C]

31. Condition: Excellent [E]

32. Endangered: Yes
No

33. Attach Photos: Roll: 24 Photo Nos 23-36 No. of Slides: X

SE 4 1987

34. Prepared by: Carolyn Murray-Wooley

35. Organization: Kentucky Heritage Council

36. Date: April 1984

37. New Survey Reserve

KENTUCKY HISTORIC RESOURCES INVENTORY

36. UTM Point of Primary Building: 17 253 320 4264 520
 37. USGS Quadrant: Uigsville
 38. G.I.S. Mod. []
 39. Coordinate Accuracy []
 40. UTM Points of Boundary:
 A. 17 253 480 4264 760 C. 17 253 925 4264 180 E. 17 253 100 4264 760
 B. 17 253 600 4264 250 D. 17 253 060 4264 330 F. _____
 41. Total Acreage in Present Property: _____ 42. Acreage Included in Nominated Boundary: 60

43. Site Plan and Boundary Description and Justification:

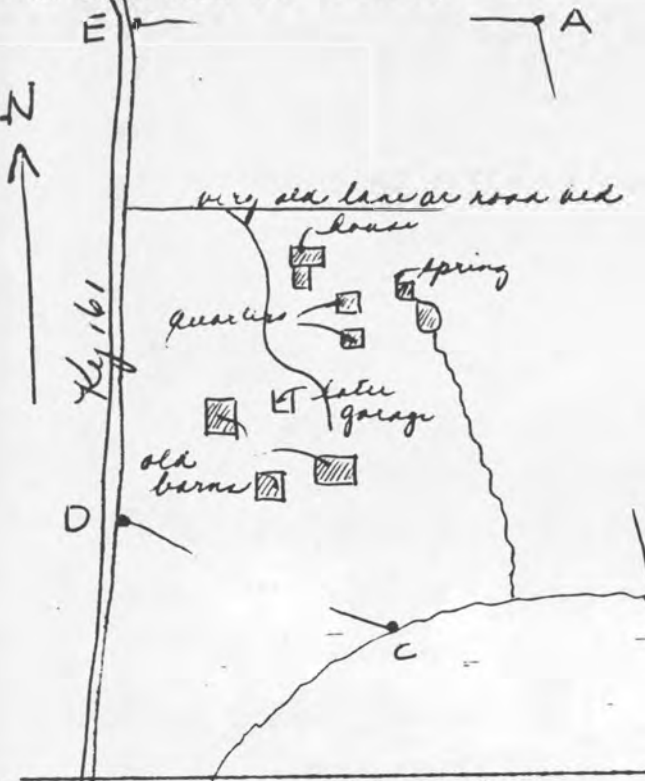

Site enclosed by A-B-C-D-E as shown.
 B-C is on Flat Fork, D-E is at Ky 161.
 Boundary includes spring house, pond,
 house, quarters and 3 barns.

- 7 contributing buildings
- 1 contributing structure (pond)
- 1 non contributing building (garage)

Boundary includes a portion
 of the original farm which can
 be seen from house.

45. Description and House Plan

One-room, dry-stone springhouse, ca. 14 x 16 feet; two stories tall, doorway to each story in north end of house; north gable end of roof extended to roof over entrance. Spring flows through rock lining into circular basin outside northwest corner of house; basin ca. four feet tall, covered by stone slab. Pool overflows and goes under entrance walk and under stone door threshold into springhouse. Steps descend from west hillside to walkway between spring and springhouse. Springs flows out southeast corner of springhouse into stone lined pond.

The spring is located downhill, east of the house.

There are several other original buildings on this farm complex. The main house is a two-story, three-bay weatherboarded house with a two-story ell. Two two-story weatherboarded servants' quarters are in the yard, southeast of the house. There are three barns around the barn yard south of the house. All of these are in good condition.

Addendum: The entire complex was an early pioneer farmstead, the house dating to the early 19th century, the quarters and barns to mid-19th century. The garage is non-contributing. The complex is a good illustration of the relationship of various domestic and agricultural buildings on a pioneer farm. The springhouse is an extremely significant example.

SPRINGHOUSE ON FLAT FORK

TR 57

1393

Spring
branch

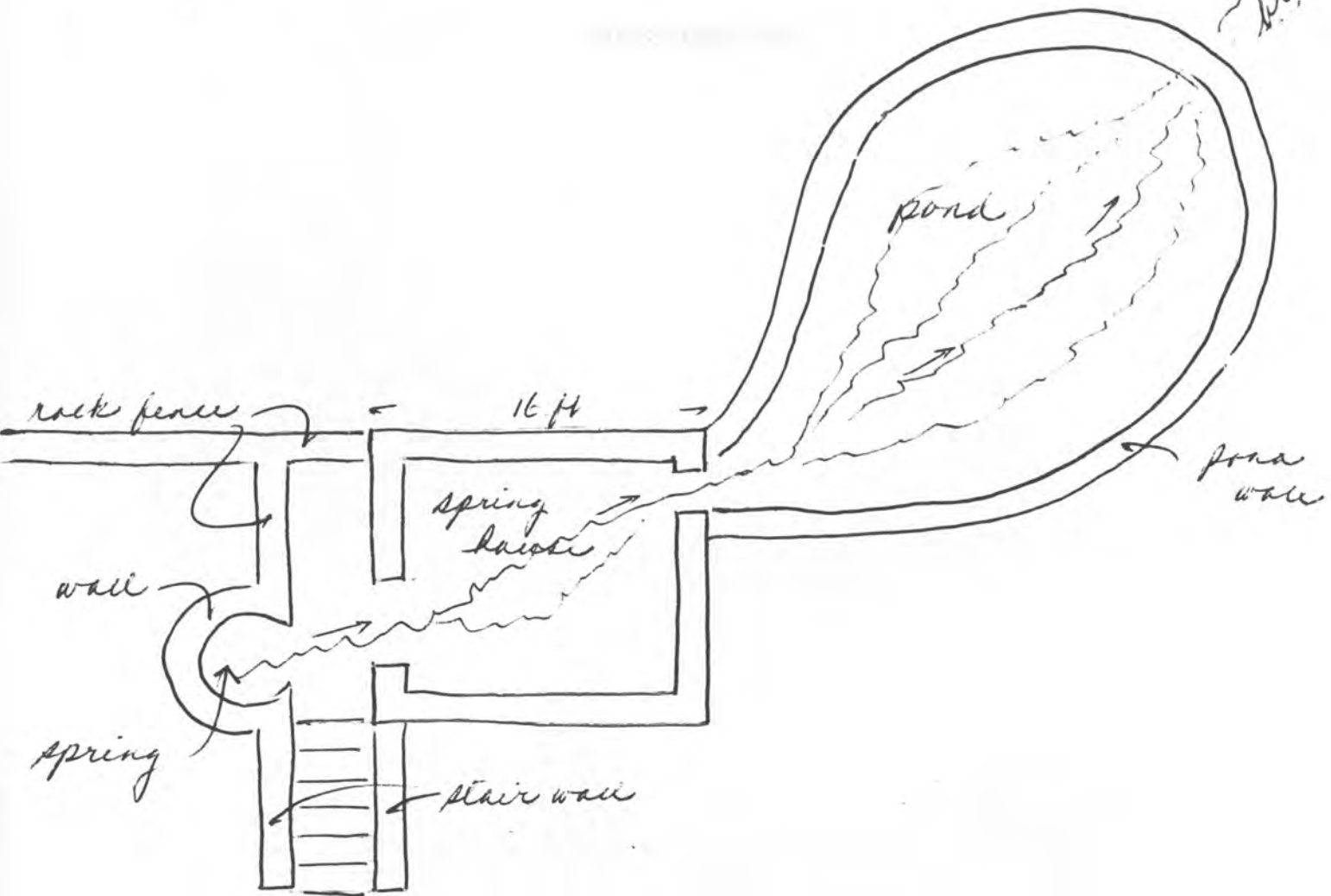

Stone slab threshold to spring house,
spring flows under it.

Area outside doorway also covered by
stone slabs spanning spring run.

JUN 6

SEP 4 1987

United States Department of the Interior
National Park Service

National Register of Historic Places
Inventory—Nomination Form

For NPS use only
received 6/6/85
date entered _____

Continuation sheet

Item number

Page 7 of 7

Multiple Resource Area
Thematic Group

Name Early Stone Buildings of Kentucky Thematic Resources
State Barren County and others, KENTUCKY

Nomination/Type of Review

Date/Signature

61. Spring House on Flat Fork

Substantive Review

Keeper

Amy Schlager 10/6/87

Attest

62. Stone Cellar on Cabin Creek

Substantive Review

Keeper

Schlager 1/8/87

Attest

63. Stone House on Clear Creek

Substantive Review

Keeper

Schlager 1/8/87

Attest

64. Stone House on Plum Creek

Substantive Review

Keeper

A Schlager 1/8/87

Attest

65. Stone House on West Fork

Substantive Review

Keeper

return

Attest

66. Van Dyke House

Substantive Review

Keeper

A Schlager 1/8/87

Attest

67. Willis, Mathias, Store House

Substantive Review

Keeper

A Schlager 1/8/87

Attest

68. Woolfolk, William, House

Substantive Review

Keeper

A Schlager 1/8/87

Attest

Keeper

Attest

Keeper

Attest

NATIONAL REGISTER OF HISTORIC PLACES
EVALUATION/RETURN SHEET

Spring House oA Flat Fork (Early Stone Buildings
of Kentucky--Outer Bluegrass and Pennyrite TR)
Mason County
KENTUCKY

Substantive Review

Working No. 1646.85
Fed. Reg. Date: 2/7/89
Date Due: 10/19/87
Action: ACCEPT 10-6-87
 RETURN
 REJECT
Federal Agency: _____

- resubmission
- nomination by person or local government
- owner objection
- appeal

Substantive Review: sample request appeal NR decision

Reviewer's comments:
*Springhouse discussed in terms of
cover + this form - this bldg
compared to others
Doc nominally acceptable*

Recom./Criteria Accept C
Reviewer Aschlag
Discipline Arch
Date 10/6/87
____ see continuation sheet

Nomination returned for: technical corrections cited below
 substantive reasons discussed below

1. Name

2. Location

3. Classification

Category	Ownership Public Acquisition	Status Accessible	Present Use

4. Owner of Property

5. Location of Legal Description

6. Representation in Existing Surveys

Has this property been determined eligible? yes no

7. Description

Condition	Check one	Check one
<input type="checkbox"/> excellent	<input type="checkbox"/> deteriorated	<input type="checkbox"/> original site
<input type="checkbox"/> good	<input type="checkbox"/> ruins	<input type="checkbox"/> moved date _____
<input type="checkbox"/> fair	<input type="checkbox"/> unexposed	
	<input type="checkbox"/> unaltered	
	<input type="checkbox"/> altered	

Describe the present and original (if known) physical appearance

- summary paragraph
- completeness
- clarity
- alterations/integrity
- dates
- boundary selection

8. Significance

Period _____ Areas of Significance—Check and justify below

Specific dates _____ Builder/Architect _____

Statement of Significance (*in one paragraph*)

- summary paragraph
- completeness
- clarity
- applicable criteria
- justification of areas checked
- relating significance to the resource
- context
- relationship of integrity to significance
- justification of exception
- other

9. Major Bibliographical References

10. Geographical Data

Acreage of nominated property _____

Quadrangle name _____

UTM References _____

Verbal boundary description and justification

11. Form Prepared By

12. State Historic Preservation Officer Certification

The evaluated significance of this property within the state is:

_____ national _____ state _____ local

State Historic Preservation Officer signature

title _____ date _____

13. Other

- Maps
- Photographs
- Other

Questions concerning this nomination may be directed to _____

Signed _____ Date _____ Phone: _____















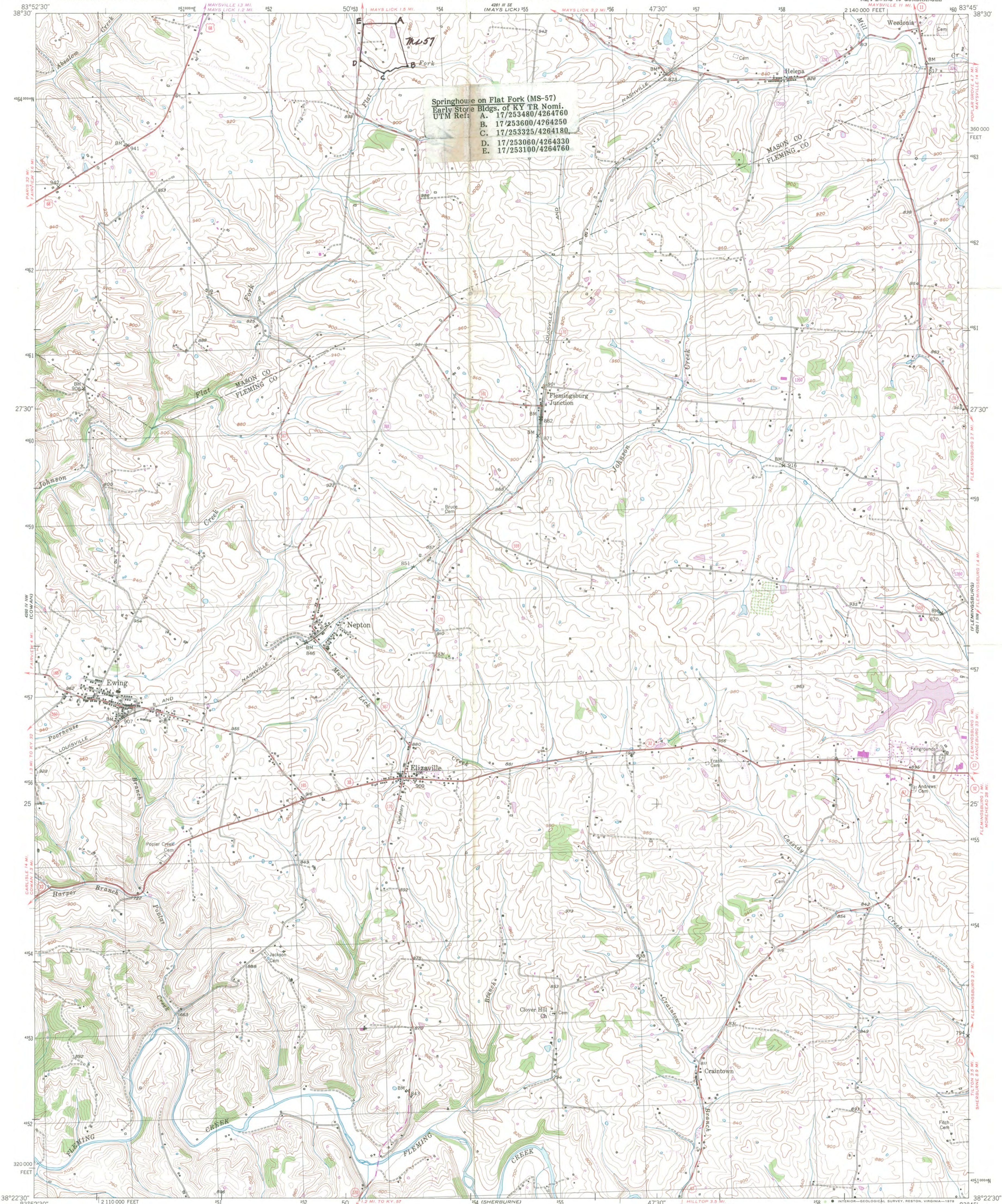

Mapped, edited, and published by the Geological Survey

Control by USGS and USC&GS

Topography from aerial photographs by multiplex methods

Aerial photographs taken 1950. Field check 1952

Polygonic projection. 1927 North American datum

10,000-foot grid based on Kentucky coordinate system, north zone

1000-meter Universal Transverse Mercator grid, zone 17

Revisions shown in purple compiled from aerial photographs taken 1975 and other source data. This information not field checked. Map edited 1978

SCALE 1:24 000

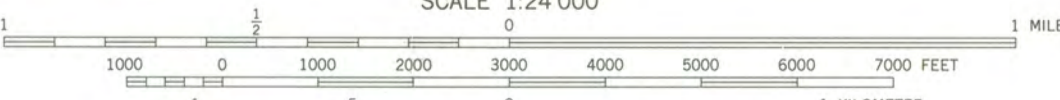

CONTOUR INTERVAL 20 FEET
NATIONAL GEODETIC VERTICAL DATUM OF 1929



ROAD CLASSIFICATION

Heavy-duty	4 LANE 6 LANE	Light-duty
Medium-duty	2 LANE 4 LANE	Unimproved dirt
	U. S. Route	State Route



ELIZAVILLE, KY.
NE/4 EWING 15' QUADRANGLE
N3822.5-W8345/7.5

1952
PHOTOREVISED 1978
AMS 4260 IV NE-SERIES 9853

THIS MAP COMPLIES WITH NATIONAL MAP ACCURACY STANDARDS
FOR SALE BY U. S. GEOLOGICAL SURVEY, RESTON, VIRGINIA 22092
KENTUCKY GEOLOGICAL SURVEY, LEXINGTON, KENTUCKY 40506,
AND KENTUCKY DEPARTMENT OF COMMERCE, FRANKFORT, KENTUCKY 40601
A FOLDER DESCRIBING TOPOGRAPHIC MAPS AND SYMBOLS IS AVAILABLE ON REQUEST