

UNITED STATES DEPARTMENT OF THE INTERIOR  
NATIONAL PARK SERVICE

DATA SHEET

FOR NPS USE ONLY

RECEIVED

APR 29 1976

DATE ENTERED

NATIONAL REGISTER OF HISTORIC PLACES  
INVENTORY -- NOMINATION FORMSEE INSTRUCTIONS IN *HOW TO COMPLETE NATIONAL REGISTER FORMS*  
TYPE ALL ENTRIES -- COMPLETE APPLICABLE SECTIONS**1 NAME**

HISTORIC

\* \* \* Washington Historic District

AND/OR COMMON

Old Washington

**2 LOCATION**

STREET &amp; NUMBER

Boundaries as shown on annexed map(s)

-- NOT FOR PUBLICATION

CITY, TOWN

Washington

CONGRESSIONAL DISTRICT

01

STATE

Kentucky

VICINITY OF

CODE  
021COUNTY  
MasonCODE  
161**3 CLASSIFICATION**

## CATEGORY

 DISTRICT BUILDING(S) STRUCTURE SITE OBJECT

## OWNERSHIP

 PUBLIC PRIVATE BOTH

## PUBLIC ACQUISITION

 IN PROCESS BEING CONSIDERED

## STATUS

 OCCUPIED UNOCCUPIED WORK IN PROGRESS

## ACCESSIBLE

 YES: RESTRICTED YES: UNRESTRICTED NO

## PRESENT USE

 AGRICULTURE COMMERCIAL EDUCATIONAL ENTERTAINMENT GOVERNMENT INDUSTRIAL MILITARY MUSEUM PARK PRIVATE RESIDENCE RELIGIOUS SCIENTIFIC TRANSPORTATION OTHER:**4 OWNER OF PROPERTY**

NAME

Large multiple private ownership; some public ownership

STREET &amp; NUMBER

City of Washington

CITY, TOWN

Washington

STATE

Kentucky

VICINITY OF

**5 LOCATION OF LEGAL DESCRIPTION**COURTHOUSE,  
REGISTRY OF DEEDS, ETC.

County Clerk's Office - Mason County Courthouse

STREET &amp; NUMBER

West Third Street

CITY, TOWN

Maysville

STATE

Kentucky

**6 REPRESENTATION IN EXISTING SURVEYS**

TITLE

Survey of Historic Sites in Kentucky

DATE

1971

 FEDERAL  STATE  COUNTY  LOCALDEPOSITORY FOR  
SURVEY RECORDS

Kentucky Heritage Commission

CITY, TOWN

Frankfort

STATE

Kentucky

## 7 DESCRIPTION

CONDITION		CHECK ONE	CHECK ONE
<input type="checkbox"/> EXCELLENT	<input type="checkbox"/> DETERIORATED	<input type="checkbox"/> UNALTERED	<input checked="" type="checkbox"/> ORIGINAL SITE
<input checked="" type="checkbox"/> GOOD	<input type="checkbox"/> RUINS	<input checked="" type="checkbox"/> ALTERED	<input type="checkbox"/> MOVED DATE _____
<input type="checkbox"/> FAIR	<input type="checkbox"/> UNEXPOSED		

### DESCRIBE THE PRESENT AND ORIGINAL (IF KNOWN) PHYSICAL APPEARANCE

The significant architecture of Washington covers the approximate period 1765-1850. With a few exceptions, architectural development ceased in the early nineteenth century at the beginning of Washington's decline. Taking into account the time lag between architectural styles fashionable on the Atlantic seaboard and in the West, the lack of refined, period examples within the town that can be found elsewhere in the state becomes understandable. Although there are few unique or outstanding examples of particular architectural styles, the structures extant represent the life of 18th- and 19th-century Washington and they give evidence of, and lend support to, the historical heritage that is Washington.

Eighteen buildings were earmarked within the boundaries of the original historic district (approved January 21, 1970). They included the most important buildings historically and architecturally, for example:

The Paxton Inn (c. 1810), a brick three-story plain Federal style structure, is a restored example of an early Kentucky public inn (HABS).

The Paxton-Evans House (c. 1800), a two-story brick house, is the central element in a three-unit row of simple Federal-style buildings (HABS).

Albert Sidney Johnston House, representative of simple early frame domestic building in Kentucky, is reputed to be the birthplace and childhood home of one of the most important generals of the Confederate States of America Army, Albert Sidney Johnston (HABS).

Federal Hill (1800) (HABS 193 ), is a large two-story brick house with transitional details of Georgian and Federal styles built by Colonel Thomas Marshall and completed by his son. Another son, John, became the Chief Justice of the United States Supreme Court (1801-1835).

Marshall Key House (1807), a two-story brick house (also HABS), which, like Federal Hill, contains Georgian and Federal elements. The house has a Federal style main body with a Georgian style doorway. The interior exhibits a beautiful self-supporting "curving stairway" in the side entrance hallway. The builder was Colonel Marshall Key, who had come to Kentucky in 1795.

Arthur Fox House (also Fox-Bickley House, c. 1785), a two-story frame and nogging clapboarded structure, was built by one of the original trustees of Washington.

The district boundaries as originally drawn, however, excluded areas that have historically been included within the city limits of Washington. Excluded were numerous historic sites which date from the same period as the central part of town (see map, Washington Kentucky Preservation Development, p. 61). The proposed boundaries would, in large part, conform to the original boundaries as laid out by Arthur Fox and William Wood in 1786 (see map 2). Specifically, the northern boundary is to extend to U.S. 68, east to St. Patrick's

(continued)

UNITED STATES DEPARTMENT OF THE INTERIOR  
NATIONAL PARK SERVICE

**NATIONAL REGISTER OF HISTORIC PLACES  
INVENTORY -- NOMINATION FORM**

FOR NPS USE ONLY

RECEIVED

APR 29 1976

DATE ENTERED

CONTINUATION SHEET

ITEM NUMBER 7

PAGE 2

Cemetery, southward, parallel to Main Street, to U.S. 62. The boundary is to extend as far westward as the western boundary of the Old Baptist cemetery and northward paralleling Main Street (see map 1).

As evidenced by the enclosed 1794 plat and 1876 map, the northern boundary was marked by Clarks Run Pike, now U.S. 68, and the southern boundary by a road now the present U.S. 62. The east-west boundary is somewhat more vague. The 1794 plat shows that the lots to the west of Water Street and to the east of Green (Marshall) Streets were much larger than the four tiers of lots between Water and Main, and Main and Green Streets. Although streets were not built east of Green or west of Water, houses were located in the earliest period of settlement on these outer lots, archaeological and historical research has uncovered. Among the late 19th-century and more modern houses in the area to be added are the following structures:

(Numbers as identified on enclosed map 4, from the Washington Preservation Development; "1876" refers to structure shown on the 1876 Atlas.)

- N307 An early 1800s, one-story frame, frontier saltbox structure.
- N309 Site of 1876 structure where archaeological investigation is recommended.
- N310 "
- N312 "
- N316 "
- N402 "
- N403 "
- N404 "
- S402 "
- S403 A mid-19th century two-story frame Gothic Revival house. At the rear is a Gothic Revival outbuilding intact.
- S405 A c. 1800 two-story frame house of hewn, mortised and tenoned, pegged timber construction.
- S411 Site of 1876 structure where archaeological investigation is recommended.
- S412 Site of old cemetery.
- S414 A c. 1800 one-and-a-half-story frame house once used as Presbyterian parsonage.

# 8. SIGNIFICANCE

PERIOD	AREAS OF SIGNIFICANCE -- CHECK AND JUSTIFY BELOW			
<input type="checkbox"/> PREHISTORIC	<input type="checkbox"/> ARCHEOLOGY-PREHISTORIC	<input type="checkbox"/> COMMUNITY PLANNING	<input type="checkbox"/> LANDSCAPE ARCHITECTURE	<input checked="" type="checkbox"/> RELIGION
<input type="checkbox"/> 1400-1499	<input checked="" type="checkbox"/> ARCHEOLOGY-HISTORIC	<input type="checkbox"/> CONSERVATION	<input type="checkbox"/> LAW	<input type="checkbox"/> SCIENCE
<input type="checkbox"/> 1500-1599	<input checked="" type="checkbox"/> AGRICULTURE	<input type="checkbox"/> ECONOMICS	<input type="checkbox"/> LITERATURE	<input type="checkbox"/> SCULPTURE
<input type="checkbox"/> 1600-1699	<input checked="" type="checkbox"/> ARCHITECTURE	<input checked="" type="checkbox"/> EDUCATION	<input type="checkbox"/> MILITARY	<input type="checkbox"/> SOCIAL/HUMANITARIAN
<input checked="" type="checkbox"/> 1700-1799	<input type="checkbox"/> ART	<input type="checkbox"/> ENGINEERING	<input type="checkbox"/> MUSIC	<input type="checkbox"/> THEATER
<input checked="" type="checkbox"/> 1800-1899	<input checked="" type="checkbox"/> COMMERCE	<input type="checkbox"/> EXPLORATION/SETTLEMENT	<input type="checkbox"/> PHILOSOPHY	<input type="checkbox"/> TRANSPORTATION
<input type="checkbox"/> 1900-	<input type="checkbox"/> COMMUNICATIONS	<input type="checkbox"/> INDUSTRY	<input type="checkbox"/> POLITICS/GOVERNMENT	<input type="checkbox"/> OTHER (SPECIFY)
		<input type="checkbox"/> INVENTION		

SPECIFIC DATES

BUILDER/ARCHITECT

STATEMENT OF SIGNIFICANCE

The town of Washington, located in Mason County in northeastern Kentucky, was founded in 1785, making it one of the oldest towns in Kentucky. Now a quiet village bypassed by the main thoroughfare from Lexington to Maysville, Washington was once the second largest town in Kentucky as reported by the first federal census of 1790. Washington became the county seat in 1788 when Mason County was formed and so remained until 1847 when it was moved to the more important rivertown of Maysville (then known as Limestone). Located near the Ohio River and the landing site for settlers migrating west into the Kentucky interior, Washington became a resting spot for travelers and a distribution center for mail for a greater part of the western territory. The town was also the birthplace of Albert Sidney Johnston, one of the most famous of Civil War Confederate generals.<sup>1</sup>

In addition to its historical significance, is the community's architectural value. An assemblage of buildings remain, representing certain stages of the development of Kentucky architecture from the early straightforward and honest log structures of the frontier to the sophisticated brick Georgian and Federal and the intriguing Carpenter's Gothic styles of the mid-19th century. The rich variety of buildings include a "flat-boat house"--the only surviving example of this unique kind of structure--a bank, an inn, row buildings, churches, a school building, a fine group of homes in log, frame, brick, and stone construction, and dependency buildings of several types. Other physical elements of importance are the original walks of stone, the wells, and the first macadamized road west of the Alleghenies.

The beginning of the first permanent settlement in what is now Mason County occurred in May 1775, when a group of ten men arrived from Virginia to survey and improve lands. One of the men, Jonathan Higgs, located his cabin near the present east end of York Street in Washington. The most influential of the group was Simon Kenton, who cleared about an acre of land on Lawrence Creek near a large spring about 1 1/2 miles from the present site of Washington. Although other emigrants continued to arrive over the next few years, the threat of Indian attack hung over the small stations until after 1782. Although the Battle of Blue Licks fought nearby on August 19, 1782, ended with an

<sup>1</sup>The historical background presented in #8, page 1 through 3, is condensed from documented material found in Washington, Kentucky Preservation Development.

## 9 MAJOR BIBLIOGRAPHICAL REFERENCES

- Best, Edna H. "The Historic Past of Washington, Mason County, Kentucky," Pamphlet, 1944.  
 Clift, G. Glenn. History of Maysville and Mason County. Lexington: Transylvania Printing Co., 1936.  
 Coleman, J. Winston, Jr. Historic Kentucky. Lexington: Henry Clay Press, 1968.  
 (continued)

## 10 GEOGRAPHICAL DATA

ACREAGE OF NOMINATED PROPERTY 180, including original district  
 UTM REFERENCES D. Longitude:  $83^{\circ} 48' 40''$  Lat:  $38^{\circ} 37' 20''$   
 C. Longitude:  $83^{\circ} 48' 45''$  Latitude:  $38^{\circ} 36' 42''$   
 A. Longitude:  $83^{\circ} 48' 14''$  Latitude:  $38^{\circ} 37' 18''$   
 B. Longitude:  $83^{\circ} 48' 18''$  Latitude:  $38^{\circ} 36' 41''$

A	ZONE	EASTING	NORTHING	B	ZONE	EASTING	NORTHING
C	ZONE	EASTING	NORTHING	D	ZONE	EASTING	NORTHING

VERBAL BOUNDARY DESCRIPTION

LIST ALL STATES AND COUNTIES FOR PROPERTIES OVERLAPPING STATE OR COUNTY BOUNDARIES

STATE	CODE	COUNTY	CODE
STATE	CODE	COUNTY	CODE

## 11 FORM PREPARED BY

NAME / TITLE

Louis N. Browning, President

GM/FW

ORGANIZATION

Old Washington, Inc.

DATE

November 1974

STREET & NUMBER

R.R. 2, Box 23

TELEPHONE

CITY OR TOWN

Maysville

STATE

Kentucky

## 12 STATE HISTORIC PRESERVATION OFFICER CERTIFICATION

THE EVALUATED SIGNIFICANCE OF THIS PROPERTY WITHIN THE STATE IS:

NATIONAL

STATE

LOCAL

As the designated State Historic Preservation Officer for the National Historic Preservation Act of 1966 (Public Law 89-665), I hereby nominate this property for inclusion in the National Register and certify that it has been evaluated according to the criteria and procedures set forth by the National Park Service.

STATE HISTORIC PRESERVATION OFFICER SIGNATURE

*Eldred W. Mellon*

4/27/76

TITLE State Historic Preservation Officer

DATE

FOR NPS USE ONLY

I HEREBY CERTIFY THAT THIS PROPERTY IS INCLUDED IN THE NATIONAL REGISTER

DATE

5/28/96

ATTEST: *William L. ...*  
 DIRECTOR, OFFICE OF ARCHEOLOGY AND HISTORIC PRESERVATION

DATE

5/26/76

KEEPER OF THE NATIONAL REGISTER

UNITED STATES DEPARTMENT OF THE INTERIOR  
NATIONAL PARK SERVICE

**NATIONAL REGISTER OF HISTORIC PLACES  
INVENTORY -- NOMINATION FORM**

FOR NPS USE ONLY

APR 29 1976

RECEIVED

DATE ENTERED

CONTINUATION SHEET

ITEM NUMBER 8

PAGE 2

American defeat, it became the last important battle against the Indians on Kentucky soil. Thereafter settlement rapidly increased.

A major route into Kentucky was by way of the Ohio River, the landing at Limestone (renamed Maysville in 1793) on the Ohio, and taking Smith's Wagon Road into the Bluegrass. It was this proximity to the Ohio and the flow of immigration traffic that saw the rise and eventual rivalry of Washington and Maysville.

In 1785, an important land transaction occurred between Simon Kenton, who had one year previous established a station near the future site of Washington, and two Virginians, Arthur Fox and William Wood. Kenton sold 700 acres to the men, who decided to lay out a one-mile-square grid-iron site, sell lots, and turn a profit. Expectations were high--the town was named Washington with the intention that it would possibly become the national capital; it was the first town in America to be so named. The ample plan with "in" and "out" lots would have been more than sufficient to accommodate the Federal Government of the time and the idea of placing the center of administration toward the West appealed to many. Fortunately, since the capital was eventually located elsewhere, the site proved to be a successful one without this incentive. Those settlers who landed at Limestone and who wished to travel to the Kentucky interior had to negotiate a steep hill to the plateau three and one-half miles away where Washington stands. It required a full day to drive a heavily loaded wagon that short distance and so most elected to stop overnight at the town before continuing their inland journey. Failing that, almost every traveller stopped at least for refreshment or directions. And so this commercial basis guaranteed a certain amount of prosperity in the early years of the town.

A list of taxed property was prepared in 1790 in order to raise the maintenance funds needed for the town. According to a contemporary description, Washington was "a village of log cabins" but the first U.S. Census lists four hundred sixty-two residents living in one hundred nineteen houses.

Since the establishment of Washington, there had been constant land transactions. Fox and Wood continued to sell lots and gradually, with the construction of public as well as private buildings, the general fabric of the town began to take on character.

(continued)

UNITED STATES DEPARTMENT OF THE INTERIOR  
NATIONAL PARK SERVICE

FOR NPS USE ONLY

RECEIVED APR 29 1976

DATE ENTERED

**NATIONAL REGISTER OF HISTORIC PLACES  
INVENTORY -- NOMINATION FORM**

CONTINUATION SHEET

ITEM NUMBER 8

PAGE 3

Confusion about lot lines, however, caused the Kentucky General Assembly to pass an act on December 19, 1793, which determined the widths of Main, William, York, Water, and Green Streets. It also required that no new buildings could be erected without application to the Board of Trustees and that a survey of the town be undertaken, which was completed October 10, 1794.

The most important building in the town, the Mason County Courthouse, was built in 1794 and signaled a most productive period in Washington's history. The town had already become one of the most dominant in the state. Now the post office became the mail distribution center for the entire Northwest Territory including the present states of Ohio, Indiana, Illinois, Michigan and Wisconsin. Not only had the mail service increased, but the influx of lawyers and others concerned with court activities resulted in the establishment of a number of taverns and inns providing accommodations and amenities.

This political, religious, and educational center of the county was well described in a letter written by Edward Harris of Washington to a friend in New Hampshire dated April 11, 1797: (Washington, Kentucky Preservation Development, p.18, Appendix D)

I live in the County town: which is about a square mile laid out in three main streets north & south, between the two streets are house lots of half an acre each, measuring each way from the center street: the rest of the land is laid out in five acre lots on each side of the back streets; there are three streets running east & west at such distance with a number of allys as to make it convenient to come at the lots, we have a court house built with stone, a Gaolors [jailor's] house of brick & 1/2 feet long placed so as the ends to make the inside & out of the room, a thick stone wall 15 feet high surrounds the Gaol, There is a considerable number of large Stone & Brick houses in the main street, there is but one meeting house & that is a Baptist, the Presbyterians are but few in number & meet in the court house: there has of late been a great stur among the baptists & and a great many persons diped; I esteem their doctrines very corrupt. We are a mixture of many sorts of people & religions which makes Church & State difficult to manage. . . .  
(Edward Harris)

Another account by a Philadelphia merchant named Espy estimated that Washington was "a thriving community with one hundred fifty houses only ten or twelve of which were masonry " (Washington, Kentucky Preservation Development, p. 19).

(continued)

UNITED STATES DEPARTMENT OF THE INTERIOR  
NATIONAL PARK SERVICE

**NATIONAL REGISTER OF HISTORIC PLACES  
INVENTORY -- NOMINATION FORM**

<b>FOR NPS USE ONLY</b>	
RECEIVED	APR 29 1976
DATE ENTERED	

CONTINUATION SHEET

ITEM NUMBER 8

PAGE 4

After the turn of the century, particularly following the War of 1812, Washington experienced a slow decline. One traveler passing through on November 25, 1818, described the town as being "laid out on a large plan but not thriving. . . ." Disaster struck in April of 1825 when a fire destroyed thirteen buildings including two taverns. Another misfortune occurred in 1820 when the Lexington and Ohio Railroad was laid out from Lexington to the Ohio River bypassing Washington, a serious blow to the future economy of the town. Added catastrophe came with the outbreak of Asiatic cholera in 1832 and '33 and resulted in a marked decrease in population. The nearby town of Maysville, however, experienced rapid development between 1830 and 1850, surpassing the growth of Washington.

During the 1840s Maysville's importance was steadily becoming more and more evident. What had been a mere boat landing for pioneers traveling inland had become a progressive seat of commerce and center of transportation. It no longer required a full day to travel to Washington and the pioneer frontier that once was Kentucky did not hold the interests of adventurers and new settlers. They were able to travel much farther west. The inevitable happened and in 1847 the decision was made to transfer the county seat from Washington to Maysville (see the nomination form for the Maysville Courthouse Square and "Mechanics' Row" Historic District, listed on the National Register May 12, 1975).

From the turn of the century to the present time, Washington has experienced very few physical alterations. When the highway by-passed the town, Washington was virtually preserved. The major changes occurred in 1909 when the former courthouse, then converted into a school, was struck by lightning and burned. The loss of the building was a serious one. As the focal point of the town it had given continuity not only architecturally but historically.

Also included in the district is the old Baptist cemetery which, from the earliest days, appears to have been part of the town and where one of the founders of the town, Arthur Fox, is buried. The cemetery, established on land formerly owned by Simon Kenton, is described by Kentucky historian Richard Collins in a narrative about the Washington Baptist Church:

In 1871, was torn down, and a new one erected on its site, the old Baptist church in Washington, the first house of worship built in northern Kentucky and one of the very first in the state. The church was constituted, and the building

(continued)



UNITED STATES DEPARTMENT OF THE INTERIOR  
NATIONAL PARK SERVICE

FOR NPS USE ONLY

RECEIVED

APR 29 1976

DATE ENTERED

**NATIONAL REGISTER OF HISTORIC PLACES  
INVENTORY -- NOMINATION FORM**

CONTINUATION SHEET

ITEM NUMBER 8

PAGE 5

erected in 1785, upon ground given by Rev. William Wood, their first preacher; who also gave the ground around it for a grave-yard, setting apart the northeast corner for strangers.... In the grave-yard, the oldest stone with an inscription is of undressed limestone; the lettering, rudely carved with a chisel and now almost illegible, is 'Heare lies the body of John Coalter, eaged 50 years, deceased July 7th, 1789.' An Indian chief, and several of his wives and warriors, are buried in this ground. (Collins, p. 559)

Among the Revolutionary War veterans listed in the DAR records as being buried in the cemetery are Arthur Fox (with William Wood, co-founder of Washington), George Wood, and Joseph Cox.

At the northeast end of town is St. Patrick's Roman Catholic Cemetery.

Archaeological Report

An historic archaeological survey was completed during the summer of 1975 in order that preservation development plans would cover all aspects of the township. This survey shed new light on an integral component which had not been previously addressed. The physical survey and historical research of others led to the discovery of numerous historic archaeological sites both inside and outside of the original historic district boundary. In addition to this, close attention was paid to the historic archaeological components of extant buildings.

In a township such as Washington, it is difficult to discuss individual archaeological sites or areas, for they should be viewed as a continuous, almost interwoven, facet of the district. Nevertheless, specific sites which need to be brought to light are the Courthouse, Johnston Kitchen, Osborne Garden with nearby stable and alley, a jail, Post Office, and numerous sites of previous dependencies.

The surface collection of artifacts within the township provided a good chronological overview of the areas cultural remains and their development. A total of 1,858 artifacts were recovered from the surface, and represent occupational periods from c. 1785 through more recent times. Pearlware, numerous varieties of ironstone, various heavy stonewares including American blue on grey, were collected throughout the township.

(continued)

UNITED STATES DEPARTMENT OF THE INTERIOR  
NATIONAL PARK SERVICE

**NATIONAL REGISTER OF HISTORIC PLACES  
INVENTORY -- NOMINATION FORM**

FOR NPS USE ONLY

RECEIVED

APR 29 1975

DATE ENTERED

CONTINUATION SHEET

ITEM NUMBER 8

PAGE 6

Recovered glass artifacts included basal fragments of bottles bearing the pre-circa 1860 pontil scars, dark olive or "black" glass, numerous canning jar fragments, and a considerable amount of the sun-colored amethyst glass characteristic of the 1880-1914 periods. Metallic artifacts were scarce but did include hand-wrought pieces, small iron chains, a boot scraper, and items of 19th century building hardware. These recovered materials will hopefully be developed into an interpretive display as preservation plans progress.

Within the confines of the state, Washington possesses an extremely valuable historical archaeological complex.

UNITED STATES DEPARTMENT OF THE INTERIOR  
NATIONAL PARK SERVICE

FOR NPS USE ONLY

RECEIVED

APR 29 1976

DATE ENTERED

**NATIONAL REGISTER OF HISTORIC PLACES  
INVENTORY -- NOMINATION FORM**

CONTINUATION SHEET

ITEM NUMBER 9

PAGE 2

Collins, Lewis. Historical Sketches of Kentucky. Maysville: By the author, 1847.

County Court and Deed Book Records, Mason County Courthouse.

Lee, Lucy C. A Historical Sketch of Mason County. Louisville: Masonic Home  
Journal, (no date).

Personal records of Humphreys Taylor.

Walden, John D.; Dr. Phillip Noffsinger; Frederick T. Wilson; and others. Washington,  
Kentucky Preservation Development. Washington, Ky: Old Washington, Inc., and  
Washington, Kentucky Historic Township Commission, 1975.

# WASHINGTON

Washington Precinct  
Scale 30 Rods to an Inch



CLARKS RUN		PIKE		CATHOLIC CEMETERY	
47	46	P. Brian 104 M. Carthy 104 102 T. Mackey	P. Jefferson 74 72 70 68	3	22
48	45	Col. M. H. Hunter Ch. A. A. A. W. Hunter H. Warner	P. Jefferson 66 64	4	21
49	44	50 50 38 Mrs. Blanchard	Mrs. W. Larkin C. Larkin S. Warner M. Walker	5	20
50	43	H. H. Maltby 52 52	W. Simpson T. Laughlin A. Moore J. Lashbrook	6	19
51	42	52 52 50 E. Collins Livery Stable D. Barnes Office C. Collins	W. H. Berry A. Burson Meth. Ch. D. H. Hurd D. J. Barnes	7	18
52	41	Col. I. Goggins	M. P. Marshall	8	17
WILLIAMS		S. T.		GREEN	
53	40	R. Hunter Storrs 42 47	Storrs H. Gifford S. Wood	9	16
54	39	Mrs. Goggins	B. Ch. S. Farmen Mrs. J. Farmen Meth. Ch.	10	15
55	38	Bap. Ch.	Mrs. C. Wood	11	14
56	37	R. Hunter 87 88	J. Johnson A. Warner	12	13
57	36	M. Kearney	67 82	13	12
58	35	J. Smithers 93 96	83 84	14	11
59	34	Miss Rankin 87 88	85 86	15	10
YORK		S. T.		GREEN	
78	73	E.S. 733 732 735 735 J. Lane	Mrs. H. J. Wood 710 710 B. D. Chinn 711 712	16	9
79	74	737 739 740 741 742 Presby. Parsonage	713 714 715 716 717 718 719 720	17	8
80	75	745 746 747 748	721 722 723 724	18	7
81	76	749 150 751 752	725 726 727 728	19	6
82	77			20	5

### WASHINGTON BUSINESS REFERENCES.

- James Rogers, Blacksmith and Horseshoer, on Clark's Run, Turnpike.
- N. Goellenstein, Blacksmith. Repairing done at reasonable rates.
- H. D. Knight, Blacksmith. Special attention given to Horseshoeing. Work warranted.
- George Taylor, Dealer in Groceries, Hats, Caps, Boots and Shoes. All of which he will sell cheap for cash. Cash paid for all kinds of country produce.
- D. B. Owens, Farmer and Stock Raiser, Dealer in fine blooded cattle, fine hogs; and manufacturer of pure Crab Cider.
- John R. Masterson, Wholesale Tobacco Dealer.
- C. B. Collins, Carpenter, Contractor and Builder.

Washington Historic District  
Washington, Mason County, Ky.  
An Illustrated Atlas of Mason  
County, Kentucky.

By Lake, Griffin & Stevenson,  
Philadelphia, 1876.

# Plan of the town of Washington TALLY SHEET

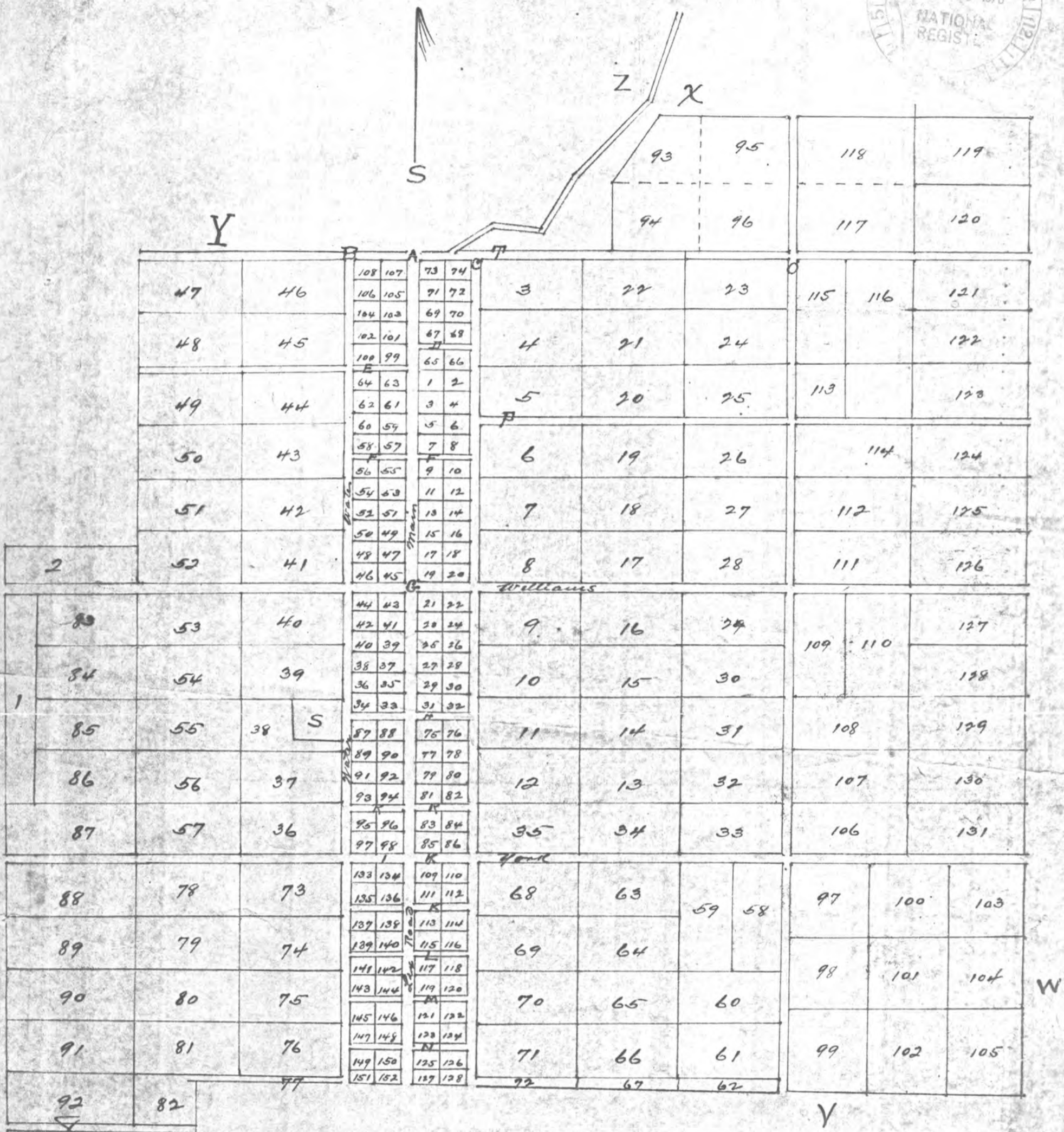

The outlines of this town, Beginning at a sugar tree in the intersection of Wm Ward's & Chas Morgan's lines: thence with the same N 0-15' W 592 poles to a stake; thence S. 89-45' W 1417 poles passing John Lett's South west corner 6 poles to a stake; thence S. 32 30' W 32 poles to a stake; thence S 0-15' E 27 poles to a stake; thence S 89-45' W 1835 poles to a stake; thence S 0-15' E 100 poles to a stake thence S 89-45' W 52 poles to three stumps Simon Keenan & Meredith Helms corner; thence with his line S. 1-30' E 3037 poles to a stake; thence South west corner of Town lots N 89-45' E 6772 poles to two beeches & blue ash trees in Wm Ward's line; thence with the same N 0-15' W 99 poles to a stake, N.W. corner of said Ward's Military survey thence with the same E 320 poles to the beginning. Containing 820 acres & 19 poles.

Scale 40 poles per in

Washington Historic District  
Washington, Mason County, Ky.  
Scale: 40 poles per inch  
Date: 1794

Plan of the town of Washington, on  
file at Mason County Clerk's office,  
Maysville, Kentucky

Oct 10-1794

TALLY SHEET

Explanatory Notes.

A.	Main street,	width. 70 feet
B.	Water street	50
C.	Green street	50
D.	An alley	16
E.	An alley	16
F.	F. An alley	13
G.	Williams street	40
H.	An alley	35
I.	York street	40
K.	An alley	27
L.	An alley	11
M.	An alley	31
N.	An alley	16, 6 inches
O.	An alley	25
P.	Surplus in Out-Lots, Surplus in Out-lots, 2 A. 1 R. 38 P.	31 feet, 11 inches wide
Q.	Ditto.	3 0 34 31 11
R.	R. Ditto on In-lots	1 0 26 27 9
S.	Meeting House lot, 2 acres	
T.	An alley, 25 feet wide.	
U.	Helms line	
V.	V. William Ward's lines	
W.	Edmund Bynes & Chas. Morgan's line	
X.	Corner of John Tebb's Pre-emption	
Y.	Simon Kenton's line	
Z.	The road to Limestone	
&	"A" street by Thomas Forman's	20 feet wide.

James Stevenson & Michael Daugherty, Surveyors.

Contents of the Fractional In-Lots.

No 127.	contains 1 road & 9 poles.
128	" 1 " & 12 "
151	" 0 - 34 <sup>3</sup> / <sub>4</sub> "
152	" 1 - 1 <sup>1</sup> / <sub>4</sub> "

Contents of Fractional Out-Lots.

	A	R	P
No 1-	4-	3-	10
No 2-	4-	3-	20
No 62-	1-	0-	20
No 67-	1-	0-	0
No 72-	0-	3-	20
No 77-	0-	2-	0
No 82	3-	2-	30

Out Lots, exceeding 5 acres &c.

Nos. 136 & 137,	each 16 acres 3 Roads.
Nos 117-118-119 & 120,	each 7 acres 2 "
Nos 110-114 & 116	each 6 acres 1 "
Nos 106-107-108-111-112 121 to 131 inclusive	} each 5 acres. 2 R & 20 poles.
Nos. 97-98-100-101-103 & 104	each 5 acres & 10 poles.
No 99-	contains 5 acres-2 R. & 20.
No-102-	" 5 " 3 R & 25
No 105-	" 6 " & 30
No 87-	" 6 " & 25 <sup>1</sup> / <sub>2</sub>
No 88-	" 6 " & 7 <sup>1</sup> / <sub>2</sub>
No 89-	" 6 " & 3
No 90-	" 5 " 3 R - & 34
No 91	" 5 " 3 R & 29 <sup>1</sup> / <sub>2</sub>
No 92.	" 5 " 3 R & 25



Property Washington Historic District  
State Kentucky Working Number 12,969.2

BOUNDARY REVISION  
INCREASE   
DECREASE \_\_\_\_\_  
MOVE \_\_\_\_\_

TECHNICAL  
Photos 20  
Maps 3

~~Need more recent map for UTM ref.~~  
UTM not available 5.25.76

CONTROL  
OK 4.30.76  
HISTORIAN  
Accept  
Kullerbaum  
5/13/76

ARCHITECTURAL HISTORIAN

BOUNDARY ENLARGEMENT BASED ON HISTORIC  
ARCHEOLOGICAL POTENTIAL (HOUSE SITES) AND TO  
REFLECT ORIGINAL TOWN BOUNDARIES.  
ADD TWO CEMETERIES TO DISTRICT

ACCEPT  
LEBOSEK  
5.10.76  
fall about  
undesignated  
houses in  
western in  
side boundary  
no central  
description

OTHER

REVIEW UNIT CHIEF

Accept  
Cole  
5-14-76

BRANCH CHIEF

KEEPER

Accept  
Hung  
5.17.76

I HEREBY CERTIFY THAT THIS BOUNDARY REVISION IS ACCEPTED

\_\_\_\_\_  
DIRECTOR, OFFICE OF ARCHEOLOGY AND HISTORIC PRESERVATION

DATE \_\_\_\_\_

ATTEST:  
\_\_\_\_\_  
KEEPER OF THE NATIONAL REGISTER

DATE \_\_\_\_\_

THIS FORM IS TO BE FILED WITH THE NATIONAL REGISTER NOMINATION.  
State notified \_\_\_\_\_ Federal Register \_\_\_\_\_ Control Cards \_\_\_\_\_ ADP \_\_\_\_\_





























HAVEN CHAPEL  
METHODIST CHURCH  
BUILT IN 1882  
REBUILT IN 1941  
REV. NICHAYO HUGHES PASTOR

















ARTHUR FOX  
born 21<sup>th</sup> Feb<sup>y</sup>  
1764  
departed this life  
11<sup>th</sup> April 1794  
aged 33 Years 1 month  
15 Days

C. Longitude: 83° 48' 45"  
Latitude: 38° 36' 42"  
D. Longitude: 83° 48' 40"  
Latitude: 38° 37' 20"

A. Longitude: 83° 48' 14"  
Latitude: 38° 37' 18"  
B. Longitude: 83° 48' 18"  
Latitude: 38° 36' 41"

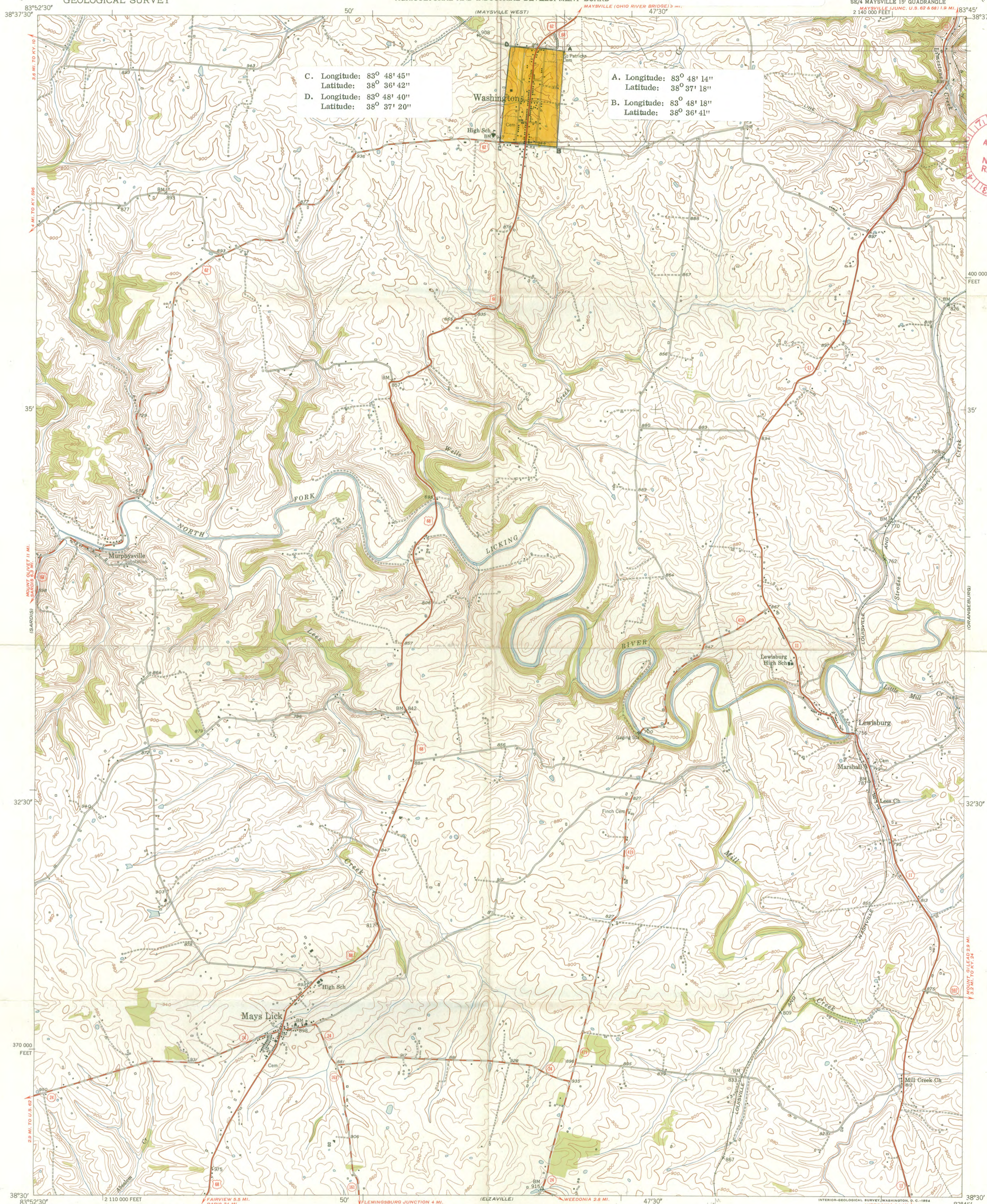

83°52'30" Mapped, edited, and published by the Geological Survey  
Control by USGS and USC&GS  
Topography from aerial photographs by multiplex methods  
Aerial photographs taken 1950. Field check 1952  
Polyconic projection. 1927 North American datum  
10,000-foot grid based on Kentucky coordinate system,  
north zone

TRUE NORTH  
MAGNETIC NORTH  
APPROXIMATE MEAN  
DECLINATION, 1952

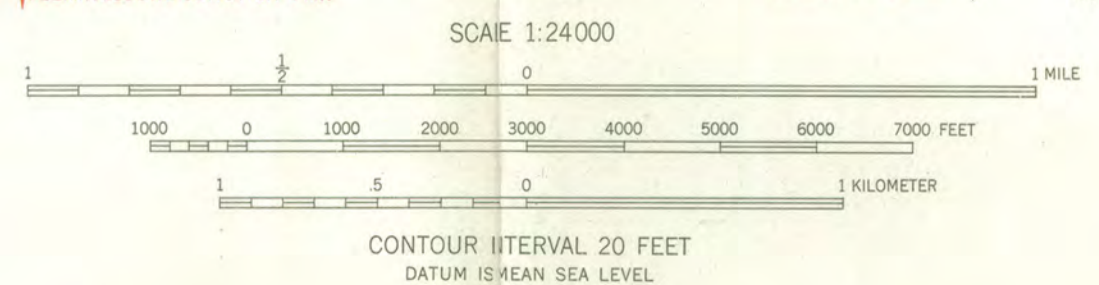

ROAD CLASSIFICATION

Heavy-duty	4 LANE 16 LANE	Light-duty
Medium-duty	4 LANE 16 LANE	Unimproved dirt

U.S. Route State Route

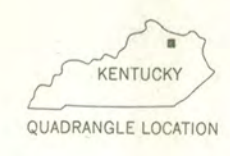

MAYS LICK, KY.  
SE 1/4 MAYSVILLE 15' QUADRANGLE  
N3830-W8345/7.5

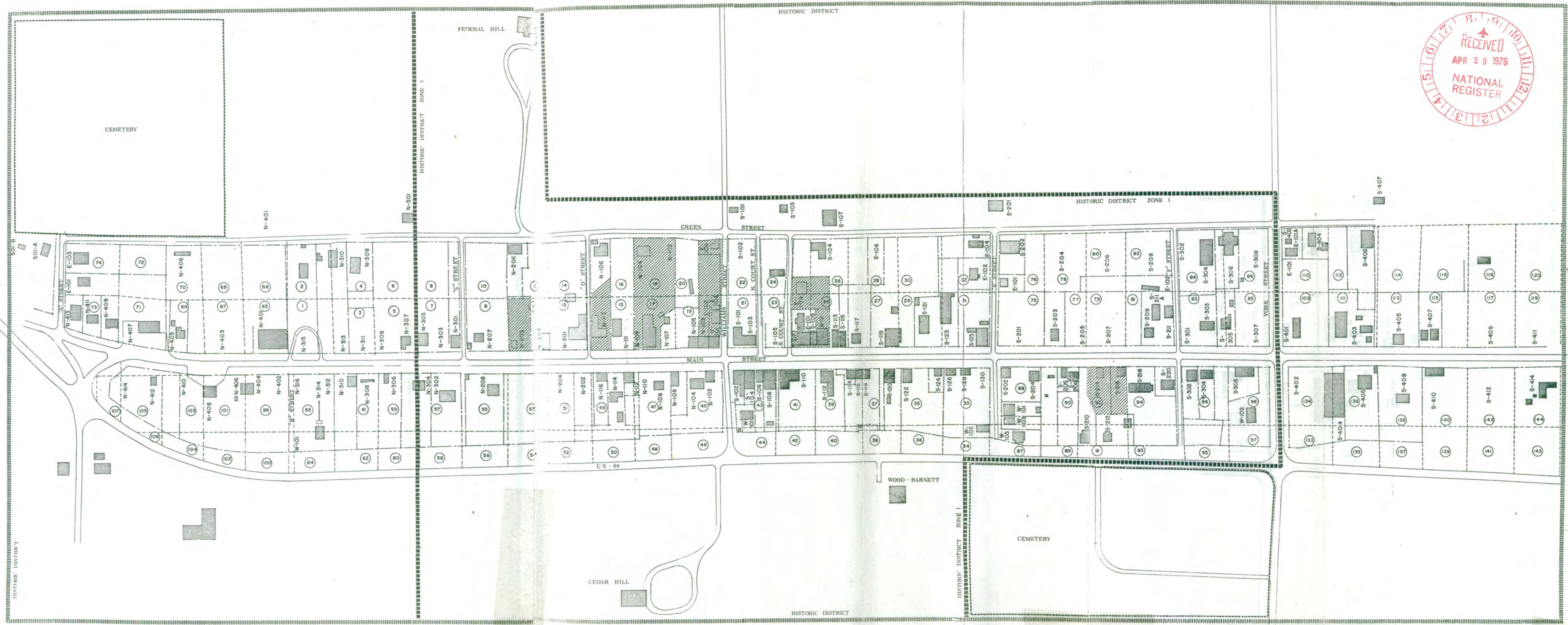

**LEGEND**

- EXISTING STRUCTURES
- PUBLIC SPACES
- N-101 INVENTORY INDEX NUMBER
- LOT NUMBER - PRECINCT MAP OF 1876
- EXISTING PROPERTY LINES
- PROPERTY LINES PRECINCT MAP OF 1876
- HISTORIC DISTRICT BOUNDARY
- HISTORIC DISTRICT ZONE 1 BOUNDARY

N

0 100 200  
ft.  
S C A L E

**BUILDINGS AND SITES INDEX MAP**

**WASHINGTON : PRESERVATION DEVELOPMENT**  
 WASHINGTON, KENTUCKY  
 AUGUST 1975

JOHN D. WALDEN  
 ARCHITECT  
 WINCHESTER KENTUCKY

V.S. VOIGT, SAGE & PFLUM  
 CONSULTANTS  
 CINCINNATI OHIO



*Kentucky Heritage Commission*  
*104 Bridge Street*  
*Frankfort, Kentucky 40601*  
April 26, 1976

Dr. William J. Murtagh, Keeper  
National Register of Historic Places  
National Park Service  
18th and C Streets, N. W.  
Washington, D. C. 20240

Dear Dr. Murtagh:

Enclosed is the National Register of Historic Places nomination form for Washington Historic District in Washington, Mason County, Kentucky. The original district was placed on the National Register January 21, 1970. The enlarged district was approved by the Kentucky Preservation Review Board March 25, 1975.

The form contains largely information included in Washington, Kentucky Preservation Development, a comprehensive report that was prepared for the direction of Washington's future restoration. A copy was forwarded by Mr. William J. Hearn, Restoration Co-ordinator for the Kentucky Heritage Commission, to Mr. George Emery of your staff in early 1975.

We understand that there will be a grant-in-aid application forthcoming from Historic Washington for inclusion in Kentucky's FY 1977 Apportionment Warrant. Your earliest possible consideration of the nomination, therefore, would be appreciated.

Sincerely yours,

*Eldred W. Melton*

Mrs. Eldred W. Melton  
State Historic Preservation Officer



Enclosure (See List of Attachments)



Dr. William J. Murtagh

April 26, 1976

Page 2

Washington Historic District, Mason County, Kentucky

#### LIST OF ATTACHMENTS

National Register of Historic Places Nomination Form

7 Continuation Sheets

4 Maps

20 Photos

May 11

TELEPHONE REPORT

9:20



1. CALL  TO:  FROM (Name)

WALTER LANGSAM

2. ADDRESS (Tel. No. if needed)

KY

3. SUBJECT, PROJECT NO., ETC.

WASHINGTON HISTORIC DISTRICT

4. DETAILS OF DISCUSSION

What are the structures on northwest side within new boundaries? Gloria Mills will call back with information

GLORIA May 12 10:30

other structures on map

{ ell shaped church 20th C  
3 other structures are 20th C residence

} less than 50 years old

boundary

verbal description included in section 7, paragraph 3

NAME OF PERSON PLACING/RECEIVING CALL

TITLE

OFFICE

WM LEBONCH

ARCH HISTORIAN

National Register

ENTRIES IN THE NATIONAL REGISTER

STATE      KENTUCKY

Date Entered      MAY 28 1976

<u>Name</u>	<u>Location</u>
Washington Historic District	Washington Mason County

Boundary change approved 5/28/76

Also Notified

State Historic Preservation Officer  
Mrs. Eldred W. Melton  
Director  
Kentucky Heritage Commission  
104 Bridge Street  
Frankfort, Kentucky 40601

PR      MMott/row      6/11/76

**NOTIFICATION OF GRANT-IN-AID ACTION**

Do Not Use This Space

1. STATE APPLICATION IDENTIFIER

2. (Reserved for use by State central information reception agency)

75-020

3. GRANTOR: a. Federal agency

Department of the Interior

b. Organizational unit

National Park Service

c. Administering office - (1) Name

Division of Grants

(2) Address - Street or P.O. Box

18th and C Streets, NW.

City

Washington

State

D.C.

Zip Code

20240

4. FEDERAL AGENCY GRANT IDENTIFIER: a. Code

21-75-00076-12

b. Title

Washington Historic District:  
Old Church Development

c. Purpose Project work will include attic and underfloor insulation, interior and exterior painting, installation of gutters, repair of the front doors, and the architect's fee.

5. GRANTEE: a. Name

Kentucky Mrs. Eldred W. Melton, Director, Kentucky Heritage Commission

b. Address - Street or P.O. Box

401 Wapping Street

City

Frankfort

State

Kentucky

Zip Code

40601

6. GRANTEE TYPE (Check only the single most applicable box)

a. State  b. Inter-state  c. County  d. City  e. School district  f. Special unit  g. Community action  h. Sponsored organization  i. Other

7. APPLICATION RECEIPT DATE

Year: 75, Month: 10, Day: 09

8. ACTION DATE

Year: 75, Month: 10, Day: 29

9. EFFECTIVE STARTING DATE

Year: 75, Month: 10, Day: 29

10. ENDING DATE

Year: 78, Month: 10, Day: 28

11. TYPE OF ACTION (Check as many boxes as apply to this action)

a. New grant  b. Continuation grant  c. Supplemental grant (identify agency in item 16)  d. Change in existing grant (1) Increase in duration  (2) Decrease in duration  (3) Cancellation  (4) Increase (\$)  (5) Decrease (\$)

12. AMOUNT OF CONTRIBUTION

a. Federal - (1) basic \$ 3,030 (2) Supplemental \$

b. State

\$3,030\*

c. Local \$

d. Other \$

13. CATALOG OF FEDERAL DOMESTIC ASSISTANCE PROGRAM (if none, clarify in item 16)

a. Program Number 15.904

b. Supplemental Program Number

14. AUTHORIZATION

a. Federal Budget Accounts 10-58-1040-0-1-405

b. Public Laws

PL Title Sec. 89 665

PL Title Sec.

PL Title Sec.

c. U.S. Code

16 U.S.C. 470

15. FACILITY LOCATION: (For facility grant actions only)

a. City Main Street, Washington

b. County Mason

16. REMARKS

\*Old Church Society - donated funds & donated architectural services

NOTIFICATION OF GRANT-IN-AID ACTION

Do Not Use This Space

1. STATE APPLICATION IDENTIFIER

75-744

2. (Reserved for use by State central information reception agency)

3. GRANTOR: a. Federal agency

Department of the Interior

b. Organizational unit

National Park Service

c. Administering office - (1) Name

Division of Grants

(2) Address - Street or P.O. Box

18th and C Streets, NW.

City

Washington

State

D. C.

Zip Code

20240

4. FEDERAL AGENCY GRANT IDENTIFIER: a. Code

21-73-00026-02

b. Title

Washington Historic District: Paxton-Evans House Acquisition

c. Purpose

This house, a 2 story brick structure, reflects the early architecture of the town dating from 1810. The property will be acquired by the Limestone Heritage Foundation.

5. GRANTEE: a. Name

Kentucky Mrs. Eldred W. Melton, Director, Kentucky Heritage Commission

a. Address - Street or P.O. Box

401 Wapping Street

City

Frankfort

State

Kentucky

Zip Code

40601

6. GRANTEE TYPE (Check only the single most applicable box)

a. State

b. Inter-state

c. County

d. City

e. School district

f. Special unit

g. Community action

h. Sponsored organization

i. Other

7. APPLICATION RECEIPT DATE

Year Month Day  
75 05 05

8. ACTION DATE

Year Month Day  
75 05 29

9. EFFECTIVE STARTING DATE

Year Month Day  
75 05 29

10. ENDING DATE

Year Month Day  
78 05 28

11. TYPE OF ACTION (Check as many boxes as apply to this action)

a. New grant

b. Continuation grant

c. Supplemental grant (identify agency in item 16)

d. Change in existing grant

(1) Increase in duration

(2) Decrease in duration

(3) Cancellation

(4) Increase(\$)

(5) Decrease(\$)

12. AMOUNT OF CONTRIBUTION

a. Federal - (1) basic

\$ 15,200

(2) Supplemental

\$

b. State

\$ 15,200\*

c. Local

\$

d. Other

\$

13. CATALOG OF FEDERAL DOMESTIC ASSISTANCE PROGRAM (if none, clarify in item 18)

a. Program Number

15.904

b. Supplemental Program Number

14. AUTHORIZATION

a. Federal Budget Accounts

10-58-1040-0-1-405

b. Public Laws

PL Title Sec.  
89 665

PL Title Sec.

PL Title Sec.

c. U.S. Code

16 U.S.C. 470

15. FACILITY LOCATION: (For facility grant actions only)

a. City Main Street, Washington

b. County

Mason

16. REMARKS

\*Limestone Heritage Foundation, agent for Limestone Chapter of D.A.R.

**NOTIFICATION OF GRANT-IN-AID ACTION**

Do Not Use This Space

1. STATE APPLICATION IDENTIFIER  
75-620

2. (Reserved for use by State central information reception agency)

3. GRANTOR: a. Federal agency  
Department of the Interior

b. Organizational unit  
National Park Service

c. Administering office—(1) Name  
Division of Grants

(2) Address—Street or P.O. Box  
18th and C Streets, NW.

City  
Washington

State  
D.C.

Zip Code  
20240

4. FEDERAL AGENCY GRANT IDENTIFIER: a. Code  
21-75-00076-00

b. Title  
Washington H. D.: Washington Hall Development

c. Purpose  
Project work will involve removal of non-original features, carpentry, thermal and moisture protection, interior and exterior painting, and mechanical and electrical systems to code required level.

5. GRANTEE: a. Name  
Ky., Mrs. Eldred W. Melton, Director, Kentucky Heritage Commission

b. Address—Street or P.O. Box  
401 Wapping Street

City  
Frankfort

State  
Kentucky

Zip Code  
40601

6. GRANTEE TYPE (Check only the single most applicable box)

a. State  b. Inter-state  c. County  d. City  e. School district  f. Special unit  g. Community action  h. Sponsored organization  i. Other

7. APPLICATION RECEIPT DATE  
Year Month Day  
75 10 03

8. ACTION DATE  
Year Month Day  
75 10 22

9. EFFECTIVE STARTING DATE  
Year Month Day  
75 10 22

10. ENDING DATE  
Year Month Day  
78 10 21

11. TYPE OF ACTION (Check as many boxes as apply to this action)

a. New grant  b. Continuation grant  c. Supplemental grant (identify agency in item 16)  d. Change in existing grant (1) Increase in duration  (2) Decrease in duration  (3) Cancellation  (4) Increase(\$) (5) Decrease(\$)

12. AMOUNT OF CONTRIBUTION

a. Federal—(1) basic \$ 2,550 (2) Supplemental \$

b. State \$ 3,630\* c. Local \$

d. Other \$

13. CATALOG OF FEDERAL DOMESTIC ASSISTANCE PROGRAM (if none, clarify in item 16)

a. Program Number  
15.904

b. Supplemental Program Number

14. AUTHORIZATION

a. Federal Budget Accounts 10-58-1040-0-1-405

b. Public Laws PL Title Sec. 89 665

c. U.S. Code 16 U.S.C. 470

15. FACILITY LOCATION: (For facility grant actions only)

a. city  
Washington

b. County  
Mason

16. REMARKS

\* Funds owners: Mr. and Mrs. C. Manning

# NR Data Sheet

PH0004227

DATE: 5-10-76  
Reviewer INITIALS: LEC/DCU  
NR DOE

NAME AS IT APPEARS IN FEDERAL REGISTER: *Washington Historic District*

OTHER NAMES: *Old Washington*

*B boundary change approved 5/28/76  
① add other names  
② location change*

LOCATION: *U.S. 62/68*

STREET & NUMBER

CITY, TOWN *Washington*

CONGRESSIONAL DISTRICT *01*

STATE *Ky*

VICINITY OF

*021*

COUNTY code

*Mason 161*

OWNER OF PROPERTY: (Circle) PRIVATE STATE LOCAL GOV'T MUNICIPAL COUNTY OTHER

ADMINISTRATOR (underline) FEDERAL (AGENCY NAME):

NPS REGION: (CIRCLE) N. ATLANTIC MID ATLANTIC SOUTHEAST MIDWEST

SOUTHWEST ROCKY MOUNTAIN WEST PACIFIC NORTHWEST

## FEATURES:

<u>INTERIOR</u>	<u>EXTERIOR</u>	<u>ENVIRONS</u>
<input type="checkbox"/> Substantially intact-1	<input type="checkbox"/> Substantially intact-2	<input type="checkbox"/> Substantially intact-3
<input checked="" type="checkbox"/> unknown - 4	<input checked="" type="checkbox"/> unknown - 5	<input checked="" type="checkbox"/> unknown - 6
<input type="checkbox"/> not applicable - 7	<input type="checkbox"/> not applicable - 8	<input type="checkbox"/> Not applicable - 9

Interior, exterior, environs not intact-0

CONDITION -	<input type="checkbox"/> EXCELLENT	<input type="checkbox"/> DETERIORATED	<input type="checkbox"/> UNALTERED	<input checked="" type="checkbox"/> ORIGINAL SITE
	<input checked="" type="checkbox"/> GOOD	<input type="checkbox"/> RUINS	<input checked="" type="checkbox"/> ALTERED	<input type="checkbox"/> MOVED
	<input type="checkbox"/> FAIR	<input type="checkbox"/> UNEXPOSED	<input type="checkbox"/> Reconstructed	<input type="checkbox"/> Unknown
		<input type="checkbox"/> Unexcavated	<input type="checkbox"/> Excavated	

ACCESS - Yes-restricted Yes-unrestricted No access Unknown

historic district? YES NO

WITHIN NATIONAL REGISTER HISTORIC DISTRICT? YES NO  
IF YES, NAME:

WITHIN NATIONAL HISTORIC LANDMARK? YES NO  
IF YES, NAME:

ADAPTIVE USE: YES NO Saved? YES NO

FUNCTION(S): (use vocabulary words)

then- *mixed*

now- *mixed*

## SIGNIFICANCE:

- |  |   |   |  |   |
|--|---|---|--|---|
| <input checked="" type="checkbox"/> ARCHEOLOGY-PREHISTORIC | <input type="checkbox"/> CONSERVATION         | <input type="checkbox"/> LANDSCAPE ARCHITECTURE | <input type="checkbox"/> RELIGION            | <input type="checkbox"/> entertainment  |
| <input checked="" type="checkbox"/> ARCHEOLOGY-HISTORIC    | <input type="checkbox"/> ECONOMICS            | <input type="checkbox"/> LAW/Gov't/politics     | <input type="checkbox"/> SCIENCE             | <input type="checkbox"/> health         |
| <input checked="" type="checkbox"/> AGRICULTURE            | <input checked="" type="checkbox"/> EDUCATION | <input type="checkbox"/> LITERATURE             | <input type="checkbox"/> SOCIAL/HUMANITARIAN | <input type="checkbox"/> recreation     |
| <input checked="" type="checkbox"/> ARCHITECTURE           | <input type="checkbox"/> ENGINEERING          | <input type="checkbox"/> MILITARY               | <input type="checkbox"/> TRANSPORTATION      | <input type="checkbox"/> settlement     |
| <input type="checkbox"/> ART                               | <input type="checkbox"/> EXPLORATION          | <input type="checkbox"/> MUSIC                  | <input type="checkbox"/> OTHER (SPECIFY)     | <input type="checkbox"/> socio/cultural |
| <input checked="" type="checkbox"/> COMMERCE               | <input type="checkbox"/> INDUSTRY             | <input type="checkbox"/> PHILOSOPHY             |  | <input type="checkbox"/> urban & commun |
| <input type="checkbox"/> COMMUNICATIONS                    | <input type="checkbox"/> INVENTION            | <input type="checkbox"/> POLITICS/GOVERNMENT    |  | <input type="checkbox"/> planning       |

## Claims

"first?" YES NO

"oldest?" YES NO

"only?" YES NO

ARCHITECTURAL STYLE: *FEDERAL, AND ITALIANATE*

architect/m.builder:

engineer:

landscape/garden designer:

artist/artisan:

interior decorator:

builder/contractor:

ETHNIC GROUP:

NAMES:

personal

(label role

&

appropriate date)

events

institutional

DATES:

DATE OF CONSTRUCTION (Specific date or 1/4 of century): *early 19th C*

DATE(S) OF "MAJOR" ALTERATIONS:

HISTORICALLY SIGNIFICANT DATE(S):

SOURCE:

(OF NOMINATION)

PRIVATE

STATE

LOCAL GOV'T

MUNICIPAL

COUNTY

OTHER

FEDERAL AGENCY:

ACREAGE:

(to nearest tenth of an acre)

*100*

*180 acres (including avg. dist.)*

COMMENTS: (include architectural information here)

*DISTRICTS CONSISTS OF <sup>BRICK</sup> FRAME AND LOG STRUCTURES ORGANIZED  
PRIMARILY ALONG NORTH/SOUTH STREETS. TWO CEMETERIES ALONG  
EDGES OF DISTRICT.*

SIGNIFICANCE: (maximum two sentences)

*In addition to being one of the oldest towns in Ky and the birthplace  
of Albert Sidney Johnston, the assemblage of buildings represent certain  
stages of the development of Ky architecture from the early shanty town  
and house log structures of the frontier to the sophisticated brick  
Georgian and Federal and the intriguing Carpenter's Gothic of the  
mid 19th C. Also, the district possess an extremely valuable  
historical archaeological complex.*