

KENTUCKY HISTORIC RESOURCES INVENTORY

Site No. Tm-B-29

1. Historic Name(s)		22. ADD County	
Original Owner		No. Ky. / Trimble 1 1 2	
2. Present Name		23. U.S.G.S. Quadrant (15'/75')	
Coleman House		Bedford 	
3. Location		24. UTM Reference	
Main Street Bedford		1 6 6 4 6 4 2 0 4 2 7 2 5 0 0 0	
4. Owner's Name		Zone Easting Northing	
Mrs. Helen M. Moore		25. Coordinate Accuracy 	
5. Owner's Address		26. Prehistoric Site Object	
Route 3, Bedford, Kentucky		Historic Site Structure	
6. Open to Public		(Building) Other	
Yes <input type="checkbox"/> No <input checked="" type="checkbox"/>		27. National Register District Name:	
7. Visible from road		Historic Resources of	
Yes <input checked="" type="checkbox"/> No <input type="checkbox"/>		Trimble County 	
8. Ownership		28. Significance Evaluation	
Private <input checked="" type="checkbox"/>		National Register 	
Local <input type="checkbox"/>		29. Status	
State <input type="checkbox"/>		National Landmark <input type="checkbox"/> Date	
Federal <input type="checkbox"/>		National Register <input type="checkbox"/>	
9. Local Contact/Organization		Landmark Certificate <input type="checkbox"/>	
		Kentucky Survey <input type="checkbox"/>	
		Local Landmark <input type="checkbox"/>	
		HABS HAER <input type="checkbox"/>	
10. Site Plan with North Arrow		30. Historic Theme	
		Primary Architecture C	
		Secondary <input type="checkbox"/>	
		Other <input type="checkbox"/>	
		31. Endangered	
		Yes <input type="checkbox"/> No <input checked="" type="checkbox"/>	
		32. Preservation Project Status <input type="checkbox"/>	
		Actual Cost in \$1,000s 	
11. Architect		33. ATTACH PHOTO	
12. Builder			
13. Date			
ca. 1810-1825 A. <input checked="" type="checkbox"/> B. <input type="checkbox"/>		Roll No. 56	
14. Style		Picture No. 1 - 28	
A. Federal <input checked="" type="checkbox"/>		Direction	
B. <input type="checkbox"/>		34. Prepared by:	
15. Original Use		William Gus Johnson	
Dwelling <input checked="" type="checkbox"/>		Sr. Historian & Photographer	
16. Present use		35. Organization	
Dwelling		Kentucky Heritage Council	
17. Condition		36. Date	
Excellent <input checked="" type="checkbox"/>		Fall 1982	
18. Description		37. Revision Dates	
Situated on the outskirts of Bedford is a significant Federal style dwelling. The brick building consists of a one-and-one-half story recessed central block with one-story twin projecting pavilions and a one-story brick ell on the central block. A one-story brick addition on the rear of the central block and connecting with the ell completes the structure. Flemish bond (Continue on Back)		38. Staff Review	
No. Stories			
1 1/2 - 1 <input checked="" type="checkbox"/>			
Single Pile <input type="checkbox"/> NA <input type="checkbox"/>			
Double Pile <input checked="" type="checkbox"/>			
Floor Plan			
Central Passage <input checked="" type="checkbox"/>			
Structural Fabric			
Brick A. <input checked="" type="checkbox"/> B. <input type="checkbox"/>			
Decorative Fabric			
Flemish Bond A. <input checked="" type="checkbox"/>			
Common Bond B. <input checked="" type="checkbox"/>			
Roof Form			
Gable			
19. History			
20. Significance			
The most outstanding example of a Federal style dwelling in Bedford, as well as the county.			
21. Source of Information			

18. brickwork enhances the facade, while the remainder is done in common bond with a row of headers every seven or nine rows. Fenestration consists of seven bays with a central entrance with a transom now enclosed. A one-story, three-bay pedimented portico embellished with shingling and pierced by a single 2/2 pane window, which replaced the original fanlight window, accentuates the facade. Six Doric Order columns support the portico. Facade windows are 9/6 pane with jackarches and wooden sills. A corbeled cornice accents the facade and rear of the central block, while each wing has a boxed cornice. The central block has interior gable-end chimneys with two 2/2 pane gable windows at each end, and the twin projecting pavilions and the ell also have interior gable-end chimneys. Square windows of 6/6 pane with wooden sills pierce the ell. Each side of the central block is punctured by two bays consisting of a door with a transom now enclosed and a 9/9 pane window with wooden sills and enhanced by one-story, two-bay open porches.

A corbeled cornice accents the ell. Each wing is accentuated by a brick pilaster. A limestone foundation supports the building. A one-story frame coal shed and a one and one-half story frame barn with log joists are dependencies of the dwelling.

KENTUCKY HISTORIC RESOURCE INVENTORY SUPPLEMENT
BOUNDARY AND LOCATION INFORMATION

Historic Property Name Coleman House Site # Tm-B-29

Multiple Resource/Thematic Nomination Title Historic Resources of Trimble County

U.T.M. Coordinates - List multiple UTM's if property is ten or more acres.

A. 16 646420 4272500 D. _____

B. _____ E. _____

C. _____ F. _____

Verbal Boundary Description

Acreage two

Beginning at the intersection of Ball Lane and U.S. 42 proceed 400' in a westward direction; thence 200' in a southward direction; thence 400' in an eastward direction; thence 200' in a northward direction to the point of origin. The boundary is drawn to include the house and outbuildings.

Sketch of Site Plan (Showing outbuildings, structures, landscape features and the site boundary as described above.)

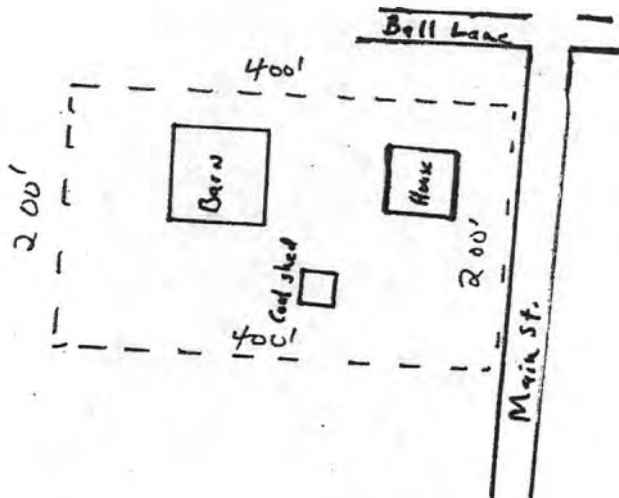

Not to Scale

Official Courthouse Property Reference:

United States Department of the Interior
National Park Service

National Register of Historic Places
Inventory—Nomination Form

For NPS use only
received 6/14/83
date entered

Continuation sheet

Item number

Page 1 of 4

Multiple Resource Area
Thematic Group

dnr-11

Name Trimble County Multiple Resource Area
State KENTUCKY

Cover ————— 4/9/84

Nomination/Type of Review

Date/Signature

- | | | | |
|--|---------------------------|-------------------|---------------------------------------|
| 1. Barringer House | <u>Substantive Review</u> | Keeper | <u>Return CD 4/10/84</u> |
| | | Attest | _____ |
| 2. Bates House | <u>Substantive Review</u> | Keeper | <u>Carl Duhie 4/9/84</u> |
| | | Attest | _____ |
| 3. Bebelt House | <u>Substantive Review</u> | Keeper | <u>Return CD 4/18/84</u> |
| | | Attest | _____ |
| 4. Bird House | <u>Substantive Review</u> | Keeper | _____ |
| | | Attest | _____ |
| 5. Brown's House | <u>Substantive Review</u> | Keeper | <u>Return CD 4/10/84</u> |
| | | Attest | _____ |
| 6. Callis General Store
and Post Office | <u>Substantive Review</u> | <u>for</u> Keeper | <u>accept Patrick Andrews 7/21/83</u> |
| | | Attest | _____ |
| 7. Coleman House | <u>Substantive Review</u> | <u>for</u> Keeper | <u>accept Patrick Andrews 7/21/83</u> |
| | | Attest | _____ |
| 8. Coleman, William L., House | <u>Substantive Review</u> | <u>for</u> Keeper | <u>accept Patrick Andrews 7/21/83</u> |
| | | Attest | _____ |
| 9. Cooper's Bottom School | <u>Substantive Review</u> | Keeper | <u>Carl Duhie 4/19/84</u> |
| | | Attest | _____ |
| 10. Fixx, Dr. Carroll, House | <u>Substantive Review</u> | Keeper | _____ |
| | | Attest | _____ |

United States Department of the Interior
National Park Service

Coleman House (Trimble County MRA)
Trimble County
KENTUCKY

Substantive Review

Working No. JUN 14 1983
Fed. Reg. Date: 2 7, 84
Date Due: 7/14/83 - 7/29/83
Action: ACCEPT 7/21/83
 RETURN
 REJECT

- resubmission
- nomination by person or local government
- owner objection
- appeal

Federal Agency: _____

Substantive Review: sample request appeal NR decision

Reviewer's comments:

*clearly architecturally significant example
of Federal style*

Recom. / Criteria accept c
Reviewer Patrick Andrus
Discipline Historian
Date 7/21/83

see continuation sheet

Nomination returned for: technical corrections cited below
 substantive reasons discussed below

1. Name

2. Location

3. Classification

Category	Ownership	Status	Present Use
	Public Acquisition	Accessible	

4. Owner of Property

5. Location of Legal Description

6. Representation in Existing Surveys

has this property been determined eligible? yes no

7. Description

Condition		Check one	Check one
<input type="checkbox"/> excellent	<input type="checkbox"/> deteriorated	<input type="checkbox"/> unaltered	<input type="checkbox"/> original site
<input type="checkbox"/> good	<input type="checkbox"/> ruins	<input type="checkbox"/> altered	<input type="checkbox"/> moved date _____
<input type="checkbox"/> fair	<input type="checkbox"/> unexposed		

Describe the present and original (if known) physical appearance

- summary paragraph
- completeness
- clarity
- alterations/integrity

8. Significance

Period _____ Areas of Significance—Check and justify below

Specific dates _____ Builder Architect _____

Statement of Significance (in one paragraph)

- _____ summary paragraph
- _____ completeness
- _____ clarity
- _____ applicable criteria
- _____ justification of areas checked
- _____ relating significance to the resource
- _____ context
- _____ relationship of integrity to significance
- _____ justification of exception
- _____ other

9. Major Bibliographical References

10. Geographical Data

Acres of nominated property _____

Quadrangle name _____

UMT References _____

Verbal boundary description and justification _____

11. Form Prepared By

12. State Historic Preservation Officer Certification

The evaluated significance of this property within the state is:

_____ national _____ state _____ local

State Historic Preservation Officer signature _____

title _____ date _____

13. Other

- _____ Maps
- _____ Photographs
- _____ Other

Questions concerning this nomination may be directed to _____

Signed _____ Date _____ Phone: 202 272 - 3504

Comments for any item may be continued on an attached sheet













Please refer to the map in the
Multiple Property Cover Sheet
for this property

Multiple Property Cover Sheet Reference Number: 64000257