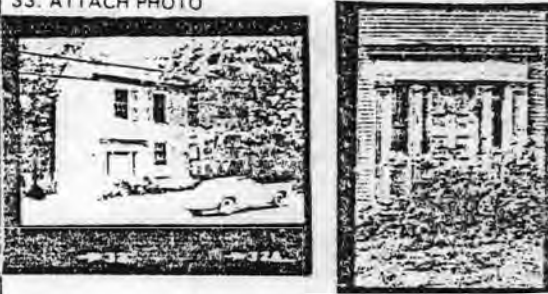

KENTUCKY HISTORIC RESOURCES INVENTORY

Site No. Tm-B-7

1. Historic Name(s) Original Owner <u>Tm-B-7</u>		22. ADD/County 112 <u>No. Ky / Trimble</u>	
2. Present Name		23. U.S.G.S. Quadrant (15'/75') <u>Bedford</u> G.I.S. Mod. <input type="checkbox"/>	
3. Location <u>Main Street, Bedford</u>		24. UTM Reference <u>16</u> <u>646530</u> <u>4273000</u> Zone Easting Northing	
4. Owner's Name <u>Irene Long</u>		25. Coordinate Accuracy <input type="checkbox"/>	
5. Owner's Address <u>Bedford, Kentucky</u>		26. Prehistoric Site <input type="checkbox"/> Object Historic Site <input type="checkbox"/> Structure (Building) <input type="checkbox"/> Other	
6. Open to Public Yes <input type="checkbox"/> No <input checked="" type="checkbox"/>	7. Visible from road Yes <input checked="" type="checkbox"/> No <input type="checkbox"/>	8. Ownership <input type="checkbox"/> Private <input type="checkbox"/> Local <input type="checkbox"/> State <input type="checkbox"/> Federal <input type="checkbox"/>	
9. Local Contact/Organization		27. National Register District Name: <u>Historic Resources of Trimble County</u> <input type="checkbox"/>	
10. Site Plan with North Arrow		28. Significance Evaluation <input type="checkbox"/>	
18. Description <u>A two-story frame structure with a two-story frame ell situated on Main Street in Bedford. Fenestration is four-bay with a side entrance with four-pane sidelights and enhanced by a Greek Revival style "Frontispiece." Windows are 6/6 pane, and second floor facade windows are accented by Greek key pattern corner blocks. The house rests on a limestone foundation and the</u> (Continue on Back)		11. Architect	
		12. Builder	
		13. Date <u>Ca. 1850</u> A. <input checked="" type="checkbox"/> B. <input type="checkbox"/>	
		14. Style A. <u>Greek Revival</u> <input checked="" type="checkbox"/> B. <input type="checkbox"/>	
		15. Original Use <u>Dwelling</u> <input checked="" type="checkbox"/>	
		16. Present use <u>Vacant</u>	
		17. Condition <u>Poor</u> <input checked="" type="checkbox"/>	
		No. Stories <u>Two</u> <input checked="" type="checkbox"/>	
		Single Pile <input checked="" type="checkbox"/> NA <input type="checkbox"/>	
		Double Pile <input type="checkbox"/>	
Floor Plan <u>Side Passage</u> <input checked="" type="checkbox"/>		29. Status <input type="checkbox"/> Date _____ National Landmark _____ National Register _____ Landmark Certificate _____ Kentucky Survey _____ Local Landmark _____ HABS/HAER _____	
Structural Fabric <u>Frame</u> A. <input checked="" type="checkbox"/> B. <input type="checkbox"/>		30. Historic Theme Primary <u>Architecture</u> <input checked="" type="checkbox"/> Secondary _____ Other _____	
Decorative Fabric A. <input type="checkbox"/> B. <input type="checkbox"/>		31. Endangered Yes <input type="checkbox"/> No <input checked="" type="checkbox"/>	
Roof Form <u>Gable</u>		32. Preservation Project Status <input type="checkbox"/>	
19. History		Actual Cost in \$1,000s <input type="checkbox"/>	
20. Significance <u>Architecture: One of the best examples of the Greek Revival style, side passage plan in Bedford.</u>		33. ATTACH PHOTO 	
21. Source of Information		Roll No. <u>16</u> Picture No. <u>16-31</u> Direction _____	
		34. Prepared by: <u>William Gus Johnson</u> Senior Historian & Photographer	
		35. Organization <u>Kentucky Heritage Council</u>	
		36. Date <u>Fall 1982</u>	
		37. Revision Dates _____ 38. Staff Review _____	

18.

gabled tin roof is completed by a cornice with returns. A one-story frame addition was constructed on the rear of the ell at a later date and features bays complemented by architrave trim. Interior features include symmetrical woodwork, Greek Revival style mantels and an open two-run stairway with turned balusters and light sawn brackets.

KENTUCKY HISTORIC RESOURCE INVENTORY SUPPLEMENT
BOUNDARY AND LOCATION INFORMATION

Historic Property Name _____ Site # Tm-B-7
Multiple Resource/Thematic Nomination Title Historic Resources of Trimble County

U.T.M. Coordinates - List multiple UTM's if property is ten or more acres.

A. 16 646530 4273000 D. _____
B. _____ E. _____
C. _____ F. _____

Verbal Boundary Description Acreage .5

The house is situated on Lot 46 as plotted on the Plate of Bedford recorded in Trimble County Miscellaneous Record Book I, P. 438. The lot measures 100' by 100'.

Sketch of Site Plan (Showing outbuildings, structures, landscape features and the site boundary as described above.)

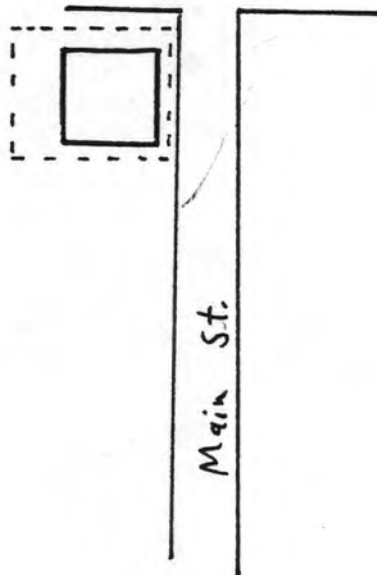

Not to scale

Official Courthouse Property Reference:

Trimble County Deed Book 53, p. 683.
Plat of Bedford, Trimble County Miscellaneous Record Book I, p. 438.

United States Department of the Interior
National Park Service

Substantive Review

House Tm-B-7 (Trimble County MRA)
Trimble County
KENTUCKY

Working No. JUN 14 1983

Fed. Reg. Date: _____

Date Due: 7/14/83 - 7/29/83

Action: ACCEPT
 RETURN 7/21/83
 REJECT

Federal Agency: _____

- resubmission
- nomination by person or local government
- owner objection
- appeal

Substantive Review: sample request appeal NR decision

Reviewer's comments:

*need info. on context for evaluation of
significance - see reverse.*

Recom./Criteria Return
Reviewer Patrick Andrews
Discipline Historian
Date 7/21/83
 see continuation sheet

Nomination returned for: technical corrections cited below
 substantive reasons discussed below

1. Name

2. Location

3. Classification

Category	Ownership	Status	Present Use
	Public Acquisition	Accessible	

4. Owner of Property

5. Location of Legal Description

6. Representation in Existing Surveys

has this property been determined eligible? yes no

7. Description

Condition		Check one	Check one
<input type="checkbox"/> excellent	<input type="checkbox"/> deteriorated	<input type="checkbox"/> unaltered	<input type="checkbox"/> original site
<input type="checkbox"/> good	<input type="checkbox"/> ruins	<input type="checkbox"/> altered	<input type="checkbox"/> moved date _____
<input type="checkbox"/> fair	<input type="checkbox"/> unexposed		

Describe the present and original (if known) physical appearance

- summary paragraph
- completeness
- clarity
- alterations/integrity

8. Significance

Period _____ Area of Significance—Check and justify below

Specific dates _____ Builder Architect _____

Statement of Significance (in one paragraph)

- _____ summary paragraph _____ completeness _____ clarity _____ applicable criteria _____ justification of areas checked _____ relating significance to the resource _____ context _____ relationship of integrity to significance _____ justification of exception _____ other
- Components of a MRA must be individually eligible within the context of the MRA as a whole, and not evaluated as significant within a smaller geographic area. Please evaluate the significance of this bld. as an ex. of Greek Rev. style within the context of all extant Greek Rev. buildings found in the MRA (and not just within the context of Bedford)

9. Major Bibliographical References

10. Geographical Data

Acres of nominated property _____

Quadrangle name _____

UMT References _____

Verbal boundary description and justification _____

11. Form Prepared By

12. State Historic Preservation Officer Certification

The evaluated significance of this property within the state is:

_____ national _____ state _____ local

State Historic Preservation Officer signature _____

title _____ date _____

13. Other

- _____ Maps
_____ Photographs
_____ Other

Questions concerning this nomination may be directed to Patrick Andrus

Signed Patrick Andrus Date 7/21/85 Phone: 202 272-3504

Comments for any item may be continued on an attached sheet

KENTUCKY HISTORIC RESOURCES INVENTORY

Site No. Tm-B-7

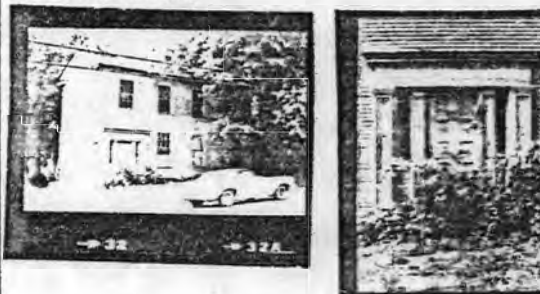
1. Historic Name(s) <u>House Tm-B-7</u>		22. ADD/County <u>No. Ky./Trimble</u> 1 1 2	
Original Owner		23. U.S.G.S. Quadrant (15'/75') <u>Bedford</u> G.I.S. Mod. [] [] []	
2. Present Name		24. UTM Reference <u>1 6</u> <u>6 4 6 5 3 0</u> <u>4 2 7 3 0 0 0</u> Zone Easting Northing	
3. Location <u>Main Street, Bedford</u>		25. Coordinate Accuracy []	
4. Owner's Name <u>Irene Long</u>		26. Prehistoric Site Object Historic Site Structure (Building) Other	
5. Owner's Address <u>Bedford, Kentucky</u>		27. National Register District Name: <u>Historic Resources of Trimble County</u> [] [] []	
6. Open to Public Yes <input type="checkbox"/> No <input checked="" type="checkbox"/>	7. Visible from road Yes <input checked="" type="checkbox"/> No <input type="checkbox"/>	8. Ownership Private <input checked="" type="checkbox"/> Local <input type="checkbox"/> State <input type="checkbox"/> Federal <input type="checkbox"/>	28. Significance Evaluation <u>National Register</u> [D]
9. Local Contact/Organization		29. Status Date National Landmark <input type="checkbox"/> National Register <input type="checkbox"/> Landmark Certificate <input type="checkbox"/> Kentucky Survey <input type="checkbox"/> Local Landmark <input type="checkbox"/> HABS/HAER <input type="checkbox"/>	
10. Site Plan with North Arrow		30. Historic Theme Primary <u>Architecture</u> [C] [] [] Secondary <input type="checkbox"/> Other <input type="checkbox"/>	
18. Description A two-story frame structure with a two story frame ell situated on Main Street in Bedford. Fenestration is four-bay with a side entrance with four-pane sidelights and enhanced by a Greek Revival style "Frontispiece." Windows are 6/6 pane, and second floor facade windows are accented by Greek key pattern corner blocks. The house rests on a limestone foundation and the gabled tin (Continue on Back)		11. Architect	
		12. Builder	
		13. Date <u>ca. 1850</u> A. <input type="checkbox"/> B. <input type="checkbox"/>	
		14. Style A. <u>Greek Revival</u> <input checked="" type="checkbox"/> B. <input type="checkbox"/>	
		15. Original Use <u>Dwelling</u> <input checked="" type="checkbox"/>	
		16. Present use <u>Vacant</u>	
		17. Condition <u>Poor</u> <input checked="" type="checkbox"/>	
19. History		31. Endangered Yes <input type="checkbox"/> No <input checked="" type="checkbox"/>	
20. Significance <u>Architecture: One of the best illustrations of the Greek Revival style, side passage plan in Trimble County. The dwelling exhibits exterior archi-</u>		32. Preservation Project Status <input type="checkbox"/>	
21. Source of Information		33. ATTACH PHOTO  Roll No. <u>16</u> Picture No. <u>16 - 31</u> Direction _____	
		34. Prepared by: <u>William Gus Johnson</u> Senior Historian & Photographer	
		35. Organization <u>Kentucky Heritage Council</u>	
		36. Date <u>Fall 1982</u>	
		37. Revision Dates _____ 38. Staff Review _____	

18. roof is completed by a cornice with returns. A one-story frame addition was constructed on the rear of the ell at a later date and features bays complemented by architrave trim. Interior features include symmetrical woodwork, Greek Revival style mantels and an open two-run stairway with turned balusters and light sawn brackets.

20. tectural features representative of subtle elements of the Greek Revival style.

KENTUCKY HISTORIC RESOURCE INVENTORY SUPPLEMENT
BOUNDARY AND LOCATION INFORMATION

Historic Property Name _____ Site # Tm-B-7

Multiple Resource/Thematic Nomination Title Historic Resources of Trimble County

U.T.M. Coordinates - List multiple UTM's if property is ten or more acres.

A. 16 646530 4273000 D. _____

B. _____ E. _____

C. _____ F. _____

Verbal Boundary Description _____ Acreage .5

The house is situated on Lot 46 as plotted on the Plate of Bedford recorded in Trimble County Miscellaneous Record Book I, P. 438. The lot measures 100' by 100'.

Sketch of Site Plan (Showing outbuildings, structures, landscape features and the site boundary as described above.)

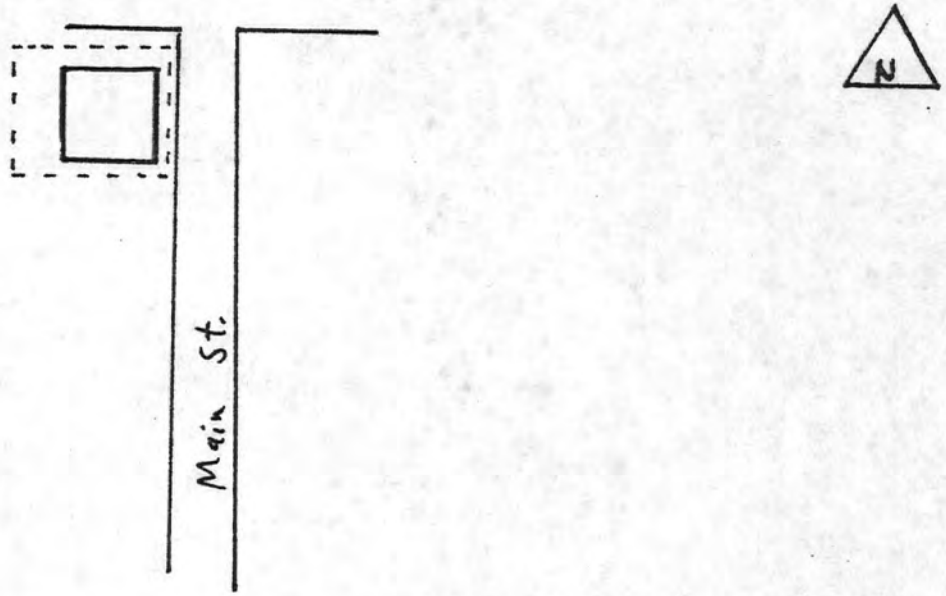

Not to scale

Official Courthouse Property Reference:

Trimble County Deed Book 53, p. 683.
Plat of Bedford, Trimble County Miscellaneous Record Book I, p. 438.

United States Department of the Interior
National Park Service

National Register of Historic Places
Inventory—Nomination Form

For NPS use only
received 6/14/83
date entered

Continuation sheet

Item number

Page 2 of 7

Multiple Resource Area
Thematic Group

Name Trimble County Multiple Resource Area
State Kentucky

Nomination/Type of Review

Date/Signature

11. Ginn's Furniture Store

Substantive Review

for Keeper accept Patrick Andrews 2/6/83

Attest

12. Hancock House

Substantive Review

Keeper Carl Dinkie 4/9/84

Attest

13. House on Kentucky Highway 1492

Substantive Review

Keeper Carl Dinkie 4/9/84

Attest

14. House on Moffett Cemetery Road

Substantive Review

for Keeper accept Patrick Andrews 2/6/83

Attest

15. House Tm-B-7

Substantive Review

Keeper Carl Dinkie 4/9/84

Attest

16. House Tm-B-25

Substantive Review

Keeper Return CD 4/10/84

Attest

17. House Tm-M-27

Substantive Review

Keeper Carl Dinkie 4/9/84

Attest

18. House Tm-M-28

Substantive Review

Keeper Carl Dinkie 4/9/84

Attest

19. Humphrey Place

Substantive Review

for Keeper accept Patrick Andrews 2/21/83

Attest

20. Logan, W. W., House

Substantive Review

Keeper Carl Dinkie 4/9/84

Attest

NATIONAL REGISTER OF HISTORIC PLACES
EVALUATION/RETURN SHEET

Substantive Review

House Tm-B-7 (Trimble County MRA)
Trimble County
KENTUCKY

Working No. JUN 14 1983
Fed. Reg. Date: 2.5.85
Date Due: 5/3/84
Action: ACCEPT 4/9/84
 RETURN
 REJECT

Federal Agency: _____

- resubmission
- nomination by person or local government
- owner objection
- appeal

Substantive Review: sample request appeal NR decision

Reviewer's comments: *Statement of significance improved.
Good example of Greek Revival w/strong
decorative details.*

Recom./Criteria ACCEPT
Reviewer DUBIE
Discipline HIST
Date 9/29/1984
_____ see continuation sheet

Nomination returned for: _____ technical corrections cited below
_____ substantive reasons discussed below

1. Name

2. Location

3. Classification

Category	Ownership	Status	Present Use
	Public Acquisition	Accessible	

4. Owner of Property

5. Location of Legal Description

6. Representation in Existing Surveys

Has this property been determined eligible? yes no

7. Description

Condition	Check one	Check one
<input type="checkbox"/> excellent	<input type="checkbox"/> deteriorated	<input type="checkbox"/> original site
<input type="checkbox"/> good	<input type="checkbox"/> ruins	<input type="checkbox"/> moved date _____
<input type="checkbox"/> fair	<input type="checkbox"/> unexposed	
	<input type="checkbox"/> unaltered	
	<input type="checkbox"/> altered	

Describe the present and original (if known) physical appearance

- summary paragraph
- completeness
- clarity
- alterations/integrity
- dates
- boundary selection

✓ **8. Significance**

Period Areas of Significance—Check and justify below

Specific dates Builder/Architect

Statement of Significance (*in one paragraph*)

- summary paragraph
- completeness
- clarity
- applicable criteria
- justification of areas checked
- relating significance to the resource
- context
- relationship of integrity to significance
- justification of exception
- other

9. Major Bibliographical References

10. Geographical Data

Acreage of nominated property _____

Quadrangle name _____

UTM References _____

Verbal boundary description and justification

11. Form Prepared By

12. State Historic Preservation Officer Certification

The evaluated significance of this property within the state is:

____ national ____ state ____ local

State Historic Preservation Officer signature

title date

13. Other

- Maps
- Photographs
- Other

Questions concerning this nomination may be directed to _____

Signed _____ Date _____ Phone: _____







Please refer to the map in the
Multiple Property Cover Sheet
for this property

Multiple Property Cover Sheet Reference Number: 64000257