

1. Historic Name(s) <u>School</u> <i>Cooper's Bottom School</i>		22. ADD County <u>N. Ky. / Tm</u> <span style="float:right">1 1 2</span>			
Original Owner		23. U.S.G.S. Quadrant (15'/75') <span style="float:right">G.I.S. Mod.</span>			
2. Present Name		24. UTM Reference <u>1 6</u>   <u>6 3 6 3 4 0</u>   <u>4 2 8 1 3 2 0</u> Zone Easting Northing			
3. Location <u>Cooper's Bottom Road</u> <i>Wm. Johnson</i>		25. Coordinate Accuracy <span style="float:right"><input type="checkbox"/></span>			
4. Owner's Name <u>Raymond Boldery</u>		26. Prehistoric Site Object Historic Site Structure (Building) Other			
5. Owner's Address <u>Route 2, Milton, Kentucky</u>		27. National Register District Name: <u>Historic Resources of Trimble County</u> <span style="float:right">1 1 1</span>			
6. Open to Public Yes <input type="checkbox"/> No <input checked="" type="checkbox"/>	7. Visible from road Yes <input checked="" type="checkbox"/> No <input type="checkbox"/>	8. Ownership <span style="float:right"><input checked="" type="checkbox"/></span> Private <input type="checkbox"/> Local <input type="checkbox"/> State <input type="checkbox"/> Federal <input type="checkbox"/>			
9. Local Contact/Organization		28. Significance Evaluation <u>N.R.</u> <span style="float:right"><input checked="" type="checkbox"/></span>			
10. Site Plan with North Arrow		11. Architect			
		12. Builder <u>.</u>			
		13. Date <u>Ca: 1865</u> A. <input type="checkbox"/> B. <input type="checkbox"/>			
		14. Style A. <input type="checkbox"/> B. <input type="checkbox"/>			
		15. Original Use <u>School</u> <span style="float:right"><input checked="" type="checkbox"/></span>			
		16. Present use <u>Vacant</u>			
		17. Condition <u>Fair</u> <span style="float:right"><input checked="" type="checkbox"/></span>			
18. Description <u>A one-story, one-bay frame school situated on Cooper's Bottom Road. The sides are punctured by three-bays. Windows are 6/6 pane with architrave trim. A center ridgeline chimney rises from the gable roof, and the building rests on a limestone foundation.</u>		29. Status <span style="float:right">Date</span> National Landmark <input type="checkbox"/> National Register <input type="checkbox"/> Landmark Certificate <input type="checkbox"/> Kentucky Survey <input type="checkbox"/> Local Landmark <input type="checkbox"/> HABS/HAER <input type="checkbox"/>			
		30. Historic Theme <span style="float:right"><input checked="" type="checkbox"/></span> Primary <u>Education</u> Secondary <u>Architecture</u> <span style="float:right"><input checked="" type="checkbox"/></span> Other <input type="checkbox"/>			
		31. Endangered <span style="float:right">Yes <input checked="" type="checkbox"/></span> <span style="float:right">No <input type="checkbox"/></span>			
		32. Preservation Project Status <span style="float:right"><input type="checkbox"/></span>			
		Actual Cost in \$1,000s <span style="float:right">1 1 1 1 1</span>			
(Continue on Back)		33. ATTACH PHOTO			
					
				Roll No. <u>50</u>	
				Picture No. <u>1-5</u>	
				Direction _____	
19. History		34. Prepared by: <u>Wm. Gus Johnson</u> <u>Sr. Historian &amp; Photographer</u>			
20. Significance <u>Education: significant as one of the few remaining rural schools in the county. The rural school was an important social institution in a rural</u>		35. Organization <u>Kentucky Heritage Council</u>			
21. Source of Information		36. Date <u>Fall 1982</u>			
		37. Revision Dates <span style="float:right">38. Staff Review</span>			

20. environment before the advent of the consolidation phase of public education which occurred in the 1930's and 40's.

KENTUCKY HISTORIC RESOURCE INVENTORY SUPPLEMENT  
BOUNDARY AND LOCATION INFORMATION

Historic Property Name \_\_\_\_\_ Site # Tm-73

Multiple Resource/Thematic Nomination Title Historic Resources of Trimble County

U.T.M. Coordinates - List multiple UTM's if property is ten or more acres.

A. 16 636340 4281320 D. \_\_\_\_\_

B. \_\_\_\_\_ E. \_\_\_\_\_

C. \_\_\_\_\_ F. \_\_\_\_\_

Verbal Boundary Description

Acreage 1

Beginning at a point on the east side of Cooper's Bottom Road, 100' from the school, proceed 200' in a northeastward direction; thence 200' in a southeastward direction; thence 200' in a southwestward direction; thence 200' in a northwestward direction to the point of origin.

Sketch of Site Plan (Showing outbuildings, structures, landscape features and the site boundary as described above.)

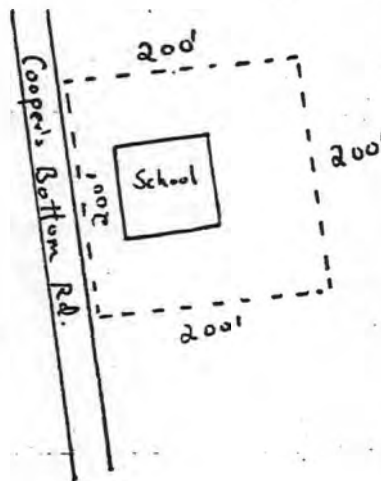

Not to scale

Official Courthouse Property Reference:

United States Department of the Interior  
National Park Service

Substantive Review

Cooper's Bottom School (Trimble County MRA)  
Trimble County  
KENTUCKY

Working No. JUN 14 1983

Fed. Reg. Date: \_\_\_\_\_

Date Due: 7/14/83 - 7/29/83

Action:  ACCEPT  
 RETURN 7/21/83  
 REJECT

Federal Agency: \_\_\_\_\_

- resubmission
- nomination by person or local government
- owner objection
- appeal

Substantive Review:  sample  request  appeal  NR decision

Reviewer's comments:

need more info. on significance. The overview has <sup>section #8</sup> not justified education as an area of significance for the MRA. Please resubmit this (with requested info) if the main section is resubmitted with a justification of educ. as an area of signif. for the MRA.

Recom./Criteria Return  
Reviewer Patrick Andrus  
Discipline Historian  
Date 7/21/83  
 see continuation sheet

Nomination returned for:  technical corrections cited below  
 substantive reasons discussed below

1. Name

2. Location

3. Classification

Category	Ownership	Status	Present Use
	Public Acquisition	Accessible	

4. Owner of Property

5. Location of Legal Description

6. Representation in Existing Surveys

Has this property been determined eligible?  yes  no

7. Description

Condition		Check one	Check one
<input type="checkbox"/> excellent	<input type="checkbox"/> deteriorated	<input type="checkbox"/> unaltered	<input type="checkbox"/> original site
<input type="checkbox"/> good	<input type="checkbox"/> ruins	<input type="checkbox"/> altered	<input type="checkbox"/> moved date _____
<input type="checkbox"/> fair	<input type="checkbox"/> unexposed		

Describe the present and original (if known) physical appearance

- summary paragraph
- completeness
- clarity
- alterations/integrity

## 8. Significance

Period \_\_\_\_\_ Area of Significance—Check and justify below

Specific dates \_\_\_\_\_ Builder Architect \_\_\_\_\_

Statement of Significance (in one paragraph)

summary paragraph

completeness

clarity

applicable criteria

justification of areas checked

relating significance to the resource

context

relationship of integrity to significance

justification of exception

other

Please provide information on the development of education within the county - how does this building fit into that development. On what basis is this bld. dated c. 1865. How many of these small schools ~~would~~ would have existed historically? Who would this have been used by (in other words, how wide of a geographic distribution across the county were there for these types of schools). How long was this bld. used as a school?

## 9. Major Bibliographical References

## 10. Geographical Data

Acres of nominated property \_\_\_\_\_

Quadrangle name \_\_\_\_\_

UMT References \_\_\_\_\_

Verbal boundary description and justification

does this VBD form a square with the beginning centered on the center of the bld?

## 11. Form Prepared By

## 12. State Historic Preservation Officer Certification

The evaluated significance of this property within the state is:

national  state  local

State Historic Preservation Officer signature \_\_\_\_\_

title \_\_\_\_\_

date \_\_\_\_\_

## 13. Other

Maps

Photographs

Other

Questions concerning this nomination may be directed to Patrick Andrus

Signed Patrick Andrus

Date 7/21/03

Phone: 202 272-3504

Comments for any item may be continued on an attached sheet

# KENTUCKY HISTORIC RESOURCES INVENTORY

Site No. Tm-73

1. Historic Name(s) <u>Moreland School</u>		22. ADD/County <u>No. Ky. /Trimble</u> <span style="float: right;">1 1 2</span>			
Original Owner		23. U.S.G.S. Quadrant (15'/75') <u>Madison West</u> <span style="float: right;">G.I.S. Mod. 1 1 1</span>			
2. Present Name <u>Cooper's Bottom School</u>		24. UTM Reference <u>1 6   6 3 6 3 4 0   4 2 8 1 3 2 0</u> Zone Easting Northing			
3. Location <u>Cooper's Bottom Road, Milton Vicinity</u>		25. Coordinate Accuracy <span style="float: right;">□</span>			
4. Owner's Name <u>Raymond Boldery</u>		26. Prehistoric Site Object Historic Site Structure (Building) Other			
5. Owner's Address <u>Route #2, Milton, Kentucky</u>		27. National Register District Name: <u>Historic Resources of Trimble County</u> <span style="float: right;">1 1 1</span>			
6. Open to Public Yes <input type="checkbox"/> No <input checked="" type="checkbox"/>	7. Visible from road Yes <input checked="" type="checkbox"/> No <input type="checkbox"/>	8. Ownership Private <input checked="" type="checkbox"/> Local <input type="checkbox"/> State <input type="checkbox"/> Federal <input type="checkbox"/>			
9. Local Contact/Organization		28. Significance Evaluation <u>National Register</u> <span style="float: right;">D</span>			
10. Site Plan with North Arrow		11. Architect			
		12. Builder			
		13. Date <u>ca. 1870</u> A. <input checked="" type="checkbox"/> B. <input type="checkbox"/>			
		14. Style A. <u>Vernacular</u> <input checked="" type="checkbox"/> B. <input type="checkbox"/>			
		15. Original Use <u>School</u> <input checked="" type="checkbox"/>			
		16. Present use <u>Vacant</u>			
		17. Condition <u>Fair</u> <input checked="" type="checkbox"/>			
		18. Description <u>A one-story, one-bay frame school situated on Cooper's Bottom Road. The sides are punctured by three-bays. Windows are 6/6 pane with architrave trim. A center ridgeline chimney rises from the gable roof, and the building rests on a limestone foundation.</u>			
		19. History		29. Status <span style="float: right;">Date</span> National Landmark <input type="checkbox"/> National Register <input type="checkbox"/> Landmark Certificate <input type="checkbox"/> Kentucky Survey <input type="checkbox"/> Local Landmark <input type="checkbox"/> HABS/HAER <input type="checkbox"/>	
		(Continue on Back)		30. Historic Theme Primary <u>Education</u> <input checked="" type="checkbox"/> Secondary <u>Architecture</u> <input checked="" type="checkbox"/> Other <input type="checkbox"/>	
20. Significance <u>Education: significant as one of the few remaining rural schools in the county. The rural school was an important social institution in a rural</u>		31. Endangered Yes <input checked="" type="checkbox"/> No <input type="checkbox"/>			
21. Source of Information		32. Preservation Project Status <input type="checkbox"/>			
		33. ATTACH PHOTO 			
		Actual Cost in \$1,000s <span style="float: right;">1 1 1 1 1 1 1 1 1 1</span>			
		Roll No. <u>50</u>			
		Picture No. <u>1 - 5</u>			
		Direction _____			
		34. Prepared by: <u>William Gus Johnson</u> <u>Sr. Historian &amp; Photographer</u>			
		35. Organization <u>Kentucky Heritage Council</u>			
		36. Date <u>Fall 1982</u>			
		37. Revision Dates _____ 38. Staff Review _____			

20. environment before the advent of the consolidation phase of public education which occurred in the 1930s and 40s. Moreland School is significant for its historical association with public education in Trimble, and is one of three surviving examples of the thirty-three rural schools constructed in Trimble County between 1840 and 1900.

KENTUCKY HISTORIC RESOURCE INVENTORY SUPPLEMENT  
BOUNDARY AND LOCATION INFORMATION

Historic Property Name Moreland School Site # TM-73

Multiple Resource/Thematic Nomination Title Historic Resources of Trimble County

U.T.M. Coordinates - List multiple UTMs if property is ten or more acres.

A. 16 636340 4281320 D. \_\_\_\_\_

B. \_\_\_\_\_ E. \_\_\_\_\_

C. \_\_\_\_\_ F. \_\_\_\_\_

Verbal Boundary Description \_\_\_\_\_ Acreage 1

Beginning at a point on the east side of Cooper's Bottom Road, 100' from the center of the school, proceed 200' in a northeastward direction; thence 200' in a southeastward direction; thence 200' in a southwestward direction; thence 200' in a northwestward direction to the point of origin.

Sketch of Site Plan (Showing outbuildings, structures, landscape features and the site boundary as described above.)

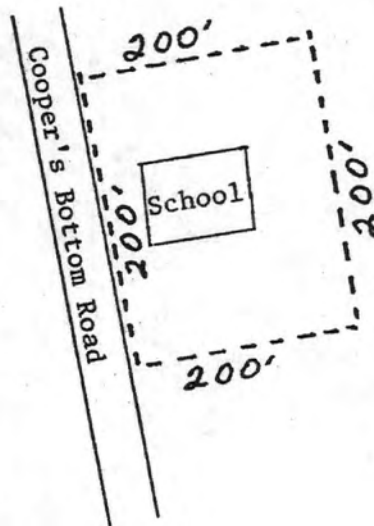

NOT TO SCALE

Official Courthouse Property Reference:



United States Department of the Interior  
National Park Service

National Register of Historic Places  
Inventory—Nomination Form

For NPS use only

received 6/14/83

date entered

Continuation sheet

Item number

Page 1 of 7

Multiple Resource Area  
Thematic Group

dnr-11

Name Trimble County Multiple Resource Area  
State KENTUCKY

Cover ————— 4/9/84

Nomination/Type of Review

Date/Signature

1. Barringer House

Substantive Review

Keeper

Return CD 4/16/84

Attest

2. Bates House

Substantive Review

Keeper

Carl Duhio 4/9/84

Attest

3. Bebelt House

Substantive Review

Keeper

Return CD 4/18/84

Attest

4. Bird House

Substantive Review

Keeper

Attest

5. Brown's House

Substantive Review

Keeper

Return CD 4/10/84

Attest

6. Callis General Store  
and Post Office

Substantive Review

for Keeper

accept Patrick Andrews 7/21/83

Attest

7. Coleman House

Substantive Review

for Keeper

accept Patrick Andrews 7/21/83

Attest

8. Coleman, William L., House

Substantive Review

for Keeper

accept Patrick Andrews 7/21/83

Attest

9. Cooper's Bottom School

Substantive Review

Keeper

Carl Duhio 4/9/1984

Attest

10. Fixx, Dr. Carroll, House

Substantive Review

Keeper

Attest

NATIONAL REGISTER OF HISTORIC PLACES  
EVALUATION/RETURN SHEET

Moreland School  
Cooper's Bottom School (Trimble County MRA)  
Trimble County  
KENTUCKY

Substantive Review

Working No. JUN 14 1983

Fed. Reg. Date: 2.5.85

Date Due: 5/3/84

Action:  ACCEPT 4-9-84

RETURN

REJECT

Federal Agency: \_\_\_\_\_

- resubmission
- nomination by person or local government
- owner objection
- appeal

Substantive Review:  sample  request  appeal  NR decision

Reviewer's comments: One of 3 rural schools surviving from the 30+  
constructed between 1860 + 1900.  
Significant for association w/ rural ed.  
+ as building type.  
Boundary improved.

Recom./Criteria ACCEPT A,C

Reviewer DUBLE

Discipline HIST

Date 9/9/84

\_\_\_\_\_ see continuation sheet

Nomination returned for:  technical corrections cited below  
 substantive reasons discussed below

1. Name

2. Location

3. Classification

Category	Ownership	Status	Present Use
	Public Acquisition	Accessible	

4. Owner of Property

5. Location of Legal Description

6. Representation in Existing Surveys

Has this property been determined eligible?  yes  no

7. Description

Condition

- excellent
- good
- fair
- deteriorated
- ruins
- unexposed

Check one

- unaltered
- altered

Check one

- original site
- moved date \_\_\_\_\_

Describe the present and original (if known) physical appearance

- summary paragraph
- completeness
- clarity
- alterations/integrity
- dates
- boundary selection

---

**8. Significance**

Period \_\_\_\_\_ Areas of Significance—Check and justify below \_\_\_\_\_

Specific dates \_\_\_\_\_ Builder/Architect \_\_\_\_\_

Statement of Significance (*in one paragraph*) \_\_\_\_\_

- summary paragraph
- completeness
- clarity
- applicable criteria
- justification of areas checked
- relating significance to the resource
- context
- relationship of integrity to significance
- justification of exception
- other

---

**9. Major Bibliographical References**

---

**10. Geographical Data**

Acreage of nominated property \_\_\_\_\_

Quadrangle name \_\_\_\_\_

UTM References \_\_\_\_\_

Verbal boundary description and justification \_\_\_\_\_

---

**11. Form Prepared By**

---

**12. State Historic Preservation Officer Certification**

The evaluated significance of this property within the state is:

\_\_\_\_ national      \_\_\_\_ state      \_\_\_\_ local

State Historic Preservation Officer signature \_\_\_\_\_

title \_\_\_\_\_

date \_\_\_\_\_

---

**13. Other**

- Maps
- Photographs
- Other

Questions concerning this nomination may be directed to \_\_\_\_\_

Signed \_\_\_\_\_ Date \_\_\_\_\_ Phone: \_\_\_\_\_





Please refer to the map in the  
Multiple Property Cover Sheet  
for this property

Multiple Property Cover Sheet Reference Number: 64000257