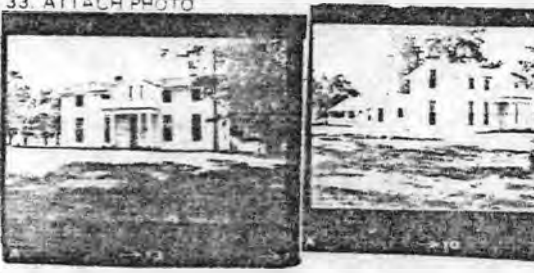

KENTUCKY HISTORIC RESOURCES INVENTORY

Site No. Tm-89

1. Historic Name(s) Preston House; Norfolk Plantation		22. ADD County No. Ky. / Trimble 1 1 2	
Original Owner		23. U.S.G.S. Quadrant (15/75') Madison West G.I.S. Mod. <input type="checkbox"/>	
2. Present Name Preston House		24. UTM Reference 1 6 6 3 7 0 6 0 4 2 7 7 0 0 0 Zone Easting Northing	
3. Location Rodgers Road, Milton, Va		25. Coordinate Accuracy <input type="checkbox"/>	
4. Owner's Name Darrell Wheeler		26. Prehistoric Site Object Historic Site Structure (Building) Other	
5. Owner's Address Route #3, Box 32, Bedford, Kentucky		27. National Register District Name: Historic Resources of Trimble County <input type="checkbox"/>	
6. Open to Public Yes <input type="checkbox"/> No <input type="checkbox"/>	7. Visible from road Yes <input type="checkbox"/> No <input type="checkbox"/>	8. Ownership Private <input type="checkbox"/> Local <input type="checkbox"/> State <input type="checkbox"/> Federal <input type="checkbox"/>	
9. Local Contact/Organization		28. Significance Evaluation National Register D	
10. Site Plan with North Arrow		29. Status Date National Landmark <input type="checkbox"/> National Register <input type="checkbox"/> Landmark Certificate <input type="checkbox"/> Kentucky Survey <input type="checkbox"/> Local Landmark <input type="checkbox"/> HABS HAER <input type="checkbox"/>	
11. Architect		30. Historic Theme Primary Architecture C Secondary <input type="checkbox"/> Other <input type="checkbox"/>	
12. Builder		31. Endangered Yes <input type="checkbox"/> No XX	
13. Date ca. 1840 A. <input checked="" type="checkbox"/> B. <input type="checkbox"/>		32. Preservation Project Status <input type="checkbox"/>	
14. Style A. Greek Revival <input checked="" type="checkbox"/> B. <input type="checkbox"/>		Actual Cost in \$1,000s <input type="checkbox"/>	
15. Original Use Dwelling <input checked="" type="checkbox"/>		33. ATTACH PHOTO	
16. Present use Dwelling			
17. Condition Very Good <input checked="" type="checkbox"/>			
18. Description Situated on rolling farmland, the Preston House is a two-story brick building which has been weatherboarded. Fenestration is five-bays with a recessed central entrance with five-pane crystal glass sidelights. A one-story, one-bay portico with bracketed and dentilled cornice and a balustraded desk enhances the entranceway. Long, narrow (Continue on Back)		No. Stories Two <input checked="" type="checkbox"/> Single Pile XX NA <input type="checkbox"/> Double Pile <input type="checkbox"/> Floor Plan Central Passage <input checked="" type="checkbox"/> Structural Fabric Brick/Frame A. <input checked="" type="checkbox"/> B. <input checked="" type="checkbox"/> Decorative Fabric Sawn Weatherboard A. <input checked="" type="checkbox"/> B. <input type="checkbox"/> Roof Form Gable	
19. History		Roll No. 58 Picture No. 1 - 36 Direction Roll 59 #1-19	
20. Significance Architecture: The Preston House is a significant illustration of vernacular architecture. The formality & ornateness of the interior appointments enhance the significance of this dwelling. In addition the site		34. Prepared by: William Gus Johnson Sr. Historian & Photographer	
21. Source of Information		35. Organization Kentucky Heritage Council	
		36. Date Fall 1982	
		37. Revision Dates 38. Staff Review	

18. rectangular windows of 6/6 pane pierce the main floor of the facade, while smaller straight-headed windows of 3/3 pane puncture the second floor. A center gable with a single four panel door with three-pane crystal glass sidelights which opens onto the balustraded deck further accentuates the facade. The house rests on a brick foundation and has interior chimneys. A one-story frame ell centered on the rear of the main block was constructed at the same time. The ell has two side entrances both with two-pane transoms, and windows are 6/6 pane. The ell is accented by a gable over one of the entrances which has a one-story, one-bay pedimented porch with a fanlight above. A center ridgeline chimney arises from the gable roof of the ell which rests on a brick foundation. On the rear of the ell is the original dwelling, a one-story frame structure with four bays with two entrances in side bays. Windows are 6/6 pane. The structure has an interior gable-end chimney and rests on a brick foundation.

The interior of the main block is quite ornate. The central hallway and both rooms on the main floor are embellished with stencilled wall and ceiling murals, and parquet flooring. Both rooms on the main floor have Victorian style mantels, as do the rooms on the second floor. First floor ceilings are fourteen feet in height. Four panel doors, twelve feet in height, augment the interior detailing, and doors and windows are enhanced by symmetrical woodwork. A spiral stairway with turned balusters leads to the upper floor.

A rather large collection of outbuildings associated with the dwelling exist today. They are:

- a. One-story brick rootcellar. One-bay. Wood shingle hip roof. Arched brick supports above the bays. Common bond with a row of headers every six rows. Directly behind the house (oldest)
 - b. One-story frame meathouse. Two-bay. Hip roof. Wooden shingle roof. Limestone foundation.
 - c. One-story frame privy. Brick foundation.
 - d. One-story frame shed.
 - e. One and one-half story frame dwelling. Slave and servant quarters. Three-bays with side entrance. Interior chimney. Brick foundation.
 - f. One-story brick with side entrance. Common bond with row of headers every six rows. Original structure had liproof and interior gable-end chimney. Window on brick portion is 6/6 pane with arched brick support. One-story bay porch, other windows 3/6 pane. One of the oldest buildings on the farm. Was used as a Catholic Chapel and School.
 - g. One and one-half brick smokehouse. According to local tradition, the building was constructed for use as a slave jail. The structure has three levels a basement where leg irons still exist, the main floor, and a loft. The building is one-bay with two brick row supporting arch. Executed in common bond with a row of headers every four rows, and reinforced by cast-iron tie ends secured by cast-iron star-shaped retainers. Hip roof.
 - h. One and one-half story frame barn.
 - i. Farm Office. A one-story frame structure. One-bay with projecting pedimented porch. Exterior gable-end stone chimney. Gable roof. Windows are 6/6 pane. Brick foundation.
20. is an outstanding example of a farmstead with a rather large collection of surviving dependencies.

KENTUCKY HISTORIC RESOURCE INVENTORY SUPPLEMENT
BOUNDARY AND LOCATION INFORMATION

Historic Property Name Preston House Site # Tm-89
Multiple Resource/Thematic Nomination Title Historic Resources of Trimble County

U.T.M. Coordinates - List multiple UTMs if property is ten or more acres.

A. 16 637060 4277000 D. _____
B. _____ E. _____
C. _____ F. _____

Verbal Boundary Description Acreage 6.5

Beginning at a point on the east side of the lane leading to the house, approximately 200' from the house, proceed 200' in an eastward direction; thence 650' in a southward direction along the farm lane; thence 400' in a westward direction; thence 650' in a northward direction; thence 200' in an eastward direction to the point of origin. The boundary is drawn to include the house and outbuildings.

Sketch of Site Plan (Showing outbuildings, structures, landscape features and the site boundary as described above.)

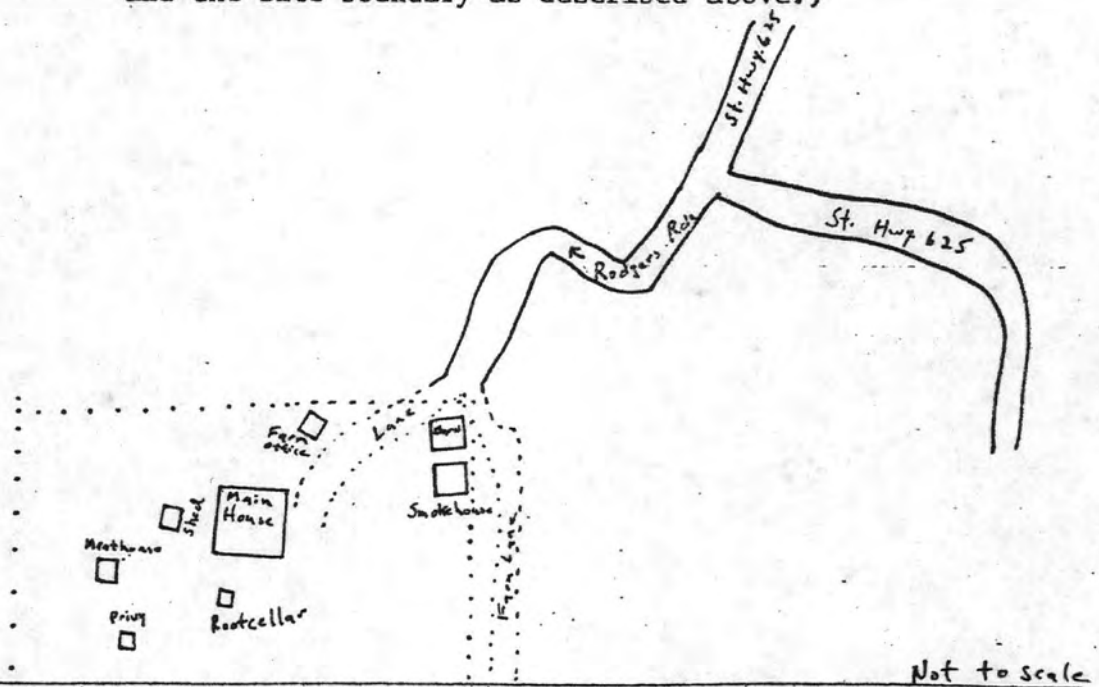

Official Courthouse Property Reference:

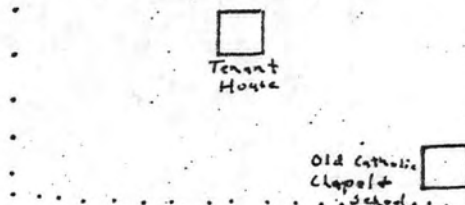

United States Department of the Interior
National Park Service

National Register of Historic Places
Inventory—Nomination Form

For NPS use only
received 6-14-83
date entered

Continuation sheet

Item number

Page 3-24

Multiple Resource Area
Thematic Group

Name Trimble County Multiple Resource Area
State Kentucky

Nomination/Type of Review

Date/Signature

21. Milton Masonic Lodge
and County General Store

Substantive Review for

Keeper

accept Patrick Andrews 7/21/83

Attest

22. Neal House

Substantive Review

Keeper

Wm Doherty 4/9/84

Attest

23. Old Kentucky Tavern

Substantive Review for

Keeper

accept Patrick Andrews 7/21/83

Attest

24. Page-Bell House

Substantive Review for

Keeper

accept Patrick Andrews 7/21/83

Attest

25. Page House

Substantive Review

Keeper

Wm Doherty 4/10/84

Attest

26. Peak House

Substantive Review

Keeper

Wm Doherty 4/9/84

Attest

27. Preston House

Substantive Review for

Keeper

accept Patrick Andrews 7/21/83

Attest

28. River View

Substantive Review

Keeper

Return CD 4/10/84

Attest

29. Rowlett's Grocery

Substantive Review for

Keeper

accept Patrick Andrews 7/21/83

Attest

30. Rowlett House

Substantive Review

Keeper

Wm Doherty 4/9/84

Attest

United States Department of the Interior
National Park Service

Preston House (Trimble County MRA)
Trimble County
KENTUCKY

Substantive Review

Working No. JUN 14 1983
Fed. Reg. Date: 2.7.84
Date Due: 7/14/83 - 7/29/83
Action: ACCEPT 7/21/83
 RETURN
 REJECT
Federal Agency: _____

- resubmission
- nomination by person or local government
- owner objection
- appeal

Substantive Review: sample request appeal NR decision

Reviewer's comments:

architecturally significant grouping of 19th century farm buildings within the context of the MRA

Recom./Criteria accept c
Reviewer Patrick Andrus
Discipline Historian
Date 7/21/83
see continuation sheet

Nomination returned for: technical corrections cited below
 substantive reasons discussed below

1. Name

2. Location

3. Classification

Category	Ownership	Status	Present Use
	Public Acquisition	Accessible	

4. Owner of Property

5. Location of Legal Description

6. Representation in Existing Surveys

has this property been determined eligible? yes no

7. Description

Condition		Check one	Check one
<input type="checkbox"/> excellent	<input type="checkbox"/> deteriorated	<input type="checkbox"/> unaltered	<input type="checkbox"/> original site
<input type="checkbox"/> good	<input type="checkbox"/> ruins	<input type="checkbox"/> altered	<input type="checkbox"/> moved date _____
<input type="checkbox"/> fair	<input type="checkbox"/> unexposed		

Describe the present and original (if known) physical appearance

- summary paragraph
- completeness
- clarity
- alterations/integrity
- dates
- boundary selection

8. Significance

Period _____ Areas of Significance—Check and justify below

Specific dates _____ Builder/Architect _____

Statement of Significance (in one paragraph)

- summary paragraph
- completeness
- clarity
- applicable criteria
- justification of areas checked
- relating significance to the resource
- context
- relationship of integrity to significance
- justification of exception
- other

9. Major Bibliographical References

10. Geographical Data

Acres of nominated property _____

Quadrangle name _____

USGS References _____

Verbal boundary description and justification _____

11. Form Prepared By

12. State Historic Preservation Officer Certification

The evaluated significance of this property within the state is:

national state local

State Historic Preservation Officer signature _____

title _____ date _____

13. Other

- Maps
- Photographs
- Other

Questions concerning this nomination may be directed to _____

Signed _____ Date _____ Phone: 202 272-3504

Comments for any item may be continued on an attached sheet





















Please refer to the map in the
Multiple Property Cover Sheet
for this property

Multiple Property Cover Sheet Reference Number: 64000257