

18. and windows are 2/2 pane. Interior chimneys. A one-story frame addition has been constructed on the south side of the building.

KENTUCKY HISTORIC RESOURCE INVENTORY SUPPLEMENT
BOUNDARY AND LOCATION INFORMATION

Historic Property Name Rowlett's Grocery Site # Tm-M-25
Multiple Resource/Thematic Nomination Title Historic Resources of Trimble County

U.T.M. Coordinates - List multiple UTM's if property is ten or more acres.

A. 16 641740 4287200 D. _____
B. _____ E. _____
C. _____ F. _____

Verbal Boundary Description Acreage .12

Rowlett's Grocery is situated on lot 14, Block II as plotted on the plat of the Kingston Addition of Milton. The lot measures 152' X 40'.

Sketch of Site Plan (Showing outbuildings, structures, landscape features and the site boundary as described above.)

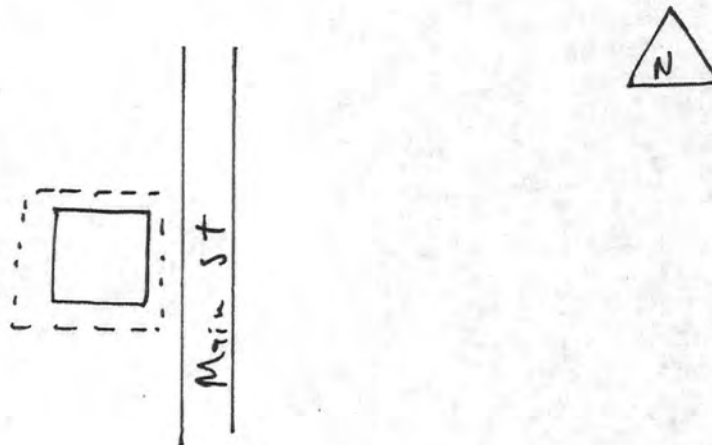

Not to scale

Official Courthouse Property Reference:

Plat of Kingston Addition of Milton. August 2, 1867.

United States Department of the Interior
National Park Service

National Register of Historic Places
Inventory—Nomination Form

For NPS use only
received 6-4-83
date entered

Continuation sheet

Item number

Page 3-24

Multiple Resource Area
Thematic Group

Name Trimble County Multiple Resource Area
State Kentucky

Nomination/Type of Review

Date/Signature

21. Milton Masonic Lodge
and County General Store

Substantive Review for

Keeper

accept Patrick Andrews 7/21/83

Attest

22. Neal House

Substantive Review

Keeper

Lynn Doherty 4/9/84

Attest

23. Old Kentucky Tavern

Substantive Review for

Keeper

accept Patrick Andrews 7/21/83

Attest

24. Page-Bell House

Substantive Review for

Keeper

accept Patrick Andrews 7/21/83

Attest

25. Page House

Substantive Review

Keeper

Lynn Doherty 4/10/84

Attest

26. Peak House

Substantive Review

Keeper

Lynn Doherty 4/9/84

Attest

27. Preston House

Substantive Review for

Keeper

accept Patrick Andrews 7/21/83

Attest

28. River View

Substantive Review

Keeper

Return CD 4/10/84

Attest

29. Rowlett's Grocery

Substantive Review for

Keeper

accept Patrick Andrews 7/21/83

Attest

30. Rowlett House

Substantive Review

Keeper

Lynn Doherty 4/9/84

Attest

NATIONAL REGISTER OF HISTORIC PLACES

EVALUATION / RETURN SHEET

United States Department of the Interior
National Park Service

Rowlett's Grocery (Trimble County MRA)
Trimble County
KENTUCKY

Substantive Review

Working No. JUN 14 1983
Fed. Reg. Date: 2.7.84
Date Due: 7/14/83 - 7/29/83
Action: ACCEPT 7/21/83
 RETURN
 REJECT
Federal Agency: _____

- resubmission
- nomination by person or local government
- owner objection
- appeal

Substantive Review: sample request appeal NR decision

Reviewer's comments:

although the significance statement evaluates this bld. only within the context of Milton, the main cover form explains the rarity & significance of historic commercial bldgs. in the MRA & this bld. is used as an illustration (main sec. 7 p 3)

Recom./Criteria accept a & c
Reviewer Patrick Andrew
Discipline Historian
Date 7/21/83
 see continuation sheet

Nomination returned for: technical corrections cited below
 substantive reasons discussed below

1. Name

2. Location

3. Classification

Category Ownership Status Present Use
Public Acquisition Accessible

4. Owner of Property

5. Location of Legal Description

6. Representation in Existing Surveys

Has this property been determined eligible? yes no

7. Description

Condition: excellent deteriorated good fair
Check one: unaltered altered
Check one: original site moved date _____

Describe the present and original (if known) physical appearance

- summary paragraph
- completeness
- clarity
- alterations/integrity
- dates
- boundary selection

8. Significance

Period _____ Areas of Significance—Check and justify below

Specific dates _____ Builder/Architect _____

Statement of Significance (in one paragraph)

- summary paragraph
- completeness
- clarity
- applicable criteria
- justification of areas checked
- relating significance to the resource
- context
- relationship of integrity to significance
- justification of exception
- other

9. Major Bibliographical References

10. Geographical Data

Acreage of nominated property _____

Quadrangle name _____

USMT References _____

Verbal boundary description and justification _____

11. Form Prepared By

12. State Historic Preservation Officer Certification

The evaluated significance of this property within the state is:

 national state local

State Historic Preservation Officer signature _____

title _____ date _____

13. Other

- Maps
- Photographs
- Other

Questions concerning this nomination may be directed to _____

Signed _____ Date _____ Phone: 202 272-3504

Comments for any item may be continued on an attached sheet





Please refer to the map in the
Multiple Property Cover Sheet
for this property

Multiple Property Cover Sheet Reference Number: 64000257