

1. Historic Name(s) <u>Trimble County Jail</u>		22. ADD: County No. Ky./Trimble <span style="float:right">1 1 2</span>	
Original Owner <u>Trimble County Fiscal Court</u>		23. U.S.G.S. Quadrant (15', 75') <u>Bedford</u> <span style="float:right">G.I.S. Mod. <input type="checkbox"/></span>	
2. Present Name <u>Trimble County Jail</u>		24. UTM Reference <u>16 646500 4272830</u> Zone Easting Northing	
3. Location <u>Main Street</u>		25. Coordinate Accuracy <input type="checkbox"/>	
4. Owner's Name <u>Trimble County Fiscal Court</u>		26. Prehistoric Site Object Historic Site Structure (Building) Other	
5. Owner's Address <u>Main Street, Bedford</u>		27. National Register District Name: <u>Historic Resources of Trimble County</u>	
6. Open to Public Yes <input type="checkbox"/> No <input checked="" type="checkbox"/>	7. Visible from road Yes <input checked="" type="checkbox"/> No <input type="checkbox"/>	8. Ownership Private <input type="checkbox"/> Local <input checked="" type="checkbox"/> State <input type="checkbox"/> Federal <input type="checkbox"/>	
9. Local Contact/Organization		28. Significance Evaluation <u>National Register</u> <span style="float:right">D</span>	
10. Site Plan with North Arrow		11. Architect	
		12. Builder	
		13. Date <u>1850-1st Part</u> <u>1899-on back</u> A. <input checked="" type="checkbox"/> B. <input checked="" type="checkbox"/>	
		14. Style A. <input type="checkbox"/> B. <input type="checkbox"/>	
		15. Original Use <u>Jail</u> <span style="float:right">J</span>	
		16. Present use " <input type="checkbox"/>	
		17. Condition <u>Fair</u> <span style="float:right">C</span>	
18. Description		29. Status <input type="checkbox"/> Date _____ National Landmark _____ National Register _____ Landmark Certificate _____ Kentucky Survey _____ Local Landmark _____ HABS/HAER _____	
<p>A two-story sandstone jail situated in the courthouse square. The original structure, built in 1851, was one-story, and the second floor was added in 1899. Fenestration for the original one-story structure was one-bay, while the second floor has a side passage and two small window slits.</p> <p style="text-align: right;">(Continue on Back)</p>		30. Historic Theme Primary <u>Architecture</u> <span style="float:right">C</span> Secondary <u>Governmental</u> <span style="float:right">J</span> Other <input type="checkbox"/>	
		31. Endangered Yes <input type="checkbox"/> No <input checked="" type="checkbox"/>	
		32. Preservation Project Status <input type="checkbox"/>	
		Actual Cost in \$1,000s <input type="checkbox"/>	
		33. ATTACH PHOTO	
19. History		Roll No. <u>29</u> Picture No. <u>21-31</u> Direction _____	
Dehlia Webster, an ardent abolitionist was once jailed here.		34. Prepared by: <u>William Gus Johnson</u> <u>Sr. Historian &amp; Photographer</u>	
20. Significance <u>Governmental &amp; Architecture: A significant examples of sandstone construction.</u>		35. Organization <u>Kentucky Heritage Council</u>	
21. Source of Information		36. Date <u>Fall 1982</u>	
		37. Revision Dates _____ 38. Staff Review _____	

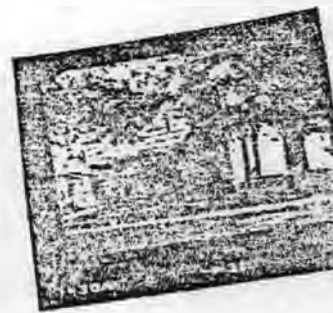

KENTUCKY HISTORIC RESOURCE INVENTORY SUPPLEMENT  
BOUNDARY AND LOCATION INFORMATION

Historic Property Name Trimble County Jail Site # Tm-B-19  
Multiple Resource/Thematic Nomination Title Historic Resources of Trimble County

U.T.M. Coordinates - List multiple UTMs if property is ten or more acres.

A. 16 646500 4272830 D. \_\_\_\_\_  
B. \_\_\_\_\_ E. \_\_\_\_\_  
C. \_\_\_\_\_ F. \_\_\_\_\_

Verbal Boundary Description \_\_\_\_\_ Acreage .20

The Trimble County Jail is situated in the Courthouse Square which measures 250' X 178'. The Square is bounded by Main Street on the east, Church Street on the north, West Street (Smith Street) on the west, and Spring Street on the south. Beginning at the intersection of Main and Church Streets proceed 178' in a northwestward direction along Church Street; thence 178' in a southeastward direction; thence 50' in a northeastward direction along Main Street to the point of origin.

Sketch of Site Plan (Showing outbuildings, structures, landscape features and the site boundary as described above.)

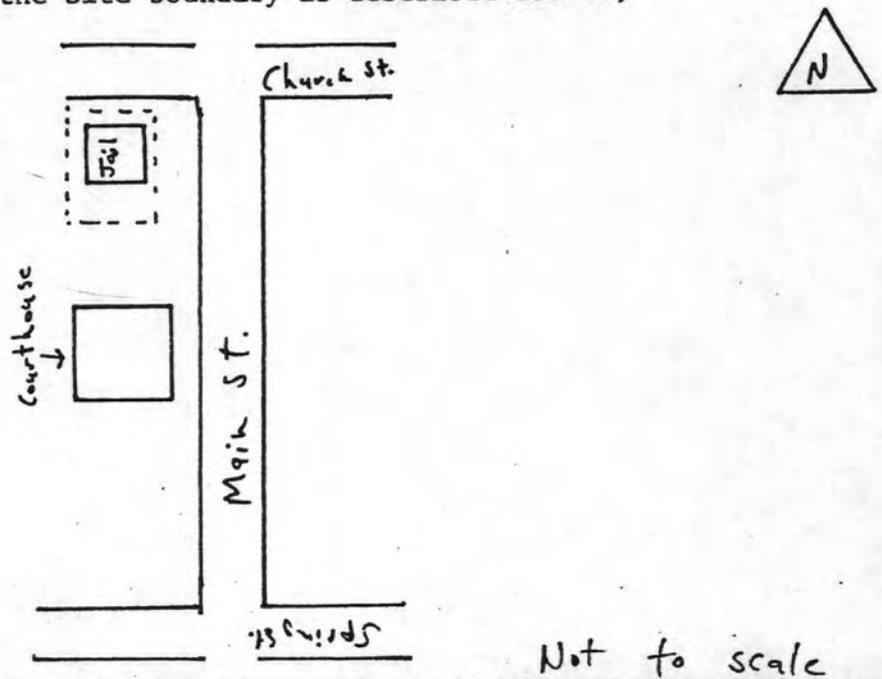

Official Courthouse Property Reference:

United States Department of the Interior  
National Park Service

*Substantive Review*

Trimble County Jail (Trimble County MRA)  
Trimble County  
KENTUCKY

Working No. JUN 14 1983

Fed. Reg. Date: \_\_\_\_\_

Date Due: 7/14/83 - 7/29/83

Action:  ACCEPT  
 RETURN 7/21/83  
 REJECT

Federal Agency: \_\_\_\_\_

- resubmission
- nomination by person or local government
- owner objection
- appeal

Substantive Review:  sample  request  appeal  NR decision

Reviewer's comments:

*VBP is incomplete*

Recom./Criteria Return  
Reviewer Patrick Andrus  
Discipline Historian  
Date 7/11/83  
 see continuation sheet

Nomination returned for:  technical corrections cited below  
 substantive reasons discussed below

1. Name

2. Location

3. Classification

Category	Ownership	Status	Present Use
	Public Acquisition	Accessible	

4. Owner of Property

5. Location of Legal Description

6. Representation in Existing Surveys

has this property been determined eligible?  yes  no

7. Description

Condition		Check one	Check one
<input type="checkbox"/> excellent	<input type="checkbox"/> deteriorated	<input type="checkbox"/> unaltered	<input type="checkbox"/> original site
<input type="checkbox"/> good	<input type="checkbox"/> ruins	<input type="checkbox"/> altered	<input type="checkbox"/> moved date _____
<input type="checkbox"/> fair	<input type="checkbox"/> unexposed		

Describe the present and original (if known) physical appearance

- summary paragraph
- completeness
- clarity
- alterations/integrity

## 8. Significance

Period \_\_\_\_\_ Area of Significance—Check and justify below

Specific dates \_\_\_\_\_ Builder Architect \_\_\_\_\_

Statement of Significance (in one paragraph)

- summary paragraph
- completeness
- clarity
- applicable criteria
- justification of areas checked
- relating significance to the resource
- context
- relationship of integrity to significance
- justification of exception
- other

Is the jail still in use as a jail? Has this been the only jail in the county? Is the use of sandstone unusual in buildings in the county - was it reserved for use in public buildings?

## 9. Major Bibliographical References

## 10. Geographical Data

Acres of nominated property \_\_\_\_\_

Quadrangle name \_\_\_\_\_

UMT References \_\_\_\_\_

Verbal boundary description and justification

The VBD describes only 3 sides of the nominated area. Please provide 4th

## 11. Form Prepared By

## 12. State Historic Preservation Officer Certification

The evaluated significance of this property within the state is:

\_\_\_\_\_ national \_\_\_\_\_ state \_\_\_\_\_ local

State Historic Preservation Officer signature \_\_\_\_\_

title \_\_\_\_\_ date \_\_\_\_\_

## 13. Other

- Maps
- Photographs
- Other

Questions concerning this nomination may be directed to Patrick Andrus

Signed Patrick Andrus Date 7/21/83 Phone: 202 272 - 3504

Comments for any item may be continued on an attached sheet

KENTUCKY HISTORIC RESOURCES INVENTORY

Site No. Tm-B-19

1984

1. Historic Name(s) <u>Trimble County Jail</u>		22. ADD/County <u>No. Ky. / Trimble</u> <span style="float:right">112</span>	
Original Owner <u>Trimble County Fiscal Court</u>		23. U.S.G.S. Quadrant (15'/75') <u>Bedford</u> <span style="float:right">G.I.S. Mod. [ ] [ ] [ ]</span>	
2. Present Name <u>Trimble County Jail</u>		24. UTM Reference <u>16</u> <u>6,4,6,5,0,0</u> <u>4,2,7,2,8,3,0</u> Zone Easting Northing	
3. Location <u>Main Street, Bedford</u>		25. Coordinate Accuracy <span style="float:right">[ ]</span>	
4. Owner's Name <u>Trimble County Fiscal Court</u>		26. Prehistoric Site Object Historic Site Structure (Building) Other	
5. Owner's Address <u>Main Street, Bedford</u>		27. National Register District Name: <u>Historic Resources of Trimble County</u> <span style="float:right">[ ] [ ] [ ]</span>	
6. Open to Public Yes <input type="checkbox"/> No <input checked="" type="checkbox"/>	7. Visible from road Yes <input checked="" type="checkbox"/> No <input type="checkbox"/>	8. Ownership Private <input type="checkbox"/> Local <input checked="" type="checkbox"/> State <input type="checkbox"/> Federal <input type="checkbox"/>	28. Significance Evaluation <u>National Register</u> <span style="float:right">[D]</span>
9. Local Contact/Organization		29. Status <span style="float:right">Date</span> National Landmark <input type="checkbox"/> National Register <input type="checkbox"/> Landmark Certificate <input type="checkbox"/> Kentucky Survey <input type="checkbox"/> Local Landmark <input type="checkbox"/> HABS/HAER <input type="checkbox"/>	
10. Site Plan with North Arrow		30. Historic Theme Primary <u>Architecture</u> <span style="float:right">[C]</span> Secondary <u>Governmental</u> <span style="float:right">[J]</span> Other <input type="checkbox"/>	
11. Architect		31. Endangered Yes <input type="checkbox"/> No <input checked="" type="checkbox"/>	
12. Builder		32. Preservation Project Status <span style="float:right">[ ]</span>	
13. Date <u>1850-1st Part</u> <u>1899-2nd Floor</u> <span style="float:right">[3]</span> B. <span style="float:right">[5]</span>		Actual Cost in \$1,000s <span style="float:right">[ ] [ ] [ ] [ ] [ ]</span>	
14. Style A. Vernacular <input checked="" type="checkbox"/> B. <input type="checkbox"/>		33. ATTACH PHOTO 	
15. Original Use <u>Jail</u> <span style="float:right">[J]</span>		34. Prepared by: <u>William Gus Johnson</u> <u>Sr. Historian &amp; Photographer</u>	
16. Present use <u>Jail</u>		35. Organization <u>Kentucky Heritage Council</u>	
17. Condition <u>Fair</u> <span style="float:right">[C]</span>		36. Date <u>Fall 1982</u>	
18. Description A two-story sandstone jail situated in the courthouse square. The original structure, built in 1851, was one-story, and the second floor was added in 1899. Renetration for the original one-story structure was one-bay, while the second floor has a side passage and two small window slits.		37. Revision Dates <span style="float:right">38. Staff Review</span>	
(Continue on Back)			
19. History <u>Dehlia Webster, an ardent abolitionist was once jailed here.</u>			
20. Significance <u>Politics/Government &amp; Architecture: The structure is significant in the area of politics/government. It was the second county jail constructed in</u>			
21. Source of Information			

20. Trimble County, and continues to function so today. The Trimble County jail also is architecturally significant as the only documented sandstone structure in the county.

KENTUCKY HISTORIC RESOURCE INVENTORY SUPPLEMENT  
BOUNDARY AND LOCATION INFORMATION

Historic Property Name Trimble County Jail Site # Tm-B-19

Multiple Resource/Thematic Nomination Title Historic Resources of Trimble County

U.T.M. Coordinates - List multiple UTMs if property is ten or more acres.

A. 16      646500      4272830      D. \_\_\_\_\_

B. \_\_\_\_\_      E. \_\_\_\_\_

C. \_\_\_\_\_      F. \_\_\_\_\_

Verbal Boundary Description      Acreage .20

The Trimble County Jail is situated in the Courthouse Square which is bounded by Main Street on the east, Church street on the north, West Street (Smith Street) on the west, and Spring Street on the south. Beginning at the intersection of Main and Church Streets proceed 178' in a westward direction along Church Street; thence 50' in a southward direction; thence 178' in an eastward direction, thence 50' in a northward direction along Main Street to the point of origin.

Sketch of Site Plan (Showing outbuildings, structures, landscape features and the site/boundary as described above.)

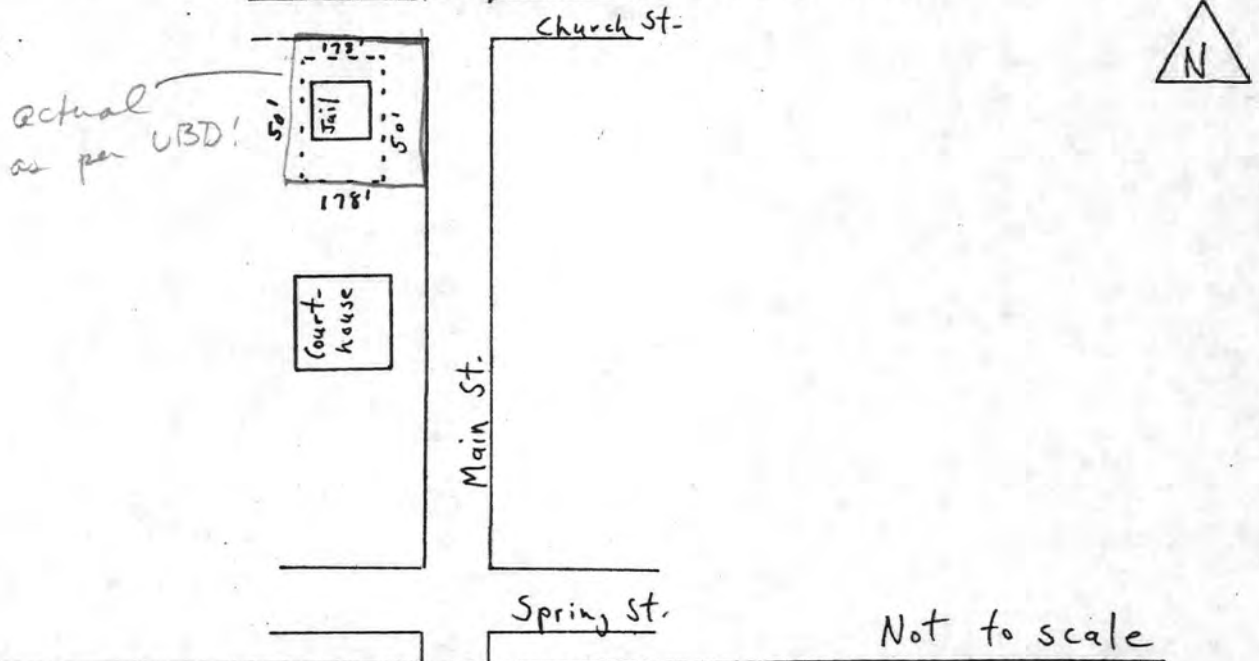

Official Courthouse Property Reference:

United States Department of the Interior  
National Park Service

National Register of Historic Places  
Inventory—Nomination Form

For NPS use only

received 6/14/83

date entered

Continuation sheet

Item number

Page 4 of 4

Multiple Resource Area  
Thematic Group

Name Trimble County Multiple Resource Area

State Kentucky

Nomination/Type of Review

Date/Signature

Substantive Review

31. Trimble County Jail

Keeper

W.A. Doherty 4/9/84

Attest

32. Trout House

Substantive Review

for Keeper

accept Patrick Andrews 7/21/83

Attest

33. Yeager General Store

Substantive Review

for Keeper

accept Patrick Andrews 7/21/83

Attest

34. Third Street Historic District

Substantive Review

Keeper

W.A. Doherty 4/10/84

Attest

35.

Keeper

Attest

36.

Keeper

Attest

37.

Keeper

Attest

38.

Keeper

Attest

39.

Keeper

Attest

40.

Keeper

Attest



NATIONAL REGISTER OF HISTORIC PLACES  
EVALUATION/RETURN SHEET

Trimble County Jail (Trimble County MRA)  
Trimble County  
KENTUCKY

Substantive Review

Working No. JUN 14 1983  
Fed. Reg. Date: 2-5-85  
Date Due: 5/3/84  
Action:  ACCEPT 4-9-84  
 RETURN  
 REJECT  
Federal Agency: \_\_\_\_\_

- resubmission
- nomination by person or local government
- owner objection
- appeal

Substantive Review:  sample  request  appeal  NR decision

Reviewer's comments: 2 story 1890's sandstone jail associated with Politics/government and significant example of stone construction in MRA.

Recom./Criteria ACCEPT A,C  
Reviewer DOUBLE  
Discipline HIST  
Date 9/9/84  
\_\_\_\_\_ see continuation sheet

Nomination returned for: \_\_\_\_\_ technical corrections cited below  
\_\_\_\_\_ substantive reasons discussed below

1. Name

2. Location

3. Classification

Category Ownership Status Present Use  
Public Acquisition Accessible

4. Owner of Property

5. Location of Legal Description

6. Representation in Existing Surveys

Has this property been determined eligible?  yes  no

7. Description

Condition Check one Check one  
 excellent  deteriorated  unaltered  original site  
 good  ruins  altered  moved date \_\_\_\_\_  
 fair  unexposed

Describe the present and original (if known) physical appearance

- summary paragraph
- completeness
- clarity
- alterations/integrity
- dates
- boundary selection

---

**8. Significance**

Period      Areas of Significance—Check and justify below

Specific dates      Builder/Architect

Statement of Significance (*in one paragraph*)

- summary paragraph
- completeness
- clarity
- applicable criteria
- justification of areas checked
- relating significance to the resource
- context
- relationship of integrity to significance
- justification of exception
- other

---

**9. Major Bibliographical References**

---

**10. Geographical Data**

Acreage of nominated property \_\_\_\_\_

Quadrangle name \_\_\_\_\_

UTM References \_\_\_\_\_

Verbal boundary description and justification \_\_\_\_\_

---

**11. Form Prepared By**

---

**12. State Historic Preservation Officer Certification**

The evaluated significance of this property within the state is:

\_\_\_\_ national      \_\_\_\_ state      \_\_\_\_ local

State Historic Preservation Officer signature

title

date

---

**13. Other**

- Maps
- Photographs
- Other

Questions concerning this nomination may be directed to \_\_\_\_\_

Signed \_\_\_\_\_ Date \_\_\_\_\_ Phone: \_\_\_\_\_







Please refer to the map in the  
Multiple Property Cover Sheet  
for this property

Multiple Property Cover Sheet Reference Number: 64000257