

J.P.W.

D.R.

TOPOGRAPHER, Post Office Department,

SEP 3 1902

TOPOGRAPHER'S OFFICE,

P. O. DEPT.

Washington, D. C., Aug 15, 1902

Sir:

To enable the Topographer of this Department to determine, with as much accuracy as possible, the relative positions of Post Offices, so that they may be correctly delineated on its maps, the Postmaster General requests you carefully to answer the questions below, and furnish the diagram on the other side, returning the same as soon as possible, verified by your signature and dated, under cover to the Topographer's Office, Post Office Department.

Respectfully, etc.,

Wm. Drake

To POSTMASTER AT Dry Ridge, Topographer P. O. Dept.
Grant Co., for new site as
Ny found 120-ft. N.

The (P. O. Dept.) name of my Office is DRY RIDGE NY

If the town, village, or site of the Post Office be known by another name than that of the Post Office, state that other name here: 33

My Office is situated in Centra part of _____ Township, or in _____ quarter of Tract _____ Township, County of Grant State of Ny

The name of the most prominent river near it is Licking
The name of the nearest creek is Clan
My Office is 15 1/4 miles from said river, on the West side of it, and is 5 miles from said nearest creek, on the East side of it.

My Office is on Mail Route No. _____
My Office is a Special Office supplied from _____ miles distant.

The name of the nearest Office on my route is _____, and its distance is _____ miles, by the traveled road, in a _____ direction from this, my Office.

The name of the nearest Office, on the same route, on the other side, is _____ and its distance is _____ miles in a _____ direction from this, my Office.

The name of the nearest Office off the route is _____, and its distance by the most direct road is _____ miles in a _____ direction from this, my Office.

My Office is at a distance of 380 feet from the track of the _____ Railroad, on the West side of the railroad.

My Office is 4 1/2 miles, air-line distance, from nearest point of my County boundary.

(Signature of Postmaster) W. E. McClure

(Date) Sept. 1 - 1902

DIAGRAM, EXPLANATION, AND INSTRUCTIONS.

The dot in the center of the 1-mile circle represents the site of your office.
 The surrounding offices should be carefully located by placing dots on or between the mile circles at the exact distance, and in the right direction from your office, and their names plainly written.

If it should be necessary to designate an office which is over 10 miles from your site, place the dot outside of the 10-mile circle, write the name of such office, and state its distance from your site.

Draw distinctly the railways, roads, rivers, and creeks.

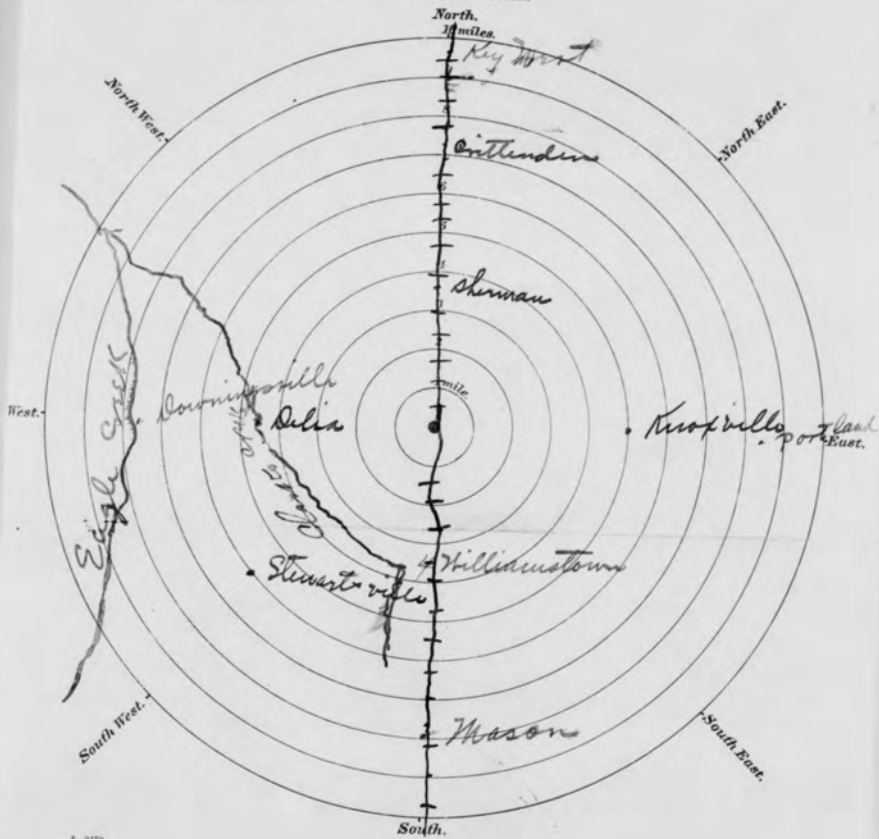

F.M.P.

DIVISION OF
EQUIPMENT AND SUPPLIES

Post Office Department
FOURTH ASSISTANT POSTMASTER GENERAL
Washington

D.R.

Postmaster, Dry Ridge,
Grant Co.,
Ky.

July 27 '17

In order that the site of your post office may be accurately represented upon the post-route maps, it is requested that you carefully answer the questions below and furnish a sketch, according to instructions on opposite side of paper, which should be returned to this Division as soon as possible.

FOURTH ASSISTANT POSTMASTER GENERAL.

Fourth Assistant Postmaster General.

The name of my post office is Dry Ridge

If the town, village, or site of the post office be known by another name than that of the post office, state that other name here: _____

My post office is situated in the center part of Grant County Township, or in _____ quarter of tract _____ Number _____ Township, County of Grant State of Kentucky

The name of the nearest river is Picking River, and the post-office building is at a distance of 15 miles on the N side of it.
N., S., E., or W.

The name of the nearest creek is Clarks Creek, and the post-office building is at a distance of 5 1/2 miles on the E. side of it.
N., S., E., or W.

The name of the nearest office on my route is Sherman Ky and its distance is 4 1/2 miles, by the traveled road, in a N direction from this, my office.
N., S., E., or W.

The name of the nearest office on my route, on the other side, is None and its distance is _____ miles, in a _____ direction from this, my office.
N., S., E., or W.

The name of the nearest office not on my route is Williamstown Ky and its distance is 4 miles, by the traveled road, in a S direction from this, my office.
N., S., E., or W.

The post-office building is on the N side of the C. N. O & T. P Railroad, and at a distance of 500 ft from the track.
N., S., E., or W.

The railroad station name is Dry Ridge Ky

My post office is 5 miles air-line distance, 2 from the nearest point of my county boundary.
N., S., E., or W.

Postmaster: Otto Casper

Date: Aug 6 1917

DIAGRAM, EXPLANATION, AND INSTRUCTIONS.

The dot in the center of the 1-mile circle represents the site of the post office.
The surrounding offices should be carefully located by placing dots on or between the mile circles at the exact distance, and in the right direction, from the post office, and their names plainly written.
Draw distinctly the railways, roads, rivers, and creeks.

5-4225

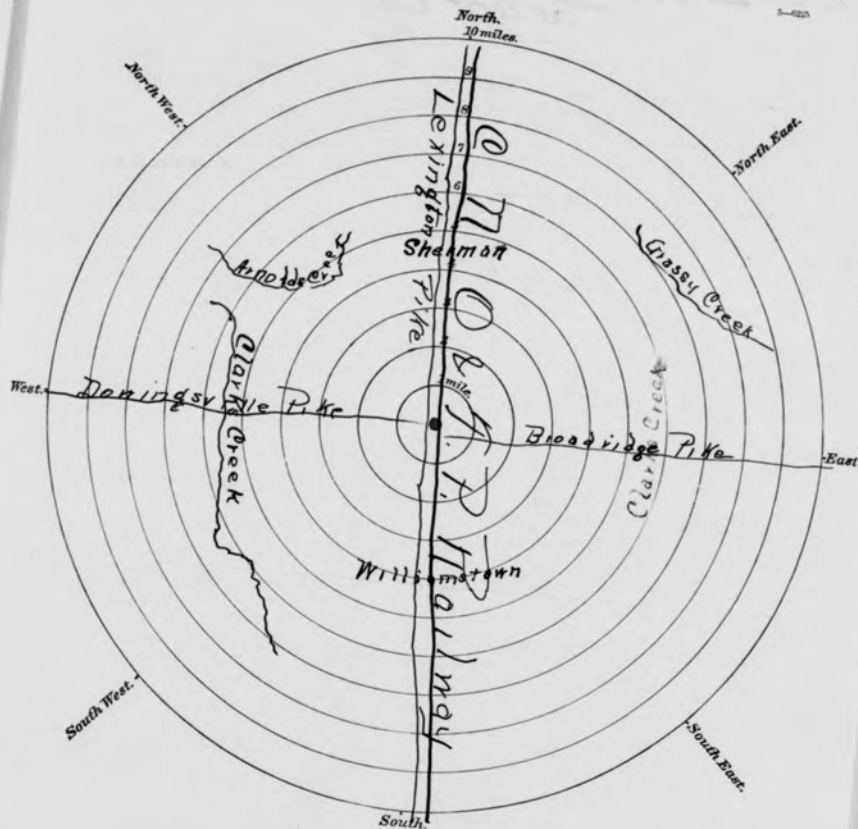

Post Office Department
FOURTH ASSISTANT POSTMASTER GENERAL
Washington

D. R.

RETURN TO
 DIVISION OF TOPOGRAPHY

Postmaster,
DRY RIDGE,

JUL 20 1939

KY.

The following information is required in order that your post office may be shown in its proper location on postal maps. Please complete this form immediately and return it without delay with the map or sketch described on the reverse side. A letter of reply is not necessary.

S. W. Murdum
 FOURTH ASSISTANT POSTMASTER GENERAL

- Street address of post office _____ County Grant
- Township _____ (If location is described by section, township, and range, fill in line 3.)
- _____ quarter of section _____ Township _____ N. or S. _____ Range _____ E. or W. _____
- Nearest adjoining county Pendleton How far: Shortest air distance? 4 mi By road? 4 1/2 mi
- Nearest U. S. or State highway No. 22 Direction from P. O. South Distance 6 ft.
- Name of nearest railroad station Dry Ridge Name of railroad C. D. O. & T. P.
- Distance by road to railroad station 1568 ft Direction from post office South-east
- Shortest air distance to nearest tracks 500 ft. Direction from post office East
- Nearest streams or bodies of water (state whether river, creek, branch, lake, ocean, etc.):

Name	Direction from post office	Distance
<u>Clarke Creek</u>	<u>West</u>	<u>3 1/2 mi</u>
<u>Eagle Creek</u>	<u>East</u>	<u>600 ft</u>
- Post offices nearest to your office (one in each general direction):

Name	County	Direction from your office	Distance by road
<u>Sherman</u>	<u>Grant</u>	<u>north</u>	<u>3 mi</u>
<u>Williams town</u>	<u>"</u>	<u>South</u>	<u>4 "</u>
<u>Jonesville</u>	<u>"</u>	<u>West</u>	<u>10 "</u>
<u>Falmouth</u>	<u>Pendleton</u>	<u>East</u>	<u>18 "</u>
- How is mail supplied to your office? Railroad From where? Dry Ridge
(Railroad, star route, rural route, etc.)

POST OFFICE DEPT.
 Fourth Assistant P. M. G.
JUL 27 1939
 Division of Topography
 4-4-3

(Date) 7-25-39

(Signed) Sola Mc Coy Postmaster.

Post office Dry Ridge Ky

(OVER)

8-11874

IMPORTANT.—A map or sketch showing the location of your post office must be submitted with the return of this paper. A printed map, such as prepared by the county or city engineer, is preferred, if it can be furnished without expense to the Department. Be sure, however, to mark on it the exact site of the post office, placing a small dot in the proper square or block and on the proper side of the street.

If a separate map cannot be furnished it is necessary to submit a sketch as described below.

These diagrams are furnished simply to make it easier to draw a sketch that will show correct distances from your post office.

SQUARE DIAGRAM

Use this diagram if your post office is located in an area described by section, township, and range, and you have filled in line 3 on the other side. Otherwise use the circular diagram.

Place a small dot representing your post office in the proper quarter-section and fill in the blanks for township and range numbers.

Then draw the following features: (Note that one-half inch on the paper equals 1 mile on the ground.)

- Adjacent post offices (show with small dots and name).
- Railroads (show by single line with cross marks; name).
- Highways (show by double lines close together and mark U. S. and State numbers; name in margin the post office to which each road leads).
- Rivers, creeks, lakes, etc. (show by wavy lines and name).
- County line (show by dashes).

CIRCULAR DIAGRAM

Use this diagram if your post office is NOT located in an area described by section, township, and range.

Let the dot in the center of the circle represent your post office.

Then draw the features a, b, c, d, and e, as described above. (Note the scale of this diagram: One-quarter inch equals 1 mile.)

