

KENTUCKY HISTORIC RESOURCES INVENTORY

BE-54

21 of 2

Site No. _____

1. Historic Name(s) **John Tanner House**
 Original Owner **Reverend John Tanner**
 2. Present Name **John Tanner House**
 3. Location **north side of Highway 20, 1/2 mile east of Ohio River at Petersburg**
 4. Owner's Name **Kenneth Griffith**
 5. Owner's Address **6402 Petersburg Road, Petersburg, Kentucky**
 6. Open to Public Yes No 7. Ownership Private Local State Federal

28. ADD/County **No. KY/Boone**
 29. U.S.G.S. Quadrant (15'/75') **Lawrenceburg**
 30. UTM Reference **16 684760 4325960**
 Zone Easting Northing
 31. Coordinate Accuracy
 32. Prehistoric Site Object
 Historic Site Structure
 (Building) Other
 33. National Register District Name: **same**
Early Stone Bldg.

8. Site Plan with North Arrow *attached*
 9. Architect/Builder _____
 10. Date **late 18th** A. B.
 11. Style **Federal** A. B.
 12. Original Use **Residence** A.
 13. Present Use **Residence**
 14. Condition **Fair-Good** B.
 15. Stories, No. of **Two** C.

34. Significance of Evaluation
 35. Status _____ Date _____
 National Landmark
 National Register
 Landmark Certificate **Nov. 30, 1978**
 Kentucky Survey **Aug. 4, 1977**
 Local Landmark
 HABS/HAER
 36. Historic Theme **Settlement**
 Primary **Architecture**
 Secondary
 Other
 37. Endangered Yes No

16. Description **Two-story, three-bay, dry stone hall parlor house, built end-wise into the hillside. Interior chimney on south end. Narrow mitered corner frames. Square sills, no voussoirs. Some re-pointing with concrete; original mortar flat. Off-center fenestration. First and second floor windows same size. Beaded board door south end. Breakfront (at corners) mantel with reeded pilasters, in hall. Interior now partitioned into four rooms. Walls sheathed with panelling. Beaded-board interior door. House located on hillside overlooking farmland and town of Petersburg at river. Garage is not old.**
 (Continue on Back)
 17. Single Pile Double Pile _____ NA _____
 18. Floor Plan **Hall/Parlor** E.
 19. Structural Fabric **Stone** A. B.
 20. Decorative Fabric **stone** A. B.
 21. Roof Form & Material **Gable/Now Metal**
 22. Foundation Material **Stone** A.
 23. Outbuildings **Frame, not old** C.
 24. Alterations Moved Additions Wall Treatment

38. ATTACH PHOTO
 Roll No. **same 2**
 Picture No. **5-12, slides also**
 Direction _____
 39. Prepared by: **Carolyn M. Wooley**
 40. Organization **Kentucky Heritage Council**
 41. Date **October 1983**
 42. Revision Dates _____ 43. Staff Review _____

25. History **Built by Reverend John Tanner, first Baptist preacher in KY. who founded Tanner's Station in 1789 (renamed Petersburg in 1814). Tanner was from Pennsylvania. He and John Taylor**
 26. Significance **Oldest existing stone house in Boone County, built by founder of Petersburg.**

27. Source of Information **Collins, History of Kentucky. II Alice Jarrell, 586-5265**

JUN 6 1983

25. purchased the 2,000 acre military grant of John David Woolperts. Tanner's two sons were captured by Indians in 1790; one escaped and the other lived with Indians the remainder of his life.

Some local accounts state that a tannery once operated at the house, *probably an error based on the Tanner name.*

KENTUCKY HISTORIC RESOURCE INVENTORY SUPPLEMENT
BOUNDARY AND LOCATION INFORMATION

Historic Property Name John Lanner house Site # 12c-54
Multiple Resource/Thematic Nomination Title Early Stone Bldgs. of Ky.

U.T.M. Coordinates - List multiple UTM's if property is ten or more acres.

A. 16 684760 4325960 D. _____
B. _____ E. _____
C. _____ F. _____

Verbal Boundary Description Acreage 1 1/2 acres

Beginning at A, at the corner of the property at the road, then w property line, SW to B at the road, NW to C, N to D at the road, E to E at the road, and SE with road to the beginning, containing about 1 1/2 acres.

Sketch of Site Plan (Showing outbuildings, structures, landscape features and the site boundary as described above.)

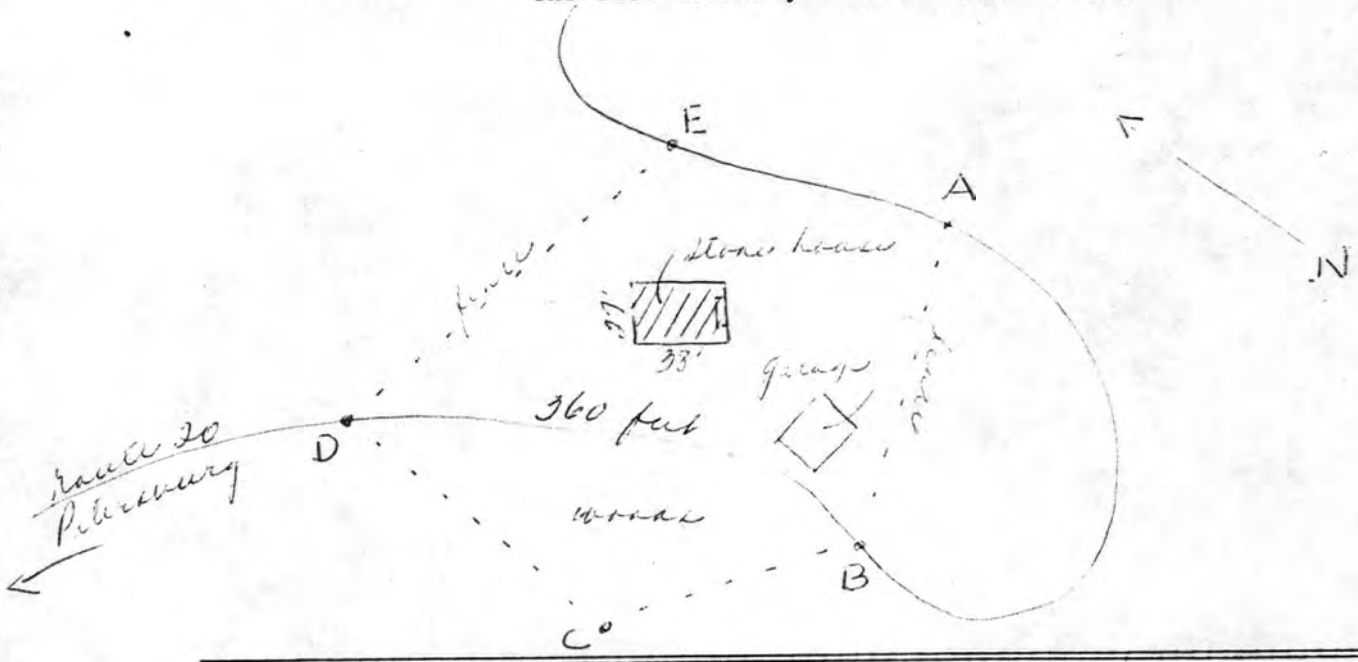

Official Courthouse Property Reference:

NATIONAL REGISTER OF HISTORIC PLACES
EVALUATION/RETURN SHEET

Tanner, John, House (Early Stone Buildings of
Kentucky TR)
Boone County
KENTUCKY

Substantive Review

Working No. JUN 6 1985

Fed. Reg. Date:

Date Due: 7/4/85 - 7/21/85

Action: ACCEPT

RETURN 7-21-85

REJECT

Federal Agency:

- resubmission
- nomination by person or local government
- owner objection
- appeal

Substantive Review: sample request appeal NR decision

Reviewer's comments:

See comments

Recom./Criteria

Reviewer

Discipline

Date

see continuation sheet

Nomination returned for: technical corrections cited below
 substantive reasons discussed below

1. Name

2. Location

3. Classification

Category	Ownership Public Acquisition	Status Accessible	Present Use
----------	---------------------------------	----------------------	-------------

4. Owner of Property

5. Location of Legal Description

6. Representation in Existing Surveys

Has this property been determined eligible? yes no

7. Description

Condition

- excellent
- good
- fair

- deteriorated
- ruins
- unexposed

Check one

- unaltered
- altered

Check one

- original site
- moved date _____

Describe the present and original (if known) physical appearance

- summary paragraph
- completeness
- clarity
- alterations/integrity
- dates
- boundary selection

8. Significance

Period Areas of Significance—Check and justify below

Specific dates Builder/Architect
Statement of Significance (in one paragraph)

- summary paragraph
- completeness
- clarity
- applicable criteria
- justification of areas checked
- relating significance to the resource
- context
- relationship of integrity to significance
- justification of exception
- other

What is context of this building in relation to others (not stone) of period in County?
 What is role of founder of Petersburg?

9. Major Bibliographical References

10. Geographical Data

Acreage of nominated property _____
 Quadrange name _____
 UTM References _____

Verbal boundary description and justification

no boundary justification—^{what is} curved line

11. Form Prepared By

amid A, E+D, B?

12. State Historic Preservation Officer Certification

The evaluated significance of this property within the state is:

___ national ___ state ___ local

what is relationship of woods to property?

State Historic Preservation Officer signature

title _____ date _____

13. Other

- Maps
- Photographs
- Other

Questions concerning this nomination may be directed to _____

Signed Cave D Shull Date 7-21-85 Phone: _____

KENTUCKY HISTORIC RESOURCES
Individual Inventory Form

Resource # BE-54
BOONE County

<p>1. Name of Resource: John Tanner House</p> <p>2. Original Owner: John Tanner</p> <p>3. Other Names:</p> <hr/> <p>4. Prehistoric Site Building <input checked="" type="checkbox"/> Object Historic Site Structure Other</p> <p>5. Location: North side KY 20, one-half mile east of Ohio River at Petersburg</p> <p>6. Owner's Name: Kenneth Griffith [P]</p> <p>7. Owner's Address: 6402 Petersburg Road Petersburg, Kentucky 42455</p> <p>8. Evaluation: National Register Theme [G]</p> <p>9. Recognition & Date: <table border="0"> <tr> <td>Nat. Landmark _____</td> <td>Local Landmark _____</td> </tr> <tr> <td>Nat. Register _____</td> <td>HABS/HAER _____</td> </tr> <tr> <td>Highway Marker _____</td> <td>KY Inventory 8/4/77</td> </tr> <tr> <td colspan="2">KY Landmark Certificate November 30, 1978</td> </tr> </table> </p> <p>10. N.R. Status & Date:</p> <p>11. N.R. Group: <table border="0"> <tr> <td>District Name:</td> <td>[]</td> </tr> <tr> <td>Mult. Resource Area:</td> <td>[]</td> </tr> <tr> <td>Thematic Name:</td> <td>Early Stone Buildings []</td> </tr> </table> </p> <p>12. Historical Theme: <table border="0"> <tr> <td>Primary: Architecture</td> <td>[030]</td> </tr> <tr> <td>Secondary: Settlement</td> <td>[140]</td> </tr> <tr> <td>Other:</td> <td>[]</td> </tr> </table> </p> <p>13. Statement of Significance: Oldest existing stone house in Boone County, built by founder of Petersburg, oldest settlement in Boone County. Good example of banked house, and hall parlor plan with off-center fenestration. [] </p>	Nat. Landmark _____	Local Landmark _____	Nat. Register _____	HABS/HAER _____	Highway Marker _____	KY Inventory 8/4/77	KY Landmark Certificate November 30, 1978		District Name:	[]	Mult. Resource Area:	[]	Thematic Name:	Early Stone Buildings []	Primary: Architecture	[030]	Secondary: Settlement	[140]	Other:	[]	<p>16. Date: <table border="0"> <tr> <td>Original Building</td> <td>late 18th cent.</td> <td>[9]</td> </tr> <tr> <td>Addition</td> <td></td> <td>[]</td> </tr> </table> </p> <p>17. Style: <table border="0"> <tr> <td>Federal</td> <td>[21]</td> </tr> <tr> <td></td> <td>[]</td> </tr> </table> </p> <p>18. Architect/Builder: Unknown</p> <p>19. No. of Stories: Two [2.0]</p> <p>20. Original Floor Plan: <table border="0"> <tr> <td>Hall-parlor</td> <td>[HP]</td> </tr> </table> </p> <p>21. Single Pile <input checked="" type="checkbox"/> Double Pile N.A.</p> <p>22. Roof Form & Material: <table border="0"> <tr> <td>Gable</td> <td>Original</td> <td></td> </tr> <tr> <td></td> <td>Not Original</td> <td>XX</td> </tr> </table> </p> <p>23. Structural Material: <table border="0"> <tr> <td>Stone</td> <td>[S]</td> </tr> </table> </p> <p>24. Exterior Material: <table border="0"> <tr> <td>Stone</td> <td>[S]</td> </tr> <tr> <td></td> <td>[]</td> </tr> </table> </p> <p>25. Foundation Material: <table border="0"> <tr> <td>Stone</td> <td>[S]</td> </tr> </table> </p> <p>26. Major Alterations: <table border="0"> <tr> <td>Moved/Rebuilt</td> <td>None</td> <td>XX</td> </tr> <tr> <td>Additions</td> <td>Other</td> <td></td> </tr> </table> </p> <p>27. Special Features:</p> <p>28. Outbuildings: <table border="0"> <tr> <td></td> <td>[0]</td> </tr> </table> </p> <p>29. Original Function: <table border="0"> <tr> <td>Residence</td> <td>[01A]</td> </tr> </table> </p> <p>30. Present Use: <table border="0"> <tr> <td>Residence</td> <td>[01A]</td> </tr> </table> </p> <p>31. Condition: <table border="0"> <tr> <td>Fair</td> <td>[F]</td> </tr> </table> </p> <p>32. Endangered: <table border="0"> <tr> <td>Yes</td> <td></td> </tr> <tr> <td>No</td> <td>XX</td> </tr> </table> </p> <p>33. Attach Photos: Roll: 2 Photo Nos: 5-12 No. of Slides: X </p>	Original Building	late 18th cent.	[9]	Addition		[]	Federal	[21]		[]	Hall-parlor	[HP]	Gable	Original			Not Original	XX	Stone	[S]	Stone	[S]		[]	Stone	[S]	Moved/Rebuilt	None	XX	Additions	Other			[0]	Residence	[01A]	Residence	[01A]	Fair	[F]	Yes		No	XX
Nat. Landmark _____	Local Landmark _____																																																																
Nat. Register _____	HABS/HAER _____																																																																
Highway Marker _____	KY Inventory 8/4/77																																																																
KY Landmark Certificate November 30, 1978																																																																	
District Name:	[]																																																																
Mult. Resource Area:	[]																																																																
Thematic Name:	Early Stone Buildings []																																																																
Primary: Architecture	[030]																																																																
Secondary: Settlement	[140]																																																																
Other:	[]																																																																
Original Building	late 18th cent.	[9]																																																															
Addition		[]																																																															
Federal	[21]																																																																
	[]																																																																
Hall-parlor	[HP]																																																																
Gable	Original																																																																
	Not Original	XX																																																															
Stone	[S]																																																																
Stone	[S]																																																																
	[]																																																																
Stone	[S]																																																																
Moved/Rebuilt	None	XX																																																															
Additions	Other																																																																
	[0]																																																																
Residence	[01A]																																																																
Residence	[01A]																																																																
Fair	[F]																																																																
Yes																																																																	
No	XX																																																																

14. History:

Built by Reverend John Tanner, first Baptist preacher in Kentucky, who founded Tanner's Station in 1789 (renamed Petersburg in 1814). Tanner was from Pennsylvania. He and John Taylor purchased the 2,000 acre military grant of John David Woolperts. Tanner's two sons were captured by Indian in 1790; one escaped and the other lived with Indians the remainder of his life.

Some local accounts state that a tannery once operated at the house, probably an error based on the Tanner name.

15. Source of historical information and/or contact person:

Collins, History of Kentucky. II
 Alice Jarrell, Petersburg Historian
 (586-5266)

34. Prepared by: Carolyn Murray-Wooley

35. Organization: Kentucky Heritage Council

36. Date: October 1983

37. New Survey _____ **Resurvey**

KENTUCKY HISTORIC RESOURCES
Individual Inventory Form

Resource # BE-54

38. UTM Point of Primary Building: Quadrant: Lawrenceburg	Zone <u>16</u>	Easting <u>684760</u>	Northing <u>4325960</u>	39. G.I.S. Mod. []	40. Coordi.Accuracy []
41. UTM Points of Boundary (for N. R. eligible sites only):					
A. ---				D. ---	
B. ---				E. ---	
C. ---				F. ---	
42. Total Acreage in Present Property:	43. Acreage included in proposed N.R. boundary: 1 1/2				
44. Site Plan (and boundary description and justification for N.R. sites):					

See Attached

45. Description and House Plan:

Two-story, three-bay, dry-stone, hall-parlor house, built end-wise into the hillside. Interior chimney on south end. Narrow mitered corner frames. Square sills, no voussoirs. Some repointing with concrete; original mortar flat. Off-center fenestration. First and second floor windows same size. Beaded-board door south end. Breakfront (at corners) mantel with reeded pilasters in hall. Beaded-board interior door.

Interior now partitioned into four rooms. Walls sheathed with new panelling. New concrete block smoke vent. Modern storm windows. Porch 1920s. Modern garage.

House located on hillside overlooking farmland and town of Petersburg at river.

KENTUCKY HISTORIC RESOURCE INVENTORY SUPPLEMENT
BOUNDARY AND LOCATION INFORMATION

Historic Property Name John Lanner house Site # Be-54
Multiple Resource/Thematic Nomination Title Early Stone Bldgs. of Ky.

U.T.M. Coordinates - List multiple UTM's if property is ten or more acres.

- A. 16 684760 4325960 D. _____
- B. _____ E. _____
- C. _____ F. _____

Verbal Boundary Description 1 1/2 acres

^{180 ft SE of corner of house}
Beginning at A, at the corner of the property at the road, ^{180 ft SE of corner of house} then W property line, SW to B at the road, NW to C, N to D at the road, E to E at the road, and SE with road to the beginning, containing about 1 1/2 acres.
A-B-C-D-E is the present property boundary. It is 360 ft along the road from B-D. The wooded hillside is part of the lot, which is bisected by the road, formerly the farm road.

1 contributing, 1 non contributing

Sketch of Site Plan (Showing outbuildings, structures, landscape features and the site boundary as described above.)

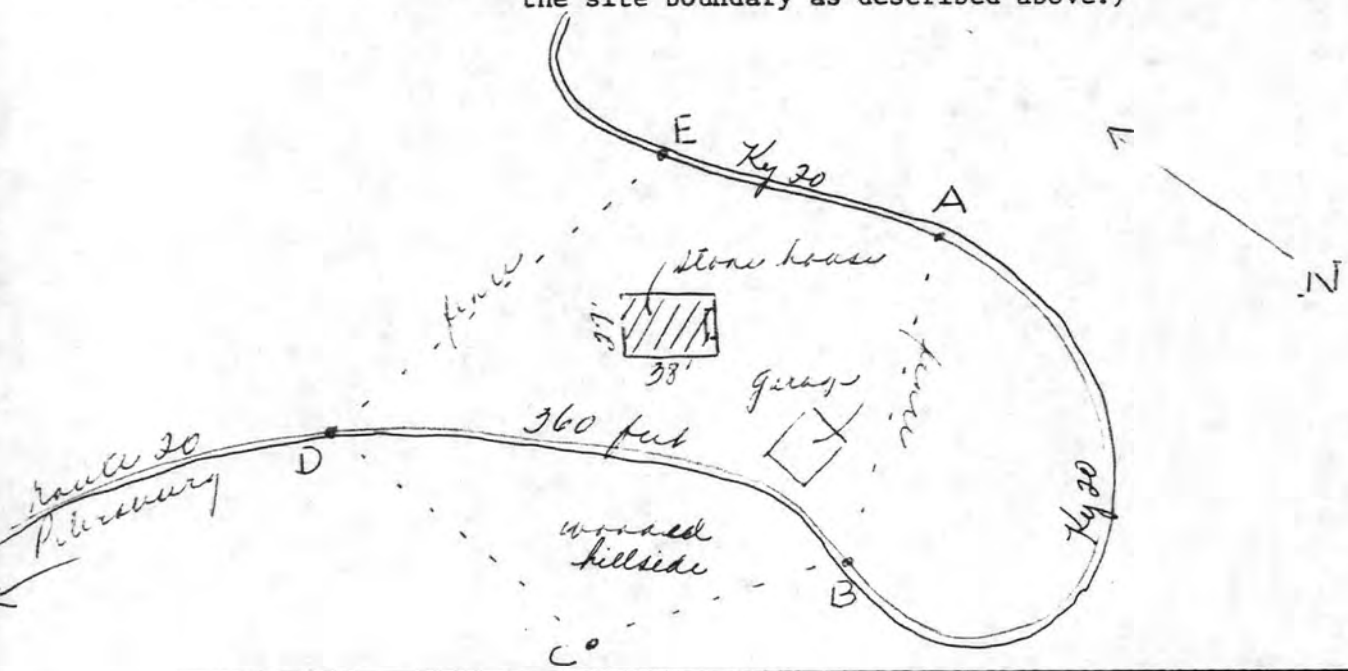

Official Courthouse Property Reference:

United States Department of the Interior
National Park Service

National Register of Historic Places
Inventory—Nomination Form

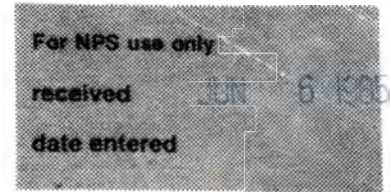

Continuation sheet

Item number

Page 1 of 7

Multiple Resource Area
Thematic Group

dnr-11

Name Early Stone Buildings of Kentucky Thematic Resources
State Barren County and others, KENTUCKY

COVER Umy Schlagel 1/8/87

Nomination/Type of Review

Date/Signature

- | | | | | |
|-----|-------------------------------|-------------------------------|--------|---------------------------|
| 1. | Bloody Bucket Tavern | Substantive Review | Keeper | _____ |
| | | | Attest | _____ |
| 2. | Stone House on Bracken Creek | Substantive Review | Keeper | <i>A. Schlagel 1/8/87</i> |
| | | | Attest | _____ |
| 3. | Stroube House | Substantive Review | Keeper | <i>A. Schlagel 1/8/87</i> |
| | | | Attest | _____ |
| 4. | Chalfant, Mordecai, House | Substantive Review | Keeper | <i>A. Schlagel 1/8/87</i> |
| | | | Attest | _____ |
| 5. | Rock Spring Warehouse | Substantive Review | Keeper | <i>A. Schlagel 1/8/87</i> |
| | | | Attest | _____ |
| 6. | Stone House on Garrison Creek | Substantive Review | Keeper | <i>A. Schlagel 1/8/87</i> |
| | | | Attest | _____ |
| 7. | Tanner, John, House | Substantive Review | Keeper | <i>A. Schlagel 1/8/87</i> |
| | | | Attest | _____ |
| 8. | Watts House | Substantive Review | Keeper | <i>A. Schlagel 1/8/87</i> |
| | | | Attest | _____ |
| 9. | Ogburn, Henry, House | Substantive Review | Keeper | <i>A. Schlagel 1/8/87</i> |
| | | | Attest | _____ |
| 10. | Stone House on Kentucky River | Substantive Review | Keeper | <i>A. Schlagel 1/8/87</i> |
| | | | Attest | _____ |

Determined Eligible

DOE/OWNER OBJECTION
~~Substantive Review~~

NATIONAL REGISTER OF HISTORIC PLACES
EVALUATION/RETURN SHEET

Tanner, John, House (Early Stone Buildings of Kentucky
--Outer Bluegrass and Pennyrile TR)
Boone County
KENTUCKY

Substantive Review

- resubmission
- nomination by person or local government
- owner objection
- appeal

Substantive Review: sample request appeal NR decision

Reviewer's comments:

*Case for C made - good
example of banked house -
as describ in cover*

Working No. 6/6/85
 Fed. Reg. Date: 2/2/88
 Date Due: 1/10/87
 Action: ACCEPT 1-8-87
 RETURN
 REJECT
 Federal Agency: _____

Recom./Criteria Accept C
 Reviewer A. Schaffel
 Discipline Ant. Hist.
 Date 1/7/87
 _____ see continuation sheet

Nomination returned for: _____ technical corrections cited below
_____ substantive reasons discussed below

1. Name

2. Location

3. Classification

Category	Ownership	Status	Present Use
	Public Acquisition	Accessible	

4. Owner of Property

5. Location of Legal Description

6. Representation in Existing Surveys

Has this property been determined eligible? yes no

7. Description

Condition		Check one	Check one
<input type="checkbox"/> excellent	<input type="checkbox"/> deteriorated	<input type="checkbox"/> unaltered	<input type="checkbox"/> original site
<input type="checkbox"/> good	<input type="checkbox"/> ruins	<input type="checkbox"/> altered	<input type="checkbox"/> moved date _____
<input type="checkbox"/> fair	<input type="checkbox"/> unexposed		

Describe the present and original (if known) physical appearance

- summary paragraph
- completeness
- clarity
- alterations/integrity
- dates
- boundary selection

8. Significance

Period _____ Areas of Significance—Check and justify below

Specific dates _____ Builder/Architect _____

Statement of Significance (in one paragraph)

- summary paragraph
- completeness
- clarity
- applicable criteria
- justification of areas checked
- relating significance to the resource
- context
- relationship of integrity to significance
- justification of exception
- other

9. Major Bibliographical References

10. Geographical Data

Acreage of nominated property _____

Quadrangle name _____

UTM References _____

Verbal boundary description and justification _____

11. Form Prepared By

12. State Historic Preservation Officer Certification

The evaluated significance of this property within the state is:

____ national ____ state ____ local

State Historic Preservation Officer signature _____

title _____ date _____

13. Other

- Maps
- Photographs
- Other

Questions concerning this nomination may be directed to _____

Signed _____ Date _____ Phone: _____







Please refer to the map in
Stone House on Garrison Creek
for this property

Reference Number: 87002614