

KENTUCKY HISTORIC RESOURCES INVENTORY

Site No. CP-109

1. Historic Name(s) <u>Peter, Barth, Farm (GS TR) ✓</u>		22. ADD/County <u>Campbell ✓</u> 019
Original Owner <u>Charles Zennick</u> <i>Alexandria vic.</i>		23. U.S.G.S. Quadrant (15'/75') <u>NEWPORT</u> G.I.S. Mod. 135
2. Present Name <u>Thomer Farm</u>		24. UTM Reference Zone <u>16</u> Easting <u>71216191710</u> Northing <u>4131210121410</u>
3. Location <u>Lower Tug Fork Road</u>		25. Coordinate Accuracy <input type="checkbox"/>
4. Owner's Name <u>Mr. Robert Thomer</u>		26. Prehistoric Site <input type="checkbox"/> Object Historic Site <input type="checkbox"/> Structure <u>Building</u> <input type="checkbox"/> Other
5. Owner's Address <u>12 Low Gap Road, Cold Spring, Kentucky</u>		27. National Register District Name: <u>GERMAN SETTLEMENT PROPERTIES</u> <u>FOUR MILE CREEK AREA</u>
6. Open to Public Yes <input type="checkbox"/> No <u>XX</u>	7. Visible from road Yes <u>XX</u> No <input type="checkbox"/>	28. Significance Evaluation D
8. Ownership Private <input type="checkbox"/> <u>XX</u> Local <input type="checkbox"/> State <input type="checkbox"/> Federal <input type="checkbox"/>		29. Status Date National Landmark <input type="checkbox"/> National Register <input type="checkbox"/> Landmark Certificate <input type="checkbox"/> Kentucky Survey <input type="checkbox"/> Local Landmark <input type="checkbox"/> HABS/HAER <input type="checkbox"/>
9. Local Contact/Organization <u>Campbell County Heritage League</u>		30. Historic Theme Primary <u>Ethnic History</u> C C Secondary <u>Architecture</u> C Other <u>Agriculture</u> A
10. Site Plan with North Arrow	11. Architect	31. Endangered Yes <input type="checkbox"/> No <u>XX</u>
	12. Builder	32. Preservation Project Status <input type="checkbox"/>
	13. Date <u>1826-1850</u> A. <u>3</u> B. <input type="checkbox"/>	Actual Cost in \$1,000s _ _ _ _ _ _ _
	14. Style A. <u>Vernacular</u> <input type="checkbox"/> <u>V</u> B. <input type="checkbox"/>	33. ATTACH PHOTO
	15. Original Use <u>Dwelling</u> <input type="checkbox"/> <u>A</u>	
	16. Present use <u>Dwelling</u>	
	17. Condition <input type="checkbox"/> <u>C</u>	
18. Description <u>Early to mid-nineteenth century farm complex comprised of log house, stone smokehouse, and stone storage building. Dwelling is a 1 1/2 story log and frame structure covered with board and batten siding. From the exterior the house appears to be either a saddlebag or double pen. The tenant told the surveyor that originally there were two rooms separated by a fireplace in the</u> <small>(Continue on Back)</small>	No. Stories <input type="checkbox"/> <u>B</u>	34. Prepared by: <u>Steve C. Gordon</u>
	Single Pile <u>XX</u> NA <input type="checkbox"/>	
	Double Pile <input type="checkbox"/>	
	Floor Plan <input type="checkbox"/> <u>C</u>	
Structural Fabric <u>Log</u> A. <input type="checkbox"/> <u>A</u> B. <input type="checkbox"/> <u>D</u>	Decorative Fabric <u>Board/Batten</u> A. <input type="checkbox"/> <u>K</u> B. <input type="checkbox"/>	35. Organization <u>Kentucky Heritage Council</u>
	Roof Form <u>Gable: Metal</u>	
	36. Date <u>October 25, 1982</u>	
19. History <u>In 1857 Peter Barth, a native of Wallertheim, Germany, purchased 77 acres of land along lower Tug Fork from Charles Zennick. Bath's father, Jacob Barth, was among the first Germans in the area, having settled Tug Fork in 1842. Peter Barth received his naturalization papers</u>	37. Revision Dates	38. Staff Review
20. Significance <u>Significant for its historical association with early German settlement in the Tug Fork/Four Mile Creek area. The Barths were one of the first German families to</u>		
21. Source of Information <u>Margaret Kopp Knable</u> <u>Campbell County Courthouse: Deed Book 28, Page 185;</u> <u>Book X, Page 431; Court Book 5, Page 249.</u>		

18. center. Log unit measures approximately 21' x 36'; an early frame addition with monitor type attic measures approximately 12' x 25'. Small two bay porch at front entrance, late nineteenth century porch at side (south) elevation. Other features include six-over-six sash, rubble limestone foundation, and small attic windows on south elevation. Eave beams and log sills are exposed. Side porch has adzed rafters. Stone wall circumscribes the hillside to the rear. Stone smokehouse, approximately 15' x 15', and six feet north of the house, has a shake hip roof and small openings. South of the house is a one story stone storage building with raised basement. It exhibits arched segmental lintels, 6/6 windows, and tooled cornerstones. Large limestone steps provide access to the raised first floor. There is a well between the storage building and the house. A worn flagstone walk is barely visible in the yard area. A large deteriorating barn far removed from the dwelling space is not included in this nomination.

19. at Alexandria in July, 1847. His first child, William Barth, was, depending on the source, born either in Cincinnati or Campbell County in 1856. Barth was one of many German farmers who regularly marketed his produce in Cincinnati. In 1866 a German farm laborer and young girl from Mecklenburg also lived with the Barths. His farm was valued at a relatively high \$4,000. Following Barth's death in 1907 the property was sold to Andrew Keppler. Peter Barth was Mrs. Knabel's great-grandfather.

20. settle Tug Fork. Jacob Barth's house, a log structure still standing nearby on Tug Fork Road, was not surveyed because of substantial structural alterations.

21. Eighth Census of the United States, 1860, Campbell County.



KENTUCKY HISTORIC RESOURCE INVENTORY SUPPLEMENT
BOUNDARY AND LOCATION INFORMATION

Historic Property Name Peter Barth Farm Site # CP-109

Multiple Resource/Thematic Nomination Title German Settlement Properties in Four-Mile Creek Area of Campbell County, Kentucky.

U.T.M. Coordinates - List multiple UTM's if property is ten or more acres.

A. 16 726970 4320240 D. _____

B. _____ E. _____

C. _____ F. _____

Verbal Boundary Description Acreage 1.35 acres

Beginning at a point on the east side of Lower Tug Fork Road, being approximately three-fourths of a mile south of St. John's Church Cemetery, proceed east 300', then proceed south 200' along the base of the hill, then proceed west 300' to the eastern edge of Lower Tug Fork Road, turning north and proceeding 200' to the point of origin. The boundaries include the log dwelling, stone smokehouse, and stone storage building. The deteriorating barn is not included.

Sketch of Site Plan (Showing outbuildings, structures, landscape features and the site boundary as described above.)

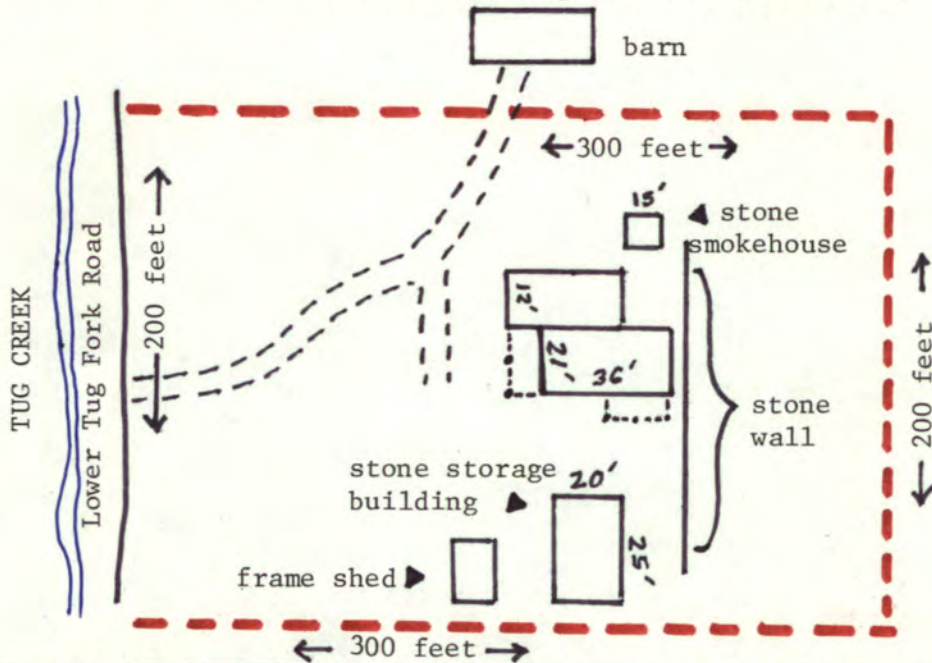

 NOT TO SCALE

Official Courthouse Property Reference:

County Book: Page 25, Parcel 68, Part of 75.5 acre tract.

United States Department of the Interior
National Park Service

National Register of Historic Places
Inventory—Nomination Form

For NPS use only
received
date entered

Continuation sheet

Item number

Page 1 of 3

Multiple Resource Area
Thematic Group

dnr-11

Name German Settlement, Four Mile Creek Area Thematic Resources
State Kentucky

Nomination/Type of Review

Date/Signature

- | | | | |
|---|-------------------------------------|--------|---|
| 1. Braun, John, House | Entered in the
National Register | Keeper | 3/9/83 <u>Delores Byers</u> |
| | | Attest | _____ |
| 2. Reitman House | Entered in the
National Register | Keeper | 3/9/83 <u>Delores Byers</u> |
| | | Attest | _____ |
| 3. Gubser-Schuchter Farm | Entered in the
National Register | Keeper | 3/9/83 <u>Delores Byers</u> |
| | | Attest | _____ |
| 4. Tiemeyer House | Entered in the
National Register | Keeper | 3/9/83 <u>Delores Byers</u> |
| | | Attest | _____ |
| 5. Heiert Farm | Entered in the
National Register | Keeper | 3/9/83 <u>Delores Byers</u> |
| | | Attest | _____ |
| 6. St. Joseph's Catholic Church
and Cemetery | Substantive Review | Keeper | <u>Linda M. Clelland 5/16/83</u>
<u>accept Patrick Andrews 5/16/83</u> |
| | | Attest | <u>accept Patrick Andrews 3/7/83</u> |
| 7. Barth, Peter, Farm | Entered in the
National Register | Keeper | 3/9/83 <u>Delores Byers</u> |
| | | Attest | _____ |
| 8. Uebel House | Entered in the
National Register | Keeper | 3/9/83 <u>Delores Byers</u> |
| | | Attest | _____ |
| 9. Leick House | Entered in the
National Register | Keeper | 3/9/83 <u>Delores Byers</u> |
| | | Attest | _____ |
| 10. Blenke House | National Register | Keeper | 3/9/83 <u>Delores Byers</u> |
| | | Attest | _____ |

United States Department of the Interior
National Park Service

Barth, Peter, Farm (German Settlement, Four
Mile Creek Area TR)
Campbell County
KENTUCKY

Working No. JAN 21 1983

Fed. Reg. Date: 2.7.84

Date Due: 2/24/83 - 3/10/83

Action: ACCEPT 3/9/83

Entered in the RETURN

National Register REJECT

Federal Agency: _____

- resubmission
- nomination by person or local government
- owner objection
- appeal

Substantive Review: sample request appeal NR decision

Reviewer's comments:

Recom./Criteria _____

Reviewer _____

Discipline _____

Date _____

see continuation sheet

Nomination returned for: technical corrections cited below
 substantive reasons discussed below

1. Name

2. Location

3. Classification

Category	Ownership	Status	Present Use
	Public Acquisition	Accessible	

4. Owner of Property

5. Location of Legal Description

6. Representation in Existing Surveys

has this property been determined eligible? yes no

7. Description

Condition		Check one	Check one
<input type="checkbox"/> excellent	<input type="checkbox"/> deteriorated	<input type="checkbox"/> unentered	<input type="checkbox"/> original site
<input type="checkbox"/> good	<input type="checkbox"/> ruins	<input type="checkbox"/> altered	<input type="checkbox"/> moved date _____
<input type="checkbox"/> fair	<input type="checkbox"/> unexposed		

Describe the present and original (if known) physical appearance

- summary paragraph
- completeness
- clarity
- alterations/integrity
- dates

8. Significance

Period _____ Areas of Significance—Check and justify below

Specific dates _____ Builder/Architect _____

Statement of Significance (in one paragraph)

- summary paragraph
- completeness
- clarity
- applicable criteria
- justification of areas checked
- relating significance to the resource
- context
- relationship of integrity to significance
- justification of exception
- other

9. Major Bibliographical References

10. Geographical Data

Address of nominated property _____

Quadrangle name _____

USIT Reference _____

Verbal boundary description and justification _____

11. Form Prepared By

12. State Historic Preservation Officer Certification

The evaluated significance of this property within the state is

____ national _____ state _____ local

State Historic Preservation Officer signature _____

Title _____ date _____

13. Other

- Maps
- Photographs
- Other

Questions concerning this nomination may be directed to _____

Signed _____ Date _____ Phone: 202 272-3500

Comments for any item may be continued on an attached sheet









Please refer to the map in the
Multiple Property Cover Sheet
for this property

Multiple Property Cover Sheet Reference Number: 64000220