

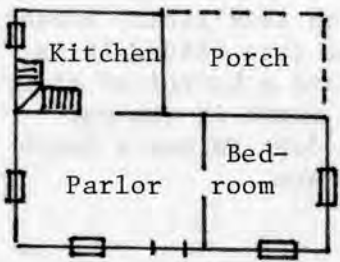

KENTUCKY HISTORIC RESOURCES INVENTORY

Site No. CP-80

1. Historic Name(s) <u>Frederich Kremer House (95 Tr)</u>		22. ADD/County <u>Campbell</u> <input checked="" type="checkbox"/>	<input type="text" value="0"/> <input type="text" value="1"/> <input type="text" value="9"/>
Original Owner <u>Kremer Brothers</u> <i>Alexandria Va.</i>		23. U.S.G.S. Quadrant (15'/75') <u>New Richmond</u>	G.I.S. Mod. <input type="text" value="1"/> <input type="text" value="3"/> <input type="text" value="6"/>
2. Present Name <u>Stony Vista</u>		24. UTM Reference <input type="text" value="1"/> <input type="text" value="6"/> <input type="text" value="7"/> <input type="text" value="2"/> <input type="text" value="7"/> <input type="text" value="4"/> <input type="text" value="9"/> <input type="text" value="0"/> <input type="text" value="4"/> <input type="text" value="3"/> <input type="text" value="1"/> <input type="text" value="7"/> <input type="text" value="9"/> <input type="text" value="6"/> <input type="text" value="0"/>	
3. Location <u>317 Poplar Ridge Road</u>		Zone Easting Northing	
4. Owner's Name <u>Roy and Jean Neiser</u>		25. Coordinate Accuracy <input type="checkbox"/>	
5. Owner's Address <u>317 Poplar Ridge Road, Alexandria</u>		26. Prehistoric Site Object <input checked="" type="checkbox"/> Historic Site Structure <input checked="" type="checkbox"/> Building Other	
6. Open to Public Yes <input type="checkbox"/> No <input checked="" type="checkbox"/>	7. Visible from road Yes <input checked="" type="checkbox"/> No <input type="checkbox"/>	8. Ownership <input checked="" type="checkbox"/> Private <input type="checkbox"/> Local <input type="checkbox"/> State <input type="checkbox"/> Federal	
9. Local Contact/Organization <u>Campbell County Heritage League</u>		27. National Register District Name: <u>German Settlement Properties</u> <u>Four Mile Creek Area</u>	
10. Site Plan with North Arrow		28. Significance Evaluation <u>National Register</u> <input type="checkbox"/> <u>D</u>	
 <p>Original floor plan</p>		11. Architect	
		12. Builder <u>Unknown</u>	
		13. Date <u>c. 1870-1875</u> A. <input type="text" value="4"/> B. <input type="checkbox"/>	
		14. Style A. Vernacular <input checked="" type="checkbox"/> V B. <input type="checkbox"/>	
		15. Original Use <u>Farmhouse</u> <input type="checkbox"/> A	
		16. Present use <u>Dwelling</u>	
		17. Condition <u>Good</u> <input type="checkbox"/> B	
18. Description Sited on high hill that has a commanding view of the Tug Fork and Four Mile Creek valleys. One and one-half story rubble limestone dwelling with stone ell addition. Symmetrical three bay fenestration characterized by center entrance and small attic windows on the upper story. Larger window and door bays have the characteristic segmental stone lintels, the attic bays <small>(Continue on Back)</small>		29. Status <input type="checkbox"/> National Landmark <input type="checkbox"/> National Register <input type="checkbox"/> Landmark Certificate <input checked="" type="checkbox"/> Kentucky Survey <u>May 16, 1979</u> <input type="checkbox"/> Local Landmark <input type="checkbox"/> HABS/HAER	
19. History On 29 May 1871, three brothers, Mathias, Nicholas, and Frederich Kremer purchased a 95 acre tract on Poplar Ridge from Mr. Crigler. Nicholas and Mathias had built houses on Four and Twelve Mile Road (CP-50, CP-55). On 12 March 1874 the Poplar Ridge property was divided		30. Historic Theme Primary <u>Architecture</u> <input type="checkbox"/> C Secondary <u>Ethnic History</u> <input type="checkbox"/> C <input type="checkbox"/> C Other <u>Agriculture</u> <input type="checkbox"/> A	
20. Significance <u>Significant as an example of vernacular stone architecture and for its historical association with German settlement in the Four Mile Creek area.</u>		31. Endangered Yes <input type="checkbox"/> No <input checked="" type="checkbox"/> XX	
21. Source of Information <u>Margaret Knable</u> <u>Brochure on Stony Vista</u> <u>Tenth Census of the United States; 1880, Campbell County.</u>		32. Preservation Project Status <input type="checkbox"/> Actual Cost in \$1,000s <input type="text"/>	
		33. ATTACH PHOTO	
			
		Roll No. <u>25/26</u> Picture No. <u>21-26/19-20</u> Direction _____	
		34. Prepared by: <u>Carolyn M. Torma</u> <u>Edward Chappell</u>	
		35. Organization <u>Kentucky Heritage Council</u>	
		36. Date <u>May 16, 1979</u>	
		37. Revision Dates <u>10/82</u> <u>S. Gordon</u>	
		38. Staff Review	

- 18. have flat wood lintels. The 1 1/2 story, single room stone ell appears to be an early addition. At the time it was added the inside stairs were moved from the front parlor to the kitchen. The house has 18" stone walls and the joists supporting the first floor are hewn. There are no fireplaces, chimney flues are along side of the end windows.

Immediately behind the ell is a rectangular stone fruit cellar and storage building. The bank barn is structurally unchanged, but the original stone smokehouse was torn down for the kitchen expansion which filled in the corner of the ell.



- 19. among the three brothers, Frederich acquiring 31 acres on this site. Frederich was a native of Prussia and had come to Four Mile in the late 1840s. It is said the man who did the masonry work on the barn was paid a barrel of cider for his efforts. The property remained in the Kremer family until it was purchased by John and Anna Neiser in February, 1919. Upon John Neiser's death in 1955, his nephew Roy Neiser, acquired the house and farm.

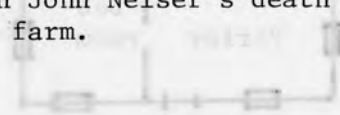

KENTUCKY HISTORIC RESOURCE INVENTORY SUPPLEMENT
BOUNDARY AND LOCATION INFORMATION

Historic Property Name Frederick Kremer House Site # CP-80

Multiple Resource/Thematic Nomination Title German Settlement Properties
Four Mile Creek Area

U.T.M. Coordinates - List multiple UTMs if property is ten or more acres.

A. _____ D. _____

B. _____ E. _____

C. _____ F. _____

Verbal Boundary Description Acres 1.6 acres

Beginning at a point on the east side of Poplar Ridge Road, which is approximately 1500' south of Upper Tug Fork Road, proceed northeast 400' along fencerow, then proceed south 200' along hillside behind barn, then proceed southwest 300' until reaching Poplar Ridge Road, then proceed northwest 200' along the east side of said road to the point of origin. Boundaries include stone house, bank barn, and dependencies.

Sketch of Site Plan (Showing outbuildings, structures, landscape features and the site boundary as described above.)

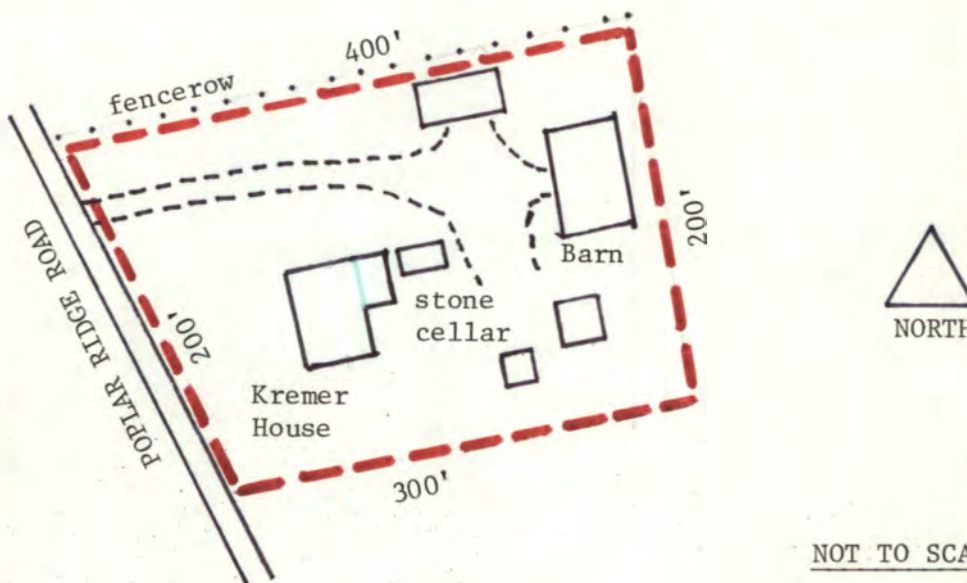

Official Courthouse Property Reference:

County Book: Page 25, Parcel 166. Part of 31.24 acre tract.

United States Department of the Interior
National Park Service

National Register of Historic Places
Inventory—Nomination Form

For NPS use only
received
date entered

Continuation sheet

Item number

Page 2 of 3

Multiple Resource Area
Thematic Group

Name German Settlement, Four Mile Creek Area Thematic Resources
State Kentucky

Nomination/Type of Review

Date/Signature

11. Roth Farm

Entered in the
National Register

Keeper

3/9/83 Melvyn Byers

Attest

12. Baumann House

Entered in the
National Register

Keeper

3/9/83 Melvyn Byers

Attest

13. Ort-Heeb Farm

Entered in the
National Register

Keeper

3/9/83 Melvyn Byers

Attest

14. Faha, John, House

Entered in the
National Register

Keeper

3/9/83 Melvyn Byers

Attest

15. St. John's Lutheran Cemetery

Entered in the
National Register

Keeper

3/9/83 Melvyn Byers

Attest

16. Kremer, Matthias, House

Substantive Review

Keeper

Linda M. Clelland 3/9/83

Attest

accept Patrick Andrews 3/7/83

17. Trutschell House (DeMoss House)

Substantive Review

Keeper

Determined Eligible

Linda M. Clelland 3/9/83

DOE/OWNER OBJECTION

Attest

Eligible Patrick Andrews 3/7/83

18. Reitman's St. Joseph House

Entered in the
National Register

Keeper

3/9/83 Melvyn Byers

Attest

19. Camp Spring House

Entered in the
National Register

Keeper

3/9/83 Melvyn Byers

Attest

20. Kremer, Frederick, House

Entered in the
National Register

Keeper

3/9/83 Melvyn Byers

Attest

United States Department of the Interior
National Park Service

Kremer, Frederick, House (German Settlement,
Four Mile Creek Area TR)
Campbell County
KENTUCKY

Working No. JAN 24 1983

Fed. Reg. Date: 2.7.84

Date Due: 2/24/83 - 3/10/83

Action: ACCEPT 3/9/83

Entered in the RETURN

National Register REJECT

Federal Agency: _____

- resubmission
- nomination by person or local government
- owner objection
- appeal

Substantive Review: sample request appeal NR decision

Reviewer's comments:

Recom./Criteria _____

Reviewer _____

Discipline _____

Date _____

see continuation sheet

Nomination returned for: technical corrections cited below
 substantive reasons discussed below

1. Name

2. Location

3. Classification

Category	Ownership	Status	Present Use
	Public Acquisition	Accessible	

4. Owner of Property

5. Location of Legal Description

6. Representation in Existing Surveys

has this property been determined eligible? yes no

7. Description

Condition		Check one	Check one
<input type="checkbox"/> excellent	<input type="checkbox"/> deteriorated	<input type="checkbox"/> unaltered	<input type="checkbox"/> original site
<input type="checkbox"/> good	<input type="checkbox"/> ruins	<input type="checkbox"/> altered	<input type="checkbox"/> moved date _____
<input type="checkbox"/> fair	<input type="checkbox"/> unexposed		

Describe the present and original (if known) physical appearance

- summary paragraph
- completeness
- clarity
- alterations/integrity
- dates

8. Significance

Period _____ Areas of Significance—Check and justify below

Specific dates _____ Builder/Architect _____

Statement of Significance (in one paragraph)

- _____ summary paragraph
- _____ completeness
- _____ clarity
- _____ applicable criteria
- _____ justification of areas checked
- _____ relating significance to the resource
- _____ context
- _____ relationship of integrity to significance
- _____ justification of exception
- _____ other

9. Major Bibliographical References

10. Geographical Data

Average of nominated property _____

Quadrangle name _____

USGS References _____

Verbal boundary description and justification _____

11. Form Prepared By

12. State Historic Preservation Officer Certification

The evaluated significance of this property within the state is

_____ national _____ state _____ local

State Historic Preservation Officer signature _____

Title _____ date _____

13. Other

- _____ Maps
- _____ Photographs
- _____ Other

Questions concerning this nomination may be directed to _____

Signed _____ Date _____ Phone: 202 272-3500

Comments for any item may be continued on an attached sheet







Please refer to the map in the
Multiple Property Cover Sheet
for this property

Multiple Property Cover Sheet Reference Number: 64000220