

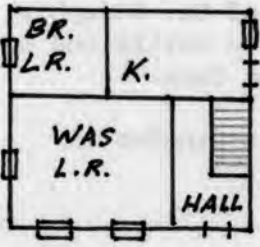

KENTUCKY HISTORIC RESOURCES INVENTORY

Site No. CP-51

1. Historic Name(s) <u>Ort-Heeb Farm (OS FMCATR)</u>		22. ADD/County <u>Campbell</u> <i>alex. v.c.</i>	
Original Owner <u>Joseph Ort</u>		23. U.S.G.S. Quadrant (15'/75') <u>New Richmond</u>	
2. Present Name <u>Sandfos Farm</u>		24. UTM Reference <u>16</u> <u>7128101810</u> <u>413117161610</u> Zone Easting Northing	
3. Location <u>Four Mile Pike</u>		25. Coordinate Accuracy	
4. Owner's Name <u>Mrs. Louise Sandfos</u>		26. Prehistoric Site Historic Site <input checked="" type="checkbox"/> Building	
5. Owner's Address <u>Box 195, Melbourne, Kentucky</u>		Object Structure Other	
6. Open to Public Yes <input type="checkbox"/> No <input checked="" type="checkbox"/> <u>XX</u>		7. Visible from road Yes <input checked="" type="checkbox"/> No <input type="checkbox"/>	
8. Ownership Private <input checked="" type="checkbox"/> <u>X</u> Local <input type="checkbox"/> State <input type="checkbox"/> Federal <input type="checkbox"/>		27. National Register District Name: <u>GERMAN SETTLEMENT PROPERTIES</u> <u>FOUR MILE CREEK AREA</u>	
9. Local Contact/Organization <u>Campbell County Heritage League</u>		28. Significance Evaluation	
10. Site Plan with North Arrow 		11. Architect 12. Builder <u>Joseph Ort</u> 13. Date <u>c. 1885</u> A. <input checked="" type="checkbox"/> <u>5</u> B. <input type="checkbox"/> 14. Style A. Vernacular <input checked="" type="checkbox"/> <u>V</u> B. <input type="checkbox"/> 15. Original Use <u>Farm Complex</u> <input checked="" type="checkbox"/> <u>A</u> 16. Present use <u>Farm Complex</u> 17. Condition	
18. Description Significant farm complex located on a hillside that faces Four Mile Creek. Primary building is a two-story, three-bay side passage stone dwelling. This particular floor plan and rough ashlar wall treatment on the front elevation are atypical to the type of German built stone houses in the Four Mile Creek area. Yet the side and rear elevations still employ the (Continue on Back)		29. Status National Landmark <input type="checkbox"/> National Register <input type="checkbox"/> Landmark Certificate <input checked="" type="checkbox"/> <u>8/18/80</u> Kentucky Survey <input checked="" type="checkbox"/> <u>5/9/79</u> Local Landmark <input type="checkbox"/> HABS/HAER <input type="checkbox"/> Date	
No. Stories <input checked="" type="checkbox"/> <u>C</u>		30. Historic Theme Primary <u>Architecture</u> <input checked="" type="checkbox"/> <u>C</u> Secondary <u>Ethnic Settlement</u> <input checked="" type="checkbox"/> <u>C</u> <input checked="" type="checkbox"/> <u>C</u> Other <u>agriculture</u> <input checked="" type="checkbox"/> <u>A</u>	
Single Pile <input type="checkbox"/> NA <input type="checkbox"/> Double Pile <input checked="" type="checkbox"/> <u>XX</u> Floor Plan <input checked="" type="checkbox"/> <u>L</u>		31. Endangered Yes <input type="checkbox"/> No <input checked="" type="checkbox"/> <u>XX</u>	
Structural Fabric A. <input checked="" type="checkbox"/> <u>B</u> B. <input type="checkbox"/> Decorative Fabric A. <input checked="" type="checkbox"/> <u>H</u> B. <input type="checkbox"/> Roof Form <u>Gable End:</u>		32. Preservation Project Status Actual Cost in \$1,000s	
19. History According to the present owner, this house was built by Joseph Ort circa 1885. Ort, born in Camp Springs in 1850, is listed in the 1850, 1860, and 1880 census. His father, listed as both George and Joseph Ort, Senior, was born in Prussia in 1822 and moved to		33. ATTACH PHOTO 	
20. Significance Important embodiment of traditional German stone vernacular architecture in the Four Mile Creek area. With its coursed ashlar facade and side passage plan		Roll No. <u>17</u> Picture No. <u>10-35</u> Direction	
21. Source of Information <u>Mrs. Louis Sandfos</u> <u>Margaret Kopp Knable</u> <u>Seventh, Eighth, and Tenth U.S. Census; 1880, Campbell County.</u>		34. Prepared by: <u>Carolyn M. Torma</u> <u>Steve C. Gordon</u>	
35. Organization <u>Kentucky Heritage Council</u>		36. Date <u>May 9, 1979</u>	
37. Revision Dates <u>10/30/82</u>		38. Staff Review	

18. rubble limestone wall surfaces. The dominant stylistic feature is the use of segmental arch lintels on all window and door bays. The majority of windows are two-over-two. This double pile house also features small attic vents and a bracketed cornice. Roof supported by roughly cut common rafters that rest directly on the joints. Rafters supported by short posts with purlin at left front only.

Various outbuildings and sheds on this property, including a bank barn (32' x 34') and stone bank-type springhouse and meathouse (9 1/2' x 12'). Present owner built the concrete walls, bridge and folk art like alligator in relief.

19. Campbell County prior to 1850. Joseph Ort was listed as a farmer in the 1880 census. During the 1880s he built this stone dwelling for himself with Peter Ensweiler assisting with the carpentry. Ensweiler's father is reputed to have built the stone outbuildings. In 1909 John Heeb purchased the farm; he was also a native of the Four Mile Creek area and member of St. Joseph's Church. Heeb's parents were born in Switzerland. In addition to cattle and hogs, the Heeb's raised grapes, turnips, cabbage, and potatoes on the farm.

Vinegar and cider were stored in the cellar. Mrs. Louise Heeb Sandfos is John Heeb's daughter.

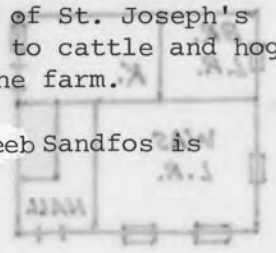

20. the house represents a slight departure from the more typical stone buildings.



According to the present owner, this house was built by Joseph Ort circa 1880. Ort, born in Camp Springs in 1820, is listed in the 1850, 1860, and 1880 censuses. His father, listed as both George and Joseph Ort, Senior, was born in Prussia in 1813 and moved to

Important embodiment of traditional mountain stone vernacular architecture in the Four Mile Creek area. With its coursed ashlar facade and side entrance

Mrs. Louise Sandfos
Severn, Elisha, and Tenth U.S. Census (1850, 1860, 1880)
County

KENTUCKY HISTORIC RESOURCE INVENTORY SUPPLEMENT
BOUNDARY AND LOCATION INFORMATION

Historic Property Name Ort-Heeb Farm Site # CP-51
 Multiple Resource/Thematic Nomination Title German Settlement Properties
Four Mile Creek Area

U.T.M. Coordinates - List multiple UTMs if property is ten or more acres.

A. 16 728080 4317660 D. _____
 B. _____ E. _____
 C. _____ F. _____

Verbal Boundary Description Acreage 2.7 acres

Beginning at a point 800' west of the intersection of gravel driveway and Four Mile Road, proceed south 300' along base of small knoll, then west 400', then north 300' along rear side of smokehouse, then east 400' until the point of origin. Boundaries include main house, bank barn, sheds, and stone smokehouse.

Sketch of Site Plan (Showing outbuildings, structures, landscape features and the site boundary as described above.)

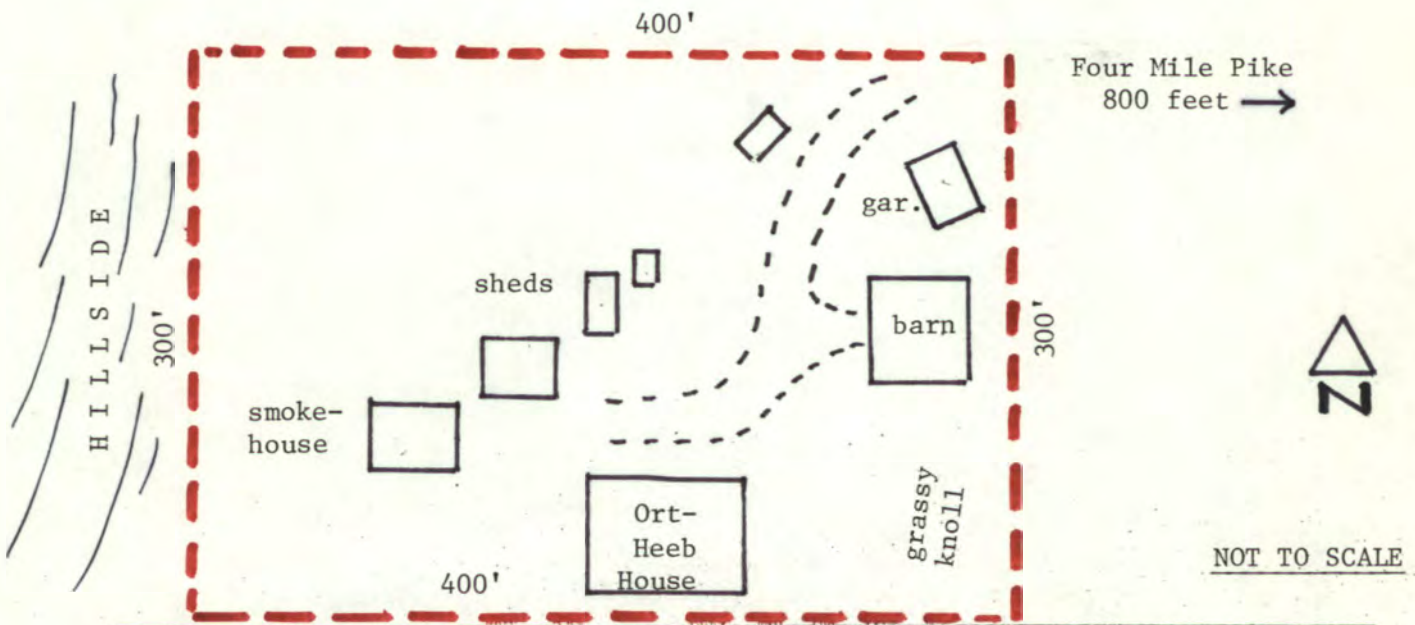

Official Courthouse Property Reference:

County Book, Page 25, Parcel 30. Part of 19 acre tract.

Cp. 51
 Ort. Heels house
 & Farm
 → N
 Scale 1sq = 2 feet



garden

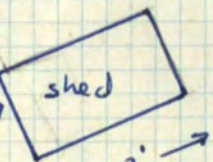
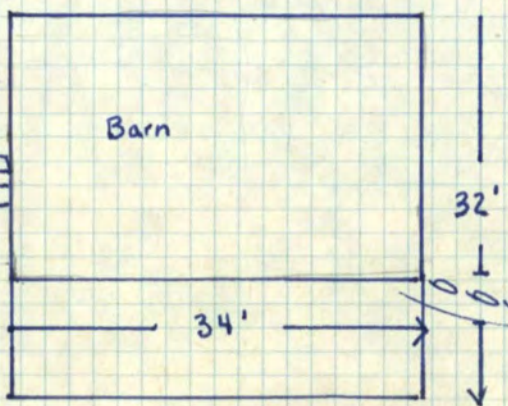
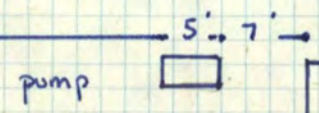
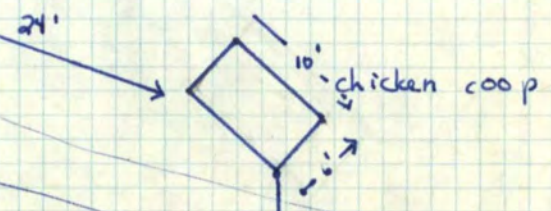
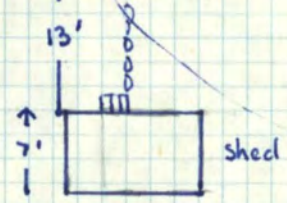
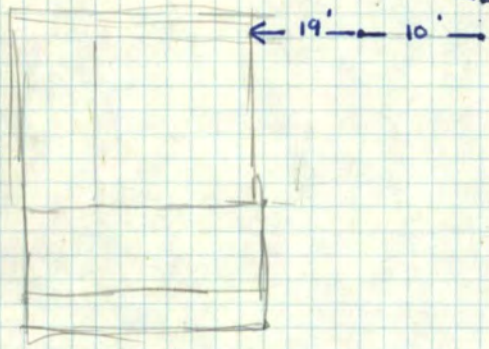
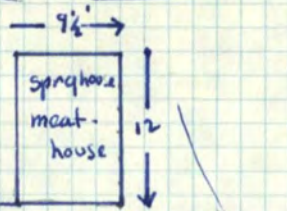

12/16/20

United States Department of the Interior
National Park Service

National Register of Historic Places
Inventory—Nomination Form

For NPS use only	
received	
date entered	

Continuation sheet

Item number

Page 2 of 3

Multiple Resource Area
Thematic Group

Name German Settlement, Four Mile Creek Area Thematic Resources
State Kentucky

Nomination/Type of Review

Date/Signature

11. Roth Farm

Entered in the
National Register

Keeper

3/9/83 Melrose Byers

Attest

12. Baumann House

Entered in the
National Register

Keeper

3/9/83 Melrose Byers

Attest

13. Ort-Heeb Farm

Entered in the
National Register

Keeper

3/9/83 Melrose Byers

Attest

14. Faha, John, House

Entered in the
National Register

Keeper

3/9/83 Melrose Byers

Attest

15. St. John's Lutheran Cemetery

Entered in the
National Register

Keeper

3/9/83 Melrose Byers

Attest

16. Kremer, Matthias, House

Substantive Review

Keeper

Linda McClelland 3/9/83

Attest

accept Patrick Andrews 3/7/83

17. Trutschell House (DeMoss House)

Substantive Review

Keeper

Determined Eligible

Linda McClelland 3/9/83

DOE/OWNER OBJECTION

Attest

Eligible Patrick Andrews 3/7/83

18. Reitman's St. Joseph House

Entered in the
National Register

Keeper

3/9/83 Melrose Byers

Attest

19. Camp Spring House

Entered in the
National Register

Keeper

3/9/83 Melrose Byers

Attest

20. Kremer, Frederick, House

Entered in the
National Register

Keeper

3/9/83 Melrose Byers

Attest

United States Department of the Interior
National Park Service

Ort-Heeb Farm (German Settlement, Four Mile
Creek Area TR)
Campbell County
KENTUCKY

Working No. JAN 24 1983

Fed. Reg. Date: 2.7.84

Date Due: 2/24/83 - 3/10/83

Action: ACCEPT 3/9/83

Entered in the RETURN
National Register REJECT

Federal Agency: _____

- resubmission
- nomination by person or local government
- owner objection
- appeal

Substantive Review: sample request appeal NR decision

Reviewer's comments:

Recom./Criteria _____

Reviewer _____

Discipline _____

Date _____

see continuation sheet

Nomination returned for: technical corrections cited below
 substantive reasons discussed below

1. Name

2. Location

3. Classification

Category	Ownership	Status	Present Use
	Public Acquisition	Accessible	

4. Owner of Property

5. Location of Legal Description

6. Representation in Existing Surveys

has this property been determined eligible? yes no

7. Description

Condition		Check one	Check one
<input type="checkbox"/> excellent	<input type="checkbox"/> deteriorated	<input type="checkbox"/> unaltered	<input type="checkbox"/> original site
<input type="checkbox"/> good	<input type="checkbox"/> ruins	<input type="checkbox"/> altered	<input type="checkbox"/> moved date _____
<input type="checkbox"/> fair	<input type="checkbox"/> unexposed		

Describe the present and original (if known) physical appearance

- summary paragraph
- completeness
- clarity
- alterations/integrity
- dates

8. Significance

Period _____ Areas of Significance—Check and justify below

Specific dates _____ Builder/Architect _____

Statement of Significance (in one paragraph)

- _____ summary paragraph
- _____ completeness
- _____ clarity
- _____ applicable criteria
- _____ justification of areas checked
- _____ relating significance to the resource
- _____ context
- _____ relationship of integrity to significance
- _____ justification of exception
- _____ other

9. Major Bibliographical References

10. Geographical Data

Address of nominated property _____

Quadrangle name _____

USRT References _____

Verbal boundary description and justification _____

11. Form Prepared By

12. State Historic Preservation Officer Certification

The evaluated significance of this property within the state is

_____ national _____ state _____ local

State Historic Preservation Officer signature _____

Title _____ date _____

13. Other

- _____ Maps
- _____ Photographs
- _____ Other

Questions concerning this nomination may be directed to _____

Signed _____ Date _____ Phone: 202 272-3504

Comments for any item may be continued on an attached sheet







Please refer to the map in the
Multiple Property Cover Sheet
for this property

Multiple Property Cover Sheet Reference Number: 64000220