

KENTUCKY HISTORIC RESOURCE INVENTORY SUPPLEMENT
BOUNDARY AND LOCATION INFORMATION

Historic Property Name Milton Masonic Lodge Site # Tm-M-12

Multiple Resource/Thematic Nomination Title Historic Resources of Trimble County

U.T.M. Coordinates - List multiple UTMs if property is ten or more acres.

A. 16 641780 4287220 D. _____

B. _____ E. _____

C. _____ F. _____

Verbal Boundary Description _____ Acreage .5

Beginning at the intersection of Main Street and State Highway 36 proceed 100' in an eastward direction along St. Highway 36; thence 100' in a southward direction; thence 100' in a westward direction; thence 100' in a northward direction to the point of origin.

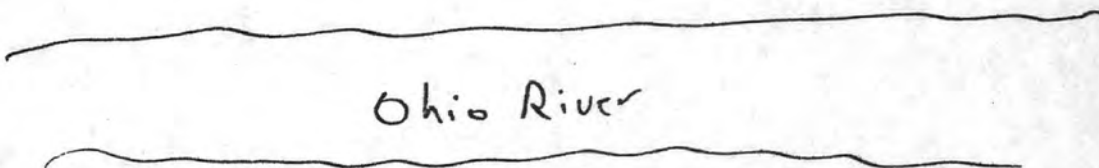

Sketch of Site Plan (Showing outbuildings, structures, landscape features and the site boundary as described above.)

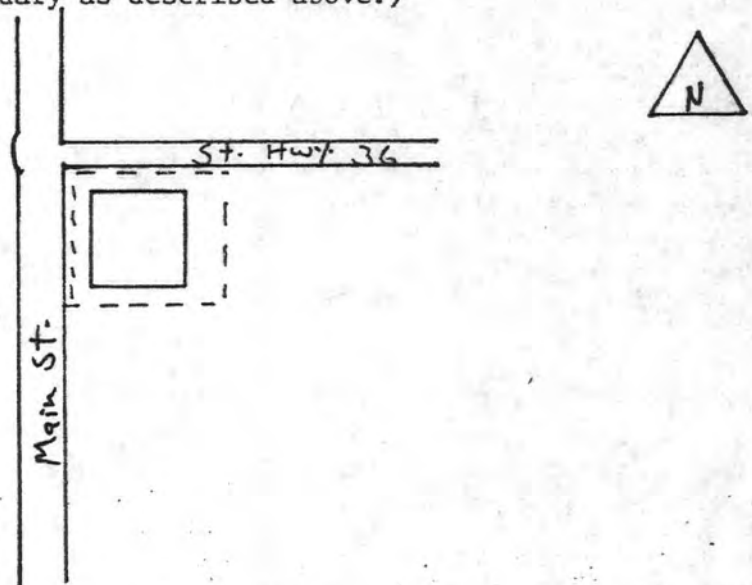

Not to scale

Official Courthouse Property Reference:

United States Department of the Interior
National Park Service

National Register of Historic Places
Inventory—Nomination Form

For NPS use only
received 6/14/83
date entered

Continuation sheet

Item number

Page 3-24

Multiple Resource Area
Thematic Group

Name Trimble County Multiple Resource Area

State Kentucky

Nomination/Type of Review

Date/Signature

21. Milton Masonic Lodge
and County General Store

Substantive Review

for

Keeper

accept Patrick Andrews 7/21/83

Attest

22. Neal House

Substantive Review

Keeper

Lynn Doherty 4/9/84

Attest

23. Old Kentucky Tavern

Substantive Review

for

Keeper

accept Patrick Andrews 7/21/83

Attest

24. Page-Bell House

Substantive Review

for

Keeper

accept Patrick Andrews 7/21/83

Attest

25. Page House

Substantive Review

Keeper

Lynn Doherty 4/10/84

Attest

26. Peak House

Substantive Review

Keeper

Lynn Doherty 4/9/84

Attest

27. Preston House

Substantive Review

for

Keeper

accept Patrick Andrews 7/21/83

Attest

28. River View

Substantive Review

Keeper

Return CD 4/10/84

Attest

29. Rowlett's Grocery

Substantive Review

for

Keeper

accept Patrick Andrews 7/21/83

Attest

30. Rowlett House

Substantive Review

Keeper

Lynn Doherty 4/9/84

Attest

United States Department of the Interior
National Park Service

Substantive Review

Milton Masonic Lodge and County General Store
(Trimble County MRA)
Trimble County
KENTUCKY

Working No. JUN 14 1983
Fed. Reg. Date: 2.7.84
Date Due: 7/14/83 - 7/29/83
Action: ACCEPT 7/21/83
 RETURN
 REJECT

- resubmission
- nomination by person or local government
- owner objection
- appeal

Federal Agency: _____

Substantive Review: sample request appeal NR decision

Reviewer's comments:

main cover form explains rarity & significance of historic commercial architecture in the MRA

Recom./Criteria accept Acc
Reviewer Patrick Andrews
Discipline Historian
Date 7/21/83
see continuation sheet

Nomination returned for: technical corrections cited below
 substantive reasons discussed below

1. Name

2. Location

3. Classification

Category	Ownership	Status	Present Use
	Public Acquisition	Accessible	

4. Owner of Property

5. Location of Legal Description

6. Representation in Existing Surveys

has this property been determined eligible? yes no

7. Description

Condition		Check one	Check one
<input type="checkbox"/> excellent	<input type="checkbox"/> deteriorated	<input type="checkbox"/> unaltered	<input type="checkbox"/> original site
<input type="checkbox"/> good	<input type="checkbox"/> ruins	<input type="checkbox"/> altered	<input type="checkbox"/> moved date _____
<input type="checkbox"/> fair	<input type="checkbox"/> unexposed		

Describe the present and original (if known) physical appearance

- summary paragraph
- completeness
- clarity
- alterations/integrity
- dates
- boundary selection

8. Significance

Period _____ Area of Significance—Check and justify below _____

Specific dates _____ Builder/Architect _____

Statement of Significance (in one paragraph)

- _____ summary paragraph
_____ completeness
_____ clarity
_____ applicable criteria
_____ justification of areas checked
_____ relating significance to the resource
_____ context
_____ relationship of integrity to significance
_____ justification of exception
_____ other

9. Major Bibliographical References

10. Geographical Data

Acres of nominated property _____

Quadrangle name _____

UMT References _____

Verbal boundary description and justification _____

11. Form Prepared By

12. State Historic Preservation Officer Certification

The evaluated significance of this property within the state is:

_____ national _____ state _____ local

State Historic Preservation Officer signature _____

Title _____ date _____

13. Other

- _____ Maps
_____ Photographs
_____ Other

Questions concerning this nomination may be directed to _____

Signed _____ Date _____ Phone: 202 272-3504

Comments for any item may be continued on an attached sheet



WORTH LINDSEY BROS.
FARM & HOME
ALTER REVISION

PEPSI
Country GENERAL STORE

Coca-Cola
Country General Store

ICE

Coke
PEPSI
Marlboro
CIGARETTES



Please refer to the map in the
Multiple Property Cover Sheet
for this property

Multiple Property Cover Sheet Reference Number: 64000257