



1004.)

Post Office Department,

OFFICE OF THE FIRST ASSISTANT P. M. GENERAL,

WASHINGTON, D. C., 16 Jan, 1884.

Sir: Before the Postmaster General decides upon the application for a new post office at Brooksville, County of Brook, State of Kentucky at which you are recommended for postmaster, he requires that the blanks in the following statement be filled, and the questions carefully and correctly answered, verified by your signature, certified by a neighboring postmaster, and returned to this Department, addressed to me. The contractor should be informed of this application; and if the site of the proposed office be off the mail route, you will forward his certificate as to the practicability of supplying it, and also as to the increase of distance. If the proposed office is not on any route now under contract, it can only be established as a "Special Office," to be supplied without expense to the Department other than net proceeds.

Be careful to designate the post offices by their true official names; and answer the subjoined queries fully and accurately, or the case will not be acted upon.

Very respectfully,

JAMES N. TYNER,
First Assistant Postmaster General.

To Mr. W. M. Egan
care of the Postmaster of Brooksville, who will please forward to him.

The proposed office to be called

STATEMENT

"Bladeston"

Select a short name for the proposed office, which, when written will not resemble the name of any other post office in the United States.

It will be situated in the _____ quarter of Section _____, Township _____, (North or South), _____ Range _____, (East or West), _____, in the County of Bracken, State of Kentucky.

It will be near route No. 20131, being the route from Falmouth Ky to Brooksville Ky, on which the mail is now carried Six times per week.

The contractor's name is Bain & Sinsley

Will it be directly on this route?—Ans. No.
If not, how far from, and on which side of it?—Ans. 3 miles N.W.

How much will it INCREASE the travel of the mail one way each trip?—Ans. _____
Where will the mail leave the present route to supply the proposed office?—Ans. Brooksville P.O.

Where intersect the route again?—Ans. Nowhere

What post office will be left out by this change?—Ans. None

If not on any route, is a "Special Office" wanted?—Ans. yes. To be supplied from Brooksville P.O.

The name of the nearest office to the proposed one, on the same route, is Brooksville
its distance is Three miles, in a North Western direction from the proposed office.

The name of the nearest office on the same route, on the other side, is _____
its distance is _____ miles, in a _____ direction from the proposed office.

The name of the nearest office to the proposed one, not on this route, is Tietzville Ky
distance by the most direct road 4 1/2 miles, in a N.W. direction from the proposed office.

The name of the most prominent river near it is Ohio.

The name of the nearest creek is Locust

The proposed office will be 4 1/2 miles from said river, on the Southern side of it, and will be 1/2 miles from said nearest creek, on the _____ side of it.

If near a railroad, state on which side the office will be located, how far from, and the name of the station or depot—

Ans. _____
If it be a village, state the number of inhabitants.—Ans. _____

Also, the population to be supplied by proposed office.—Ans. _____

A diagram, or sketch from a map, showing the position of the proposed new office, with neighboring river or creek, roads, and other post offices, towns, or villages near it, will be useful, and is therefore desired.

A correct map of the locality might be furnished by the county surveyor, but this must be without expense to the Post Office Department.

ALL WHICH I CERTIFY to be correct and true, according to the best of my knowledge and belief, this 26 day of Jan, 1884 W. M. Egan Proposed P. M.

(Sign full name.)
I CERTIFY that I have examined the foregoing statement, and that it is correct and true, to the best of my knowledge and belief.

Postmaster at Brooksville
Kentucky

(OVER.)

The scale on the diagram not being understood the distances are given in figures, without reference to the scale on diagram.

Diagram showing the site of the Blades Post Office
 in Township _____ (N. or S.), Range _____ (E. or W.) of _____ Principal
 Meridian, County of Boaden, State
 of Kentucky, with the adjacent Townships and Post Offices.

It is requested that the exact site of the proposed, or existing Post Office, as also the roads to the adjoining offices, and the larger streams or rivers, be marked on this diagram, to be returned as soon as possible to the Post Office Department.

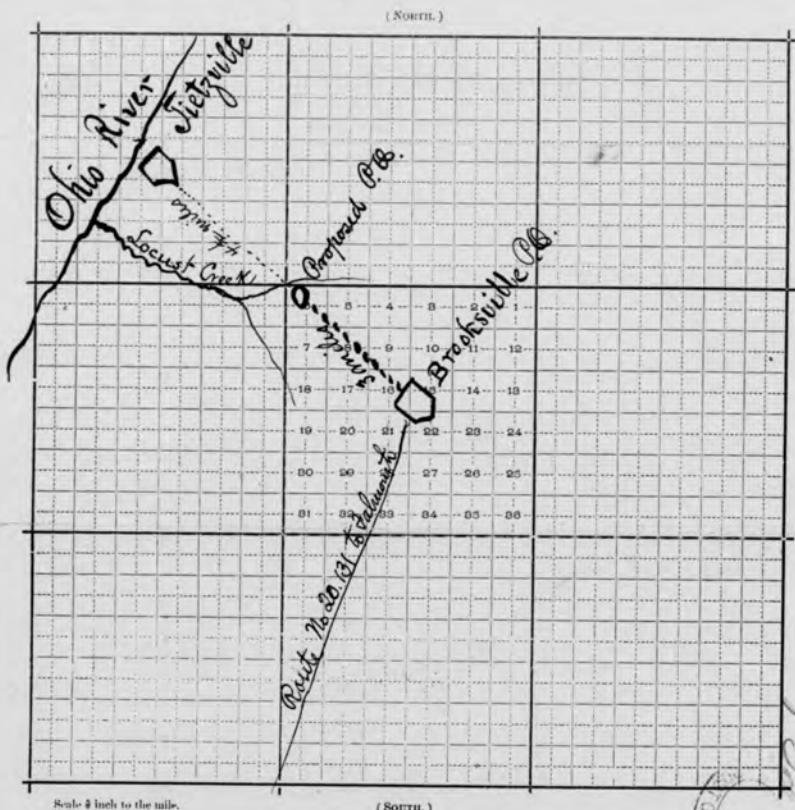

RECEIVED
 FEB 15 1884
 POST OFFICE



Post Office Department,

OFFICE OF THE FIRST ASSISTANT P. M. GENERAL,

WASHINGTON, D. C., 18 .

Sir: Before the Postmaster General decides upon the application for the establishment of a post office at, County of, State of, it will be necessary for you to carefully answer the subjoined questions, get a neighboring postmaster to certify to the correctness of the answers, and return the location paper to the Department, addressed to me. If the site selected for the proposed office should not be on any mail route now under contract, only a "Special Office" can be established there, to be supplied with mail from some convenient point on the nearest mail route by a special carrier (see section 733, Postal Laws and Regulations of 1887), for which service a sum equal to two-thirds of the amount of the salary of the postmaster at such office will be paid by the Department.

You should inform the contractor, or person performing service for him, of this application, and require him to execute the inclosed certificate as to the practicability of supplying the proposed office with mail, and return the same to the Department.

Very respectfully,

W. H. Whitfield
J. S. Johnson
 First Ass't Postmaster General.

To Mr., care of the Postmaster of, who will please forward to him.

STATEMENT.

The proposed office to be called

Bladestown *Bladestown*

It will be situated in the quarter of Section Township (North or South), Range (East or West), in the County of *Beauleau*, State of *Delaware*.

It will be on or near route No., being the route from on which the mail is now carried times per week.

Will it be directly on this route?—Ans. *Yes*
 If not, how far from it?—Ans. *1/2*

If not on any route, is a "Special Office" wanted?—Ans. *Yes*. To be supplied from *Bladestown* by *special carrier*

The name of the nearest office to the proposed one, on one side, is *Bladestown* miles in a *North East* direction from the proposed office.

The name of the nearest office, on the other side, is *Bladestown* miles in a *North East* direction from the proposed office.

The name of the other nearest office to the proposed one is *Bladestown* miles in a *North East* direction from the proposed office.

The name of the most prominent river near it is *Bladestown* miles from said river, on the *South* side of it, and will be *4 1/2* miles from said creek, on the *South* side of it.

The name of the nearest railroad is *Chesapeake & Ohio*. If on the line of or near a railroad, on which side will the office be located: how far from the track; and what is, or will be, the name of the station?—Ans.

If it be a village, state the number of inhabitants.—Ans. *See*

Also, the population to be supplied by the proposed office.—Ans. *See*

A diagram, or sketch from a map, showing the position of the proposed new office, with neighboring river or creek, roads, and other post offices, towns, or villages near it, will be useful, and is therefore desired.

A correct map of the locality might be furnished by the county surveyor, but this must be without expense to the Post Office Department.

ALL WHICH I CERTIFY to be correct and true, according to the best of my knowledge and belief, this day of, 18

(Sign full name.) *John William Dean* Proposed P. M.

I CERTIFY that I have examined the foregoing statement, and that it is correct and true, to the best of my knowledge and belief.

A. E. Rawson
 Postmaster of *Augusta*

(OVER.)

Diagram showing the site of the _____ Post Office,
 in Township _____ (N. or S.), Range _____ (E. or W.) of _____ Principal
 Meridian, County of Blairstown State
 of Kentucky —, with the adjacent Townships and Post Offices.

It is requested that the exact site of the proposed or existing Post Office, as also the roads to the adjoining offices, and the larger streams or rivers, be marked on this diagram, to be returned as soon as possible to the Post Office Department.

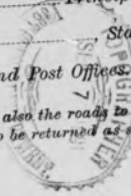

Blairsville, Ky.

(NORTH.)

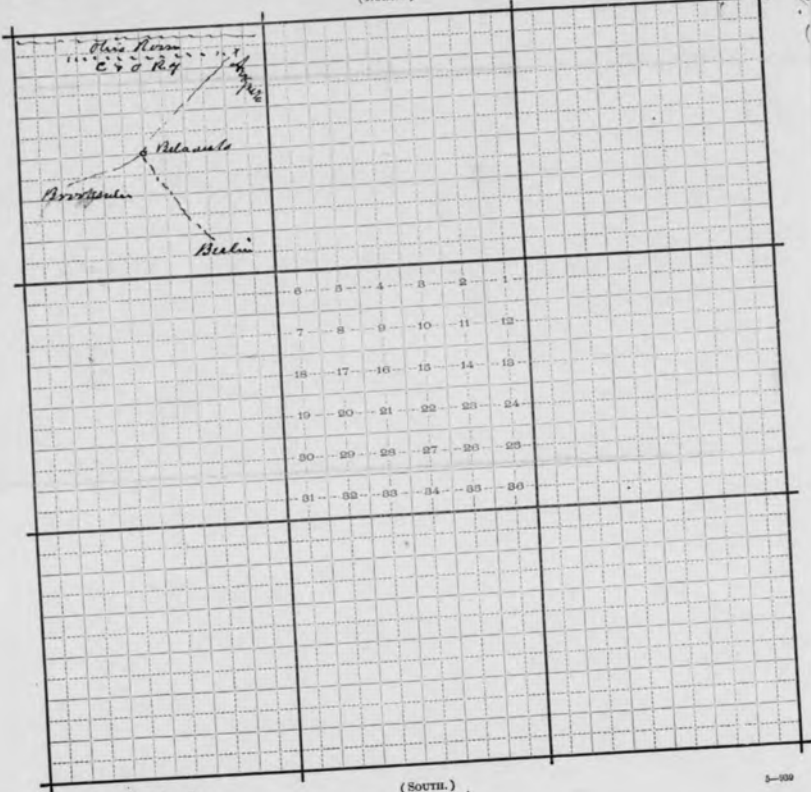

Scale 1/2 inch to the mile.

(SOUTH.)

2-939