

(No. 40.)  
TOPOGRAPHER.

Post Office Department,  
CONTRACT OFFICE,  
Washington, *April 7<sup>th</sup>*, 187*6*



SIR:

To enable the Topographer of this Department to determine, with as much accuracy as possible, the relative positions of Post Offices, so that they may be correctly delineated on its maps, the Postmaster General requests you to fill up the spaces and answer the questions below, and return the same, verified by your signature and dated, under cover to this Office.

For a New map of Ky. Respectfully, &c.,

*J. P. N. Tigner*  
Second Assistant Postmaster General.

TO POSTMASTER AT

*Clatsam*  
*Bracken Co*  
*Kentucky*  
*Chustain*

The (P. O. Dept.) name of my office is

\* Its local name is

It is situated in

County of

*Bracken*

State of

*Kentucky*

Township,

The name of the most prominent river near it is

*Ohio*

The name of the nearest creek is

*South*

This office is *5* miles from said river, on the *South* side of it, and is

*1* miles from said nearest creek, on the *North* side of it.

The name of the nearest office on route No. \_\_\_\_\_ is *Brooksville*, and its distance is *4 1/2* miles, by the traveled road, in a *S. West* direction from this my office.

The name of the nearest office, on the same route, on the other side, is *Augusta* and its distance is *5* miles in a *North* direction from this my office.

The name of the nearest office off the route is \_\_\_\_\_, and its distance by the most direct road is \_\_\_\_\_ miles in a \_\_\_\_\_ direction from this my office.

This office is at a distance of \_\_\_\_\_ from the \_\_\_\_\_ Station of the \_\_\_\_\_ Railroad, on the \_\_\_\_\_ side of the railroad.

State, under this, the names of all other offices near your office, in different directions from it, and their distances from it by the most direct roads. *Germanstown 6 miles North East*  
*Menasa 7 miles East*

\* If the town, village, or site of the Post Office be known locally by another name than that of the Post Office, state that other name here, that it may be identified on any published map of the State, (or Territory,) if appearing thereon.

† A diagram of the township, (or where the land is not so divided, a sketch map,) showing the precise location of your office, together with the adjoining Post Offices, towns, or villages, the roads, railroads, and larger streams or creeks, in addition to the above verbal description, will be useful, and is desired.

A correct map of the locality and adjacent country might be furnished by your County Surveyor, but this must be without expense to the Post Office Department; it being, however, for the general interest and advantage of the community to have the Post Offices correctly located on the maps, it may be expected that this will be cheerfully furnished on proper application.

State (on margin of this sheet) whether there is on file at your county-seat, (court-house,) or in the hands of your County Surveyor, a Map of the county.

State also the present Surveyor's name and the Post Office address.

*H. J. Hargrett Brooksville Ky*

(Signature of Postmaster.)

*Jacob B. Taylor*

(Date.)

*April 20 1876*

*This is a map of this county - Published by E. R. Barrett of Berlin Ky*

Post Office Department,

Office of the First Assistant P. M. General.



Washington, D. C., July 9, 1888.

SIR: Before the Postmaster General decides upon the application for a change of \_\_\_\_\_ site of the post office at Chatham, County of Barren

State of Ky he requires that the blanks in the following statement be filled, and the questions carefully and correctly answered, verified by your signature, certified by a neighboring postmaster, and returned to this Department, addressed to me. The contractor should be informed of this application; and if the site proposed be off the mail route, you will forward his certificate as to the practicability of supplying it, and also as to the increase of distance. Be careful to designate the post offices by their true official names; and answer the subjoined queries fully and accurately, or the case will not be acted upon.

Very respectfully,

A. E. Stevenson  
First Assistant Postmaster General.

To Mr. E. M. Bateman  
of the Postmaster of Chatham, who will please forward to him.

STATEMENT.

The office to be called

Chatham

Select a short name for the proposed office, which, when written, will not resemble the name of any other post office in the State.

The new site will be situated on the \_\_\_\_\_ quarter of Section \_\_\_\_\_, Township \_\_\_\_\_, Range \_\_\_\_\_, in the County of Barren, State of Kentucky

It will be on or near route No. 20293, being the route from Mayesville Ky to Argusville Ky, on which the mail is now carried tw times per week.

The contractor's name is J. A. Beaph

Will it be directly on this route?—Ans. No.

How much will it INCREASE the travel of the mail one way each trip?—Ans. About 200 yards, South Side

Where will the mail leave the present route to supply the proposed site?—Ans. At junction of R.R. at

Where intersect the route again?—Ans. at same place

What post office will be left out by this change?—Ans. None

The name of the nearest office to the proposed site, on the same route, is Argusville  
its distance is 4 1/2 miles, in a North direction.

The name of the nearest office on the same route, on the other side, is Barrenville  
its distance is 4 3/4 miles, in a S. W. direction from the proposed site.

The name of the nearest office to the proposed site, not on this route, is \_\_\_\_\_  
distance by the most direct road \_\_\_\_\_ miles, in a \_\_\_\_\_ direction.

The name of the most prominent river near it is Ohio

The name of the nearest creek is Secret

The proposed site will be 4 1/2 miles from said river, on the South Side of same  
side of it, and will be Five miles from said nearest creek, on the S. W. side of it.

The name of the nearest railroad is \_\_\_\_\_

If on the line of or near a railroad, on which side will the office be located; how far from the track, and what is, or will be, the name of the station?—Ans.

What will be the distance from the proposed site to the nearest flag station?—Ans.

State name of station: \_\_\_\_\_

What will be the distance from the proposed site to the nearest station at which mail trains make regular stops?—Ans.

State name of station: \_\_\_\_\_

If the proposed office is located where it can be supplied from a crane or flag station, or located over 80 rods from the station where mail trains make regular stops, will the mail be carried to and from the proposed office without expense to the Department?—Ans.

If it be a village, state the number of inhabitants.—Ans. Not

Also, the population to be supplied by proposed office.—Ans.

A diagram, or sketch from a map, showing the position of the proposed new office, with neighboring river or creek, roads, and other post offices, towns, or villages near it, will be useful, and is therefore desired.

A correct map of the locality might be furnished by the county surveyor, but this must be without expense to the Post Office Department.

ALL WHICH I CERTIFY to be correct and true, according to the best of my knowledge and belief, this 21 day of July, 1888.

(If Sign full name.)

E. M. Bateman Proposed P. M.

I CERTIFY that I have examined the foregoing statement, and that it is correct and true, to the best of my knowledge and belief.

J. A. Beaph  
Postmaster at Argusville  
Kentucky

(OVER.)

How far, and in what direction, do you propose to move the office?—Ans.

Diagram showing the proposed site of the Leatham  
 in Township \_\_\_\_\_, Range \_\_\_\_\_ of  
 \_\_\_\_\_, County of Barren  
 of Kentucky, with the adjacent Townships and Post Offices

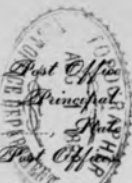

*Leatham*

It is requested that the exact site proposed, as also the roads to the adjoining offices, and the larger streams or rivers, be marked on this diagram, to be returned as soon as possible to the Post Office Department.

(NORTH)

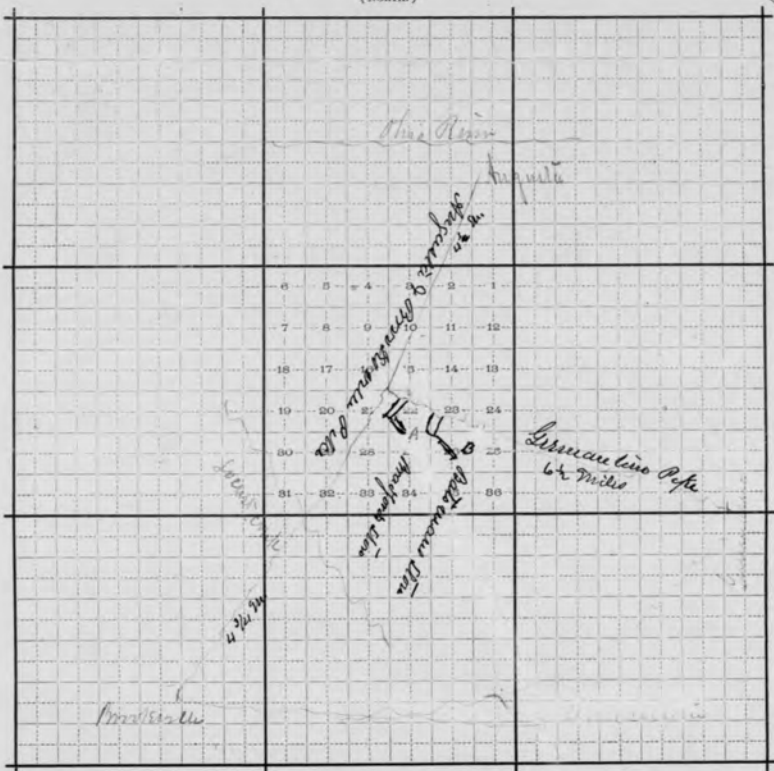

*July*

*A - when 1877 by James B. M.*

Scale  $\frac{1}{2}$  inch to the mile.

(SOUTH)

The present site is on the \_\_\_\_\_ quarter of Section \_\_\_\_\_, Town \_\_\_\_\_, Range \_\_\_\_\_  
 and proposed site is on the \_\_\_\_\_ quarter of Section \_\_\_\_\_, Town \_\_\_\_\_, Range \_\_\_\_\_  
 distant \_\_\_\_\_ miles, in a \_\_\_\_\_ direction, and will be supplied \_\_\_\_\_