

*R.W.*

Post Office Department  
FOURTH ASSISTANT POSTMASTER GENERAL

*E.S.*

Washington, DEC 28 1938

RETURN TO  
DIVISION OF TOPOGRAPHY

Postmaster,

EAGLE STATION

KY

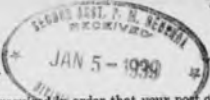

*Carroll Co.*

The following information is required in order that your post office may be shown in its proper location on postal maps. Please complete this form immediately and return it without delay with the map or sketch described on the reverse side. A letter of reply is not necessary.

NEW SITE

*S. W. Wurdeman*  
FOURTH ASSISTANT POSTMASTER GENERAL

- Street address of post office *Eagle Station* County *Carroll*
- Township \_\_\_\_\_ (If location is described by section, township, and range, fill in line 3.)
- \_\_\_\_\_ quarter of section \_\_\_\_\_ Township \_\_\_\_\_ N. or S. \_\_\_\_\_ Range \_\_\_\_\_ E. or W. \_\_\_\_\_
- Nearest adjoining county *Owen* How far: Shortest air distance? \_\_\_\_\_ By road? *7*
- Distance: P.O. from old site *4.15 mi.* Direction: P.O. from old site *North*
- Nearest U. S. or State highway *36* Direction from P. O. *North* Distance *10 ft*
- Name of nearest railroad station *Eagle Ky* Name of railroad *L & N*
- Distance by road to railroad station *1.4* Direction from post office *South*
- Shortest air distance to nearest tracks \_\_\_\_\_ Direction from post office *South*
- Nearest streams or bodies of water (state whether river, creek, branch, lake, ocean, etc.):

Name	Direction from post office	Distance
<u><i>Eagle Creek</i></u>	<u><i>South</i></u>	<u><i>2 mi</i></u>

10. Post offices nearest to your office (one in each general direction):

Name	County	Direction from your office	Distance by road
<u><i>Sanders Ky</i></u>	<u><i>Carroll</i></u>	<u><i>East</i></u>	<u><i>4 mi</i></u>
<u><i>Worthville Ky</i></u>	<u><i>"</i></u>	<u><i>West</i></u>	<u><i>4 mi</i></u>

11. How is mail supplied to your office? *R.R.* From where? *Eagle Sta*  
(Railroad, star route, rural route, etc.)

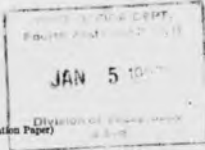

(Date) *Jan 21, 1939*  
(Signed) *Mrs. Effie Barnes* Postmaster.  
\*Post office *Eagle Station Ky*  
2-1074

## DIAGRAM, EXPLANATION, AND INSTRUCTIONS.

The dot in the center of the 1-mile circle represents the site of your office.

The surrounding offices should be carefully located by placing dots on or between the mile circles at the exact distance, and in the right direction from your office, and their names plainly written.

If it should be necessary to designate an office which is over 10 miles from your site, place the dot outside of the 10-mile circle, write the name of such office, and state its distance from your site.

Draw distinctly the railways, roads, rivers, and creeks.

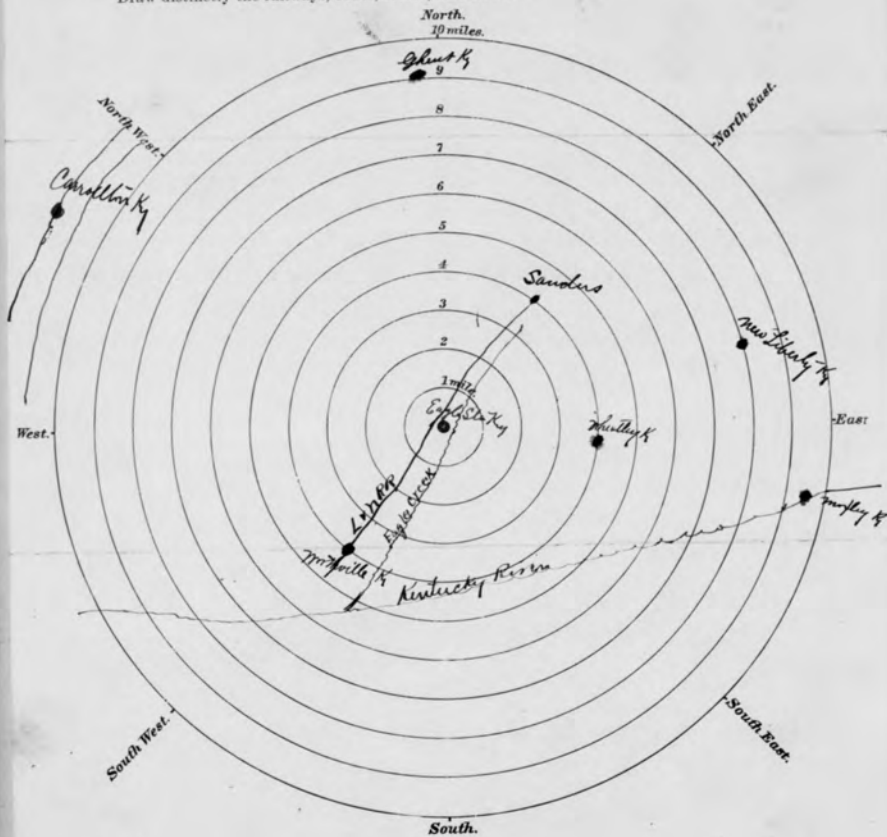

## Post Office Department,

OFFICE OF THE FOURTH ASSISTANT P. M. GENERAL,  
AFFIDAVIT DIVISION.

Washington, D. C., JAN 13 1904, 190

E. S.

SIR:

Before the Postmaster General decides upon the application for a change of site of the post office at Eagle Station, County of Carroll State of Kentucky, to \_\_\_\_\_ he requires that the following questions be carefully and correctly answered, and returned to this Department. The contractor or station agent will also answer the queries addressed to him.

Very respectfully,

  
Fourth Asst. P. M. General.

To Mr. J. C. Jacobs, who will please forward to him  
care of the Postmaster of \_\_\_\_\_

## STATEMENT.

The office to be called

Eagle StationHow far, and in what direction do you propose to move the office?—Ans. 65 yds westThe new site will be situated in the County of Carroll State of KyIt will be on ~~or near~~ route No. 29681, being the route from Eagle Sta Ky  
to Moxley Ky, on which the mail is now carried 6 times per week.Will it be directly on this route?—Ans. yes

If not, how far from, and on which side of it?—Ans. \_\_\_\_\_

How much will it increase the distance necessarily traveled by the carrier in going once over the route?—65 ydsThe name of the nearest office to the proposed site, on the same route, is Wheatley Ky  
its distance is about 3 miles, in S. Easterly direction.The name of the nearest office on the same route, on the other side, is Moxley Ky  
its distance is 8 miles, in a Southerly direction from the proposed site.The name of the nearest office to the proposed site, not on this route, is Sanders Ky  
distance by the most direct road 3 3/4 miles, in a Easterly direction.The name of the most prominent river near it is Kentucky RiverThe name of the nearest creek is Eagle CreekThe proposed site will be 5 miles from said river, on the NE side of it,  
and will be 125 yds miles from said nearest creek, on the north side of it.

If on the line of or near a railroad, state the name, on which side the office will be located, how far from the depot, and what is, or will be, the name of the station.—Ans. \_\_\_\_\_

If it be a village, state the number of inhabitants.—Ans. 75Also, the population to be supplied by proposed office.—Ans. 200ALL OF WHICH I CERTIFY to be correct and true, according to the best of my knowledge and belief, this 15 day of Jan, 1904(20) Sign full name.) Samuel Cornell Jacobs Proposed P. M.

*Engle Station*

**Diagram**

showing the proposed site of the *Engle Sta* Post Office  
on the \_\_\_\_\_ quarter of section \_\_\_\_\_, in Township \_\_\_\_\_ (N. or S.),  
Range \_\_\_\_\_ (E. or W.), of \_\_\_\_\_ Principal Meridian, County of *Carroll*

It is requested that the exact site of your Post Office, as also the roads to the adjoining Offices,  
and the rivers and creeks be marked on this diagram, to be returned as soon as possible to the  
Topographer's Office, Post Office Department. If on, or near a railroad, mark the railroad and  
adjacent Station accurately.

In localities not surveyed by the U. S. Land Office, a sketch map is requested.

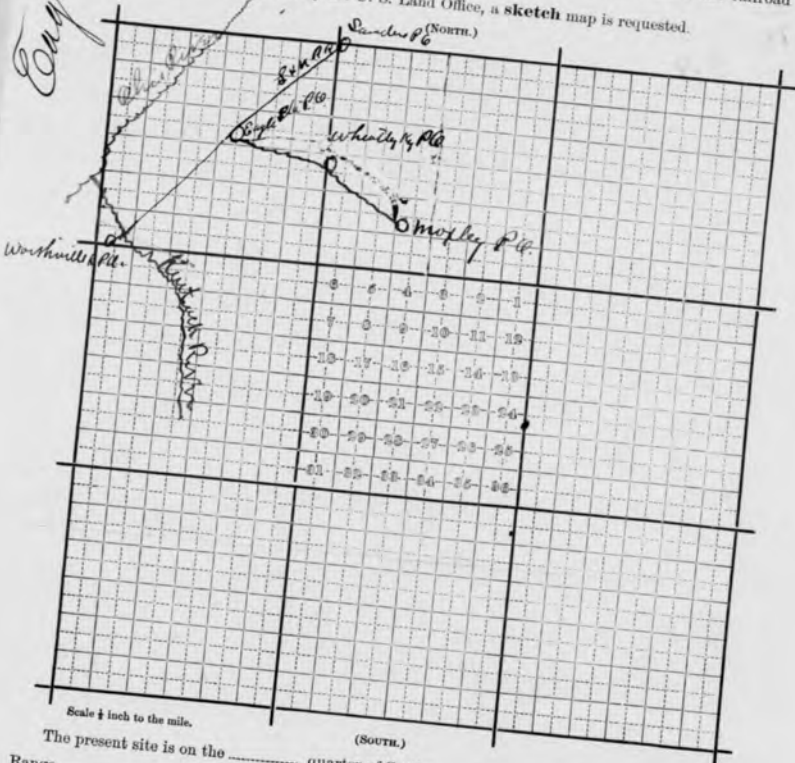

The present site is on the \_\_\_\_\_ quarter of Section \_\_\_\_\_, Town \_\_\_\_\_  
Range \_\_\_\_\_, and proposed site is on the \_\_\_\_\_ quarter of Section \_\_\_\_\_  
Town \_\_\_\_\_, Range \_\_\_\_\_, distant \_\_\_\_\_ miles, in a \_\_\_\_\_ direction.

POST OFFICE DEPARTMENT

OFFICE OF THE

FOURTH ASSISTANT POSTMASTER GENERAL

WASHINGTON

Dec. 3, 1908.

DIVISION OF TOPOGRAPHY



Sir:

In order that ~~the~~ office may determine, with as much accuracy as possible, the relative positions of Post Offices, so that they may be correctly delineated on its maps, please carefully answer the questions below, and furnish the diagram on the other side, returning the same as soon as possible, verified by your signature and dated.

Very respectfully,

*C. P. Raw*

Fourth Assistant Postmaster General.

To POSTMASTER AT Eagle Station  
Carroll Co.,  
Ky.

The (P. O. Dept.) name of my Office is Eagle Station Ky  
If the town, village, or site of the Post Office be known by another name than that of the Post Office, state that other name here:

My Office is situated in \_\_\_\_\_ part of \_\_\_\_\_ Township, or in \_\_\_\_\_ quarter of Tract No. \_\_\_\_\_ Township, County of \_\_\_\_\_ State of \_\_\_\_\_

The name of the most prominent river near it is Kentucky River

The name of the nearest creek is Eagle Creek

My Office is 5 miles from said river, on the north side of it, and is 150 yds miles from said nearest creek, on the north side of it.

My Office is on Mail Route No. 29735 Head of Route

My Office is a Special Office supplied from \_\_\_\_\_ miles distant.

The name of the nearest Office on my route is Wheatley Ky, and its distance is 3 miles, by the traveled road, in a east direction from this, my Office.

The name of the nearest Office, on the same route, on the other side, is Moxley Ky and its distance is 9 miles in a southwesterly direction from this, my Office.

The name of the nearest Office off the route is Skanders Ky, and its distance by the most direct road is 24 miles in a northerly direction from this, my Office.

My Office is at a distance of 50 ft from the track of the L & N Railroad, on the South side of the railroad.

My Office is 5 miles, air-line distance, from nearest point of my County boundary.

(Signature of Postmaster) S. C. Jacobs P.M.

(Date) Dec 11 1908

Please state on which side of the R. R. your P.O. is located!

*R.W.*

Post Office Department  
FOURTH ASSISTANT POSTMASTER GENERAL

*E.S.*

Washington, DEC 28 1938

RETURN TO  
DIVISION OF TOPOGRAPHY

Postmaster,

EAGLE STATION

KY

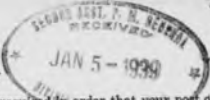

*Carroll Co.*

The following information is required in order that your post office may be shown in its proper location on postal maps. Please complete this form immediately and return it without delay with the map or sketch described on the reverse side. A letter of reply is not necessary.

NEW SITE

*S. W. Wurdeman*  
FOURTH ASSISTANT POSTMASTER GENERAL

- Street address of post office *Eagle Station* County *Carroll*
- Township \_\_\_\_\_ (If location is described by section, township, and range, fill in line 3.)
- \_\_\_\_\_ quarter of section \_\_\_\_\_ Township \_\_\_\_\_ N. or S. \_\_\_\_\_ Range \_\_\_\_\_ E. or W. \_\_\_\_\_
- Nearest adjoining county *Owen* How far: Shortest air distance? \_\_\_\_\_ By road? *7*
- Distance: P.O. from old site *4.15* Direction: P.O. from old site *North*
- Nearest U. S. or State highway *36* Direction from P. O. *North* Distance *10 ft*
- Name of nearest railroad station *Eagle Ky* Name of railroad *L & N*
- Distance by road to railroad station *1.4* Direction from post office *South*
- Shortest air distance to nearest tracks \_\_\_\_\_ Direction from post office *South*
- Nearest streams or bodies of water (state whether river, creek, branch, lake, ocean, etc.):

Name	Direction from post office	Distance
<i>Eagle Creek</i>	<i>South</i>	<i>2 mi</i>

10. Post offices nearest to your office (one in each general direction):

Name	County	Direction from your office	Distance by road
<i>Sanders Ky</i>	<i>Carroll</i>	<i>East</i>	<i>4 mi</i>
<i>Worthville Ky</i>	<i>"</i>	<i>West</i>	<i>4 mi</i>

11. How is mail supplied to your office? *R.R.* From where? *Eagle Sta.*  
(Railroad, star route, rural route, etc.)

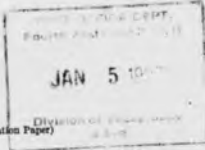

(Date) *Jan 21, 1939*  
(Signed) *Mrs. Effie Barnes*  
Postmaster  
Post office *Eagle Station Ky*

**IMPORTANT.**—A map or sketch showing the location of your post office must be submitted with the return of this paper. A printed map, such as prepared by the county or city engineer, is preferred, if it can be furnished without expense to the Department. Be sure, however, to mark on it the exact site of the post office, placing a small dot in the proper square or block and on the proper side of the street.

If a separate map cannot be furnished it is necessary to submit a sketch as described below.

These diagrams are furnished simply to make it easier to draw a sketch that will show correct distances from your post office.

#### SQUARE DIAGRAM

Use this diagram if your post office is located in an area described by section, township, and range, and you have filled in line 3 on the other side. Otherwise use the circular diagram.

Place a small dot representing your post office in the proper quarter-section and fill in the blanks for township and range numbers.

Then draw the following features: (Note that one-half inch on the paper equals 1 mile on the ground.)

- a. Adjacent post offices (show with small dots and name).
- b. Railroads (show by single line with cross marks; name).
- c. Highways (show by double lines close together and mark U. S. and State numbers; name in margin the post office to which each road leads).
- d. Rivers, creeks, lakes, etc. (show by wavy lines and name).
- e. County line (show by dashes).

#### CIRCULAR DIAGRAM

Use this diagram if your post office is NOT located in an area described by section, township, and range.

Let the dot in the center of the circle represent your post office.

Then draw the features a, b, c, d, and e, as described above. (Note the scale of this diagram: One-quarter inch equals 1 mile.)

