

Post Office Department,

OFFICE OF THE FIRST ASSISTANT P. M. GENERAL,

WASHINGTON, D. C., 10 Jan 1885.

Sup. Before the Postmaster General decides upon the application for the establishment of a post office at Sandy, County of Carroll, State of Kentucky, it will be necessary for you to carefully answer the subjoined questions, get a neighboring postmaster to certify to the correctness of the answers, and return the location paper to the Department, addressed to me. If the site selected for the proposed office should not be on any mail route now under contract, only a "Special Office" can be established there, to be supplied with mail from some convenient point on the nearest mail route by a special carrier, for which service a sum equal to two-thirds of the amount of the salary of the postmaster at such office will be paid.

You should inform the contractor, or person performing service for him, of this application, and require him to execute the inclosed certificate as to the practicability of supplying the proposed office with mail, and return the same to the Department.

Very respectfully,

FRANK HATTON, First Assistant Postmaster General.

To Mr. Henry Bethel, care of the Postmaster of Ghent, who will please forward to him.

STATEMENT.

The proposed office to be called Sandy

Select a short name for the proposed office, which, when written, will not resemble the name of any other post office in the United States.

It will be situated in the 1st quarter of Section 36, Township 1 North or South, Range 4 (East or West), in the County of Carroll, State of Kentucky, being the route from Nevada, Ind.

It will be on or near route No. 20188, on which the mail is now carried from Nevada, Ind. times per week.

The contractor's name is R. O. Williams

Will it be directly on this route?—Ans. Yes

If not, how far from, and on which side of it?—Ans. 5 miles N.E.

How much will it INCREASE the travel of the mail one way each trip?—Ans. Nothing

Where will the mail leave the present route to supply the proposed office?—Ans. Just off the Road

Where intersect the route again?—Ans. Does not leave the Road

What post office will be left out by this change?—Ans. None

If not on any route, is a "Special Office" wanted?—Ans. Yes To be supplied from Ghent

The name of the nearest office to the proposed one, on the same route, is Ghent

its distance is Three miles in a S.W. direction from the proposed office.

The name of the nearest office on the same route, on the other side, is Nevada

its distance is Seven miles in a S.W. direction from the proposed office.

The name of the nearest office to the proposed one, not on this route, is Cape Station

its distance by the most direct road Five miles in a S.W. direction from the proposed office.

The name of the nearest river near it is Ohio River

The proposed office will be Three miles from said river, on the S.W. side of it, and will be 5 1/2 miles from said nearest creek, on the S.W. side of it.

The name of the nearest railroad is Louisville & Nashville (Short Line)

If on the line of or near a railroad, on which side will the office be located; how far from the track; and what is, or will be, the name of the station?—Ans. Liberty Station

What will be the distance from the proposed site to the nearest day station?—Ans. Seven miles

State name of station? Liberty Station

What will be the distance from the proposed site to the nearest station at which mail trains make regular stops?—Ans. Liberty

State name of station? Liberty Station

If the proposed office is located where it can be supplied from a crane or flag station, or located over 80 rods from the station where mail trains make regular stops, will the mail be carried to and from the proposed office without expense to the Department?—Ans. Yes

If it be a village, state the number of inhabitants.—Ans. at Camp Roads 5 in the day

Also, the population to be supplied by the proposed office.—Ans. Liberty is in the T.C.H.

A diagram, or sketch from a map, showing the position of the proposed new office, with neighboring river or creek, roads, and other past offices, towns, or villages near it, will be useful, and is therefore desired.

A correct map of the locality might be furnished by the county surveyor, but this must be without expense to the Post Office Department.

ALL WHICH I CERTIFY to be correct and true, according to the best of my knowledge and belief, this 15 day of January, 1885.

(Sign full name.) Henry Bethel, Proposed P. M.

I CERTIFY that I have examined the foregoing statement, and that it is correct and true, to the best of my knowledge and belief.

Postmaster at Ghent, Carroll Co

(OVER.)

Be careful to answer the inquiries fully and accurately, or the case will not be acted upon.

Diagram showing the site of the

Jan 24

Post Office

Preempt

(E. or W.) of

Principal

Township *Mont* (N. or S.), Range

County of *Carroll*

State

Kennett, with the adjacent Townships and Post Offices.



It is requested that the exact site of the proposed or existing Post Office, as also the roads to the adjoining offices, and the larger streams or rivers, be marked on this diagram, to be returned as soon as possible to the Post Office Department.

(North.)

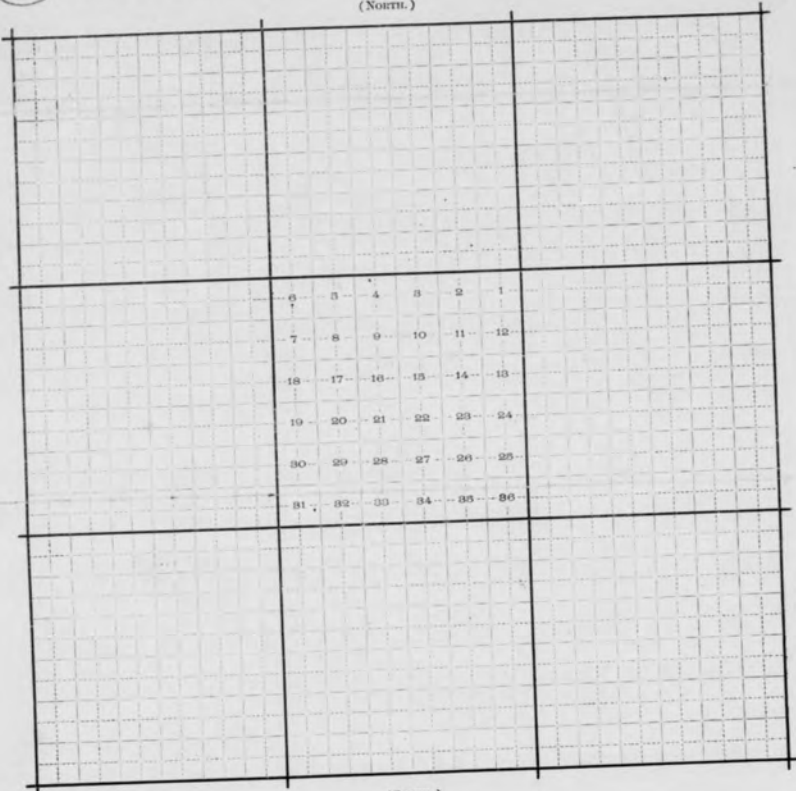

Scale 1/2 inch to the mile.

(South.)

Jan 24
Carroll Co
1885
Post Office



Post Office Department,

OFFICE OF THE FIRST ASSISTANT P. M. GENERAL,

WASHINGTON, D. C., 14 June, 1882.

Sub: Before the Postmaster General decides upon the application for a new post office at Dashville, County of Council, State of Kentucky, at which you are recommended for postmaster, he requires that the blanks in the following statement be filled, and the questions carefully and correctly answered, verified by your signature, certified by a neighboring postmaster, and returned to this Department, addressed to me. The contractor should be informed of this application; and if the site of the proposed office be off the mail route, you will forward his certificate as to the practicability of supplying it, and also as to the increase of distance. If the proposed office is not on any route now under contract, it can only be established as a "Special Office," to be supplied without expense to the Department other than net proceeds.

Be careful to designate the post offices by their true official names; and answer the subjoined queries fully and accurately, or the case will not be acted upon.

Very respectfully,

FRANK HATTON,
First Assistant Postmaster General.

To Mr. Wm. Payne
care of the Postmaster of Ghent Ky, who will please forward to him.

STATEMENT.

The proposed office to be called

Gandy

Select a short name for the proposed office, which, when written, will not resemble the name of any other post office in the United States.

It will be situated in the North quarter of Section 1, Township 1, (North or South),

Range 1 (East or West), in the County of Madison, State of Kentucky

It will be on no route No. 1, on which the mail is now carried once times per week.

The contractor's name is Wm. H. Williams

If it be directly on this route?—Ans. Yes. It will be on the part of the road on which the mail is now carried.

If not, how far from, and on which side of it?—Ans. 3/4 of a mile.

How much will it INCREASE the travel of the mail one way each trip?—Ans. Nothing.

Where will the mail leave the present route to supply the proposed office?—Ans. At each place where the route intersects the route again?—Ans. None.

What post office will be left out by this change?—Ans. None.

If not on any route, is a "Special Office" wanted?—Ans. Yes. To be supplied from Ghent

The name of the nearest office to the proposed one, on the same route, is Ghent miles in a North direction from the proposed office.

The name of the nearest office on the same route, on the other side, is Liberty Station miles in a South direction from the proposed office.

The name of the nearest office to the proposed one, not on this route, is Engle miles in a South direction from the proposed office.

The name of the most prominent river near it is The Ohio River

The name of the nearest creek is McCords Creek miles from said river, on the South side of it, and will be one mile from said creek, on the South side of it.

The name of the nearest railroad is Louisville & Nashville miles from the proposed site, on the South side of it.

If on the line of or near a railroad, on which side will the office be located; how far from the track; and what is, or will be, the name of the station?—Ans. It will be on the line of the Louisville & Nashville R.R. 3/4 of a mile from the station.

What will be the distance from the proposed site to the nearest flag station?—Ans. 3/4 of a mile.

State name of station: Engle

What will be the distance from the proposed site to the nearest station at which mail trains make regular stops?—Ans. 3/4 of a mile.

State name of station? Engle

If the proposed office is located where it can be supplied from a crane or flag station, or located over 80 rods from the station where mail trains make regular stops, will the mail be carried to and from the proposed office without expense to the Department?—Ans. It will be carried.

If it be a village, state the number of inhabitants.—Ans. It has not been laid off into lots. There is a store & a few houses.

Also, the population to be supplied by proposed office.—Ans. The road to be here from 3000 to 4000.

A diagram, or sketch from a map, showing the position of the proposed new office, with neighboring river or creek, roads, and other post offices, towns, or villages near it, will be useful, and is therefore desired.

A correct map of the locality might be furnished by the county surveyor, but this must be without expense to the Post Office Department.

All WHICH I CERTIFY to be correct and true, according to the best of my knowledge and belief, this 24th day of June, 1882.

I CERTIFY that I have examined the foregoing statement, and that it is correct and true, to the best of my knowledge and belief.

Wm. H. Williams Proposed P. M.
By Wm. H. Williams
Postmaster at Ghent Ky

* This road is now owned and run by the Louisville & Nashville R.R. Co. If the name has been changed, do not name it.

(OVER.)

Jan 20/91
 Post Office
 30 June 91

Diagram showing the site of the proposed Roadville Post Office
 in Township _____ (N. or S.), Range _____ (E. or W.) of _____
 Principal
 Meridian, County of Garrett, State
 of Kentucky, with the adjacent Townships and Post Offices.

It is requested that the exact site of the proposed or existing Post Office, as also the roads to
 the adjoining offices, and the larger streams or rivers, be marked on this diagram, to be returned
 as soon as possible to the Post Office Department.

(NORTH)

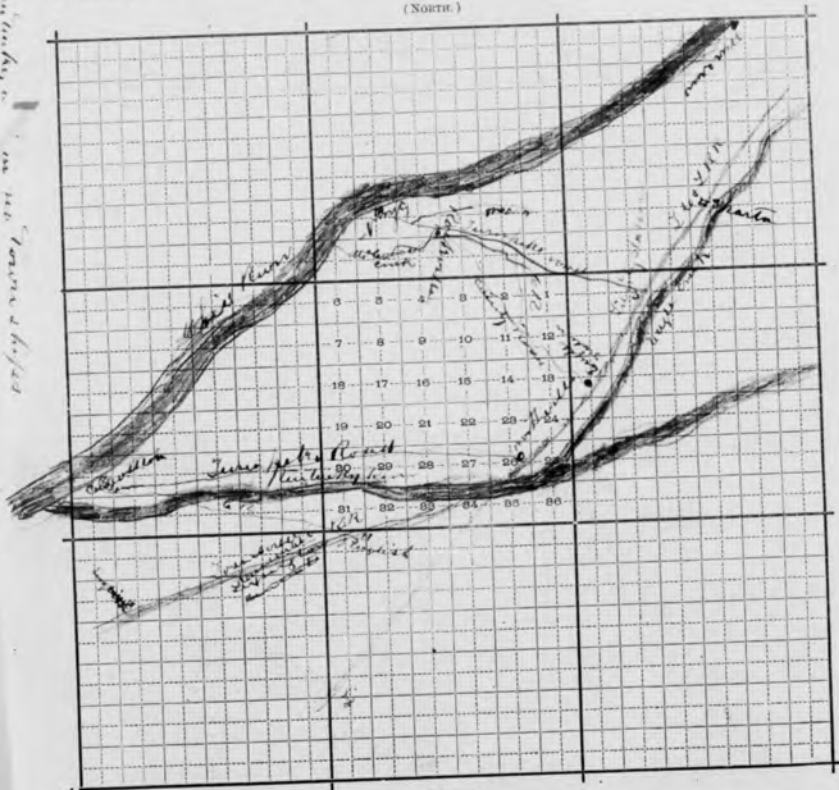

Scale 1/4 inch to the mile.

(SOUTH)