

J.W.

M.

POST OFFICE DEPARTMENT
OFFICE OF THE
FOURTH ASSISTANT POSTMASTER GENERAL
WASHINGTON

DIVISION OF TOPOGRAPHY



Apr. 21/07.

Sir:

In order that this office may determine, with as much accuracy as possible, the relative positions of Post Offices, so that they may be correctly delineated on its maps, please carefully answer the questions below, and furnish the diagram on the other side, returning the same as soon as possible, verified by your signature and dated.

Very respectfully,

C. A. Raw.

Fourth Assistant Postmaster General.

To POSTMASTER AT

Mason
Grant Co., formerly Gouges
N.Y.

The (P. O. Dept.) name of my Office is *Mason*

If the town, village, or site of the Post Office be known by another name than that of the Post Office, state that other name here: *None*

My Office is situated in *N* part of *None* Township, or in *None* quarter of Tract No. *None* Township, County of *Grant* State of *N.Y.*

The name of the most prominent river near it is *None*

The name of the nearest creek is *Cash Creek*

My Office is *None* miles from said river, on the *None* side of it, and is *7* miles from said nearest creek, on the *E* side of it.

My Office is on Mail Route No. *None*

My Office is a Special Office supplied from *C.S.R.R.* miles distant.

The name of the nearest Office on my route is *None* and its distance is *None* miles, by the traveled road, in a *None* direction from this, my Office.

The name of the nearest Office, on the same route, on the other side, is *South 7 Court* and its distance is *7* miles in a *S* direction from this, my Office.

The name of the nearest Office off the route is *Williamstown*, and its distance by the most direct road is *5* miles in a *N* direction from this, my Office.

My Office is at a distance of *7.0* miles from the track of the *C.S.R.R.* Railroad, on the *N* side of the railroad.

My Office is *7* miles, air-line distance, from nearest point of my County boundary.

(Signature of Postmaster) *J. C. Williams*

(Date) *4/20/07*

DIAGRAM, EXPLANATION, AND INSTRUCTIONS.

The dot in the center of the 1-mile circle represents the site of your office.

The surrounding offices should be carefully located by placing dots on or between the mile circles at the exact distance, and in the right direction from your office, and their names plainly written.

If it should be necessary to designate an office which is over 10 miles from your site, place the dot outside of the 10-mile circle, write the name of such office, and state its distance from your site.

Draw distinctly the railways, roads, rivers, and creeks.

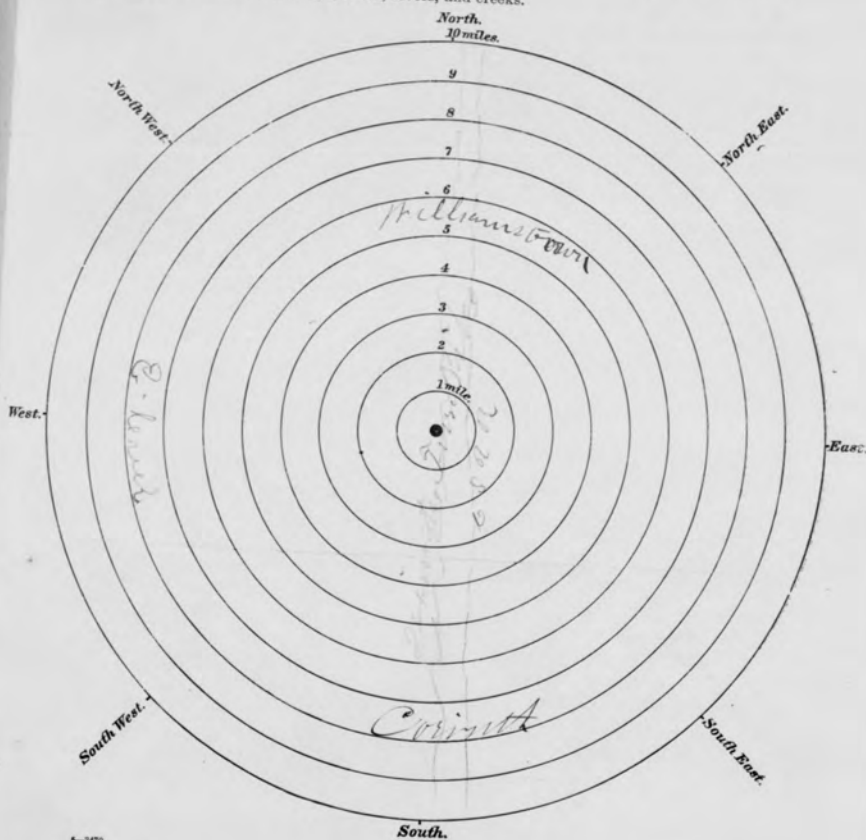

M.

Post Office Department
FOURTH ASSISTANT POSTMASTER GENERAL
Washington

RETURN TO
 DIVISION OF TOPOGRAPHY

Postmaster,

MASON,

JUL 20 1939

KY.

The following information is required in order that your post office may be shown in its proper location on postal maps. Please complete this form immediately and return it without delay with the map or sketch described on the reverse side. A letter of reply is not necessary.

J. W. Wurdum
 FOURTH ASSISTANT POSTMASTER GENERAL

1. Street address of post office _____ County Grant
2. Township _____ (If location is described by section, township, and range, fill in line 3.)
3. _____ quarter of section _____ Township _____ N. or S. _____ Range _____ E. or W. _____
4. Nearest adjoining county Owen How far: Shortest air distance? 5 mi By road? 8
5. Nearest U. S. or State highway 25 95 Direction from P. O. East Distance 100 yd
6. Name of nearest railroad station Mason Name of railroad Southern
7. Distance by road to railroad station 200 yd Direction from post office East
8. Shortest air distance to nearest tracks 120 yd Direction from post office East
9. Nearest streams or bodies of water (state whether river, creek, branch, lake, ocean, etc.):

| Name | Direction from post office | Distance |
|--------------------|----------------------------|-------------|
| <u>Eagle Creek</u> | <u>west</u> | <u>8 mi</u> |
| <u>Grassy Run</u> | <u>west</u> | <u>2 mi</u> |
10. Post offices nearest to your office (one in each general direction):

| Name | County | Direction from your office | Distance by road |
|---------------------|--------------|----------------------------|------------------|
| <u>Williamsboro</u> | <u>Grant</u> | <u>north</u> | <u>6 mi</u> |
| <u>Cornith</u> | <u>Grant</u> | <u>South</u> | <u>6 mi</u> |
11. How is mail supplied to your office? Railroad From where? Animato Ohio
(Railroad, star route, rural route, etc.)

POST OFFICE DEPT.
 Fourth Assistant P. M. G
JUL 28 1939
 Division of Topography
 44-5

(Date) July 24/39
 (Signed) Ediga Robinson Asst PM
 Post office Mason Ky. Postmaster.

IMPORTANT.—A map or sketch showing the location of your post office must be submitted with the return of this paper. A printed map, such as prepared by the county or city engineer, is preferred, if it can be furnished without expense to the Department. Be sure, however, to mark on it the exact site of the post office, placing a small dot in the proper square or block and on the proper side of the street.

§ If a separate map cannot be furnished it is necessary to submit a sketch as described below.

These diagrams are furnished simply to make it easier to draw a sketch that will show correct distances from your post office.

SQUARE DIAGRAM

Use this diagram if your post office is located in an area described by section, township, and range, and you have filled in line 3 on the other side. Otherwise use the circular diagram.

Place a small dot representing your post office in the proper quarter-section and fill in the blanks for township and range numbers.

Then draw the following features: (Note that one-half inch on the paper equals 1 mile on the ground.)

- a. Adjacent post offices (show with small dots and name).
- b. Railroads (show by single line with cross marks; name).
- c. Highways (show by double lines close together and mark U. S. and State numbers; name in margin the post office to which each road leads).
- d. Rivers, creeks, lakes, etc. (show by wavy lines and name).
- e. County line (show by dashes).

CIRCULAR DIAGRAM

Use this diagram if your post office is NOT located in an area described by section, township, and range.

Let the dot in the center of the circle represent your post office.

Then draw the features a, b, c, d, and e, as described above. (Note the scale of this diagram: One-quarter inch equals 1 mile.)

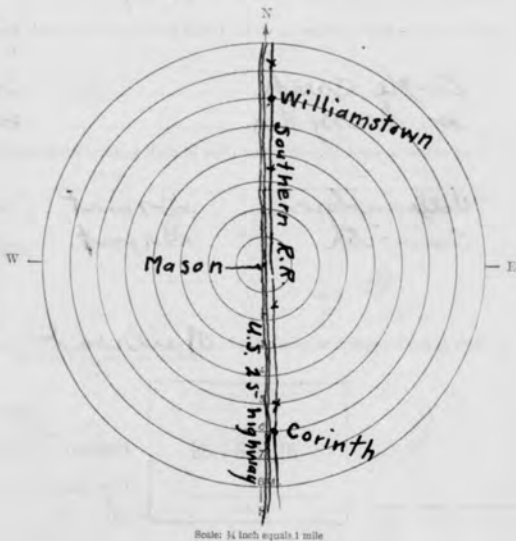
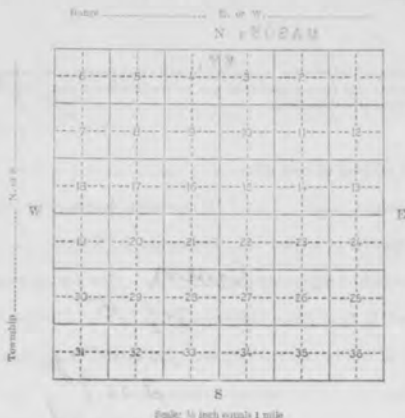

740

M.

Post Office Department
FOURTH ASSISTANT POSTMASTER GENERAL
Washington

RETURN TO
 DIVISION OF TOPOGRAPHY

NOV 29 1944

Postmaster, *E. N. 12-2-44*

MASON KENTUCKY

The following information is required in order that your post office may be shown in its proper location on postal maps. Please complete this form immediately and return it without delay with the map or sketch described on the reverse side. A letter of reply is not necessary.

NEW SITE

Walter Myers
 FOURTH ASSISTANT POSTMASTER GENERAL

- Street address of post office _____ County Grant *Fl*
- Township _____ (If location is described by section, township, and range, fill in line 3.)
- _____ quarter of section _____ Township _____ N. or S. _____ Range _____ E. or W. _____
- Nearest adjoining county Owen How far: Shortest air distance? 5 mi By road? 6.5
 Distance: P.O. from old site 128 ft. Direction: P.O. from old site South
- Nearest U. S. or State highway 100 ft. U.S. Direction from P. O. East Distance 100 ft
- Name of nearest railroad station Mason Name of railroad Cincinnati, New Orleans + Texas Pacific
- Distance by road to railroad station 600 ft Direction from post office North
- Shortest air distance to nearest tracks 150 Direction from post office East
- Streams or bodies of water nearest to your office:

| Name | Direction from post office | Distance |
|--------------------|----------------------------|--------------|
| <u>Eagle Creek</u> | <u>West</u> | <u>6 mi.</u> |

- Post offices nearest to your office (one in each general direction):

| Name | County | Direction from your office | Distance by road |
|-------------------|--------------|----------------------------|------------------|
| <u>Wilkesboro</u> | <u>Grant</u> | <u>North</u> | <u>5.5 mi</u> |
| <u>Cornick</u> | <u>Grant</u> | <u>South</u> | <u>6 mi</u> |
| _____ | _____ | _____ | _____ |
| _____ | _____ | _____ | _____ |

- How is mail supplied to your office? Railroad From where? Cincinnati
(Railroad, star route, rural route, etc.)

(Date) Dec. 12, 1944

(Signed) Wm. Maxine Faulkner
 Postmaster.

Post office Mason Ky.

W.H.
S.F.

M.

Post Office Department
FOURTH ASSISTANT POSTMASTER GENERAL

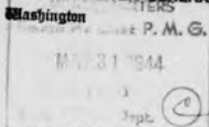

RETURN TO
DIVISION OF TOPOGRAPHY

MAY 24 1944

Postmaster, MASON KY.

Topog

The following information is required in order that your post office may be shown in its proper location on postal maps. Please complete this form immediately and return it without delay with the map or sketch described on the reverse side. A letter of reply is not necessary.

Nellie Mygale

FOURTH ASSISTANT POSTMASTER GENERAL

- Street address of post office Dixie Highway County Grant
- Township _____ (If location is described by section, township, and range, fill in line 3.)
- _____ quarter of section _____ Township _____ N. or S. _____ Range _____ E. or W.
- Nearest adjoining county Owen Co. How far: Shortest air distance? 6 mi By road? 8 mi approx
- Nearest U. S. or State highway 200 ft US 25 Direction from P. O. EN Distance 10 ft
- Name of nearest railroad station Mason Name of railroad Southern
C. & O. T. P.
- Distance by road to railroad station 500 ft Direction from post office N
- Shortest air distance to nearest tracks 200 ft Direction from post office E
- Streams or bodies of water nearest to your office:

| Name | Direction from post office | Distance |
|-------|----------------------------|----------|
| _____ | _____ | _____ |
| _____ | _____ | _____ |

10. Post offices nearest to your office (one in each general direction):

| Name | County | Direction from your office | Distance by road |
|----------------------------|--------------|----------------------------|--------------------|
| <u>Carroll Post Office</u> | <u>Grant</u> | <u>South</u> | <u>8 mi approx</u> |
| <u>Williamstown P.O.</u> | <u>Grant</u> | <u>North</u> | <u>5 mi approx</u> |
| _____ | _____ | _____ | _____ |

11. How is mail supplied to your office? Railroad & Grant Hwy From where? Mason

(Railroad, star route, rural route, etc.)

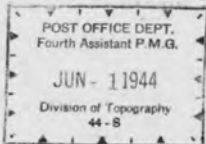

4901-B-112 (Location Paper)

(Date) May 29, 1944

(Signed) Mrs. Mygale Faulkner
Postmaster.

Post office Mason, Ky.

(OVER)

10-9071

IMPORTANT.—A map showing the location of your post office must be submitted with the return of this paper. A highway map such as prepared by State, county, or local agencies is preferred, if it can be furnished without expense to the Department. Be sure, however, to mark on it the exact site of the post office, placing a small dot in the proper square or block and on the proper side of the street.
If no map can be furnished it is necessary to draw a sketch on one of the diagrams below.

INSTRUCTIONS

These diagrams are furnished simply to make it easier to draw a sketch that will show correct distances from your post office.

SQUARE DIAGRAM

Use this diagram if your post office is located in an area described by section, township, and range, and you have filled in line 3 on the other side. Otherwise use the circular diagram.

Place a small dot representing your post office in the proper quarter-section and fill in the blanks for township and range numbers.

Then draw the following features:
(Note that one-half inch on the paper equals 1 mile on the ground.)

- Adjacent post offices (show with small dots and name).
- Railroads (show by single line with cross marks; name).
- Highways (show by double lines close together and mark U. S. and State numbers; name in margin the post office to which each road leads).
- Rivers, creeks, lakes, etc. (show by wavy lines and name).
- County line (show by dashes).

CIRCULAR DIAGRAM

Use this diagram if your post office is NOT located in an area described by section, township, and range.

Let the dot in the center of the circle represent your post office.

Then draw the features a, b, c, d, and e, as described above. (Note the scale of this diagram: One-quarter inch equals 1 mile.)

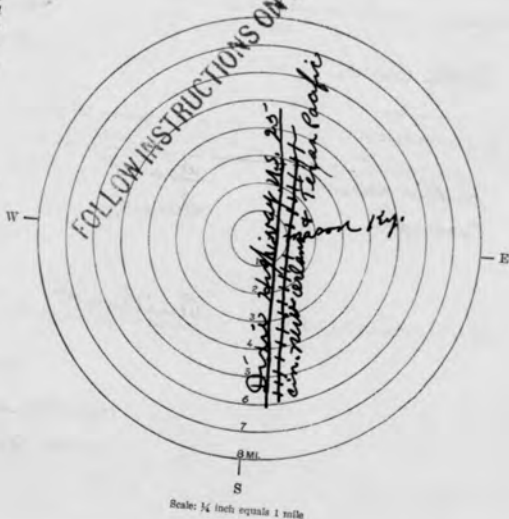
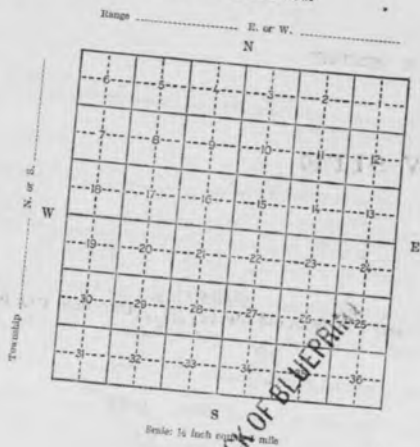

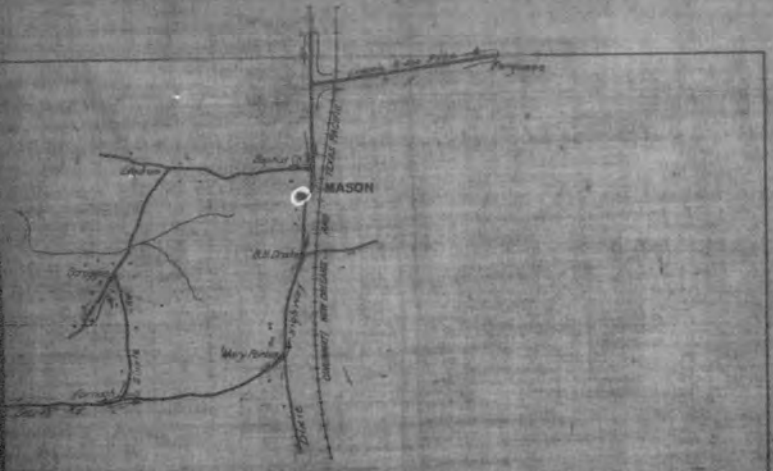

70-227

RURAL DELIVERY ROUTE
No. 1

MASON, GRANT CO., KY.

POST OFFICE DEPARTMENT

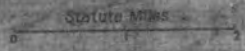

44-6607-2