



Post Office Department,

OFFICE OF THE FIRST ASSISTANT P. M. GENERAL,

WASHINGTON, D. C., May 26, 1890

SIR: Before the Postmaster General decides upon the application for the establishment of a post office at Ky, County of Kenton, State of Ky, it will be necessary for you to carefully answer the subjoined questions: get a neighboring postmaster to certify to the correctness of the answers, and return the location paper to the Department, addressed to me. If the site selected for the proposed office should not be on any mail route now under contract, only a "Special Office" can be established there, to be supplied with mail from some convenient point on the nearest mail route by a special carrier, for which service a sum equal to two thirds of the amount of the salary of the postmaster at such office will be paid by the Department.

You should inform the contractor, or person performing service for him, of this application, and require him to execute the inclosed certificate as to the practicability of supplying the proposed office with mail, and return the same to the Department.

Very respectfully,

J. S. Blockson
First Ass't Postmaster General.

Be careful to answer the inquiries fully and accurately, or the case will not be acted upon.

To Mr. J. A. Bird
care of the Postmaster of Nicholas, who will please forward to him.

STATEMENT.

The proposed office to be called

Stwood

Select a short name for the proposed office, which, when written, will not resemble the name of any other post office in the State.

It will be situated in the quarter of Section Township (North or South)
Range (East or West), in the County of Kenton, State of Kentucky
It will be on or near route No. 20802, being the route from Lexington
to Nicholas, on which the mail is now carried by 6 times per week.
Will it be directly on this route? - Ans. No, further south on same pike
If not, how far from it? - Ans. Three (3) miles South
If not on any route, is a "Special Office" wanted? - Ans. yes To be supplied from Nicholas
The name of the nearest office to the proposed one, on one side, is Key West
its distance is Five (5) miles in a West direction from the proposed office.
The name of the nearest office, on the other side, is Horming Green
its distance is Six (6) miles in a East direction from the proposed office.
The name of the other nearest office to the proposed one is Dickburgh
its distance by the most direct road is 5 1/2 miles in a South direction from the proposed office.
The name of the most prominent river near it is Licking
The name of the nearest creek is Cruises Creek
The proposed office will be 6 1/2 miles from said river, on the South West side of it, and will be Two (2) miles from said nearest creek, on the South North side of it.
The name of the nearest railroad is Queen & Crescent C. & O. R. R.
If on the line of or near a railroad, on which side will the office be located; how far from the track; and what is, or will be, the name of the station? - Ans.
If it be a village, state the number of inhabitants - Ans. no info (no)
Also, the population to be supplied by the proposed office - Ans. at least 300

A diagram, or sketch from a map, showing the position of the proposed new office, with neighboring river or creek, roads, and other post offices, towns, or villages near it, will be useful, and is therefore desired.

A correct map of the locality might be furnished by the county surveyor, but this must be without expense to the Post Office Department.

ALL WHICH I CERTIFY to be correct and true, according to the best of my knowledge and belief, this 26 day of May, 1890

I CERTIFY that I have examined the foregoing statement, and that it is correct and true, to the best of my knowledge and belief

Postmaster at Nicholas
B. W. Sanders

(OVER.)

Diagram showing the site of the Atwood Post Office,
 in Township _____ (N. or S.), Range _____ (E. or W.) of _____ Principal
 Meridian, County of Kenton, State
 of Kentucky, with the adjacent Townships and Post Offices.

It is requested that the exact site of the proposed or existing Post Office, as also the roads to the adjoining offices, and the larger streams or rivers, be marked on this diagram, to be returned as soon as possible to the Post Office Department.

(North.)

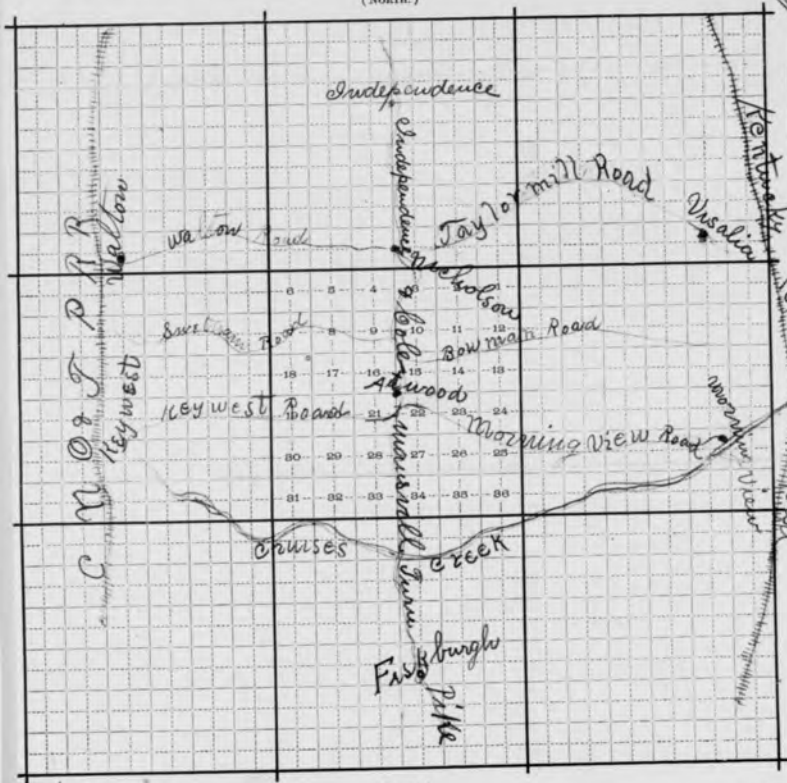

Scale 1/2 inch to the mile.

(South.)

5-228

Atwood, Ky.
 Piercing River
 Kenton County
 Usalia
 Taylor Mill Road
 Morning View Road
 Fishing Creek
 Fishburgh
 Key West
 Independence